



Waterloo 2.6 GPM Wall-Mounted Pet Grooming / Utility Faucet with 8" Centers, 9' Coiled Hose, and 6" Add-On Faucet

#750FWU86

Item #: 750FWU86 Qty: _____

Project: _____

Approval: _____ Date: _____



Features

- Multi-use faucet for pet grooming, washdown, and other utility applications
- 9' coiled hose, 2.6 GPM spray valve, 6" add-on swivel faucet
- Wall-mounted design with 8" adjustable centers; 1/2" NPT inlets
- 1/4 turn ceramic cartridges for long life and leak-protection
- Heavy-duty faucet base and spray valve; chrome-plated brass construction

Certifications



CSA, US and Canada



1/2"

1/2" Water Connection



NSF Certified

Technical Data

Hose Length	108 Inches
Faucet Width	12 3/8 Inches
Faucet Height	11 Inches
Add-On Faucet	6 Inches
Add-On Type	Swing
Cartridge Type	Ceramic
Faucet Centers	8 Inches
Features	ASME A112.18.1-2018 / CSA B125.1-18 Massachusetts Accepted Plumbing Product NSF Certified

Technical Data	
Finish	Chrome
Handle Type	Lever
Material	Brass
Mounting Style	Wall Mounted
Mounting Type	Adjustable
Pre Rinse Unit Type	No Riser
Spout Connection Size	1"-20 UNEF
Spray Valve Flow Rate	2.6 GPM
Temperature Rating	180 Degrees F
Thread Type	NPT
Type	Faucets
Water Inlet Size	1/2 Inches

Plan View

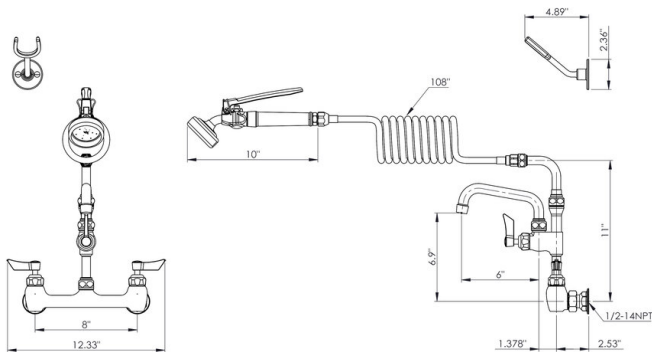
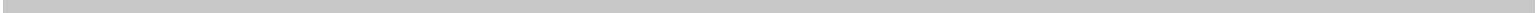

Notes & Details

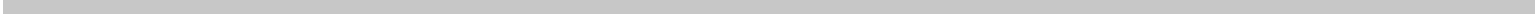

This Waterloo wall-mounted utility faucet is a versatile water fixture that can fill a wide range of roles in your business thanks to its coiled, 9' hose and a reliable spray valve design! Waterloo products provide the industry-leading quality you expect. With heavy chrome-plated brass faucet bodies, ceramic cartridges engineered for durability, and certifications from a wide range of national and local regulatory agencies, you can install Waterloo products with confidence. And to give you total peace of mind, this model comes with a 3-year replacement warranty.

A 9' long hose makes it easy to get water exactly where you need it, when you need it, and the coiled design keeps it stowed out of the way when you don't need it. It's a great solution for pet and animal grooming applications. Restaurants can also use it for easier equipment washdown, and it's great for plenty of other utility applications, too! The spray valve delivers a flow rate of 2.6 GPM, giving you the power needed to blast away debris while still being gentle enough for use on animals in grooming applications. This unit also comes with a 6" add-on faucet for times when you need a normal faucet instead of a spray valve. It is perfect for filling up sink compartments or washing small hand tools and is also great for mixing up cleaning solutions in sanitation pails.

This faucet uses ceramic cartridges, which provide a much lower fail rate than the compression cartridges widely used in the industry. In this design, 2 ceramic discs fit together to create a watertight seal when closed. This removes the need for a rubber seat washer, which is one of the most frequently replaced parts on a faucet. This is a wall-mounted faucet, and it comes with 8" adjustable centers that line up with your sink or mounting surface centers to make installation easy. A set of 1/2" NPT inlets make it easy to connect it to your facility's water lines. Due to flow rate regulations, this faucet cannot be used in a pre-rinse application for pre-scrapping dinnerware.

⚠ WARNING: This product can expose you to chemicals including lead, which are known to the State of California to cause cancer and birth defects or other reproductive harm. For more information, go to www.p65warnings.ca.gov.