



Waterloo 1.8 GPM Wall-Mount Faucet with 12" Swing Spout, 8" Centers, and Wrist Handles

#750CFW812WHK

Item #: 750CFW812WHK Qty: _____
 Project: _____
 Approval: _____ Date: _____



Features

- 12" long swing spout with 1.8 GPM aerator
- Wall-mounted design with 8" adjustable centers and 1/2" NPT inlets
- Temperature rating of 40-180 degrees Fahrenheit
- Heavy-duty chrome-plated brass construction
- Leak-resistant quarter-turn ceramic cartridges with check valves

Certifications



CSA, US and Canada



NSF Certified



1/2" Water Connection

Technical Data

Spout Length	12 Inches
Faucet Height	5 5/8 Inches
Cartridge Type	Ceramic
Faucet Centers	8 Inches
Finish	Chrome
Flow Rate	1.8 GPM
Handle Type	Wrist
Material	Brass
Mounting Style	Wall Mounted
Mounting Type	Adjustable

Technical Data

Rough In	8 Inches
Spout Clearance	3 5/16 Inches
Spout Connection Size	1"-20 UNEF
Spout Type	Swing
Temperature Rating	40 - 180 Degrees F
Thread Type	NPT
Type	Faucets
Water Inlet Size	1/2 Inches

Plan View

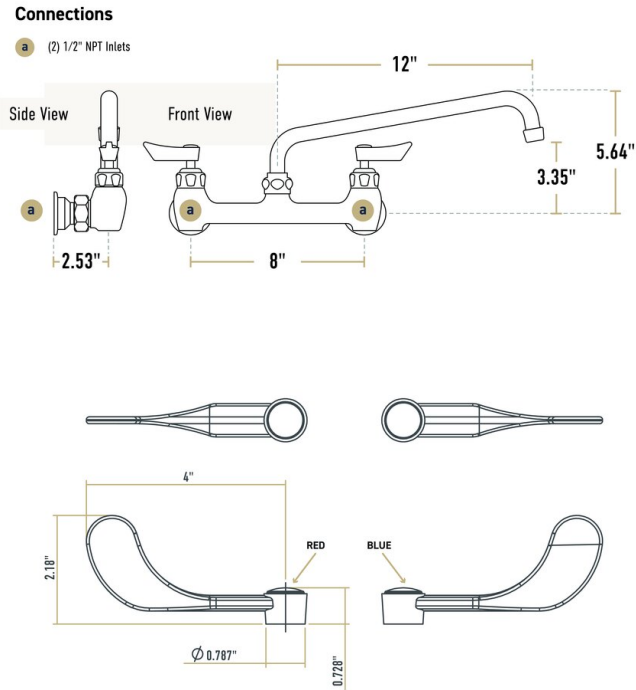

Notes & Details

This Waterloo wall-mounted faucet is the perfect solution when you need a dependable water fixture in your facility! Waterloo faucets provide the industry-leading quality you expect. With heavy-duty chrome-plated brass faucet bodies, ceramic cartridges engineered for durability, and certifications from a wide range of national and local regulatory agencies, you can install this model with confidence.

This faucet features a 12" long swing spout that moves easily around the sink bowl, while a 1.8 GPM aerator provides a consistent flow rate and minimal splashing. It boasts a set of 8" adjustable centers, while the deck-mounted design is easy to install with 1/2" NPT inlets. For convenient use and sanitary hand washing, this model comes with 4" blade style wrist handles. This type of handle lets employees turn the water on or off by using the wrist rather than the fingers, reducing the transfer of germs for increased sanitation.

This faucet uses quarter-turn ceramic cartridges, which provide a much lower fail rate than the compression cartridges widely used in the industry. In this design, 2 ceramic discs fit together to create a watertight seal when closed. This removes the need for a rubber seat washer, which is one of the most frequently replaced parts on a faucet.

⚠ WARNING: This product can expose you to chemicals including lead, which are known to the State of California to cause cancer and birth defects or other reproductive harm. For more information, go to www.p65warnings.ca.gov.