



Item No. _____

Quantity _____

Model No. SWC200

Rotary Cutter

The perfect way to make a chopped salad. Place the meat and cheese into the bowl and add your requested vegetables. Use the Stainless steel Rotary Cutter and chop the salad to the desired size. It will take approximately 6 to 8 passes. This is a simple and quick way to build a Chopped Salad. The cutter is easy to clean, just remove the blade retainers (2) and the cutting wheels.



Standard Features:

- Stainless steel blade
- Polypropylene handle
- Removable cutting wheels
- NSF Listed

NEMCO Food Equipment, Ltd.
301 Meuse Argonne Ave.
Hicksville, OH 43526
Phone 419-542-7751
FAX 419-542-6690
www.nemcofoodequip.com

Printed 11/14 Printed in U.S.A.

Rotary Cutter
Model No.
SWC200

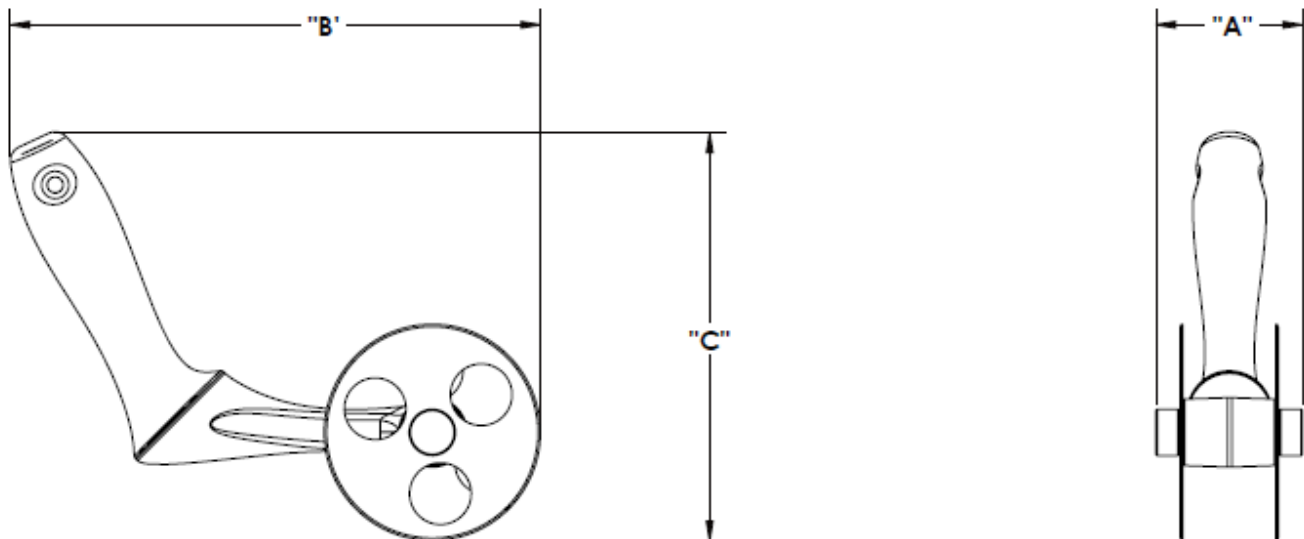

SPECIFICATIONS

Model No.	Width Inches/(cm) A	Depth Inches/(cm) B	Height Inches/(cm) C	Unit Weight lbs./(Kg)	Shipping Weight lbs./(Kg)
SWC200	2 3/8" (6.0)	8 5/8" (21.9)	6 5/8" (16.8)	0.6 (0.27)	1 (0.45)

TYPICAL SPECIFICATIONS

Rotary Cutters are constructed of two stainless steel blades and polypropylene handle. Blade Retainers are removable. Cutters are Listed with the National Sanitation Foundation.



NEMCO Food Equipment, Ltd.
 301 Meuse Argonne Ave.
 Hicksville, OH 43526
 Phone 419-542-7751
 FAX 419-542-6690
www.nemcofoodequip.com

11/14 Printed in U.S.A.