



Regency LDR-2324 24" Five-Tiered Stainless Steel Liquor Display Rack - 23" Deep

#600LDR2324



Technical Data

| | |
|---------------------|------------------|
| Length | 24 Inches |
| Width | 23 Inches |
| Height | 33 Inches |
| Shelf Depth | 4 3/8 Inches |
| Backsplash Height | 3 Inches |
| Work Surface Height | 30 Inches |
| Backsplash | With Backsplash |
| Capacity | 30 Bottles |
| Features | NSF Certified |
| Leg Construction | Galvanized Steel |

Features

- 24" x 23" with 3" backsplash
- Five-tiered design holds approximately 30 liquor bottles
- 18 gauge type 304 stainless steel bottom, back, sides, hat channel, and steps
- 16 gauge type 304 stainless steel 2" wide bars hold bottles in place
- Galvanized legs and bracing with plastic bullet feet

Certifications



NSF Certified

Technical Data

| | |
|-----------------|-----------------|
| Material | Stainless Steel |
| Number of Tiers | 5 Tiers |
| Type | Liquor Displays |

Plan View

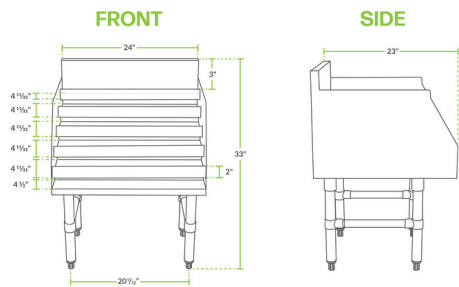

Notes & Details

Effectively store liquor bottles within convenient reach of the bartender while creating a unique display for customers with this Regency 24" wide liquor display rack! At 23" deep, this rack accommodates approximately 30 liquor bottles and, thanks to the stepped five-tiered design, all bottles are clearly on display at all times within a compact 24" wide footprint. A 3" backsplash helps protect the walls and floor around the unit from accidental splashes and spills, while a 2" wide integrated bar on each tier helps hold bottles in place for added assurance.

Built for reliable, long-lasting performance, this Regency 24" liquor display rack features an 18 gauge type 304 stainless steel bottom, back, sides, hat channel, and steps. That not only makes for a durable addition to your bar setup, but also one that is extremely simple to clean! The galvanized legs feature cross-bracing for added stability and rest upon plastic bullet feet.