



Regency LDC-2324 24" Five-Tiered Stainless Steel Liquor Display Cabinet - 23" Deep

#600LDC2324



Technical Data

Length	24 Inches
Width	23 Inches
Height	33 Inches
Backsplash Height	3 Inches
Work Surface Height	30 Inches
Backsplash	With Backsplash
Capacity	30 Bottles
Features	NSF Certified
Leg Construction	Stainless Steel

Features

- Five-tiered design holds approximately 30 liquor bottles
- Full-height side enclosures help protect other underbar equipment
- 18 gauge type 304 stainless steel bottom, back, sides, hat channel, and steps
- 16 gauge type 304 2" wide bars hold bottles in place
- Stainless steel legs with stainless steel feet

Certifications



NSF Certified

Technical Data

Material	Stainless Steel
Number of Tiers	5 Tiers
Type	Liquor Displays

Plan View

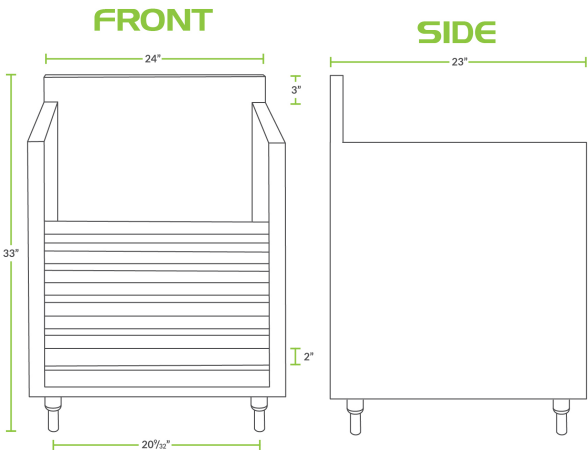

Notes & Details

Effectively store liquor bottles within convenient reach of the bartender while adding a reliable storage solution that creates a unique display for customers with this Regency 24" wide liquor display cabinet! At 23" deep, this cabinet accommodates approximately 30 liquor bottles and, thanks to the stepped five-tiered design, all bottles are clearly on display at all times within a compact 24" wide footprint. A 3" back splash combines with full-height side enclosures to help protect the walls, floor, and other equipment around the unit from accidental splashes and spills, while a 2" wide integrated bar on each tier helps hold bottles in place for added assurance.

Built for reliable, long-lasting performance, this Regency 24" liquor display cabinet features an 18 gauge type 304 stainless steel bottom, back, sides, hat channel, and steps. That not only makes for a durable addition to your bar setup, but also one that is extremely simple to clean! The stainless steel legs rest soundly on stainless steel feet.