



Regency Spec Line 24" x 24" Stainless Steel Perforated Top Glass Rack Storage Unit

#600GRDB2424S



Technical Data

Length	24 Inches
Width	24 Inches
Height	39 1/16 Inches
Backsplash Height	7 Inches
Work Surface Height	30 Inches
Backsplash	With Backsplash
Base Style	Cabinet
Drain Size	1 Inch
Leg Construction	Stainless Steel
Material	Stainless Steel

Features

- 18 gauge type 304 stainless steel construction
- Removable perforated drainboard top
- Durable stainless steel legs and bullet feet
- 7" backsplash protects walls
- 1" NPS bottom drain, 3" rear hole for plumbing access

Technical Data

Product Line	Regency Spec Line
Top Style	Perforated
Type	Glass Rack Storage Units

Plan View

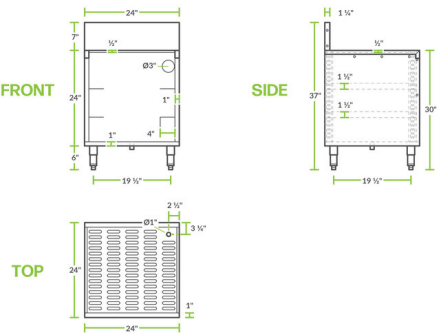

Notes & Details

Add this Regency Spec Line glass rack storage unit to your establishment to ensure your glassware is properly cleaned and sanitized. Its perforated drainboard top is a convenient place for drying glasses or unloading glass racks. The top is even removable for added versatility. This unit features a 7" backsplash to protect your walls and floors, along with a 1" NPS bottom drain and 3" hole in the rear to accommodate your plumbing needs.

This glass rack storage unit is constructed of all 18 gauge type 304 stainless steel for long-lasting durability and corrosion resistance. With durable stainless steel legs and bullet feet, this unit keeps glass racks up off the floor for sanitary storage. Plus, the legs give you enough clearance to clean beneath the cabinet. This unit is designed to stand up to the rigors of any food service environment.

⚠ WARNING: This product can expose you to chemicals including lead, which are known to the State of California to cause cancer and birth defects or other reproductive harm. For more information, go to www.p65warnings.ca.gov.