



Regency 6" Pre-Rinse Wall Bracket Assembly for 3/8" NPS Riser

#600WB6



Technical Data

Type

Wall Brackets

Features

- Secures the pre-rinse assembly to the wall
- 6" long
- Fits 3/8" NPS risers on Regency pre-rinse faucets
- Mounting screws included

Plan View

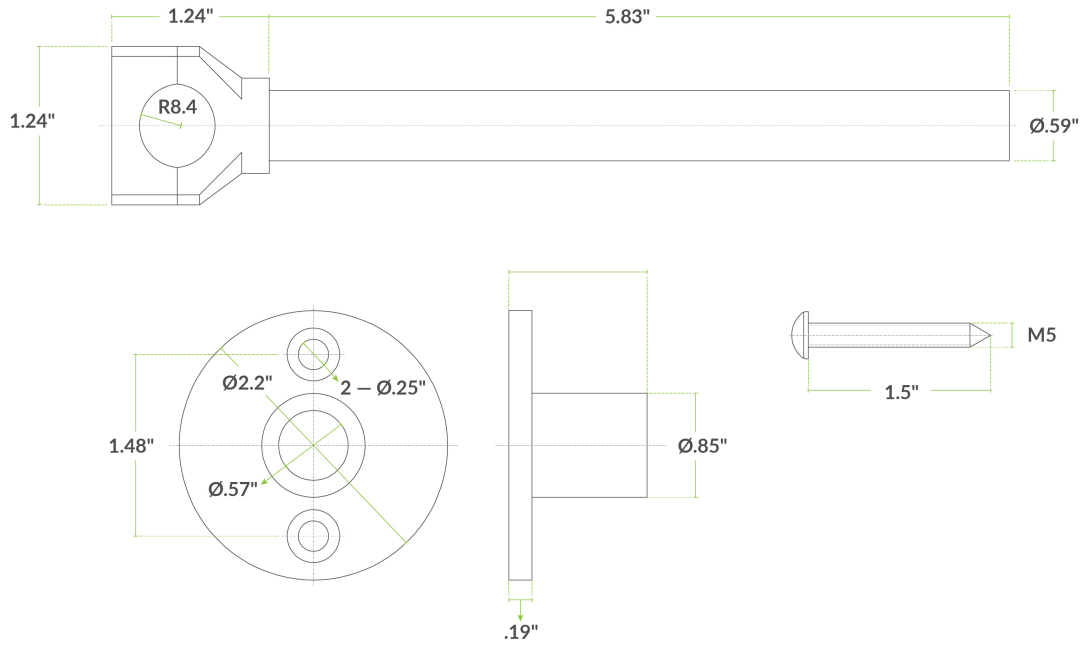

Notes & Details

This Regency 6" wall bracket assembly is perfect for use as a replacement on your pre-rinse faucet. The wall bracket is a vital part of your faucet assembly, providing a sturdy support system for the faucet riser and bracing it against your wall. This bracket measures 6" long, and is designed to fit 3/8" NPS risers on Regency pre-rinse faucets.

⚠ WARNING: This product can expose you to chemicals including lead, which are known to the State of California to cause cancer, birth defects, or other reproductive harm. For more information, go to www.p65warnings.ca.gov.