



Regency Open Stainless Steel Hose Reel with 35' x 3/8" Hose

#600HRSS35NS



Technical Data

Length	20 19/32 Inches
Width	8 3/8 Inches
Height	21 1/2 Inches
Hose Length	35 Feet
Hose Interior Diameter	3/8 Inch
Application	Air Water
Features	With Hose
Inlet Size	3/8 Inch
Material	Stainless Steel

Features

- Durable stainless steel reel houses 35' hose
- Adjustable guide arm ensures precise control
- Locking mechanism allows for locking at preferred length
- 6 3/4" wide L-shaped base has groove reinforcement to ensure stability
- Spring reducer prevents wear on the hose

Technical Data

Maximum Pressure	300 PSI
Maximum Temperature	140 Degrees F
Minimum Temperature	-4 Degrees F
Pressure	Low
PSI	300 PSI
Return Style	Retractable
Style	Open
Type	Hoses Reels

Plan View

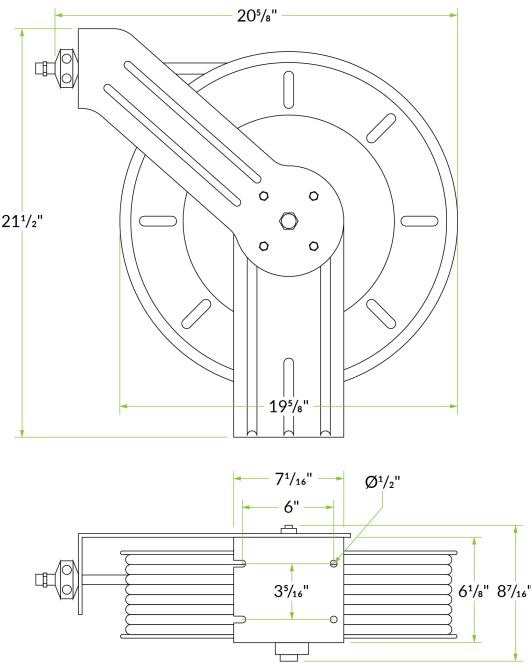

Notes & Details

Equip your business with the Regency open stainless steel hose reel with a 35' hose! The reel is constructed entirely of stainless steel to ensure safety and durability in high-demand environments such as food and chemical industries. It is designed for air and water applications, and it has a 35' hose with a 3/8" inner diameter.

The 6 3/4" wide L-shaped base has groove reinforcement to ensure stable use, while the adjustable guide arm offers multiple positions to fit a variety of needs. This allows for easier field adjustment and more precise control. The reinforced steel-stamped flange adds additional strength to the reel, while the spring reducer prevents wear to maintain the integrity of the hose. Additional features include the swivel joint that prevents leakage, and the hose stopper that can automatically stop the retracting hose. This unit has a 3/8 inlet / outlet and it is rated to 300 PSI.

**⚠ WARNING:** This product can expose you to chemicals including lead, which are known to the State of California to cause cancer and birth defects or other reproductive harm. For more information, go to [www.p65warnings.ca.gov](http://www.p65warnings.ca.gov).