



## REFRIGERATED CABINETS

### Self-Contained Dual-Zone Back Bar Refrigerators



**eco**friendly  
R290 Refrigerant

JOB	
AREA	
ITEM NO.	
MODEL NO.	



DZS60 shown with optional drawers and full extension wine shelvers



DZS36 shown with optional Draft Arms Towers

MODELS	
DZS60	2-Door Model
DZS36	1-Door Model

*Note: NSF/ANSI Standard 7 Listed for the storage and display of bottled or canned products only.*

## KEY PRODUCT FEATURES AND BENEFITS

- Patented dual zone design allows for storage of beer, white wine, or red wine to be stored at it's optimal temperature
- Stainless steel interior and top standard on all Perlick Back Bar refrigeration for long life durability and easy to clean hygienic storage
- 2" foamed-in-place eco-friendly insulation provides energy savings with zero ozone depletion
- NSF/ANSI Standard 7 Listed for open food, beverage, and garnish storage
- End wall compressor and evaporator design increases storage capacity by 14% compared to top mounted designs
- Anti-sweat heaters in cabinet face prevents condensation from forming on door, extending door gasket life and protecting flooring below from damage or slip hazards
- Multiple door styles available in any compartment
  - Choose between Glass, Stainless-Steel, Black Vinyl, or Customer Provided Overlay
  - Choose between Refrigerator Drawers or Wine Drawers

### Quick Features:

- Integrated door locks standard on all units
- Choose compressor mounted on left or right side of cabinet to match your space
- Configurable to accommodate tapping from any compartment
- NSF Rated digital controller allows for easy and precise temperature changes
- Choose between three temperature ranges
  - Refrigerator (34°F-42°F) Factory set to 38°F
  - White Wine (40°F-65°F) Factory set to 45°F
  - Red Wine (40°F-65°F) Factory set to 60°F
- Choose between 6000K white LED lighting or cool blue display lighting
- Choose between Full Length, 6" Chrome, or pull tab style handles
- Choose between flat shelving and wine racks for each compartment
- 1 Year Parts and Labor Warranty, 5 Year Compressor Warranty
- Made in USA



*Shelves and drawers not available for DZS36. Intended for dispensing kegs only.*



## REFRIGERATED CABINETS

### Self-Contained Dual-Zone Back Bar Refrigerators

MODEL NUMBERS - DZS36, DZS60

MODEL NUMBERS		DZS36	DZS60
NUMBER OF DOORS		1	2
EXTERIOR CABINET DIMENSIONS	Length - in. (mm)	36 (914)	60 (813)
	Depth - in. (mm)	24¾ (629)	24¾ (629)
	Height - in. (mm)	34½ (878)	34½ (878)
INTERIOR CABINET DIMENSIONS	Length - in. (mm)	20 (508)	44 (1118)
	Depth - in. (mm)	18¾ (476)	18¾ (476)
	Height - in. (mm)	31 (787)	31 (787)
INTERNAL VOLUME, Net. Cu. Ft. (liters)		7.1 (201)	15.0 (425)
SHIPPING WEIGHT, Lbs. (kg.)		305 (138)	380 (172)
ELECTRICAL SPECIFICATIONS	Electrical Supply	120 VAC/60 Hz/1 Ph	120 VAC/60 Hz/1 Ph
	Running Load Amps	1.8	2.5
	Electrical Connection	Cord Connected	Cord Connected
	Cord Plug Type	NEMA 5-15	NEMA 5-15
	Cord Length	8'	8'
	Defrost Initiation	Automatic	Automatic
	Defrost Type	Off Cycle	Off Cycle
	Thermostat	Digital Control	Digital Control
	Lighting Type	None	LED
REFRIGERATION SPECIFICATIONS	Horsepower	1/6	1/5
	Refrigerant	R290	R290
	Refrigerant Charge (grams)	90	100
	Heat Rejection at 75F BTU/hr	900	1900
	Factory Temperature Setting - Refrigerator F (C)	36° (3.3°)	36° (3.3°)
	Temperature Range - Refrigerator F (C)	34°-42° (1.1°-5.6°)	34°-42° (1.1°-5.6°)
	Factory Temperature Setting - White Wine F (C)	45° (7.2°)	45° (7.2°)
	Factory Temperature Setting - Red Wine F (C)	60° (15.6°)	60° (15.6°)
	Temperature Range - Wine F (C)	40°-60° (4.4°-15.6°)	44°-65° (6.7°-18.3°)
	Condensing Unit Location	Left or Right	Left or Right
	Expansion Device	Capillary Tube	Capillary Tube
	Pull-Out Condensing Unit	Yes	Yes
	Front Vented	Yes	Yes
PLUMBING	Floor Drain Included	No	Yes
	Evaporator Condensate	Automatically	Automatically



## REFRIGERATED CABINETS

### Self-Contained Dual-Zone Back Bar Refrigerators

# 60" DUAL ZONE

DZS60  
UNIT RIGHT

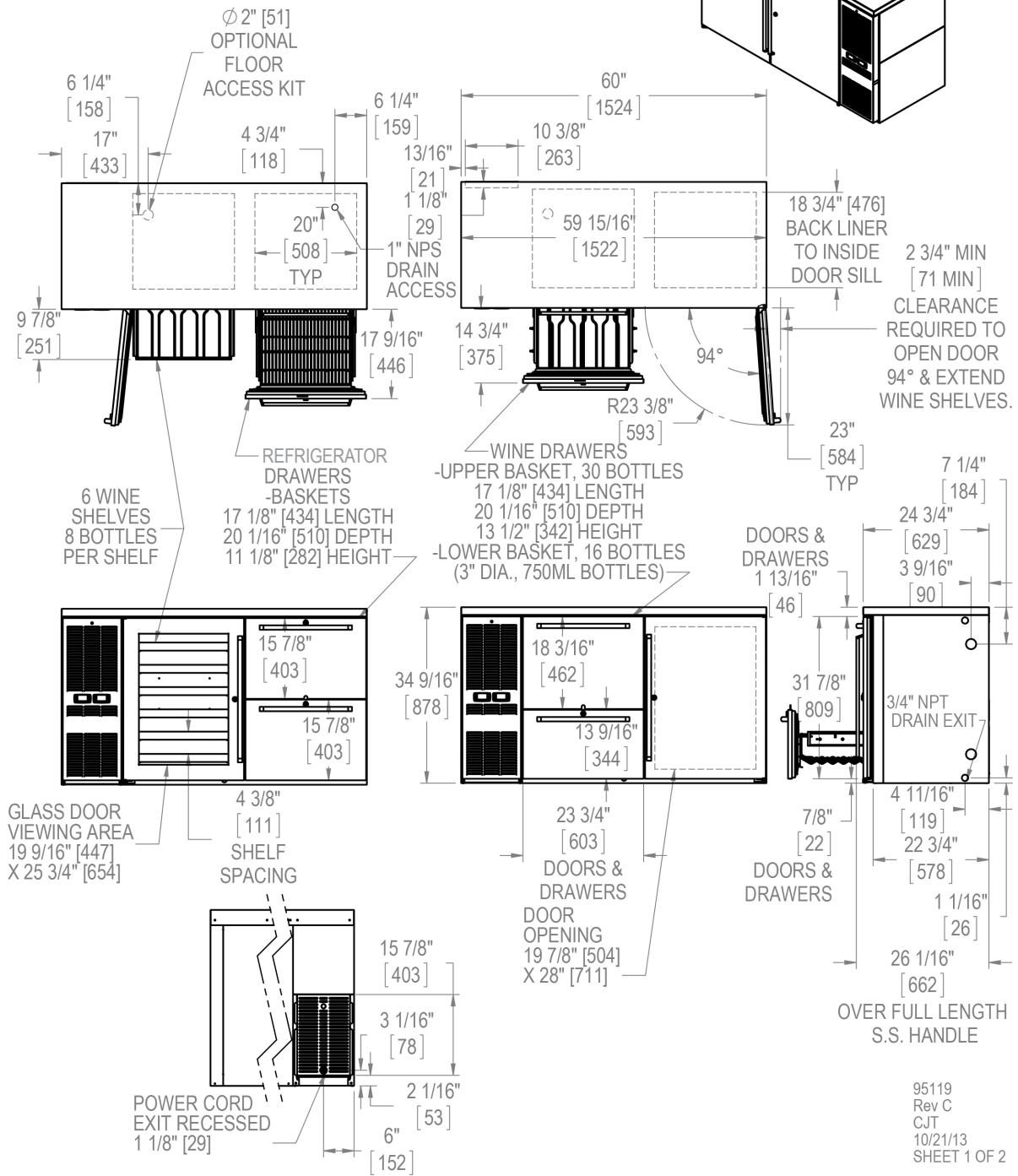

#### California Prop 65 Notice:



**WARNING:** The materials used in this product may contain chemicals known to the State of California to cause cancer and birth defects or other reproductive harm. For more information go to [www.P65Warnings.ca.gov](http://www.P65Warnings.ca.gov).

Form No. Z2602  
Rev. 04.22.2021



## REFRIGERATED CABINETS

### Self-Contained Dual-Zone Back Bar Refrigerators

## 36" DUAL ZONE

**DZS36**  
UNIT LEFT  
with 4 faucet  
Tee Tower.

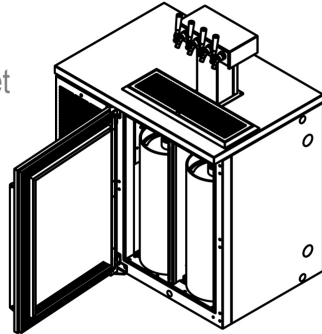

**DZS36**  
UNIT RIGHT  
with (2) 2 faucet  
Draft Arms.

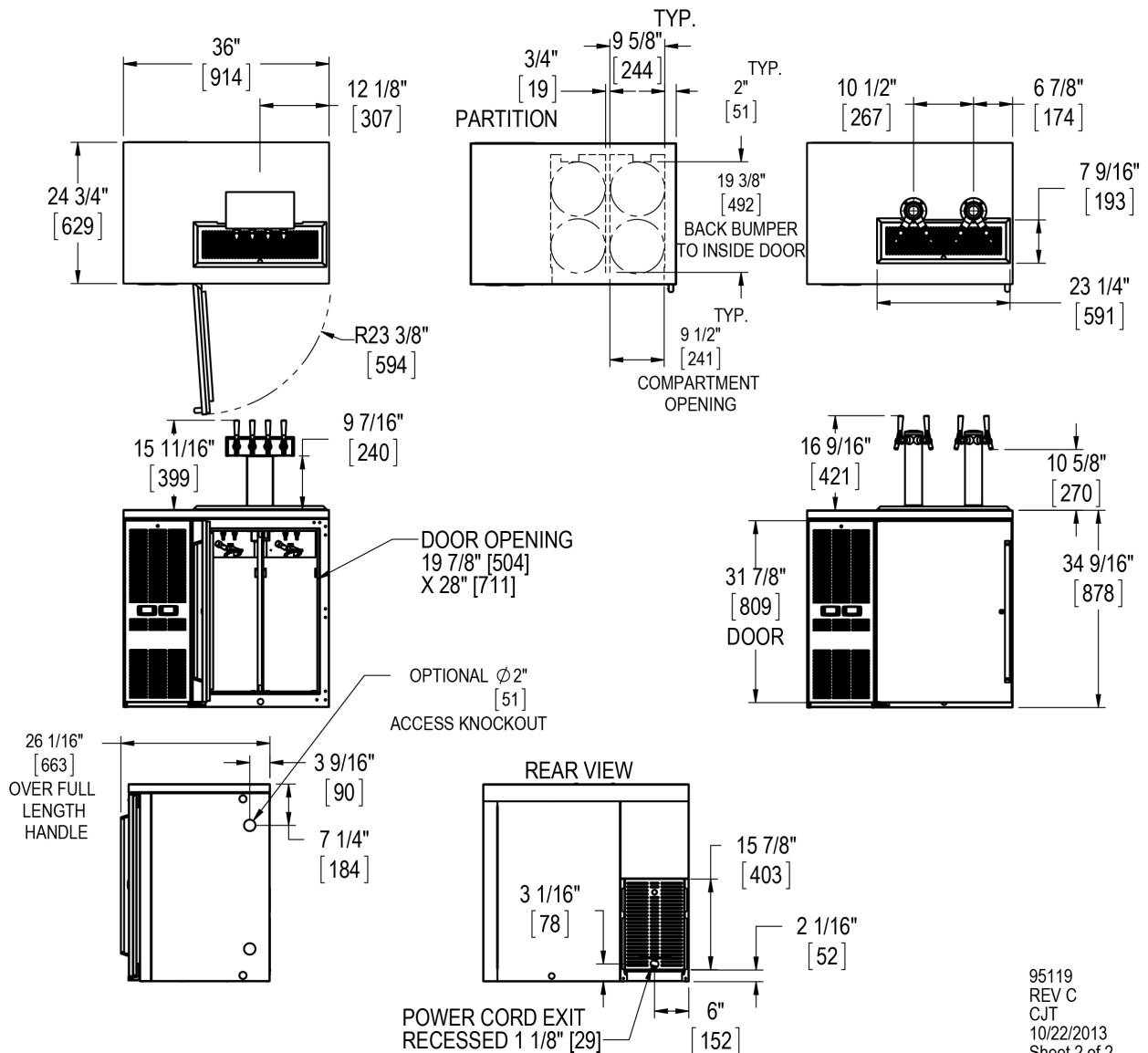
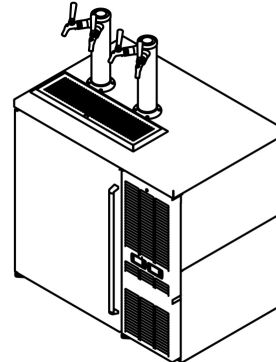

95119  
REV C  
CJT  
10/22/2013  
Sheet 2 of 2

#### California Prop 65 Notice:



**WARNING:** The materials used in this product may contain chemicals known to the State of California to cause cancer and birth defects or other reproductive harm. For more information go to [www.P65Warnings.ca.gov](http://www.P65Warnings.ca.gov).

Form No. Z2602  
Rev. 04.22.2021