



Oxygen-Supreme

EXPERIENCE UNPARALLELED AIR FRESHNESS



TECHNICAL SHEET



Oxygen-Supreme
White Dispenser



Oxygen-Supreme
Black Dispenser



Grande Cartridge
30/60/90 Days

Oxygen-Supreme's new stylish design is perfect for each facility. Available in a range of colors and striking finishes with new two tone possibilities, the Oxygen-Supreme System will elevate the image of your washrooms, offices, reception areas, conference rooms and more.

Oxygen-Supreme Dispenser Features

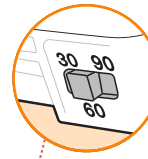
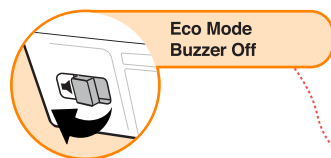
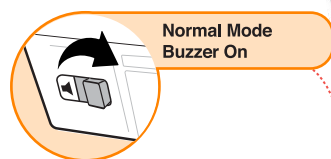
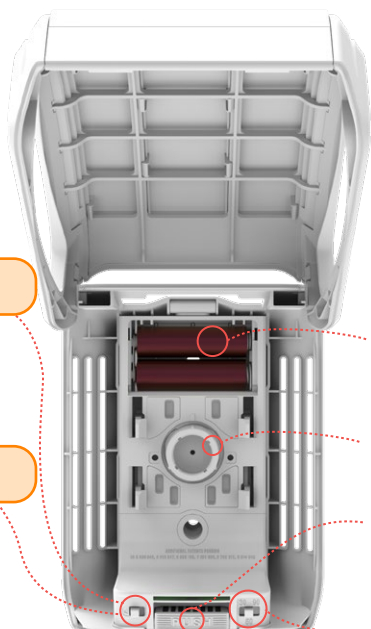
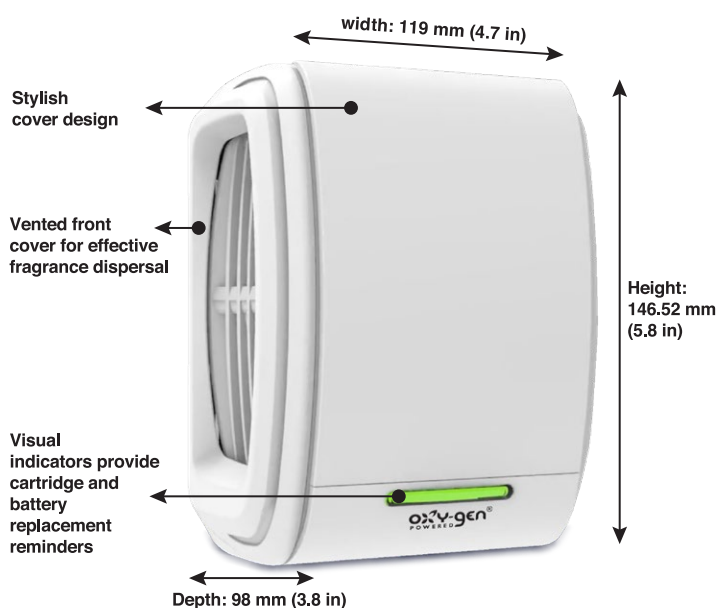

Select the required
30/60/90 days setting.

- Supplied with 2 double sided tapes
- Operates on 2 AA alkaline batteries (not included) that last for up to 1 year
- Made of 100% recyclable plastic

Dispenser	Code	
Oxygen-Supreme 30/60/90 days programmable Dispenser - White	U-301-ST-001-PB-AABB-001	
Weight & Dimension - Dispenser Unit Pack - 1 Piece		
Unit Pack weight	447.03 g	
Unit Pack dimensions (L x W x H)	12 cm x 10 cm x 15.2 cm 4.7 in x 3.9 in x 5.9 in	
Weight & Dimension - Dispensers Per Case		
Weight	2.9 kg	
Dispenser per case	6 Dispensers	
Dimensions (L x W x H)	31.5 cm x 25 cm x 16.7 cm 12.4 in x 9.8 in x 6.6 in	
Weight & Dimension - Dispensers Cases Per Pallet		
	Standard Pallet	Euro Pallet
Weight	486.5 kg	384 kg
Cases/Pallet	165 Cases	121 Cases
Unit/Pallet	990 Dispensers	726 Dispensers
Dimensions (L x W x H)	120 cm x 100 cm x 205 cm 47.2 in x 39.3 in x 80.7 in	120 cm x 80 cm x 205 cm 47.2 in x 31.4 in x 80.7 in
No. of Rows	11 Rows	11 Rows
No. of Cases/Row:	15 Cases	11 Cases

DISPENSER PROGRAM SETTINGS

Use the Normal-Eco Mode switch to change the dispenser from Normal Mode to Eco Mode. A dispenser operating in the Eco Mode offers considerable battery savings by disabling the light and buzzer alerts during the cartridge cycle.

GREEN LIGHT - SUCCESSFUL INSTALLATION

NORMAL MODE

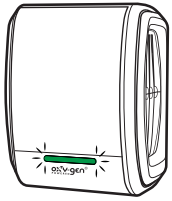

Green light flashing for the first 2 minutes after cartridge installation indicates proper installation. After initial 2 mins it will flash every 5 mins

1 flashing light indicates a 1 month (30 days) setting.

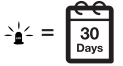

2 flashing lights indicate a 2 month (60 days) setting.



3 flashing lights indicate a 3 month (90 days) setting.

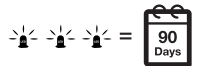

ECO MODE

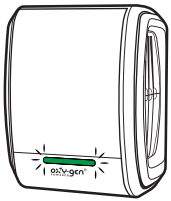

Green light flashing for the first 2 minutes after cartridge installation indicates proper installation. After initial 2 mins it will flash every 5 mins.

To check if the dispenser is functioning properly, the Normal-Eco Mode Switch can be toggled by moving the switch to Normal Mode and then bringing it back to the Eco Mode position.

ORANGE LIGHT- REPLACE CARTRIDGE

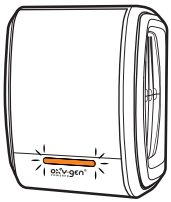

Orange light flashing indicates that the cartridge is empty. Replace immediately.

RED LIGHT- REPLACE BATTERIES

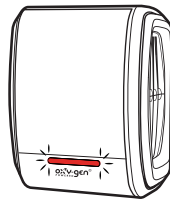

Red light flashing indicates that the batteries need to be replaced.



In the **Normal Mode** if the cartridge is not replaced within 7 days, the buzzer activates and will beep every 30 seconds. There is no buzzer in **Eco Mode**.

- Standard dispensers are key-less dispensers (push-button).
- Optional Key-Access system available upon request (1 Key per dispenser).

TO OPERATE

Step 1 Open the dispenser

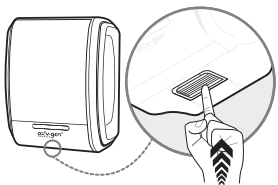

Open the dispenser by pushing the button at the bottom (or with a key for key lock dispenser).

Step 2 Insert the battery



Open the battery compartment and insert two AA alkaline batteries.

Step 3 Remove the paper sleeve

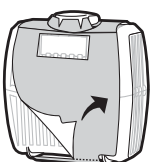

Remove the protective paper sleeve and discard it.

Step 4 Activate the cartridge

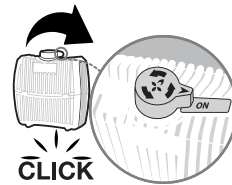

Activate the cartridge by rotating the cap counter-clockwise to 'ON' position until it clicks. Make sure the cap is pointing towards 'ON'.

Step 5 Insert the cartridge into the dispenser

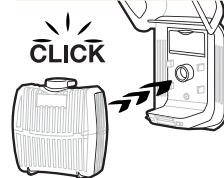

Push the cartridge firmly into the dispenser, until it locks into place.

Step 6 Eject the cartridge

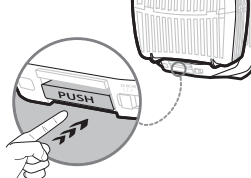

To replace the cartridge press the push button to release the cartridge.

Oxygen-Supreme Cartridge Features



Grande Cartridge 30/60/90 Days

Sealed fragrance reservoir - When activated, the reservoir releases the fragrance oil gradually and continuously.

Grande Cartridge	CODE
adore	U-201G-001-AABB-AE
bloom	U-201G-001-AABB-BM
charm	U-201G-001-AABB-CM
crush	U-201G-001-AABB-CH
elan	U-201G-001-AABB-EN
elate	U-201G-001-AABB-EE
flair	U-201G-001-AABB-FR
glow	U-201G-001-AABB-GW
glee	U-201G-001-AABB-GE
spa	U-201G-001-AABB-SA
spring	U-201G-001-AABB-SP
tang	U-201G-001-AABB-TG
verde	U-201G-001-AABB-VE
vita	U-201G-001-AABB-VA
zeal	U-201G-001-AABB-ZL
zing	U-201G-001-AABB-ZG
neutra-tox super	U-201G-001-AABB-NL
bleer' natural	U-201G-001-AABB-KR

Weight & Dimension - Per Grande Cartridge		
Weight	149.68 g	
Dimensions (L x W x H)	11.2 cm x 5.9 cm x 11.8 cm 4.4 in x 2.3 in x 4.7 in	
Weight & Dimension - Cartridge Per Case		
Weight	1.03 kg	
Cartridges per Case	6 Cartridges	
Dimensions (L x W x H)	22.8 cm x 19 cm x 13.1 cm 8.9 in x 7.5 in x 5.2 in	
Weight & Dimension - Cartridges Per Pallet		
	Standard Pallet	Euro Pallet
Weight	411.35 kg	347 kg
Cases/Pallet	390 Cases	315 Cases
Unit/Pallet	2340 Cartridges	1890 Cartridges
Dimensions (L x W x H)	120 cm x 100 cm x 210 cm 47.2 in x 39.3 in x 82.7 in	120 cm x 80 cm x 210 cm 47.2 in x 31.4 in x 82.7 in
No. of Rows	15 Rows	15 Rows
No. of Cases/Row:	26 Cases	21 Cases

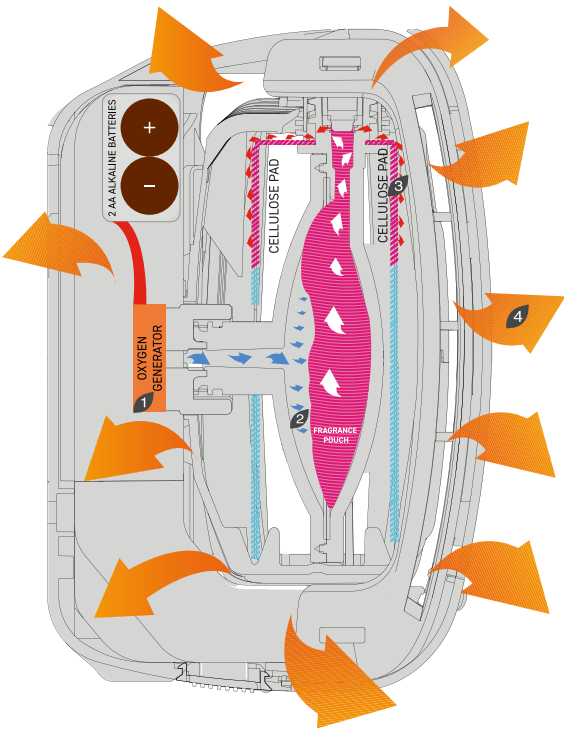

1. The oxygen generator continuously releases a precise dose of oxygen, non-stop.
2. The oxygen squeezes the fragrance pouch, displacing the fragrance.
3. A continuous measured dose of fragrance is delivered on to the cellulose pad.
4. Pure fresh fragrance is released into the room.



FRAGRANCE DELIVERY TECHNOLOGIES LTD.
P.O. Box No. 262800, Dubai, UAE
USA | UK | EUROPE | UAE
www.oxygenpowered.com
ISO 9001:2015 Certified Organisation