

Project: \_\_\_\_\_

Item #: \_\_\_\_\_

**Panasonic****NE-12523****1200 WATT\* COMMERCIAL MICROWAVE OVEN****FOOD SERVICE  
EQUIPMENT****PRO1**[www.panasonic.com/CMO](http://www.panasonic.com/CMO)

## UPGRADE YOUR PERFORMANCE with PRO1:

Quickly achieve delicious, consistent product your clients will love in a fraction of time.

- **Higher Wattage:** Quicker, more efficient operation—and better retains foods' nutrients!
- **Programmable:** Same flavorful outcome every time
- **Additional Power Levels and Multi-stage Cooking:** Best showcase flavor in food
- Enhanced diagnostics, enhanced heating elements
- Auto voltage switching

SPECIFICATIONS	NE-12523
Power Source:	120V, 60Hz, Single Phase
Receptacle Required:	NEMA 5-20
Frequency:	2,450MHz
Required Power:	17.3A
Output:	1200 Watts*
Outer Dimensions: (w x d x h)	16-5/8" x 20" x 13-1/8"
Cavity Dimensions: (w x d x h)	13" x 12-7/32" x 6-1/8"
Net Weight:	59 lbs.
Shipping Weight:	65 lbs.
Shipping Box Size: (w x d x h)	19-15/16" x 24-1/8" x 16-7/8" 4.7 cu. ft.
Timer:	Maximum times for each stage of cooking: Times vary for each (of 15) power levels (See Manual)
Memory Capability:	30 Programs

The NE-12523 commercial microwave meets or exceeds all safety performance and sanitation standards set for commercial food service microwave ovens by UL, HHS, FCC and NSF.



NEMA 5-20



**Panasonic Commercial Food Service**  
Division of Panasonic Corporation of  
North America  
2 Riverfront Plaza | Newark, NJ 07102  
(201) 348-7000  
[www.panasonic.com/cmo](http://www.panasonic.com/cmo)

## PERFECT FOR

- Quick serve and casual dining applications
- Chef's line
- Over shelf
- High volume application where space is at a premium
- Fast 1/2 pan cooking/re-therm

## PERFORMANCE

- 1200 Watt power
- 15 Power levels
- 30 memory capability
- 5-stage cooking
- Controllable LED lights
- 2 magnetrons (heating elements)
- One-Touch start feature
- Independent top/bottom energy feed control

## ADDITIONAL FEATURES

- 0.6 cubic feet capacity
- 16-5/8" wide
- Fits 1 half-size 6" deep steam table pan/cover
- Quick-clean stainless steel cabinet + cavity
- Compact size, heavy-duty performance
- Cycle counter
- Programmable lock
- Easy-clean air filter with reminder
- Patented safety door seal system
- See-through oven door
- Removable ceiling splatter shield
- Digital display
- Stackable
- 120V

## MAINTENANCE

- Enhanced diagnostics
- Warranty: 3 years parts and labor  
3 years magnetron

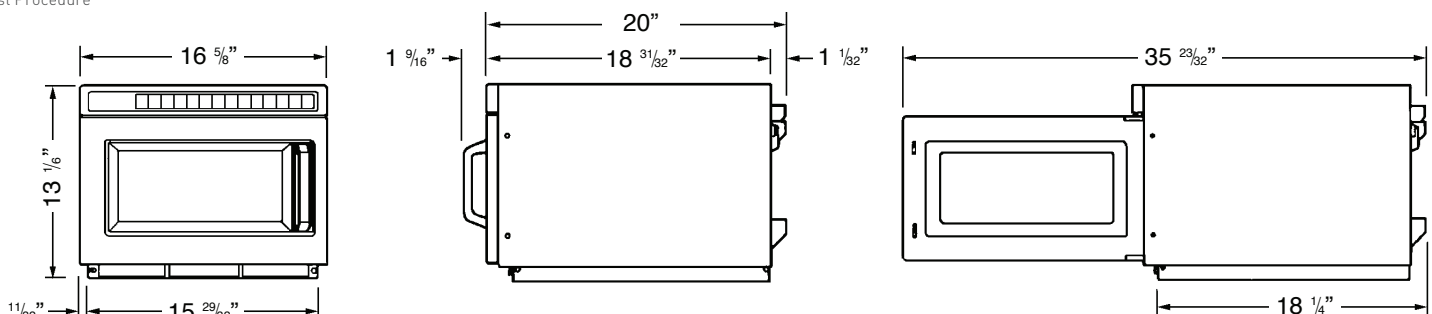

\*IEC 705 Test Procedure