



Jonti-Craft® Dual Writing Desk - 9522JC



This dual writing desk empowers young learners to develop their writing skills. Perfect for practicing penmanship, journaling, drawing and more. Fits two students with ample workspace as well as storage for supplies, including upper shelf with rail. Desktop height is 21" from the floor. KYDZSafe® edges. KYDZStrong® construction. KYDZTuff® finish. Ready-to-Assemble. GREENGUARD Gold certified. CARB II & CPSIA compliant. Lifetime warranty.

Item: 9522JC

36" W x 24" D x 38.5" H

Ship Weight: 57 lbs

Warranty: Lifetime

Ready-to-Assemble

Made in United States

 KYDZ Safe.

 KYDZ Strong.

 KYDZ Tuff.





JonTi-Craft® Dual Writing Desk - 9522JC

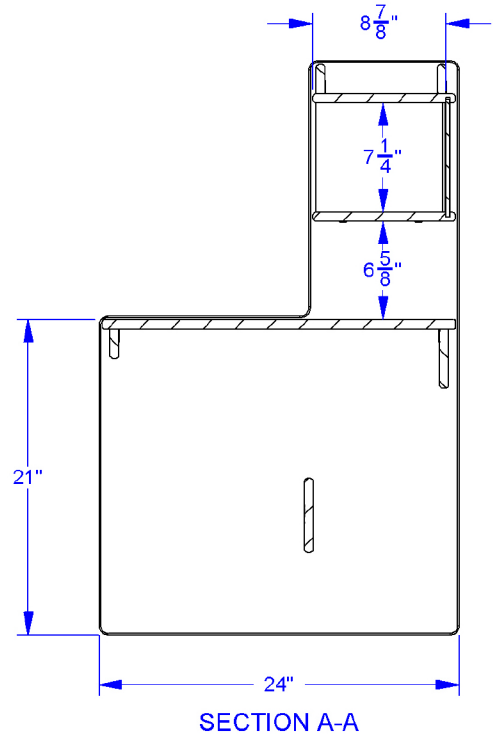
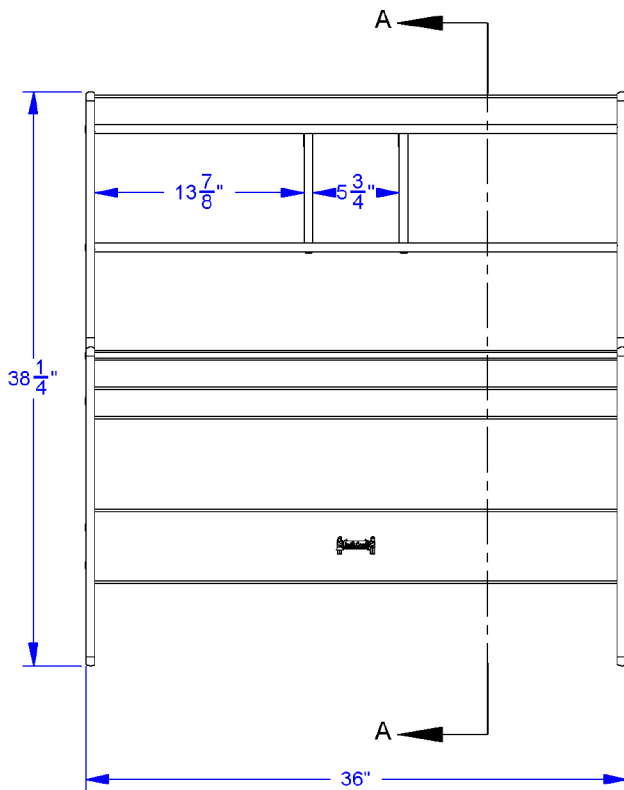

JonTi-Craft Flagship Features Include:

KYDZSafe corners & edges are rounded to minimum of 1/2" radius. KYDZSafe kickplates prevent pinching & lost objects. KYDZSafe 15" depth adds increased stability & 25% more storage than competitor's 12" depth. KYDZStrong materials are guaranteed to last. KYDZStrong dowel-pin construction adds stability & strength. KYDZStrong Recessed backs give stability & structural integrity. KYDZTuff acrylic finish is ultra-long lasting and resists yellowing. The UV coating is environmentally friendly and easy to clean with an extra-strong resistance to daily wear and common cleaning products, like bleach and nail polish remover.