



## Jonti-Craft® High Chairries® Premium Tray - 5" Seat Height - 6820JC

Item: 6820JC



22" W x 22" D x 15.5" H

Ship Weight: 14 lbs

Warranty: Lifetime

Fully Assembled

Made in United States

 **KYDZ Safe.**

 **KYDZ Strong.**

 **KYDZ Tuff.**

High Chairries® are a smart and versatile choice for any early education environment. Designed to make feeding and clean-up a snap, the High Chairries feature a durable 22" wide x 17" deep stain-resistant, FDA Approved and BPA-free plastic tray that has 126% more surface space. The raised lip helps contain spills and can hold up to a half gallon of liquid. A removable and adjustable 3-point seat belt makes for easy cleaning and an excellent fit. Available in multiple seat heights. KYDZSafe® edges. KYDZStrong® construction. KYDZTuff® finish. FDA approved. BPA-free materials. GREENGUARD Gold certified. CARB II & CPSIA compliant.





# Jonti-Craft® High Chairries® Premium Tray - 5" Seat Height - 6820JC

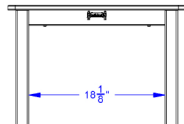
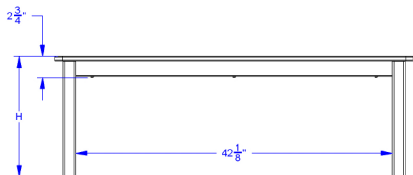
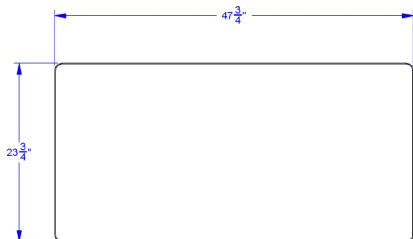

## Jonti-Craft Flagship Features Include:

KYDZSafe corners & edges are rounded to minimum of  $\frac{1}{2}$ " radius. KYDZSafe kickplates prevent pinching & lost objects. KYDZSafe 15" depth adds increased stability & 25% more storage than competitor's 12" depth. KYDZStrong materials are guaranteed to last. KYDZStrong dowel-pin construction adds stability & strength. KYDZStrong Recessed backs give stability & structural integrity. KYDZTuff acrylic finish is ultra-long lasting and resists yellowing. The UV coating is environmentally friendly and easy to clean with an extra-strong resistance to daily wear and common cleaning products, like bleach and nail polish remover.