



003	004	005
Blue	Purple	Teal
007	008	112
Yellow	Red	Navy
114	119	180
Orange	Green	Black

Two adjustable shelves, easily adjusted in 1¼" increments, are 35" wide x 21" deep. Lockable doors, keys included. KYDZSafe® edges. KYDZStrong® construction. KYDZHinges®. TRUEdge®. Constructed of 5/8" thick freckled-gray Thermally Fused Laminate (TFL). Lockable doors. Stationary.

36" W x 24" D x 72" H

Ship Weight: 240 lbs

Warranty: Lifetime

Fully Assembled

Made in United States

 KYDZ Safe.

 KYDZ Strong.

 KYDZ Hinges.

 TRU Edge.



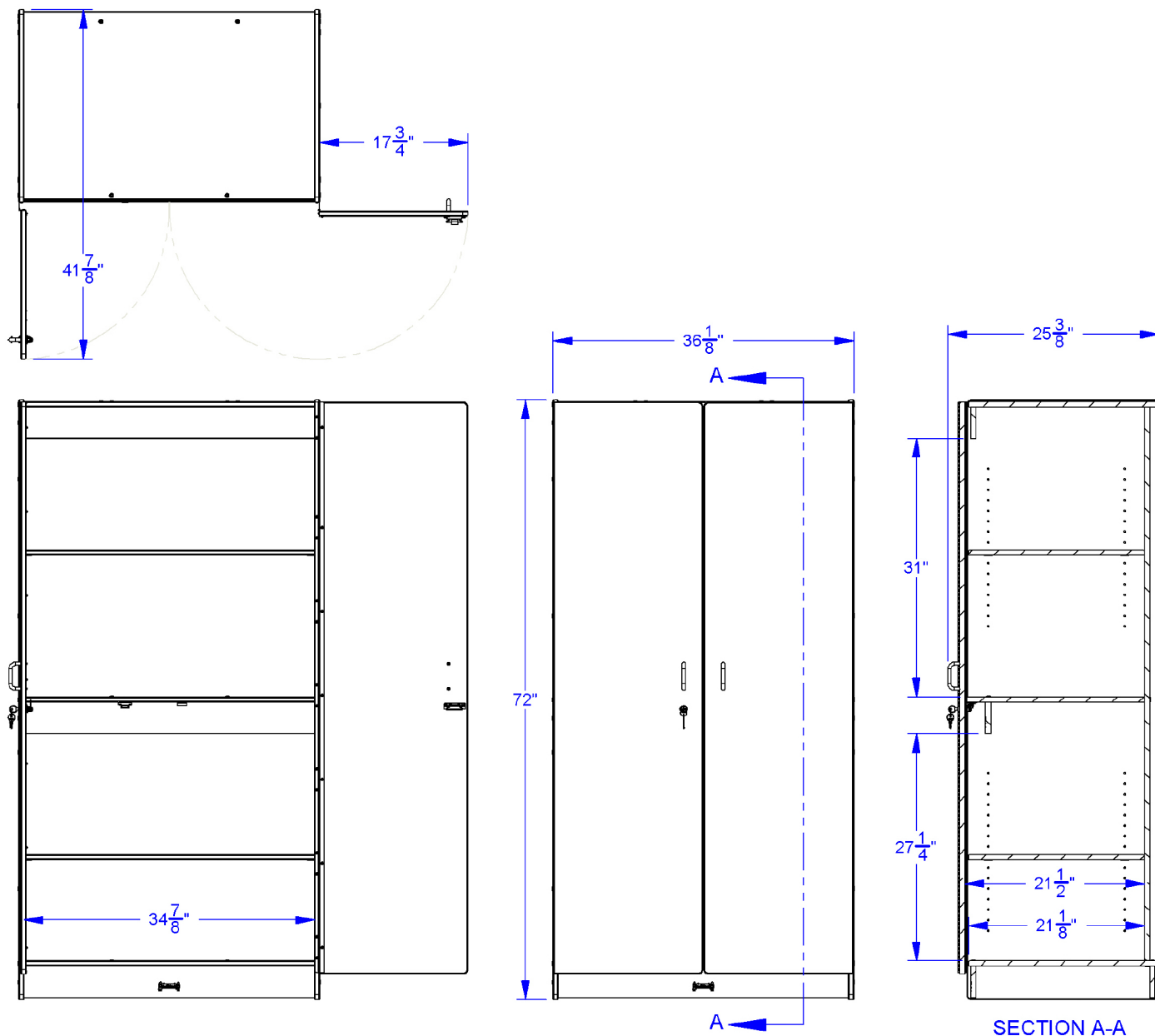

Jonti-Craft Flagship Features Include:

KYDZSafe corners & edges are rounded to minimum of $\frac{1}{2}"$ radius. KYDZSafe kickplates prevent pinching & lost objects. KYDZSafe 15" depth adds increased stability & 25% more storage than competitor's 12" depth. KYDZStrong materials are guaranteed to last. KYDZStrong dowel-pin construction adds stability & strength. KYDZStrong Recessed backs give stability & structural integrity. KYDZHinges piano hinges prevent pinching. KYDZHinges are attached with no less than nine screws and allow doors to open to 270 degrees. TRUEdge is permanently thermo-fused to furniture, is moisture-resistant, and prevents germs from getting into the board. TRUEdge also comes in multiple colors.