



Provide maximum storage space for backpacks and other items with this triple stack of lockers featuring 12 individual lockers. Different locks and keys for secured lockers. Individual lockers are 10.5" wide x 12.5" deep x 20" high. Stacked lockers must be fastened to a wall. Note: The unit has four small holes and threaded inserts through the top for stacking units. KYDZSafe® edges. KYDZStrong® construction. KYDZHinges®. TRUEdge®. Constructed of 5/8" thick freckled-gray Thermally Fused Laminate (TFL). Stationary.

48.5" W x 15" D x 67" H

Ship Weight: 281 lbs

Warranty: Lifetime

Minimal Assembly

Made in United States

 **KYDZ Safe.**

 **KYDZ Strong.**

 **KYDZ Hinges.**

 **TRUEdge.**



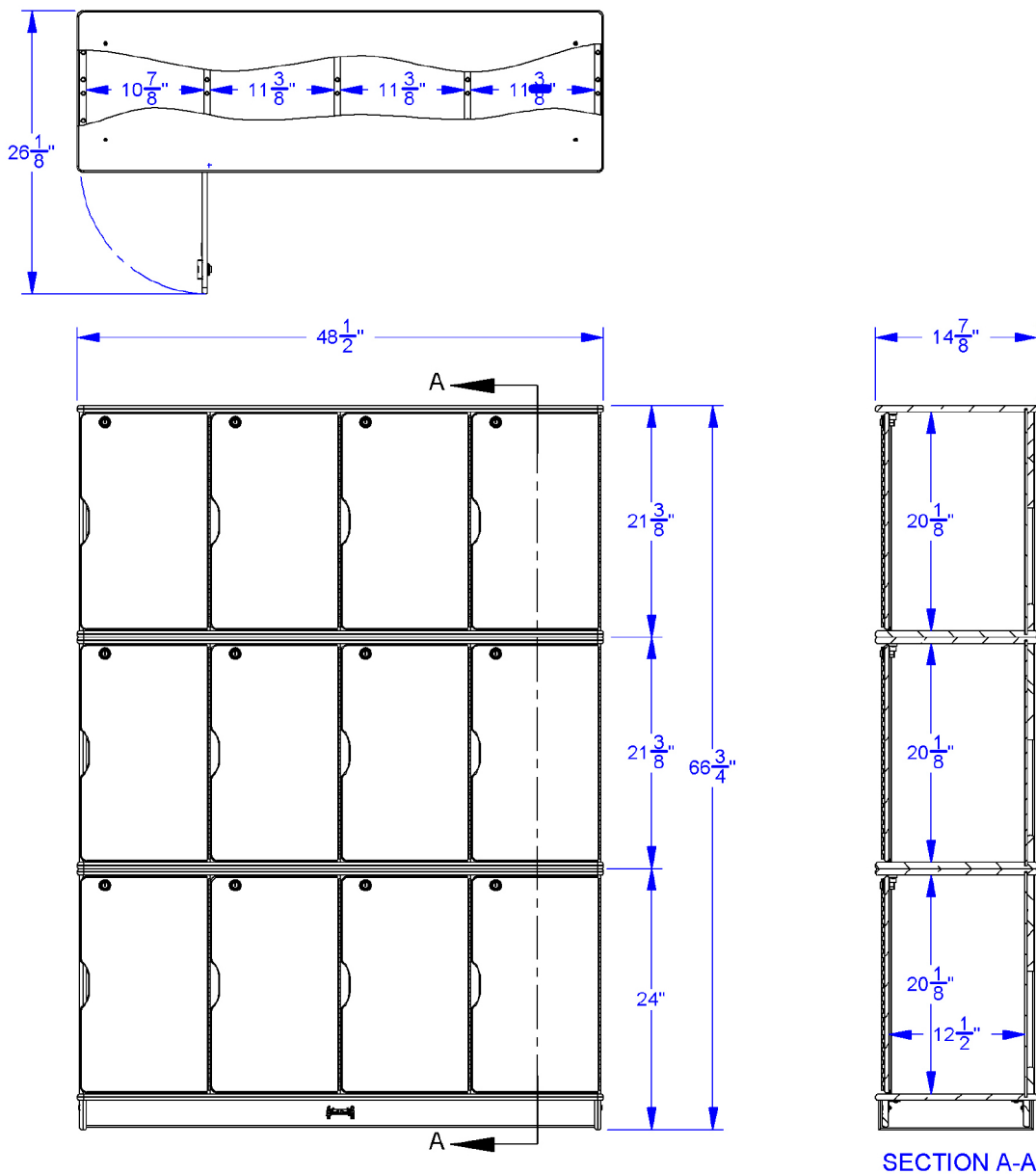

Jonti-Craft Flagship Features Include:

KYDZSafe corners & edges are rounded to minimum of $\frac{1}{2}"$ radius. KYDZSafe kickplates prevent pinching & lost objects. KYDZSafe 15" depth adds increased stability & 25% more storage than competitor's 12" depth. KYDZStrong materials are guaranteed to last. KYDZStrong dowel-pin construction adds stability & strength. KYDZStrong Recessed backs give stability & structural integrity. KYDZHinges piano hinges prevent pinching. KYDZHinges are attached with no less than nine screws and allow doors to open to 270 degrees. TRUEdge is permanently thermo-fused to furniture, is moisture-resistant, and prevents germs from getting into the board. TRUEdge also comes in multiple colors.