



## Jonti-Craft® 10 Cubbie-Tray Mobile Unit - without Trays - 0610JC



This mobile unit with ten cubbie-tray openings is ideal for small classrooms or limited space. KYDZSafe® edges. KYDZStrong® construction. KYDZTuff® finish. MAXBracket®. Standard bin colors are a mix of red, blue, yellow, green and orange. Contact your Jonti-Craft dealer for specific bin colors. Back options available.

Item: 0610JC

20" W x 15" D x 35.5" H

Ship Weight: 59 lbs

Warranty: Lifetime

Fully Assembled

Made in United States

**KYDZ** Safe.

**KYDZ** Strong.

**KYDZ** Tuff.

**MAX** Bracket.







# Jonti-Craft® 10 Cubbie-Tray Mobile Unit - without Trays - 0610JC

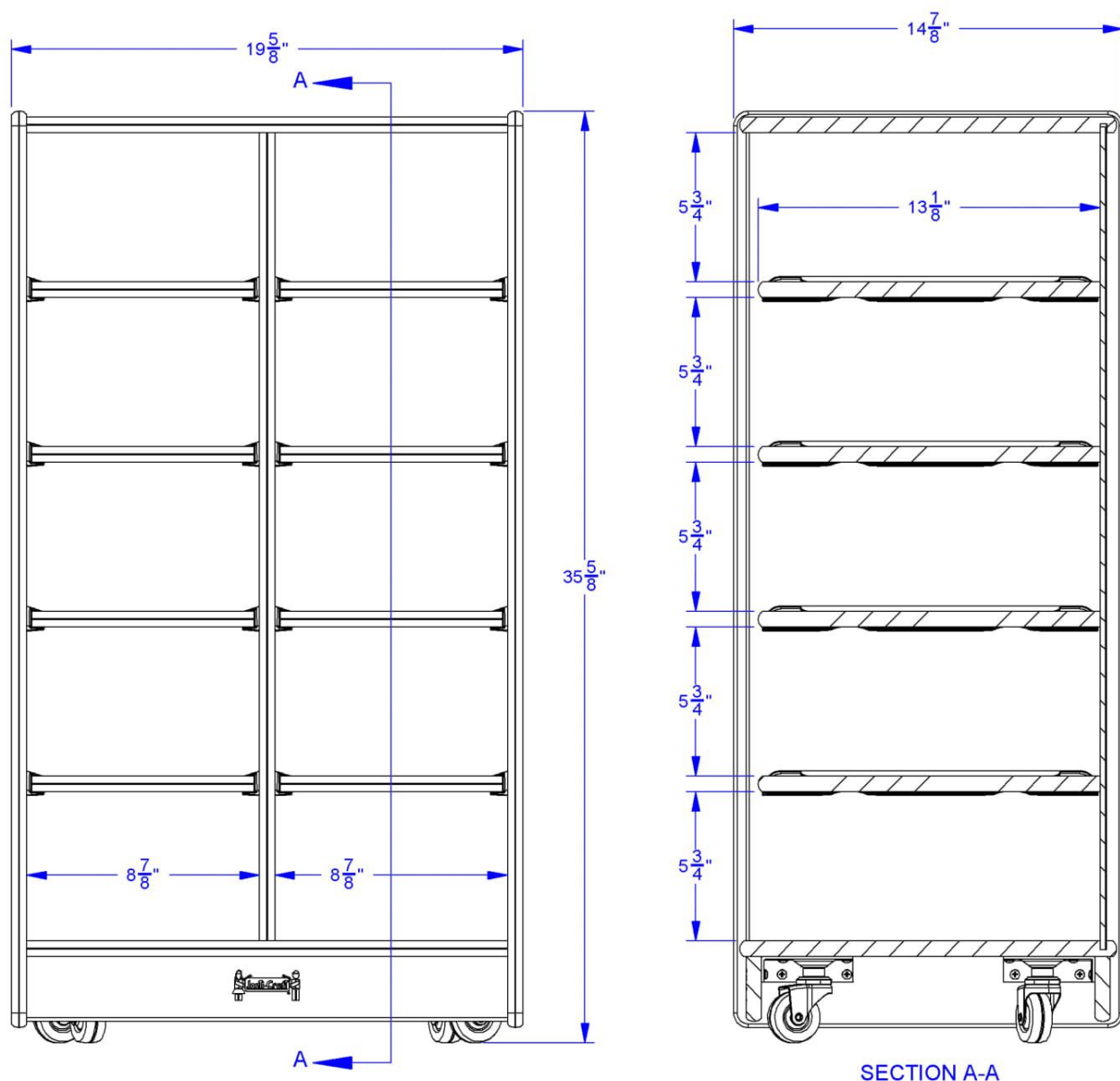

## Jonti-Craft Flagship Features Include:

KYDZSafe corners & edges are rounded to minimum of  $\frac{1}{2}"$  radius. KYDZSafe kickplates prevent pinching & lost objects. KYDZSafe 15" depth adds increased stability & 25% more storage than competitor's 12" depth. KYDZStrong materials are guaranteed to last. KYDZStrong dowel-pin construction adds stability & strength. KYDZStrong Recessed backs give stability & structural integrity. KYDZTuff acrylic finish is ultra-long lasting and resists yellowing. The UV coating is environmentally friendly and easy to clean with an extra-strong resistance to daily wear and common cleaning products, like bleach and nail polish remover. MAXBrackets are heavy-duty casters that make it easy to support and move furniture. Wheels are made of hard, non-marking rubber and a three-point-connection bracket adds triangular strength.