



## Jonti-Craft® Open Shelf - 0530JC



Deep shelves hold even the largest play items on this stationary unit. And open front and back makes access from either side easy. KYDZSafe® edges. KYDZStrong® construction. KYDZTuff® finish.

Item: 0530JC

36" W x 15" D x 29" H

Ship Weight: 47 lbs

Warranty: Lifetime

Fully Assembled

Made in United States

 **KYDZ Safe.**

 **KYDZ Strong.**

 **KYDZ Tuff.**





## Jonti-Craft® Open Shelf - 0530JC

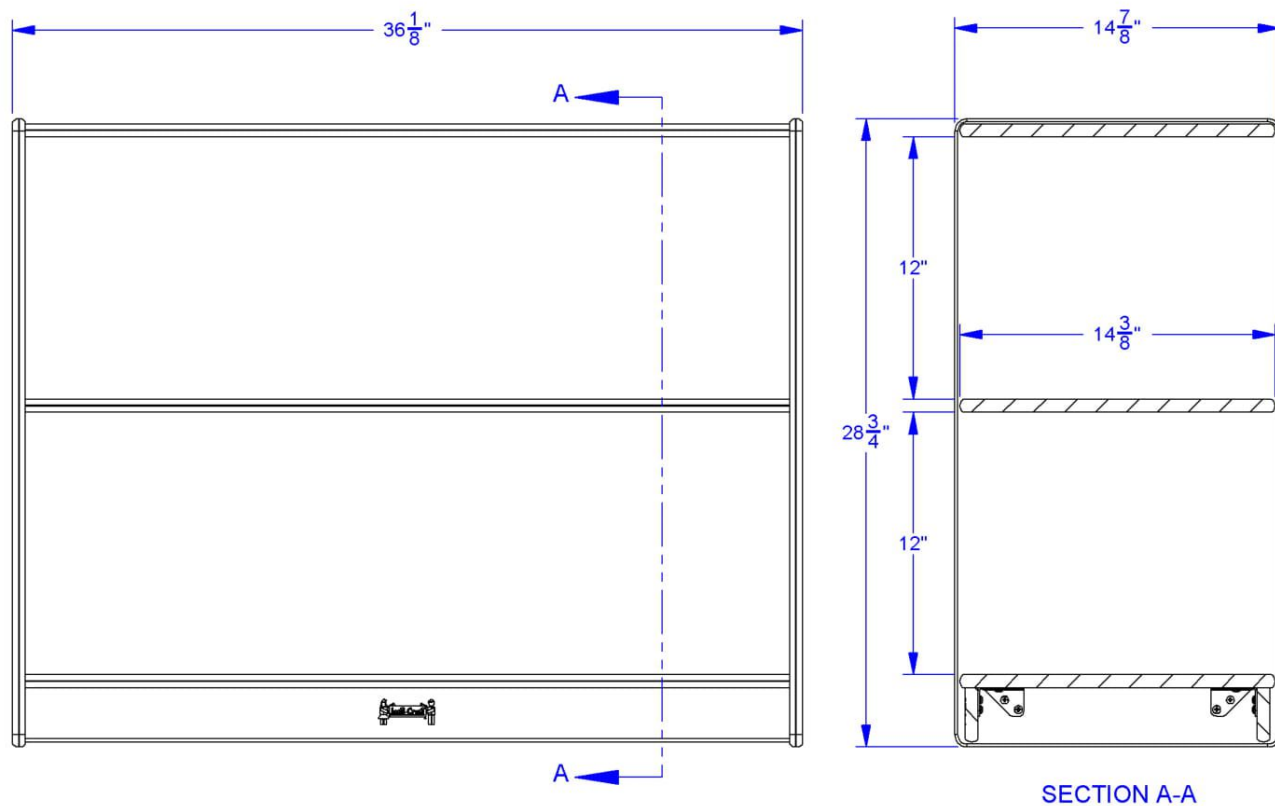

### Jonti-Craft Flagship Features Include:

KYDZSafe corners & edges are rounded to minimum of  $\frac{1}{2}"$  radius. KYDZSafe kickplates prevent pinching & lost objects. KYDZSafe 15" depth adds increased stability & 25% more storage than competitor's 12" depth. KYDZStrong materials are guaranteed to last. KYDZStrong dowel-pin construction adds stability & strength. KYDZStrong Recessed backs give stability & structural integrity. KYDZTuff acrylic finish is ultra-long lasting and resists yellowing. The UV coating is environmentally friendly and easy to clean with an extra-strong resistance to daily wear and common cleaning products, like bleach and nail polish remover.