



# JonTi-Craft® Space-Saver Mobile Straight-Shelf - 0450JC



Great for books or unit blocks this space-saving storage unit is perfect for tight spaces. KYDZSafe® edges. KYDZStrong® construction. KYDZTuff® finish. Back options available. MAXBracket®.

Item: 0450JC

24" W x 15" D x 35.5" H

Ship Weight: 46 lbs

Warranty: Lifetime

Fully Assembled

Made in United States

**KYDZ** Safe.

**KYDZ** Strong.

**KYDZ** Tuff.

**MAX** Bracket.





# Jonti-Craft® Space-Saver Mobile Straight-Shelf - 0450JC

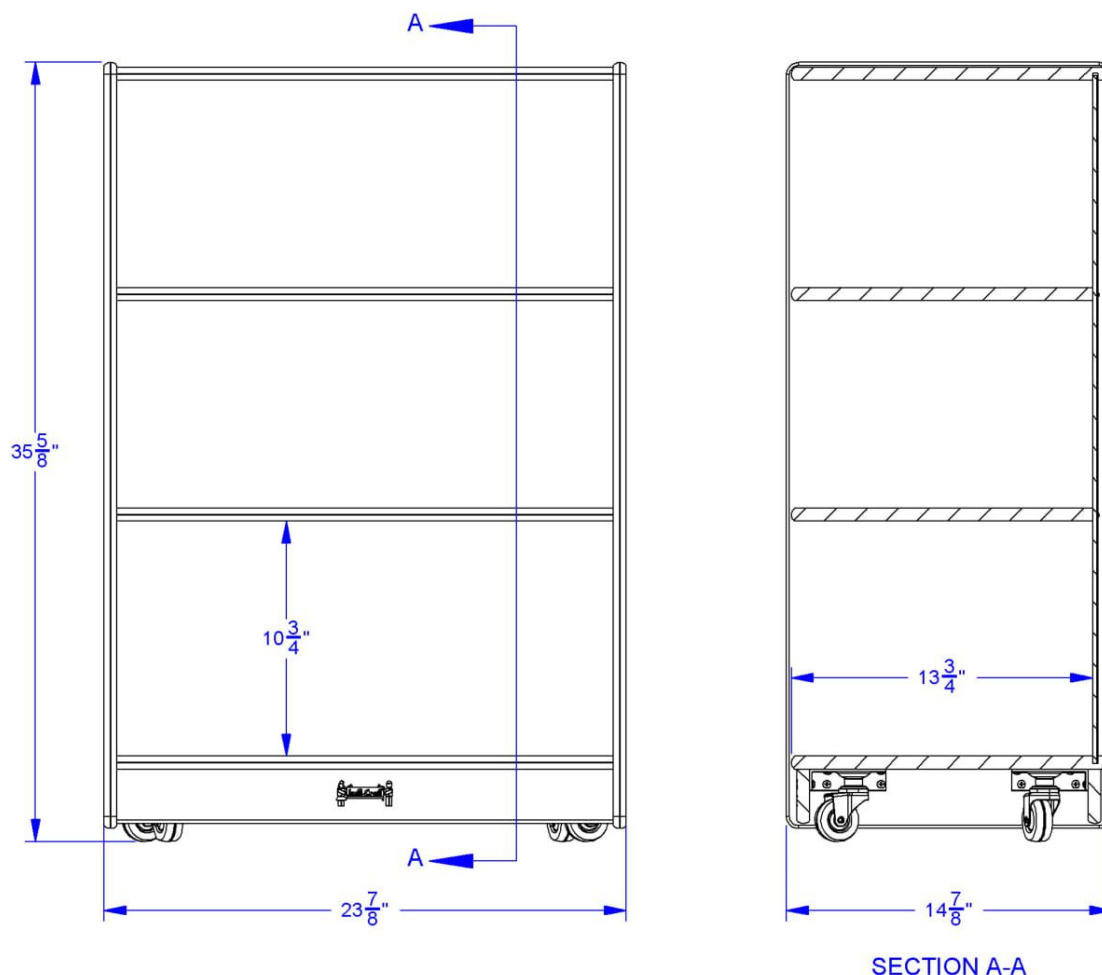

## Jonti-Craft Flagship Features Include:

KYDZSafe corners & edges are rounded to minimum of  $\frac{1}{2}$ " radius. KYDZSafe kickplates prevent pinching & lost objects. KYDZSafe 15" depth adds increased stability & 25% more storage than competitor's 12" depth. KYDZStrong materials are guaranteed to last. KYDZStrong dowel-pin construction adds stability & strength. KYDZStrong Recessed backs give stability & structural integrity. KYDZTuff acrylic finish is ultra-long lasting and resists yellowing. The UV coating is environmentally friendly and easy to clean with an extra-strong resistance to daily wear and common cleaning products, like bleach and nail polish remover. MAXBrackets are heavy-duty casters that make it easy to support and move furniture. Wheels are made of hard, non-marking rubber and a three-point-connection bracket adds triangular strength.