

EZ-PRO™ C4L (EZP2760)

Your EZ-PRO™ 4-container Carousel has a 6-inch clearance, making it the perfect table-top dispenser for both cereal and topping products. This model is a space-saving stylish solution for your dispensing needs!

SETTING UP YOUR PRODUCT

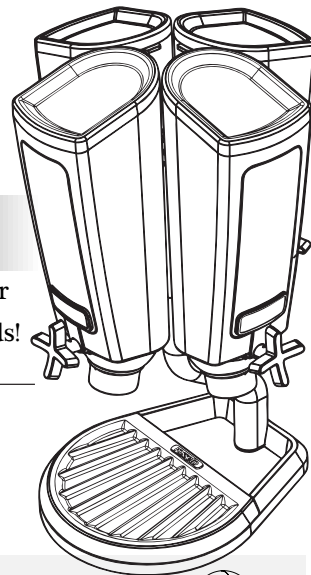

1. Carefully remove all parts from packaging and poly bags.

• You will have 4 EZ-PRO™ containers each with:

- a. Stainless steel lid
- **3 interchangeable portion wheels:**
 - b. PRO 6-Wing Silicon 1 oz. Portion Wheel
 - c. PRO-6SM 1 tbsp.
 - d. EZP007 1 tsp. Scoop-It™ with Funnel

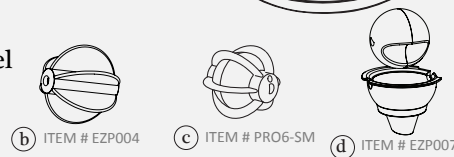

• **2 interchangeable nozzles:**

- e. Regular Nozzle
- f. Narrow Nozzle



NOTE:
Please remove the clear plastic nozzle when using EZP007 or any of the Scoop-It™ Portion Wheels.

- g. Container
- h. Label Holder
- i. Handle
- j. Handle Clip
- k. PRO Fresh Lid

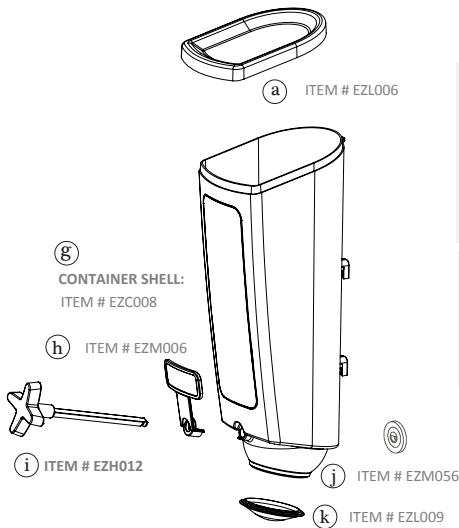

- 4 easy-to-install back snap system (optional accessory)
- 1 Assembled EZ-PRO™ C4L metal base with pole and detachable tray

2. Make sure you have all parts listed above before discarding packaging.

3. Place the metal base on a flat surface.

4. Check if the tray and the pole are set securely on the base.

5. Check the portion wheels installed and make sure you use the right fit for each product you are dispensing.

NOTE: If you need to change any portion wheels, follow steps 2 thru 5 on the disassembly instructions on Page 2.

6. Fill an EZ-PRO™ container with desired product and seal with the lid.

7. On the back of each container are 2 hooks that fit snugly onto the allotted notches on the pole. Install a container by securing both hooks on the upper and lower notches. Make sure it locks into place.

8. If desired, place an identifying label on the label holder.

9. Repeat steps 5 thru 7 for the remaining containers.

10. Dispense as you please!

11. When not in use, fasten the PRO Fresh Lid onto the nozzle.

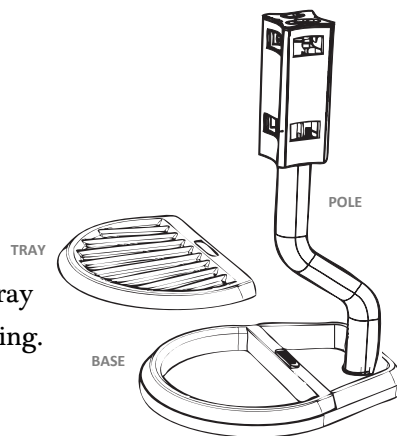

2 hooks on the back of the EZ-PRO™ container latch on to the upper and lower notches on the pole.

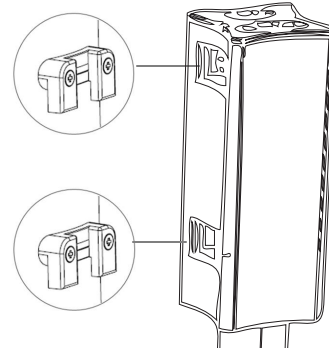

NOTE: Included with each container unit is an optional locking system that you can easily install with a small Phillips head screwdriver. (ITEM # EZM048)

NEED ASSISTANCE?

Please contact our customer support at (847)763-1215 and we'll be happy to assist with any assembly questions, comments or concerns.

ROSSETO® 3600 W. Pratt Avenue. Lincolnwood, IL 60712

Visit our website at: www.rosseto.com

INTERCHANGEABLE PORTION WHEELS

Your new EZ-SERV® Dispenser comes with 3 easily interchangeable Portion Wheels delivering just the right amount of product every time.

Here are some quick guidelines to explain how the different wheels work:

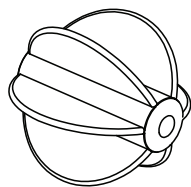

6W: 1 Oz.
6-Wing Wheel
ITEM #: EZP004

The 6W is great for dispensing bulk dry foods like cereals, coffee beans, loose tea; snacks like granola & trail mix and M&M's and most other candies.

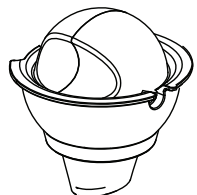

Scoop-It™: 1 Tsp
ITEM #: EZP007

If you are looking for precision, the 1 tsp. Scoop-It™ wheel delivers consistent portions over and over. The patent-pending Scoop-It™ wheels are ideal for the smallest items like Jimmies/Sprinkles, chopped nuts and M&M's®, mini Hershey's Kisses® as well as Sugar, powdered creamer and seasonings & spices.

Also available are 2 Tsp, 3 Tsp and 5 Tsp Scoop-It™ Wheels!

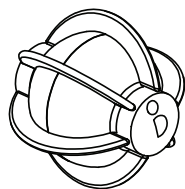

6SM: 1 Tbsp.
PRO6-SM
ITEM #: PRO6-SM

The 6SM is perfect for medium sized or non-uniform foods like chopped cookies, pie crust, cookie dough.

*Other wheels available: 2, 3, 4.5 teaspoon portions

CARING FOR YOUR DISPENSER

CLEANING INSTRUCTIONS:

1. To maintain the quality of your EZ-PRO™ dispenser, wash all parts daily in warm soapy water. Use a non-abrasive sponge.
2. DO NOT put any part of the unit through any dishwasher or dryer machines.
3. When disassembling the container, handle all parts gently. Please refrain from using too much force.
4. To keep the tray and base polished, use a commercial stainless steel surface cleaner.
5. Reassemble the unit only after all parts are completely dry.

HOW TO DISASSEMBLE:

1. Remove the container from the stand by holding it securely and lifting directly upward, clearing the hooks from the notches on the stand.
2. Remove lid from top of container. Make sure there is no remaining product inside that can spill over.
3. Remove handle clip at the back of the container.
4. Gently pull the handle from the front of the container. Set aside both handle and label holder.
5. Reach into container and remove portion wheel by gently pulling upwards or turning container upside down. Do the same to remove the nozzle.

HOW TO ASSEMBLE:

1. Place nozzle into container, followed by the portion wheel.
2. Adjust the portion wheel inside the container, so that its holes align with the container's holes (both front and back).
3. Position the label holder so that it matches the hole on the front of the container.
4. Insert handle through the label holder and front hole. Push the shaft through the portion wheel, all the way to the back of the container.
5. Install handle clip to the back end of the shaft. Make sure it locks snugly into place.
6. Fill container with desired dry product and place lid securely on the container.
7. Follow steps 7 and 8 on Page 1.

NEED ASSISTANCE?

Please contact our customer support at (847)763-1215 and we'll be happy to assist with any assembly questions, comments or concerns.

ROSSETO® 3600 W. Pratt Avenue. Lincolnwood, IL 60712

Visit our website at: www.rosseto.com