

## SINGLE-SHEET TABLE-TOP DISPENSER (EZ535/EZ552)

Your **Double 1.3-Gal Single-Sheet Table-Top Dispenser** comes with the **6W PRO Silicon Portion Wheel (1 oz)**. This portion wheel is perfect for dispensing items such as medium grind cookies, cereals & granolas, trail mixes and coffee beans!

### SETTING UP YOUR PRODUCT

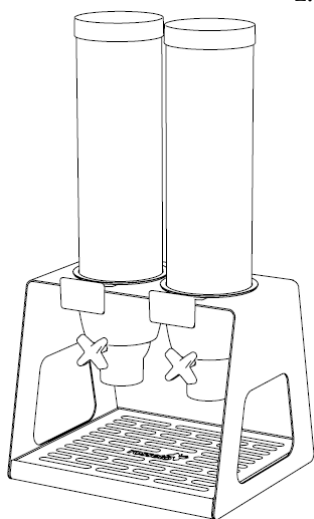

1. Carefully remove all parts from packaging and poly bags:

- 1 Stainless Steel Stand
- 2 Multicone Containers each one with:
  - a. Lid
  - b. 6WR PRO Silicon Portion Wheel
  - c. Container
  - d. Label Holder
  - e. Steel Handle
  - f. Handle Clip
- (For EZ535) 1 Black Acrylic Spill Tray
- (For EZ535) 1 Stainless Steel Tray Top

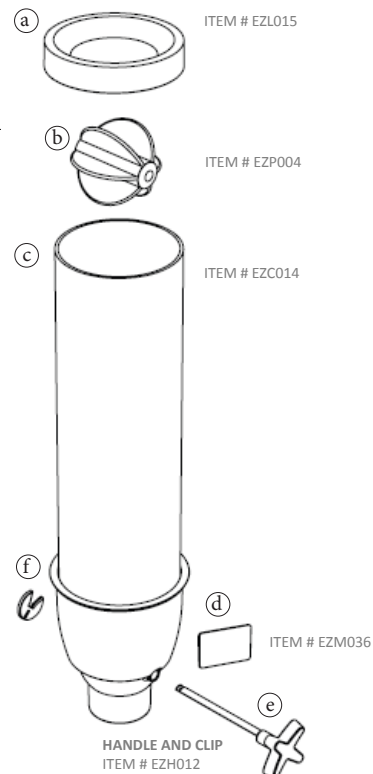

2. Make sure you have all parts above before discarding packaging.
3. Place the stand on a flat surface facing you.
4. Fill container with desired product and seal with the lid. (You may also choose to do this after step 7.)
5. Hold the container above the stand with the handle facing you. Carefully lower the container down to the metal opening, tilted at an angle that allows the handle to clear through first.  
Note: The back of the container has a small key that aligns with a bracket notch. This prevents movement from side to side.
6. Once the handle is cleared through the metal opening, you may tilt the container carefully back to a full upright position. Then, gently set the container down directly on the stand.
7. Repeat steps 4 thru 6 for the remaining containers.
8. Attach the **Label Holder** (d) as shown in **FIGURE A**.
9. Dispense as you please!

FIGURE A

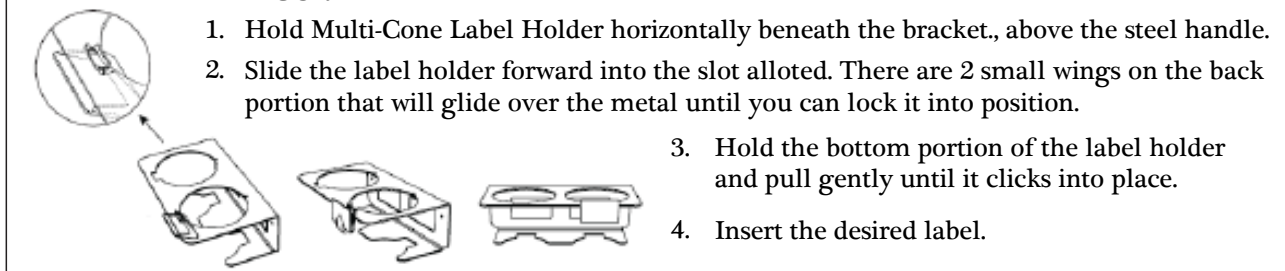

**NEED ASSISTANCE?**

Please contact our customer support at (847)763-1215 and we'll be happy to assist with any assembly questions, comments or concerns.

**ROSSETO®** 3600 W. Pratt Avenue. Lincolnwood, IL 60712  
Visit our website at: [www.rosseto.com](http://www.rosseto.com)

# CARING FOR YOUR CONTAINER

---

## CLEANING INSTRUCTIONS:

1. Regularly wash all parts of the container in warm soapy water. Never use abrasive sponge or cloth.
2. When disassembling the container, handle all parts gently. Please refrain from using too much force.
3. Reassemble the unit only after all parts are completely dry.

## HOW TO DISASSEMBLE:

1. Gently lift your container by a couple of inches, stopping before the steel handle hits the metal. Angle the top of the container towards you until the handle clip at the back is cleared through the opening. After this, you may clear the rest of the container through the opening. Handle your container with care by making sure the steel handle does not hit the metal!
2. Set your container on a secure flat surface.
3. Remove lid from top of container. Make sure there is no remaining product inside that can spill over.
4. Remove handle clip at the back of the container.
5. Gently pull the handle from the front of the container.
6. Reach into container and remove paddle wheel by gently pulling upwards or turning container upside down.

## HOW TO ASSEMBLE:

1. Place portion wheel into container, making sure the holes align with the container's holes.
2. Insert handle through front of the container, making sure to push through the paddle wheel and through the back of the container.
3. Place handle clip on the back end of the handle shaft. Make sure the words "This Side Out" are facing out.
4. Fill container with desired dry product and place lid securely on the container.
5. Follow steps 4 thru 9 on Page 1.

**Need a different-sized portion wheel? We have 6 more options for you to choose from!**

Other portion wheels available:

- Pro6-SM – 1 tablespoon
- EZP005 – 1 tablespoon
- EZP012 – 1 teaspoon
- EZP013 – 2 teaspoons
- EZP014 – 3 teaspoons
- EZP015 – 4 teaspoons

**PRO6-SM**

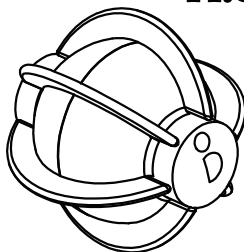

**EZP012**

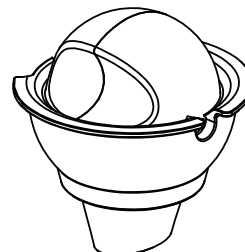

**The Rosseto interchangeable portion wheels deliver just the right amount of product every time. Test each wheel with your dry foods to determine which works best for you!**

**NEED ASSISTANCE?**

Please contact our customer support at (847)763-1215 and we'll be happy to assist with any assembly questions, comments or concerns.

**ROSSETO®** 3600 W. Pratt Avenue. Lincolnwood, IL 60712

Visit our website at: [www.rosseto.com](http://www.rosseto.com)