

FEATURES & BENEFITS

OPTIONS

For more information, visit www.hawscos.com or call (888) 640-4297.



SPECIFICATIONS

Model SP65SS AXION[®] MSR Type 304 Stainless Steel eye/face wash head shall include inverted directional flow with laminar flow and an integral 3.7 gpm (14 L) flow control, along with a yellow plastic pop-off dust cover. (Not for use with freeze protected models)

APPLICATIONS

Intended as a direct replacement for the SP63 and SP63FC Haws eyewash assembly. Suitable as a replacement for current SP62, SP62FC, SP69, and SP69FC eyewash assemblies.

INSTALLATION/ RETRO FIT STEPS

1. IF REPLACING AN EXISTING EYEWASH ASSEMBLY WITH SP65SS FOLLOW STEPS 2 THROUGH 5
AND IF INSTALLING SP65SS ON NEW UNIT FOLLOW STEPS 3 THROUGH 5 (IF APPLICABLE).
**NOTE: NOT FOR USE ON ANY FREEZE RESISTANT UNIT; i.e. 8300FP,
8300.158, 7433FP, 8317CTFP, 8317CTFP.220V, AND 8317CTFP1D1.**
- 2 REMOVE EXISTING EYEWASH BY SPINNING EYEWASH TEE COUNTERCLOCKWISE.
DO NOT REMOVE BRASS NIPPLE FROM BOWL HOLDER.
- 3 PLACE SP65SS ADAPTER THROUGH DUST COVER LOOP. THREAD SP65SS ADAPTER ONTO
NIPPLE UNTIL SNUG AGAINST STRAINER.
- 4 THREAD SP65SS ONTO ADAPTER. ORIENT TAB TOWARDS THE BACK (AWAY FROM USER).
DO NOT OVER-TIGHTEN.
- 5 PLACE DUST COVER ONTO EYE/FACE WASH IF MODEL 9102 STAINLESS COVER IS NOT INSTALLED.
- 6 EXISTING COMPONENTS SHOWN (TYPICAL MODEL) ARE FOR REFERENCE ONLY AND MAY NOT
REPRESENT YOUR SPECIFIC UNIT.
- 7 ADAPTER SUPPLIED WITH SP65SS MAY NOT BE REQUIRED IN SOME APPLICATIONS.

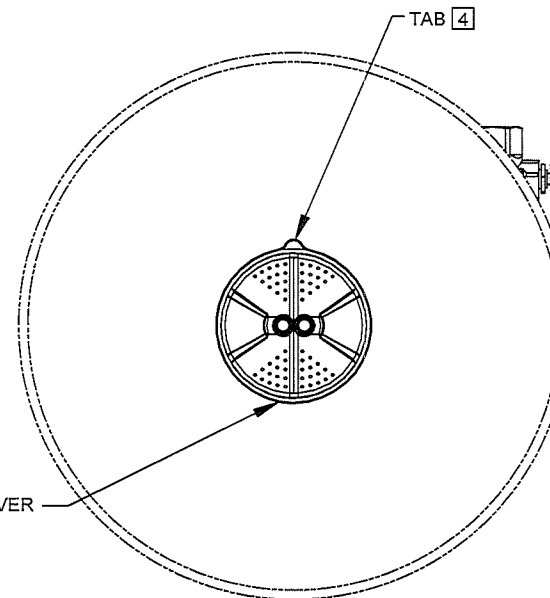

EYE/FACE WASH HEAD SHOWN WITHOUT DUST COVER

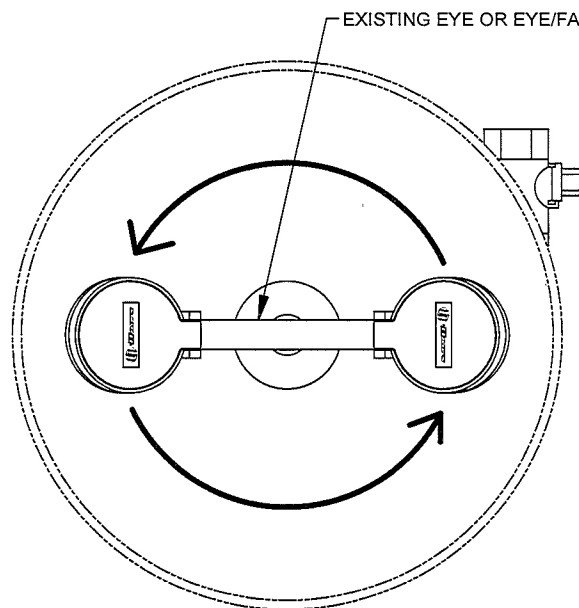

EXISTING EYE OR EYE/FACE WASH ASSEMBLY 2 6

6 (EXISTING) BOWL ASSEMBLY

6 3 (EXISTING) STRAINER

6 (EXISTING) BOWL HOLDER

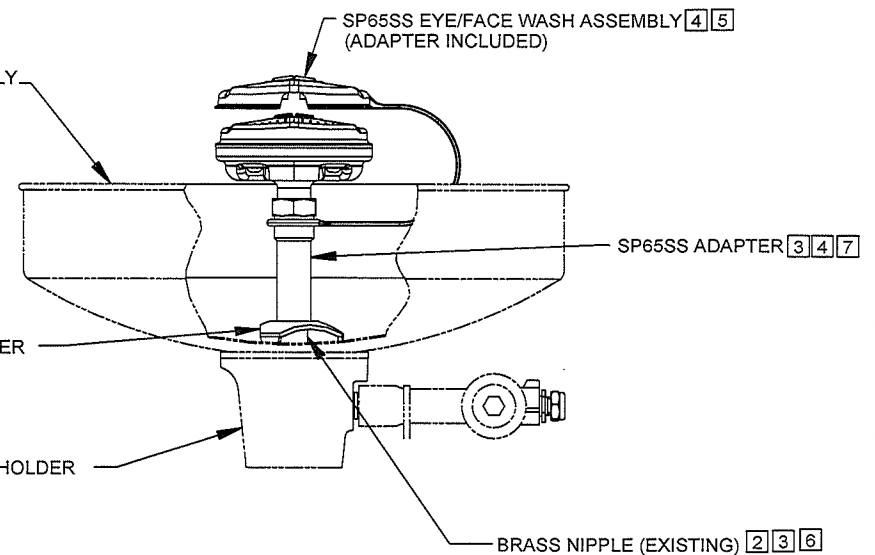

SP65SS EYE/FACE WASH ASSEMBLY 4 5
(ADAPTER INCLUDED)

SP65SS ADAPTER 3 4 7

BRASS NIPPLE (EXISTING) 2 3 6

SEE SHEET 2 OF 2
FOR FLOW CONTROL
CLEANING STEPS

 Haws®		1455 KLEPPE LANE SPARKS, NEVADA 89431 (775) 359-4712 FAX (775) 359-7424 E-MAIL: HAWS@HAWS.CO.COM WEBSITE: WWW.HAWS.CO.COM	
		ECN NO. 4358 REVISED PER BY: HM ECN: 4838 DRAWN: IR DATE: 2/10/10 CHKD: JH APPROVED: DATE: 2/10/10	
MODEL(S)		SP65SS	
PART NUMBER		0002077593	
DRAWING NO.		15972A00	
REV		3	
SCALE: 1:18		DRAWING TYPE: INSTALLATION	
SIZE: A		SHEET 1 OF 2	

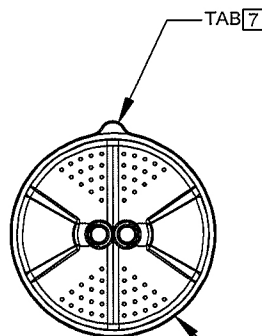
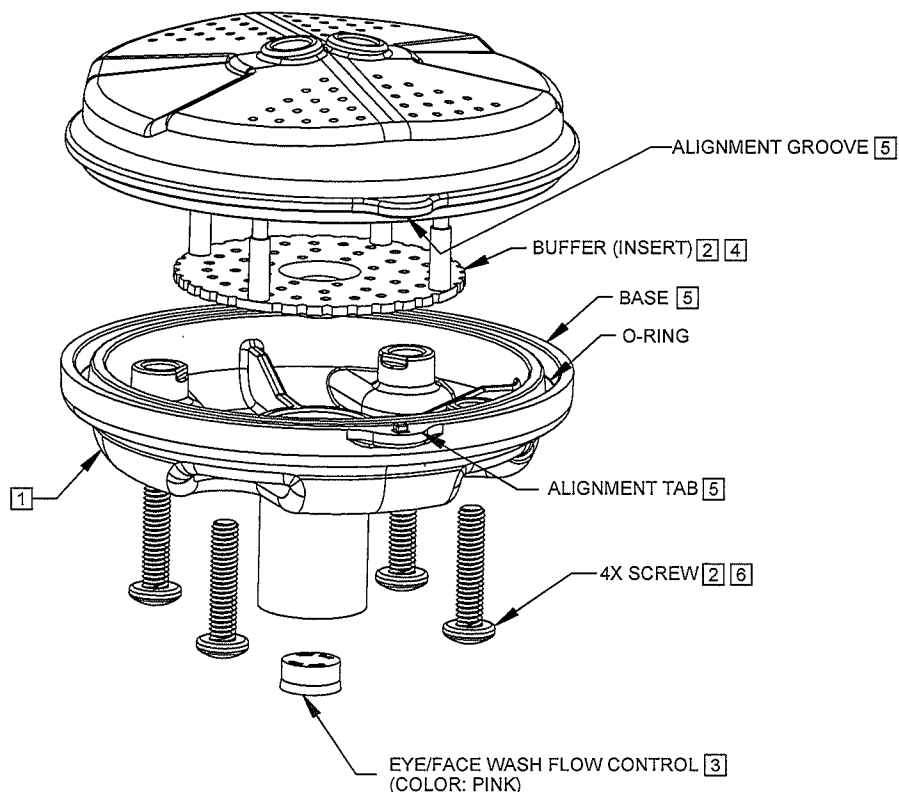

FLOW CONTROL CLEANING STEPS:

- [1] UNSCREW EYE/FACE WASH ASSEMBLY FROM ADAPTER.
- [2] REMOVE SCREWS (QTY. 4) FROM SP65SS EYE/FACE WASH ASSEMBLY. REMOVE EYE/FACE WASH HEAD AND BUFFER (INSERT).
- [3] REMOVE EXISTING FLOW CONTROL FROM BASE BY PUSHING IT OUT FROM THE TOP, AND CAREFULLY REMOVE ANY DEBRIS LODGED BETWEEN O-RING AND HOUSING OR OPENINGS. ALSO, CHECK FOR ANY SEDIMENT OR MINERAL DEPOSITS BLOCKING OPENINGS. EXERCISE CAUTION NOT TO DAMAGE OR LOSE O-RING IN THE PROCESS. ALL OPENINGS ON FLOW CONTROL MUST BE FREE AND CLEAR OF ANY OBSTRUCTIONS FOR FLOW CONTROL TO FUNCTION PROPERLY. REINSTALL FLOW CONTROL. SEE DETAIL A FOR ORIENTATION.
- [4] INSERT BUFFER (INSERT) INTO EYE/FACE WASH HEAD NOTING ORIENTATION OF POST IN RELATIONSHIP TO L-SHAPED RIB AS SHOWN ON DETAIL B.
- [5] REASSEMBLE EYE/FACE WASH HEAD, MAKING SURE THAT ALIGNMENT GROOVE ON EYE/FACE WASH HEAD LINES UP WITH ALIGNMENT TAB ON BASE AND O-RING IS SEATED IN O-RING GROOVE.
- [6] REINSTALL SCREWS (QTY. 4) INTO THE EYE/FACE WASH ASSEMBLY. TIGHTEN SNUG TO ENSURE A WATER-TIGHT SEAL.
- [7] REASSEMBLE SP65SS EYE/FACE WASH ASSEMBLY ONTO ADAPTER. ORIENT TAB TOWARDS THE BACK (AWAY FROM USER). DO NOT OVER-TIGHTEN.
- [8] PLACE DUST COVER OVER EYE/FACE WASH.

NOTE ORIENTATION OF POSTS IN
RELATIONSHIP TO L-SHAPED RIB.
ALL 4 POSTS MUST BE INSIDE OF
RIBS (AS SHOWN).

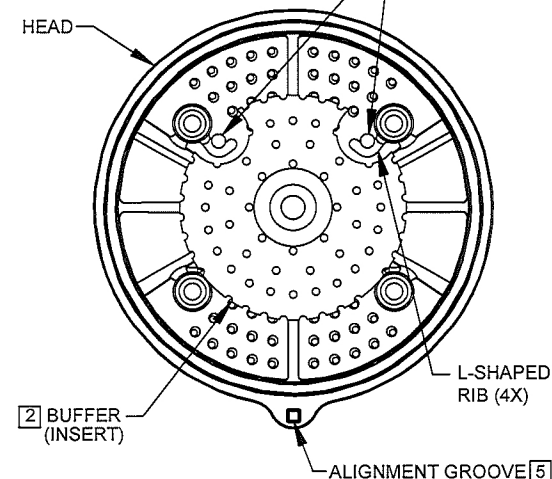

[4] DETAIL B

SEE SHEET 1 OF 2
FOR INSTALLATION/
RETROFIT STEPS



1455 KLEPPE LANE
SPARKS, NEVADA 89431
(775) 359-4712 FAX (775) 359-7424
E-MAIL: HAWS@HAWS.CO.COM
WEBSITE: WWW.HAWS.CO.COM

ECN NO. REVISED PER BY:	MODEL(S)	PART NUMBER
4358 ECN: 4838 HM	SP65SS	0002077593
DRAWN: IR	DATE: 2/10/10	DRAWING NO. 15972A00
APPROVED: [Signature]	DATE: 2/10/10	REV 3
SCALE: 1:18	DRAWING TYPE: INSTALLATION	SHEET 2 OF 2