



Project _____
Item # _____
Quantity _____

Heated Shelf Built-In Flush - Simulated Stone

Models: HSBF-SS-2418, -3018, -3618, -4818

Give your operation a seamless look with the Heated Shelf Built-In Flush - Simulated Stone. The bracket mounting hardware gives a true flush mount appearance that will safely hold food hot while blending with your decor. It is a must for buffet lines in cafeterias, restaurants and more!

Standard features

- Model is bottom mount, flush with the countertop
- Recommended for use in metallic counters. For other surfaces, verify that the material is suitable for temperature up to 200°F (93°C)♦
- Simulated Stone is Swanstone®
- Simulated Stone surface and blanket-type element with thermostatically-controlled heated base results in uniform heat to extend food holding times
- Insulation keeps heat at the holding surface while a built-in adjustable thermostat controls surface temperature.
- Available in widths of 24", 30", 36", 48" (610, 762, 914, 1219 mm) and a depth of 18" (457 mm)
- 3' (914 mm) Conduit is Standard – with ITC Control Boxes only, 6' and 10' (1829, 3048 mm) lengths are available
- Standard control includes thermostat, lighted rocker switch and mounting brackets

♦ Hatco is not responsible for counter damage caused by heat from the warmer



Options (available at time of purchase only)

Unit Simulated Stone color – Night Sky standard – Non-standard colors are non-returnable

☐ Gray Granite ☐ Bermuda Sand

Designer Color for Flush Mount Control Bezel – Stainless Steel standard – Non-standard colors are non-returnable

☐ Warm Red ☐ Black ☐ Gray Granite ☐ White Granite
☐ Navy Blue ☐ Hunter Green ☐ Antique Copper

Control Boxes - with Lighted Power Rocker Switch, cord and plug

☐ Flush Mount ITC Control Box
☐ Flush Mount Thermostatic Control Box
☐ Small Flush Mount ITC Control Box
☐ Small Flush Mount Thermostatic Control Box

Conduit in lieu of standard 3' (914 mm) (Flush Mount ITC Control Box only)

☐ 6' (1829 mm) conduit ☐ 10' (3048 mm) conduit



IFS anti-microbial coatings use naturally-occurring, environmentally sustainable, silver ions to help inhibit the growth of microbes on the powder coated surface. See www.hatcocorp.com/antimicrobial-paint for more information.



For operation, location and safety information, please refer to the Installation and Operating Manual.



HATCO CORPORATION | P.O. Box 340500 Milwaukee, WI 53234-0500 U.S.A. | (800) 558-0607 | (414) 671-6350



www.hatcocorp.com | support@hatcocorp.com | [Find a Hatco Rep](#) | [Image Library](#) | [Document Library](#) | [Chat](#)



Heated Shelf Built-In Flush - Simulated Stone

Models: HSBF-SS-2418, -3018, -3618, -4818

HSBF-SS-xxxx

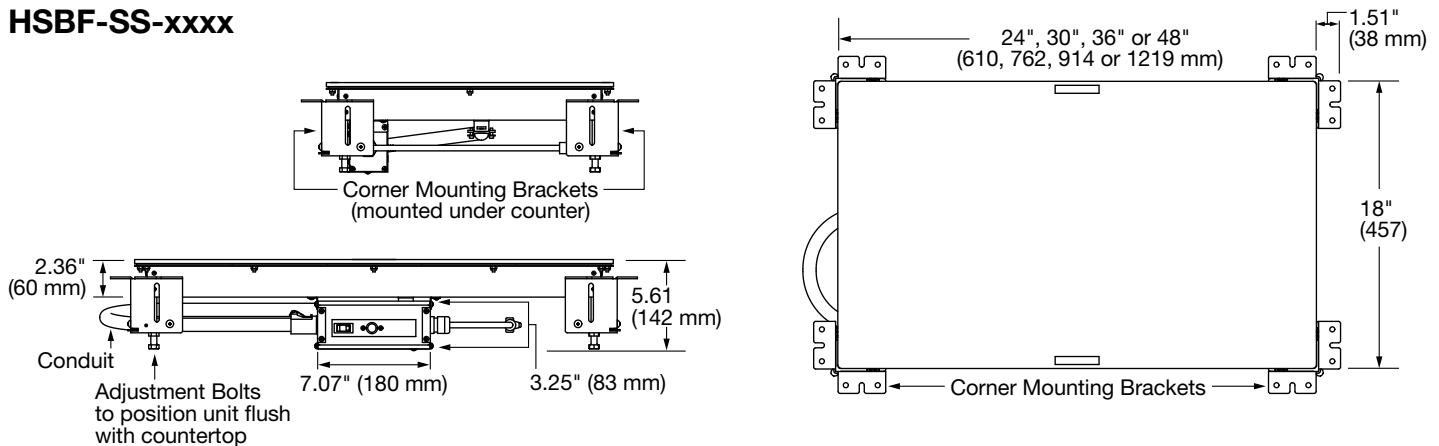

OPTIONAL CONTROL BOXES

HSBF-FLUSH-TSTAT Flush Mount Thermostatic

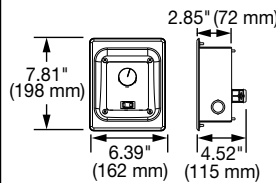

Cut Out Dimensions:
5.875\" W x 6.375\" H (149 x 162 mm)

HSBF-FLUSH-ITC Flush Mount Electronic

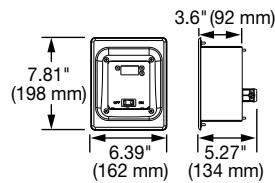

Cut Out Dimensions:
5.875\" W x 6.375\" H (149 x 162 mm)

HSBF-SMFLUSH-TSTAT Small Flush Mount Thermostatic

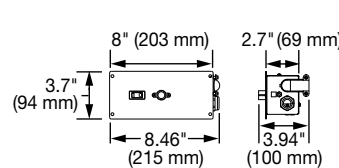

Cut Out Dimensions:
6.75\" W x 3.44\" H (171 x 87 mm)

HSBF-SMFLUSH-ITC Small Flush Mount Electronic

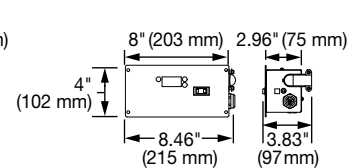

Cut Out Dimensions:
6.75\" W x 3.75\" H (171 x 95 mm)

SPECIFICATIONS

Heated Shelf Built-In Flush - Simulated Stone

The shaded areas contain electrical information for International models

| Model [^] | Overall Dimensions (including brackets) W x D x H | Heated Stone Size W x D | Cutout Dimension with 3/8\" (10 mm) radii W x D | Volts* | Watts | Amps | Plug |
|--------------------|---|--------------------------------|---|-----------------|--------------------|-----------------|------------------------------------|
| HSBF-SS-2418 | 27.02\" x 21.02\" x 5.61\" (686 x 533 x 142 mm) | 24\" x 18\" (610 x 457 mm) | 24.38\" x 18.38\" (619 x 467 mm) | 120 | 635 | 5.3 | NEMA 5-15P |
| | | | | 220 | 534 | 2.4 | AS3112, BS-1363, CEE 7/7 Schuko |
| | | | | 220 - 230 - 240 | 534 - 583 - 635 | 2.4 - 2.5 - 2.6 | |
| HSBF-SS-3018 | 33.02\" x 21.02\" x 5.61\" (838 x 533 x 142 mm) | 30\" x 18\" (762 x 457 mm) | 30.38\" x 18.38\" (722 x 467 mm) | 120 | 780 | 6.5 | NEMA 5-15P |
| | | | | 220 | 655 | 3.0 | AS3112, BS-1363, CEE 7/7 Schuko |
| | | | | 220 - 230 - 240 | 655 - 716 - 780 | 3.0 - 3.1 - 3.3 | |
| HSBF-SS-3618 | 39.02\" x 21.02\" x 5.61\" (990 x 533 x 142 mm) | 36\" x 18\" (914 x 457 mm) | 36.38\" x 18.38\" (924 x 467 mm) | 120 | 930 | 7.8 | NEMA 5-15P |
| | | | | 220 | 782 | 3.6 | AS3112, BS-1363, CEE 7/7 Schuko |
| | | | | 220 - 230 - 240 | 782 - 854 - 930 | 3.6 - 3.7 - 3.9 | |
| HSBF-SS-4818 | 51.02\" x 21.02\" x 5.61\" (1295 x 533 x 142 mm) | 48\" x 18\" (1219 x 457 mm) | 48.38\" x 18.38\" (1229 x 467 mm) | 120 | 1270 | 10.6 | NEMA 5-15P |
| | | | | 220 | 1068 | 4.9 | AS3112, BS-1363, CEE 7/7 Schuko |
| | | | | 220 - 230 - 240 | 1068 - 1166 - 1270 | 4.9 - 5.1 - 5.3 | |

[^] Recommended for use in a metallic countertop. For other surfaces, verify material is suitable for temperatures up to 200°F (93°C).

* All voltages non-CE

PLUG CONFIGURATION

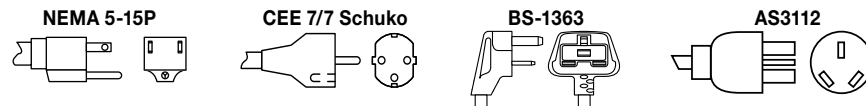

PRODUCT SPECS

Heated Shelf Built-In Flush - Simulated Stone

The Heated Shelf Built-In Flush - Simulated Stone shall be model ... as manufactured by the Hatco Corporation, Milwaukee, WI 53234 U.S.A.

The Heated Shelf Built-In Flush - Simulated Stone shall be rated at ... watts, ... volts, and ... inches (millimeters) in overall width. It shall consist of food-safe Swanstone® surface shelf assembly, adjustable bracket with cord and plug attached and attached Electronic Temperature Control Box. Options shall include: Granite Grey and

Bermuda Sand Simulated Stone color, *Designer Color* for Flush Mount Control Bezel (Stainless Steel standard), Flush Mount Thermostatic Control Box with Lighted Power Switch (Thermostatic or ITC), Small Flush Mount Control Box (Thermostatic or ITC) and a 6' (1829 mm) or 10' (3048 mm) conduit used with ITC Control Boxes only. All *Designer Colors* are anti-microbial paint.

Warranty consists of 24/7 parts and service assistance (U.S. and Canada only).

HATCO CORPORATION | P.O. Box 340500 Milwaukee, WI 53234-0500 U.S.A. | (800) 558-0607 | (414) 671-6350



www.hatcocorp.com | support@hatcocorp.com | [Find a Hatco Rep](#) | [Image Library](#) | [Document Library](#) | [Chat](#)