

Project Name: _____ AIA#: _____

Model #: _____ Location: _____

SIS#: _____ Item #: _____ Quantity: _____



Precise - Powerful - Premium Construction

S-Series premium slicers deliver precision, performance, industry-leading convenience, superior cleanability and lasting value.



Removable Knife
makes cleanup easier
while providing more
operator protection



Arby's Premium Automatic Slicer



Model

☐ SG13A-22 (Advanced Model)

Standard Features

- Patented anodized aluminum design & construction for quick and easy cleaning
- Patent-pending indexing system enables accurate and precise slice thickness adjustment up to 1-1/8"
- 13" stainless steel removable knife with hardened edge provides quality slices and higher yield
- Removable Knife includes removal tool
- Tilting & removable carriage accommodates up to 13.75" H, 8" dia., 11" W large products
- Advanced meat grip design for superior product hold
- 1/2 HP continuous use knife motor combined with the high efficiency knife drive system delivers optimum power
- No Voltage Release prevents inadvertent reactivation of slicer in the event of interlock or power interruption
- Interlock prevents slicer from operating without the knife cover in place
- Variable speed brushless auto mode motor delivers 3ft. lbs. of peak torque
- Patent-pending auto engagement system prevents slippage
- Top mounted, removable sharpening system with long-lasting synthetic diamond surfaces
- High temperature resistant polymer on end weight, sharpener cover, thumb guard and handles
- Patent-pending graphic user interface with Clear-Text LCD display provides operator messages, diagnostics and system information in English, Spanish and French
- Home Start – carriage must be in home position to start slicer
- Carriage tilt interlock – prevents knife exposure when carriage is tilted and prevents slicer from operating
- Return to Home feature returns carriage to home position when powering off motor
- Adjustable timer – shuts off slicer after inactivity
- Close to Stop – closing slicer table shuts off slicer
- 3 cut lengths and 4 speeds

Warranty

- Two year parts and labor
- Lifetime warranty on sharpening stones

Optional Accessories

- S-FENCE - Food Fence
- S-SLAWTRAY - Slaw Tray
- SC-LARGE - Slicer Sanitation Cover
- S-VEGHOP - Vegetable Hopper



MADE IN THE U.S.A.



REVIT



Intertek
Complies to NSF/ANSI STD. 4



Intertek



AutoQuotes

Approved by: _____ Date: _____

2153 Dryden Rd., Dayton, OH 45439 | 937-299-5493 | 800-347-5423 | Fax: 937-299-4147 | www.globefoodequip.com

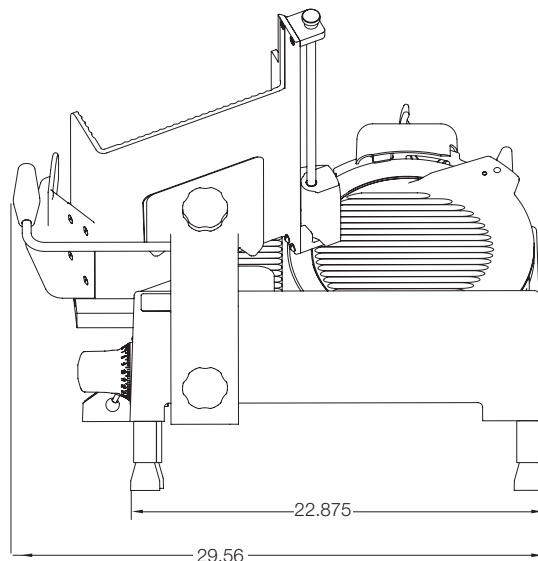
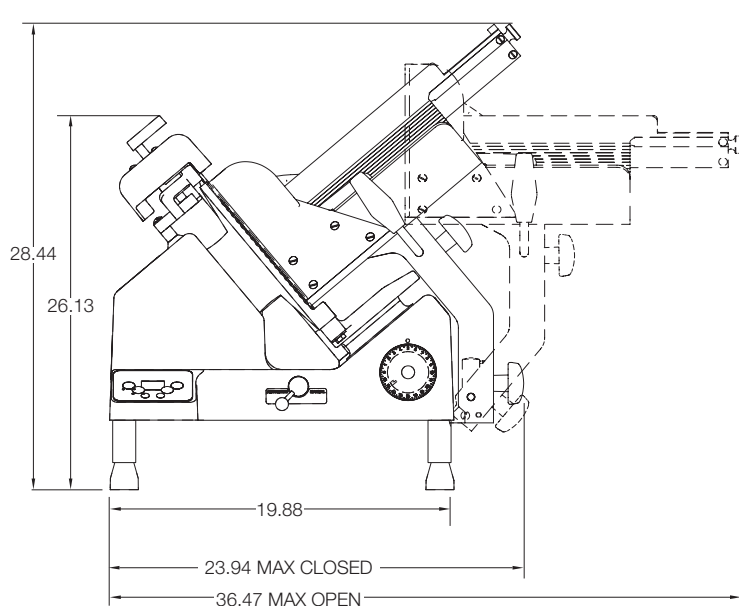

UNIT: Inches

Drawings available through KCL. www.kclcad.com

SPECIFICATIONS

Model	Motor	Volts	Amps	NEMA Plug Type	Drive Type	Slicing Vol. / Day	Cheese Slicing	Blade Diameter	Max Slice	Product Cutting Capacity		
										D (Diameter)	H (Height)	W (Width)
SG13A-22	1/2 HP	115-60-1	2.5	5-15	Poly-V Belt	All Day		13" (33.02 cm)	1-1/8" (2.857 cm)	8" (20.32 cm)	13.75" (35 cm)	11" (27.94 cm)

Cord & Plug: Attached 7 ft. flexible 3-wire cord with molded plug fits a grounded receptacle. **Please specify desired plug configuration when ordering.**

DIMENSIONS | SHIPPING INFORMATION

Reinforced carton for shipping. The weight and dimensions of this reinforced carton are included below and may vary from shipment to shipment.

Shipped on a pallet. Freight class 85.

Model	Max Overall Dimensions	Net Weight	Shipping Dimensions	Shipping Weight
SG13A-22	36.47" W x 29.56" D x 28.44" H (92.63 cm x 75.08 cm x 72.23 cm)	155 lbs. (70.3 kg)	31.5" W x 31.5" D x 31.5" H (80 cm x 80 cm x 80 cm)	171 lbs. (77.6 kg)

OPTIONAL ACCESSORIES:

- ☐ S-FENCE - Food Fence
- ☐ S-VEGHOP - Vegetable Hopper
- ☐ SC-LARGE - Slicer Sanitation Cover
- ☐ S-SLAWTRAY - Slaw Tray
- ☐ S-LEGS - 2.5" Extension Legs
- ☐ S-XDSLA - Extended Warranty

Constructed of anodized aluminum with built-in Clear-Text display/control panel. 1/2 HP motor with overload protection & 13" hardened steel removable knife. Patent-pending indexing system with slice thickness adjustment up to 1-1/8". Top mounted removable sharpener with synthetic diamond stone wheel and plate. Tilting & removable carriage accommodates up to 13.75" H, 8" dia., 11" W large products. Adjustable cut length and speed. Slicer is ETL listed. No Voltage Release and Knife Cover Interlock. Additional features include Home Start, Return to Home, Adjustable Timer, Close to Stop, Carriage Tilt Interlock & Clear-Text Display with services and operation/diagnostics. Two year parts & labor slicer warranty, lifetime warranty on sharpening stones.