

General Information

Project Name: _____

Consultant: _____

Item #: _____

Model #: _____

Quantity: _____



Specifications

FS-R Model is a standard duty "right corner" utility sink constructed of 16GA Type 304 with a 24" x 18" x 7" deep bowl & angled corner with integrated full-height apron and built in pitch to 4" OD waste outlet with strainer.

Product Guide

IMC Utility Sinks are easily cleanable without the use of tools. All corners are coved, and all seams are fully welded and polished.

Rugged type 304, 18-8 stainless steel construction, engineered to stand up under day-in and day-out abuse.

Options

- ☐ **SSF** - Wall Faucet
- ☐ **HA** - 36" Hose
- ☐ **MH3** - Mop Holder (3)
- ☐ **MH4** - Mop Holder (4)
- ☐ **MH5** - Mop Holder (5)
- ☐ **LH6** - 6" High Legs
- ☐ **IPS2** - 2" IPS Drain
- ☐ **BW-36** - Custom Bowl up to 36" x 36"
- ☐ **FL48** - 48" High Flashing at Rear or Side
- ☐ **FL48-W** - Welded 48" High Flashing on 3 Sides
- ☐ **RSS8** - Rear & Side Splash 8" High
- ☐ **USH24** - 24" Utility Shelf
- ☐ **USH36** - 36" Utility Shelf
- ☐ **MSR** - Lint Bucket (Mesh Strainer)
- ☐ **FF-50** - S/S Flanged Feet (Each)
- ☐ **SEC** - Correctional Package

*See Price List for more options



IMC/TEDDY
DECADES OF FINE CRAFTSMANSHIP

FS-R

Right Corner Floor Sink / Utility Sink

DRAWINGS

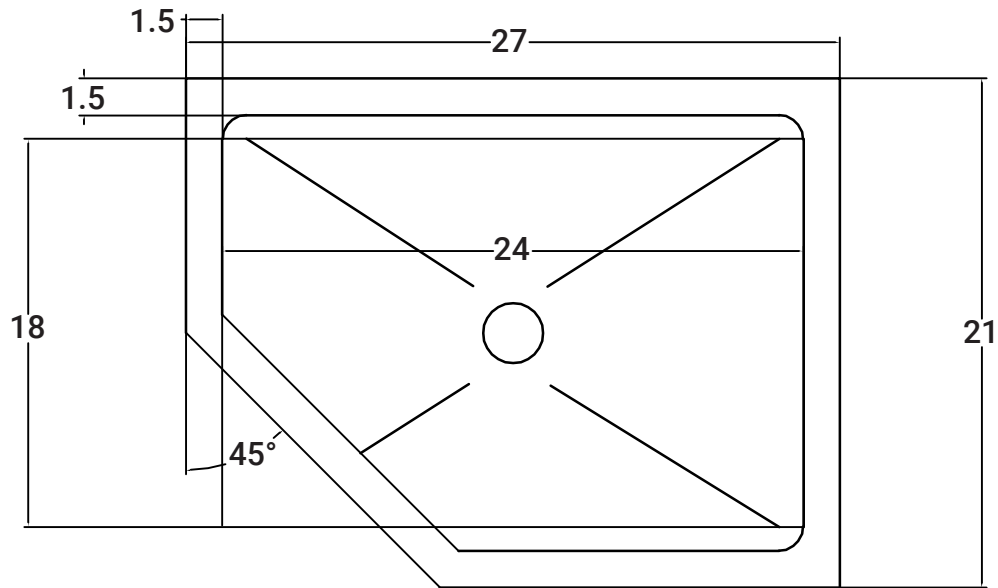

PLAN

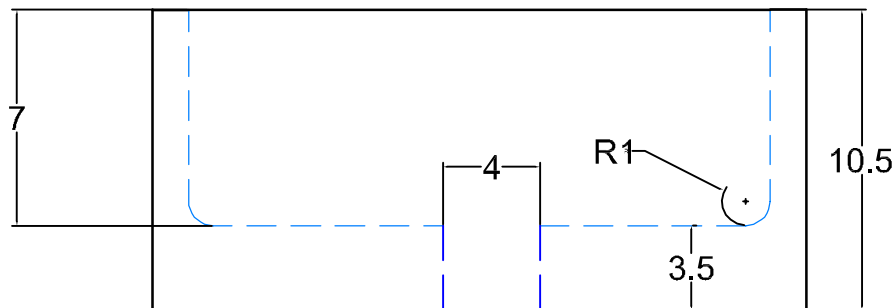

FRONT ELEVATION

RIGHT CORNER FLOOR SINK

Model	Bowl Size (W x L x H)	Overall Size (W x L x H)
□ FS-R	24" x 18" x 7"	21" x 27" x 10½"

Specifications subject to change without notice.

FS-R-30 0524