



# BEVERAGE-AIR®

PROJECT: \_\_\_\_\_  
ITEM # \_\_\_\_\_ QTY: \_\_\_\_\_  
MODEL # \_\_\_\_\_  
AIA # \_\_\_\_\_ SIS # \_\_\_\_\_  
APPROVED: \_\_\_\_\_

## BREEZE™ SERIES

### Model: BZ13HC-B

#### OPEN AIR MERCHANDISER



### 3 Year Parts/Labor Warranty 5 Year Compressor Warranty

#### CABINET CONSTRUCTION

- Exterior finish is heavy-duty steel with a black baked on durable coating
- Interior is white coated steel
- Curved design with open front
- Interior lighting provides two recessed interior lights for maximum product visibility
- Three (3) epoxy coated shelves
- Side shield to maximize product display
- Modern grille is easy to remove for cleaning and servicing
- Brightly lighted sign panel standard
- Gravity-Flo organizer standard
- Certified for bottled beverage & packaged food products



#### OPTIONS & ACCESSORIES

- White exterior finishes available
- Black dividers
- Black shelves
- Roller kit
- Custom graphics and signage

#### REFRIGERATION SYSTEM

- Uses environmentally friendly, energy efficient R290 refrigerant, and meets all regulatory requirements for CARB, SNAP, DOE & more
- Automatic, non-electric defrost
- Epoxy coated evaporator coil
- Maintains product temperature between 32°F and 40°F



# BEVERAGE-AIR®

## BREEZE™ SERIES

Model: BZ13HC-B

PLAN VIEW

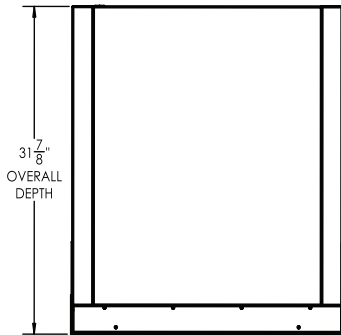

ELEVATION VIEW

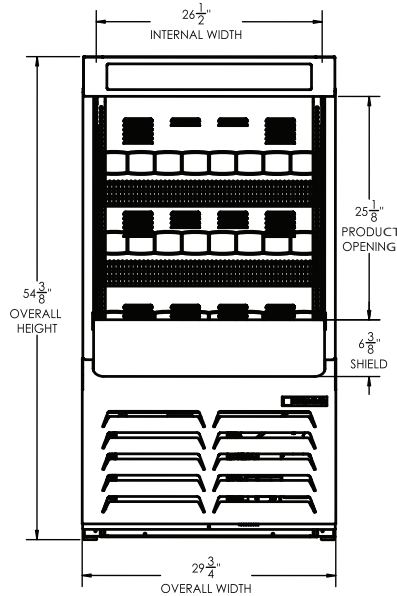

SIDE VIEW

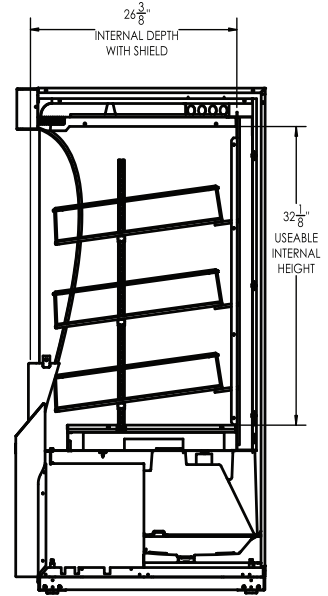

### EXTERNAL DIMENSIONAL DATA

Width Overall (in)	29 3/4"
Depth Overall (in)	31 7/8"
Height Overall (in)	54 3/8"

### INTERNAL DIMENSIONAL DATA

NET Capacity (cubic ft.)	13.0
Internal Width Overall (in)	26 1/2"
Internal Depth Overall (in)	26 3/8"
Internal Height Useable (in)	32 1/8"
Product Opening (in)	25 1/8"
Number of Shelves	3
Facings Per Shelf	8
20 oz. Case Capacity	7

We reserve the right to change specifications and product design without notice. Such revisions do not entitle the buyer to corresponding changes, improvements, additions or replacements for previously purchased equipment. Dimensional tolerances +/- 1/4". Metric dimensions (MM).

Required Clearance: Top 6" & Rear 3"

### ELECTRICAL DATA

Full Load Amps	9.1
Voltage	115/60/1
Nema Plug (8' cord)	5-15P

### REFRIGERATION DATA

Horsepower	3/4
Capacity (BTU/Hr)	5452
Heat Rejection (BTU/Hr)	8178
Charge (lbs/grams/ounces)	0.32 / 145 / 5.1

### SHIPPING DATA

Gross Weight - Crated	350 lbs.
Height - Crated (in)	60"
Width - Crated (in)	33"
Depth - Crated (in)	35"

### ELECTRICAL CONNECTION



115/60/1  
NEMA 5-15P

Unit pre-wired at factory and include 8' long cord and plug set.

3779 Champion Blvd., Winston-Salem, NC 27105 | 888-845-9800 | Fax: 336-245-6453 | Beverage-Air.com | Sales@bevair.com

Date Issued 9/25 | Printed in U.S.A.