

Item #: 193BCF48B Project: \_\_\_\_\_

Qty: \_\_\_\_\_ Date: \_\_\_\_\_ Approval: \_\_\_\_\_

## Avantco BCF-48-HC 47 3/16" Square Glass Black Refrigerated Bakery Display Case

Item #193BCF48B



### Technical Data

Width	47 3/16 Inches
Depth	26 5/8 Inches
Height	55 3/16 Inches
Power Cord Length	5 9/10 Feet
Interior Width	44 5/16 Inches
Interior Depth	22 13/16 Inches
Interior Height	33 1/8 Inches
Amps	7.6 Amps
Hertz	60 Hz
Phase	1 Phase

### Features

- Bright, cool LED lighting shows off your food products
- Features a square double pane anti-fogging glass design for maximum product visibility
- 3 adjustable glass shelves with 55 lb. weight capacity include price tag holders
- Sliding glass doors for easy access
- Easy-to-use digital controls; R-290 refrigerant; 1/3 hp, 115V

### Certifications



ETL, US



5-15P



ETL Sanitation

## Technical Data

Voltage	115 Volts
Capacity	18.7 cu. ft.
Capacity (per Shelf)	55 lb.
Casters	With Casters
Color	Black
Compressor Location	Bottom Mounted
Display Case Type	Refrigerated
Door Style	Sliding
Door Type	Glass
Features	LED Lighting
Glass Style	Flat
Horsepower	1/3 hp
Installation Type	Freestanding
Material	Metal
Number of Casters	4 Casters
Number of Doors	2 Doors
Number of Shelves	3 Shelves
Plug Type	NEMA 5-15P
Refrigerant Capacity	4.9 oz.
Refrigerant Type	R-290
Service Type	Full Service
Shelf Material	Glass Stainless Steel
Temperature Range	33 - 40 Degrees F
Total BTU	1261 BTU

## Plan View

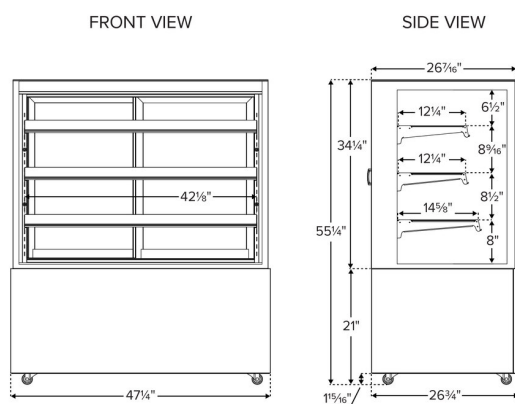



## Notes & Details

Showcase everything from cakes and pies to eclairs and flan in this Avantco BCF-48-HC 47 3/16" square glass black refrigerated bakery display case! Perfect for bakeries, cafes, coffee shops, and diners, the unit includes 3 glass shelves to help display and organize product. Additionally, it comes ready with price tag holders! Each shelf holds up to 55 lb. of weight.

Designed with double anti-fogging glass panels on 4 sides, the case provides maximum product visibility, tempting customers with decadent desserts. The rest of the exterior is black, so you can be sure that it draws attention to the treats on display. Plus, LED lighting is built-in, illuminating product for a bright, enticing display. Thanks to its rear sliding glass doors, this unit makes it easy to load and unload product without blocking walking areas. This bakery case ensures optimal performance by operating with a 1/3 hp refrigeration system that circulates R-290 hydrocarbon refrigerant to maintain temperatures from 33 to 40 degrees Fahrenheit. R-290 refrigerant has an ozone depletion potential (ODP) of 0 and a global warming potential (GWP) of 3.

The digital temperature controller ensures quick temperature readability, while a manual defrost function allows for easy maintenance. Plus, for optimal temperature retention, the case features foamed-in-place polyurethane insulation that protects the integrity of your decadent desserts. This unit includes a set of 2" casters to make it easy to move for cleaning and service. A 115V electrical connection is required for operation.

**⚠ WARNING:** This product can expose you to chemicals including lead, which are known to the State of California to cause cancer and birth defects or other reproductive harm. For more information, go to [www.p65warnings.ca.gov](http://www.p65warnings.ca.gov).