

Item #: 193BC36HCB Project: _____

Qty: _____ Date: _____ Approval: _____

Avantco BC-36-HC 36" Curved Glass Black Refrigerated Bakery Display Case

Item #193BC36HCB



Technical Data

Width	36 Inches
Depth	26 1/2 Inches
Height	48 Inches
Power Cord Length	69 Inches
Interior Width	33 13/16 Inches
Interior Depth	22 9/16 Inches
Interior Height	25 3/16 Inches
Amps	3.9 Amps
Phase	1 Phase
Voltage	115 Volts

Features

- Bright, cool LED lighting shows off your food products
- Features a curved double pane glass design for maximum product visibility
- Adjustable glass shelves with 44 lb. weight capacity; includes price tag holders
- Sliding glass doors for easy access
- Easy-to-use digital controls; R-290 refrigerant; 1/4 hp, 115V

Certifications



ETL, US



5-15P



ETL Sanitation

Technical Data

BTU (LBP)	1231 BTU
Capacity	13.8 cu. ft.
Color	Black
Compressor Location	Bottom Mounted
Display Case Type	Refrigerated
Door Type	Glass
Features	LED Lighting
Glass Style	Curved
Horsepower	2/7 hp
Installation Type	Freestanding
Number of Shelves	2 Shelves
Plug Type	NEMA 5-15P
Refrigerant Capacity	4.9 oz.
Refrigerant Type	R-290
Service Type	Full Service
Temperature Range	33 - 40 Degrees F
Total BTU	1261 BTU

Plan View

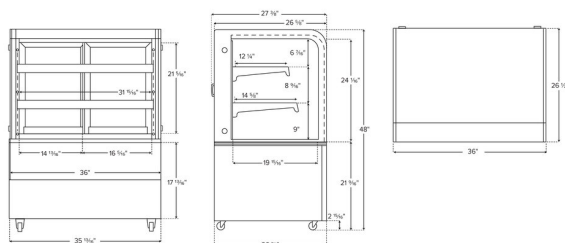

Notes & Details

Showcase everything from cakes and pies to eclairs and flan in this Avantco BC-36-HC 36" curved glass black refrigerated bakery display case! Perfect for bakeries, cafes, coffee shops, and diners, the unit includes 2 glass shelves to help display and organize product. Each shelf holds up to 44 lb. of weight.

Designed with double glass panels on 4 sides, the case provides maximum product visibility, tempting customers with decadent desserts. The rest of the exterior is black, so you can be sure that it draws attention to the treats on display. Plus, LED lighting is built-in, illuminating product for a bright, enticing display.

This bakery case ensures optimal performance by operating with a 1/4 hp refrigeration system that circulates R-290 hydrocarbon refrigerant to maintain temperatures from 33 to 40 degrees Fahrenheit. R290 refrigerant has an ozone depletion potential (ODP) of 0 and a global warming potential (GWP) of 3.

This unit includes a set of 2" casters to make it easy to move for cleaning and service. A 115V electrical connection is required for operation.

⚠ WARNING: This product can expose you to chemicals including lead, which are known to the State of California to cause cancer and birth defects or other reproductive harm. For more information, go to www.p65warnings.ca.gov.