

Item #: 178UBB72SGTS Project: _____

Qty: _____ Date: _____ Approval: _____

Avantco UBB-72S-GT-S 72" Stainless Steel Underbar Height Narrow Sliding Glass Door Back Bar Refrigerator with Galvanized Top and LED Lighting

Item #178UBB72SGTS



Technical Data

Width	72 3/4 Inches
Depth	24 7/16 Inches
Height	34 1/4 Inches
Power Cord Length	106 Inches
Interior Width	60 1/8 Inches
Left Door Opening Width	18 13/16 Inches
Middle Door Opening Width	18 5/8 Inches
Packaging Width	75 1/4 Inches
Right Door Opening Width	18 13/16 Inches
Shelf Width	19 - 20 1/2 Inches

Features

- Galvanized steel top with stainless steel interior and stainless steel exterior
- LED interior lighting
- Six adjustable epoxy-coated steel shelves can be removed to fit three 1/2 kegs
- Glass doors and bright, LED lighting ensure easy product visibility and retrieval
- 115V; 3/7 hp; 2 Amps; R290 refrigerant

Certifications



ETL, US



5-15P



ETL Sanitation



Technical Data

Interior Depth	18 1/2 Inches
Nominal Depth	Narrow
Packaging Depth	27 1/2 Inches
Shelf Depth	18 1/8 - 18 1/4 Inches
Interior Height	29 Inches
Packaging Height	41 3/4 Inches
Amps	2 Amps
Hertz	60 Hertz
Phase	1 Phase
Voltage	115 Volts
Access Type	Doors
BTU (LBP)	974 BTU
Capacity	(3) 1/2 Kegs 21.6 cu. ft.
Casters	Without Casters
Compressor Location	Side Mounted
Countertop Type	Galvanized Steel
Door Style	Sliding
Door Type	Glass
Exterior Finish	Stainless Steel
Features	Automatic Electric Defrost Digital Temperature Controller Food Rated LED Lighting
Horsepower	3/7 HP
Individual Shelf Capacity	88 lb.
Insulation Material	Polyurethane Foam
Material	Stainless Steel
Maximum Ambient Temperature	90 Degrees F
Net Weight	331 lb.
Number of 12 oz. Bottles	308 Bottles
Number of 12 oz. Cans	252 Cans
Number of Doors	3 Doors
Number of Kegs	3 Kegs
Number of Shelves	6 Shelves
Plug Type	NEMA 5-15P
Refrigerant Capacity	2.5 oz.
Refrigerant Type	R-290
Shelf Material	Epoxy-Coated Steel
Temperature Range	33 - 40 Degrees F
Top Capacity	353 lb.
Top Type	Below Counter

Plan View

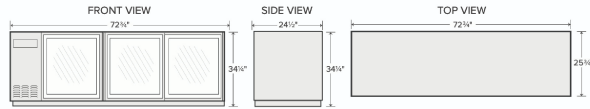

Notes & Details

Whether you operate a pub, banquet hall, catering service, or facilitate other special events, this Avantco UDD-1-HC-S beer dispenser is an excellent way to offer crisp, refreshing draft beer to your guests without investing in a complex built-in tap system! This unit features a single tap tower with a 10 1/4" faucet height that allows you to easily fill pint glasses and pitchers with local microbrews, international macrobrews, and everything in between. Its compact construction holds a 1/2 keg of beer that is concealed behind a self-closing door that not only prevents potential energy loss, but also locks to prevent theft during off hours.

Unlike many competitive beer dispensers, this model ships with a coupler so that you can tap a keg right out of the box! This commercial kegerator features a sleek stainless steel finish and a 1 1/2" thick stainless steel top that is both durable and extremely simple to clean, while a built-in drip tray further expedites end-of-day cleaning. It has a 3/7 hp refrigeration system that circulates R290 hydrocarbon refrigerant. R290 refrigerant has an ozone depletion potential (ODP) of 0 and a global warming potential (GWP) of 3, making it an energy-efficient choice for your business. This unit requires a 115V electrical connection for operation and even comes with adjustable feet for simple, convenient leveling. For long-lasting quality assurance and peace of mind, this unit also comes with a 2 year Parts and Labor Warranty.

⚠ WARNING: This product can expose you to chemicals including lead, which are known to the State of California to cause cancer, birth defects, or other reproductive harm. For more information, go to www.p65warnings.ca.gov.