

Item #: 178UBB60GHC Project: \_\_\_\_\_

Qty: \_\_\_\_\_ Date: \_\_\_\_\_ Approval: \_\_\_\_\_

## Avantco UBB-60G-HC 60" Black Counter Height Narrow Glass Door Back Bar Refrigerator with LED Lighting

Item #178UBB60GHC



### Technical Data

Width	60 3/4 Inches
Depth	25 3/4 Inches
Height	36 1/4 Inches
Power Cord Length	106 Inches
Interior Width	48 1/4 Inches
Left Door Opening Width	22 3/8 Inches
Packaging Width	63 1/2 Inches
Right Door Opening Width	22 3/8 Inches
Shelf Width	23 5/8 Inches
Interior Depth	18 1/2 Inches

### Features

- Durable stainless steel countertop and interior with black-coated steel exterior
- LED interior lighting
- Four adjustable epoxy-coated steel shelves can be removed to fit two 1/2 kegs
- Preprogrammed digital temperature controls and auto-defrost function for easy setup and maintenance
- 115V; 3/7 hp; R290 refrigerant

### Certifications



5-15P



ETL, US



ETL Sanitation

## Technical Data

Nominal Depth	Narrow
Packaging Depth	27 1/2 Inches
Shelf Depth	18 1/8 Inches
Interior Height	30 1/2 Inches
Packaging Height	41 3/4 Inches
Amps	3.5 Amps
Hertz	60 Hz
Voltage	115 Volts
Wattage	325 Watts
Access Type	Doors
BTU (LBP)	974 BTU
Capacity	(2) 1/2 Kegs 17.3 cu. ft.
Capacity (per Shelf)	88 lb.
Compressor Location	Side Mounted
Compressor Style	Front Breathing
Countertop Type	Stainless Steel
Door Style	Swing
Door Type	Glass
Exterior Finish	Black
Features	Automatic Electric Defrost Digital Temperature Controller Food Rated LED Lighting Locking Doors Removable Magnetic Door Gaskets
Horsepower	3/7 hp
Insulation Material	Polyurethane Foam
Material	Black Coated Steel / Stainless Steel
Maximum Ambient Temperature	90 Degrees F
Net Weight	276 lb.
Number of 12 oz. Bottles	252 Bottles
Number of 12 oz. Cans	192 Cans
Number of Doors	2 Doors
Number of Kegs	2 Kegs
Number of Shelves	4 Shelves
Plug Type	NEMA 5-15P
Refrigerant Capacity	2.5 oz.
Refrigerant Type	R-290
Shelf Material	Epoxy-Coated Steel
Starting Amps	10.5 Amps
Starting Wattage	975 Watts
Temperature Range	33 - 40 Degrees F
Top Capacity	353 lb.
Top Type	Counter Height

## Plan View

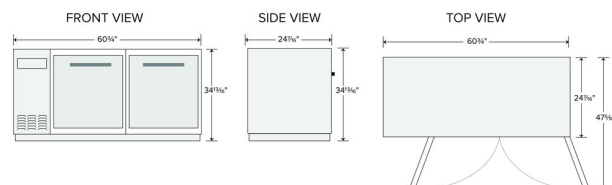

## Notes & Details

Optimize the space behind your bar by adding refrigerated storage with this Avantco 60" counter height narrow back bar refrigerator! Providing 17.3 cu. ft. of interior storage space, the unit fits up to (2) 1/2 kegs and houses (4) 23 5/8" x 18 1/8" shelves that each accommodate up to 88 lb. They're even illuminated by bright LED lighting for optimal product visibility. The epoxy-coated steel shelves are perfect for storing and organizing heavy bulk ingredients for your bar service, from bottles of ale to bottles of cider. Plus, with a narrow depth design, the unit fits in spaces other units can't, helping you to maximize the space you have available.

The interior, made of strong 304 type stainless steel, is accessible through two glass doors. Because they're made of glass, the doors provide excellent product visibility, enabling you to easily view your current drink or ingredient selection for efficient drink preparation. For overall durability, the unit's exterior is made with black coated steel and is topped with a type 304 stainless steel surface.

This back bar refrigerator ensures optimal performance by operating with a 3/7 hp refrigeration system that circulates R290 hydrocarbon refrigerant to maintain temperatures from 33 to 40 degrees Fahrenheit. R290 refrigerant has an ozone depletion potential (ODP) of 0 and a global warming potential (GWP) of 3, making it an energy-efficient choice for your business. The foamed-in-place polyurethane insulation helps to trap in the cold air and to prevent the ambient air from entering. This ensures that all beverages held in the unit remain at cool temperatures and are ready for immediate service to customers! The unit requires a 115V electrical connection for operation and even comes with adjustable feet for simple, convenient leveling.

**⚠ WARNING:** This product can expose you to chemicals including lead, which are known to the State of California to cause cancer and birth defects or other reproductive harm. For more information, go to [www.p65warnings.ca.gov](http://www.p65warnings.ca.gov).