

Item #: 178UBB378G Project: _____

Qty: _____ Date: _____ Approval: _____

Avantco UBB-378-G-HC 78" Black Counter Height Glass Door Back Bar Refrigerator with LED Lighting

Item #178UBB378G



Technical Data

Width	78 Inches
Depth	27 3/4 Inches
Height	36 1/4 Inches
Power Cord Length	96 Inches
Interior Width	66 3/8 Inches
Left Door Opening Width	20 1/4 Inches
Middle Door Opening Width	19 3/16 Inches
Packaging Width	80 11/16 Inches
Right Door Opening Width	20 1/4 Inches
Shelf Width	21 5/8 Inches

Features

- 1 1/2" thick stainless steel countertop with stainless steel interior and black exterior
- LED interior lighting and glass doors to show off beverage selection
- Six adjustable epoxy-coated steel shelves can be removed to fit four 1/2 kegs
- Preprogrammed digital temperature controls with auto-defrost function for easy setup and maintenance
- 115V; 1/4 hp; R-290 refrigerant

Certifications



ETL, US



5-15P



ETL Sanitation

Technical Data

Depth with Door Open	48 9/16 Inches
Interior Depth	21 7/8 Inches
Nominal Depth	Standard
Packaging Depth	30 5/16 Inches
Shelf Depth	21 1/4 Inches
Interior Height	30 1/2 Inches
Packaging Height	41 3/4 Inches
Amps	4.1 Amps
Hertz	60 Hz
Phase	1 Phase
Voltage	115 Volts
Wattage	385 Watts
Access Type	Doors
BTU (LBP)	974 BTU
Capacity	(4) 1/2 Kegs 25.8 cu. ft.
Capacity (per Shelf)	88 lb.
Casters	Without Casters
Compressor Location	Side Mounted
Compressor Style	Side / Rear Breathing
Countertop Type	Stainless Steel
Door Style	Swing
Door Type	Glass
Exterior Finish	Black
Features	Automatic Electric Defrost Digital Temperature Controller Food Rated LED Lighting Removable Magnetic Door Gaskets
Horsepower	1/4 hp
Insulation Material	Polyurethane Foam
Material	Black Coated Steel / Stainless Steel
Maximum Ambient Temperature	90 Degrees F
Net Weight	320 lb.
Number of 12 oz. Bottles	432 Bottles
Number of 12 oz. Cans	384 Cans
Number of Doors	3 Doors
Number of Kegs	4 Kegs
Number of Shelves	6 Shelves
Plug Type	NEMA 5-15P
Refrigerant Capacity	2.5 oz.
Refrigerant Type	R-290
Shelf Material	Epoxy-Coated Steel
Starting Amps	12.3 Amps
Starting Wattage	1155 Watts
Style	1/2 Barrel
Temperature Range	33 - 41 Degrees F
Top Capacity	353 lb.
Top Type	Counter Height

Plan View

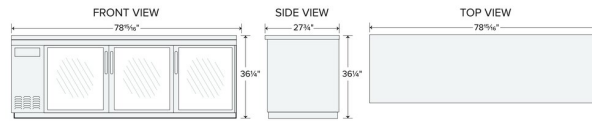

Notes & Details

Optimize the space behind your bar by adding refrigerated storage with this Avantco UBB-378-G-HC 78" counter height glass door back bar refrigerator! Providing 25.8 cu. ft. of interior storage space, the unit fits up to (4) 1/2 kegs and houses six plastic-coated shelves that each accommodate up to 88 lb. The interior is illuminated by bright LED lighting and the front doors of the unit have glass panes so that you can show off your beverage selection. The plastic-coated steel shelves are perfect for storing and organizing drinks for your bar service, from bottles of ale to bottles of cider.

The interior, made of strong 304 type stainless steel, is accessible through three glass doors. For overall durability, the unit's exterior is made with black coated steel and is topped with a type 304 stainless steel surface. This back bar refrigerator ensures optimal performance by operating with a 1/4 hp refrigeration system that circulates R-290 hydrocarbon refrigerant to maintain temperatures from 33-41 degrees Fahrenheit. R-290 refrigerant has an ozone depletion potential (ODP) of 0 and a global warming potential (GWP) of 3, making it an energy-efficient choice for your business. The foamed-in-place polyurethane insulation provides the refrigerator with additional structural integrity and ensures that all beverages held in the unit remain at cool temperatures and are ready for immediate service to customers! The unit requires a 115V electrical connection for operation and even comes with adjustable feet for simple, convenient leveling.

⚠ WARNING: This product can expose you to chemicals including lead, which are known to the State of California to cause cancer and birth defects or other reproductive harm. For more information, go to www.p65warnings.ca.gov.