

Item #: 177CHSME24IA Project: _____

Qty: _____ Date: _____ Approval: _____

Avantco CHSME24A 24" Electric Countertop Cheese Melter - 120V, 1600W

Item #177CHSME24IA



Technical Data

Width	24 Inches
Depth	12 Inches
Height	11 7/8 Inches
Power Cord Length	4 Feet
Rack Width	17 1/2 Inches
Rack Depth	10 Inches
Amps	13.33 Amps
Hertz	60 Hertz
Phase	1 Phase
Voltage	120 Volts

Features

- 17 1/2" x 10" rack fits a 10" plate or sizzle platter
- Full-width calrod heating elements and durable stainless steel construction with insulated body
- Compact countertop or wall-mount design for limited kitchen space
- 4 rack positions and removable food rack with 6" bakelite handles included
- Infinite controls and audible 15-minute timer for easy operation; 120V, 1600W

Certifications



5-15P



ETL, US & Canada



ETL Sanitation

Technical Data

Wattage	1600 Watts
Control Type	Infinite
Features	Timer
Heating Source	Metal Sheathed / Calrod
Installation Type	Countertop Wall Mounted
Material	Stainless Steel
Number of Shelves	1 Shelf
Plug Type	NEMA 5-15P
Power Type	Electric
Temperature Settings	Adjustable
Type	Cheese Melters
Usage	Standard Duty

Plan View

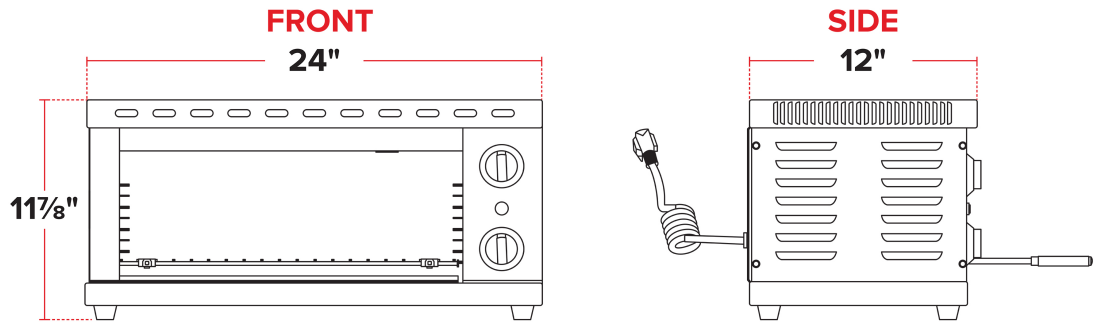

Notes & Details

Quickly melt cheese on nachos, toast roast beef sandwiches, or warm up plates with this Avantco CHSME24A 24" electric countertop cheese melter! Designed to help you quickly warm, toast, and melt appetizers, soups, sandwiches, or small dishes, this versatile cheese melter is perfect for your small-to-medium-sized restaurant or bar. Since this model has a 17 1/2" x 10" rack, it can fit plates or sizzle platters with diameters up to 10". The adjustable rack has 4 positions to meet the needs of different dishes. 6" cool-to-touch Bakelite handles make it easy to adjust or remove the food rack.

This cheese melter is made of heavy-duty stainless steel for greater durability in fast-paced kitchens. The insulated body ensures better heat retention, helping to keep food warm and reduce recovery time. High, medium, and low infinite controls are easy to use, providing ideal control over heating cycles and creating the perfect outcome for every individual dish. Also, it has a 15-minute audible timer so you can be sure your food is under the heat for the perfect amount of time.

A stainless steel removable crumb tray is included to make cleaning as easy as possible and to keep your unit free of crumbs and burnt pieces. This compact countertop model can also be wall-mounted with the included brackets to save even more counter space if desired. Non-slip rubber feet ensure the melter will stay stable on your countertop. This model requires a 120V electrical connection for operation and includes a 4' power cord.



⚠ WARNING: This product can expose you to chemicals including lead, which are known to the State of California to cause cancer, birth defects, or other reproductive harm. For more information, go to www.p65warnings.ca.gov.

Avantco Equipment