

ALTO-SHAAM.

Made in the USA with a commitment to quality. Alto-Shaam is ISO 9001:2015-certified.

- ☐ Signage Panel, POP Display
- ☐ Signage Panel, Shelf – Rotisserie Chicken
- ☐ Signage Panel, Shelf – Hot Sandwiches
- ☐ Signage Panel, Shelf – Barbecue Ribs
- ☐ Signage Panel, Shelf – Hot & Tasty
- ☐ Signage Panel, Shelf – Grab & Go
- ☐ Signage Panel, Shelf – Hot & Fresh

qty

HSM Countertop Series Heated Shelf Merchandiser



Dimension Drawings

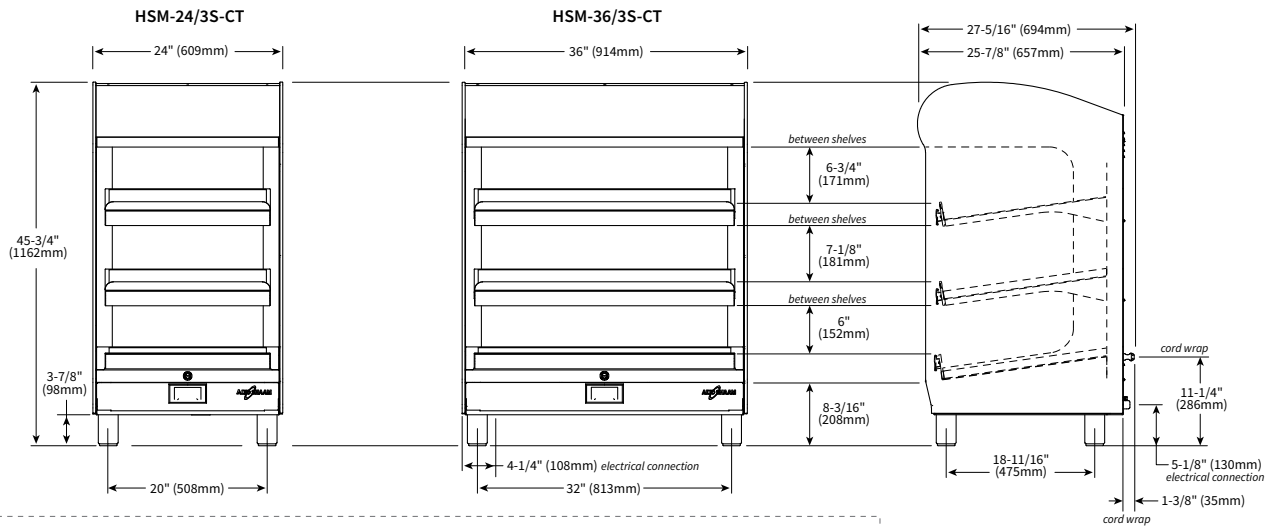

Pass-Through Maximum Openings

- ③ = Horizontal (swing doors)
- ④ = Horizontal (slide doors)
- ⑤ = Vertical

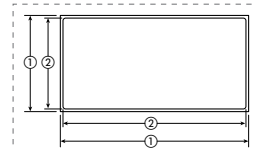
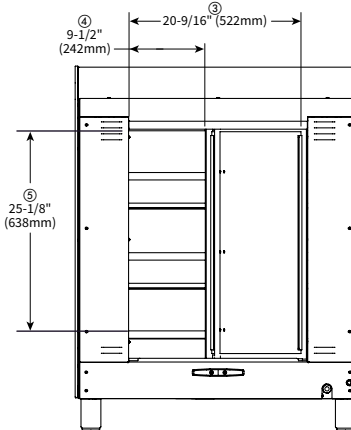
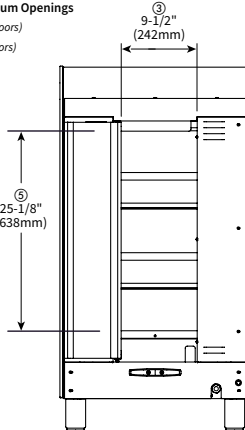

Shelf Dimensions (W x D)

- ① = Overall ② = Heated Surface

HSM-24/3S-CT

- ① 20-7/8" x 20-1/2" (530mm x 521mm)
- ② 19-7/8" x 19-1/2" (505mm x 495mm)

HSM-36/3S-CT

- ① 32-7/8" x 20-1/2" (835mm x 521mm)
- ② 31-7/8" x 19-1/2" (810mm x 495mm)

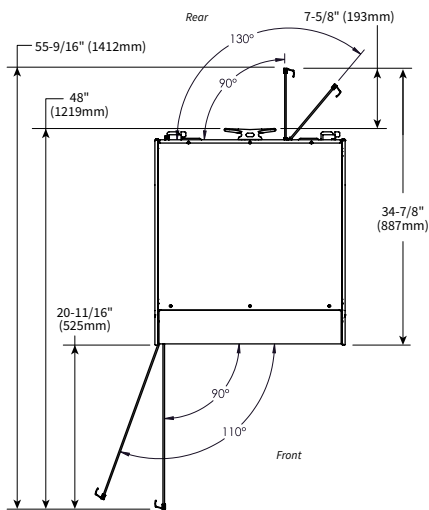

HSM-24/3S-CT Swing Door Dimensions

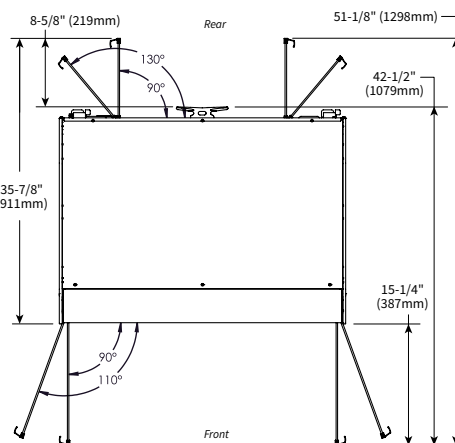

HSM-36/3S-CT Swing Door Dimensions

HSM Countertop Series Heated Shelf Merchandiser



Specifications



CHECK FIRST

- Merchandiser must be installed level.
- Merchandiser must not be installed in any area where it may be affected by steam, grease, dripping water, high temperatures, or any other severely adverse conditions.
- In order to maintain NSF standards, models must be equipped with 4" (102mm) legs or sealed at the bottom by NSF approved sealant.



CLEARANCE

Rear: 4" (102mm)

Recommended: 18" (457mm) for service access. Charges in connection with inadequate service access is not covered under warranty.



DIMENSIONS

Model	Exterior (H x W x D)	Net Weight
HSM-24/3S-CT	45-3/4" x 24" x 27-5/16" (1162mm x 609mm x 694mm)	250 lb (113 kg)
HSM-36/3S-CT	45-3/4" x 36" x 27-5/16" (1162mm x 914mm x 694mm)	311 lb (141 kg)

	Ship Dimensions (L x W x H)*	Ship Weight*
HSM-24/3S-CT	36" x 36" x 60" (914mm x 914mm x 1524mm)	300 lb (136 kg)
HSM-36/3S-CT	56" x 45" x 65" (1422mm x 1143mm x 1651mm)	417 lb (189 kg)

*Domestic ground shipping information. Contact factory for export weight and dimensions.



ELECTRIC

	V	Ph	Hz	A	kW	Plug Configuration
HSM-24/3S-CT	120	1	60	15.0	1.8	NEMA 5-20P (20A, 125V)
	208 – 240	1	60	6.5 – 7.5	1.4 – 1.8	NEMA 6-20P (20A, 250V)
	230	1	50/60	7.0	1.8	CEE 7/7 CH2-16P BS 1363
HSM-36/3S-CT	208 – 240	1	60	8.8 – 9.2	1.9 – 2.5	NEMA 6-20P (20A, 250V)
	230	1	50/60	9.0	2.1	CEE 7/7 CH2-16P BS 1363

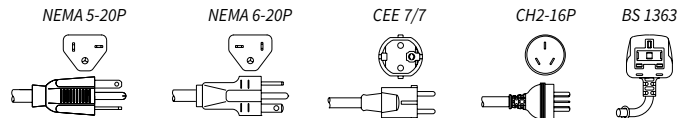

CE IP X4

CONTACT US

W164 N9221 Water Street | Menomonee Falls, Wisconsin 53051 | U.S.A.
Phone: 262.251.3800 | 800.558.8744 U.S.A./Canada | Fax: 262.251.7067 | alto-shaam.com