

INTERNAL DIMENSIONS:

L = 43-7/16"
W= 37-1/8"
H= 27-3/8"

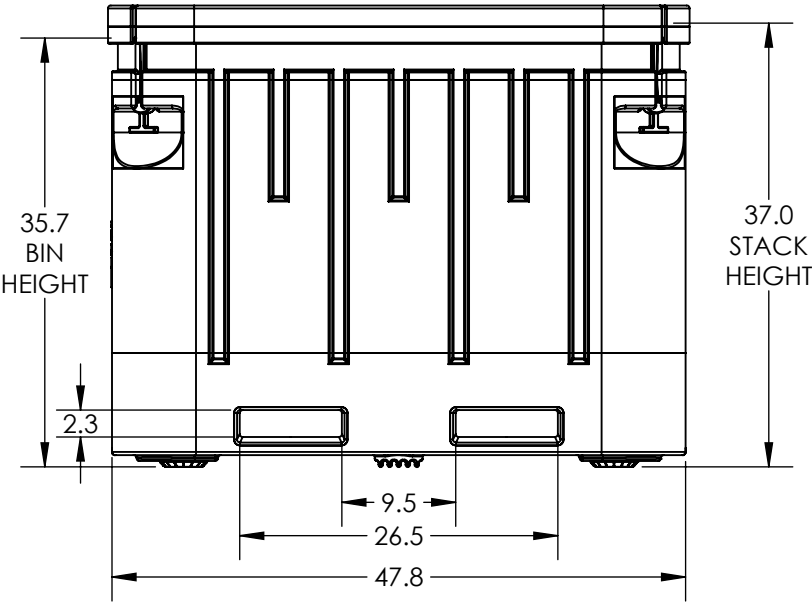
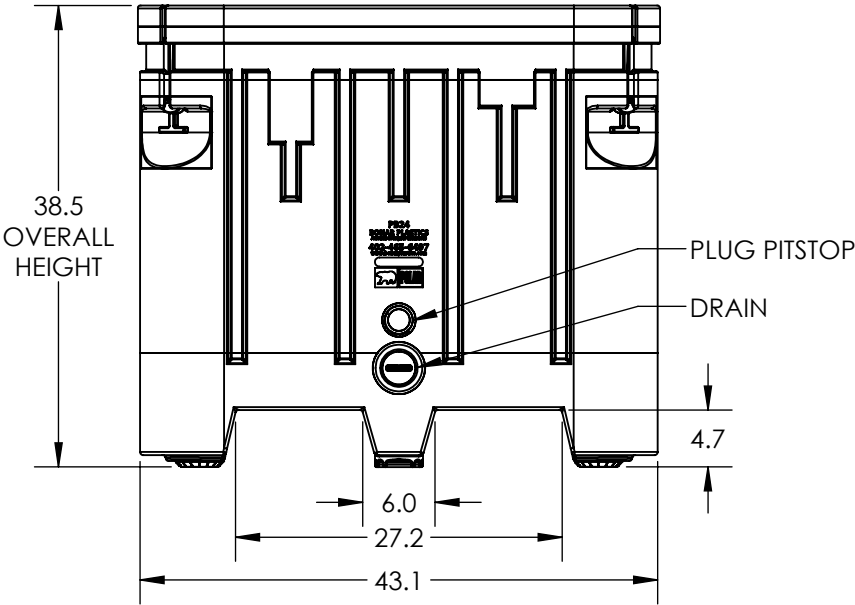
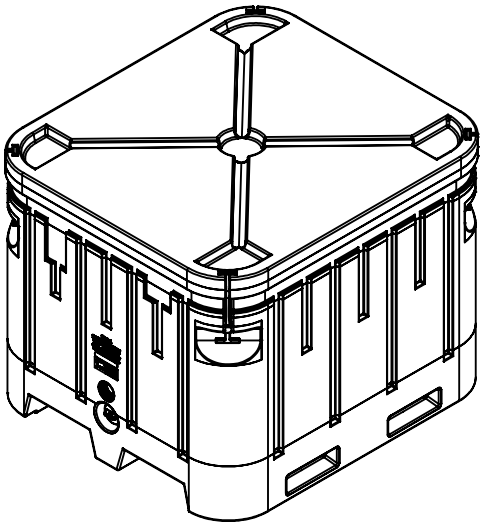

ALL DIMENSIONS ARE IN INCHES, NOMINAL, & SUBJECT TO CHANGE WITHOUT NOTICE.
ALL DIMENSIONS ON ROTATIONAL MOLDED PARTS ARE SUBJECT TO A \pm 3% TOLERANCE.

DO NOT SCALE		DRAWN BY		TITLE:		REVISION	
STATUS:		IGG		BONAR PLASTICS		ASM DI INSUL BIN PB24 WD	
© SNYDER INDUSTRIES, LLC, 2021		1005 Atlantic Drive West Chicago, IL 60185 (630)293-0303		PART NO.		SHEET	
ALL DIMENSIONS, DESIGNS, AND INFORMATION ON THIS PRINT MUST BE CONSIDERED PROPRIETARY TO SNYDER INDUSTRIES, LLC, AND MAY NOT BE USED, COPIED, OR DISTRIBUTED WITHOUT WRITTEN PERMISSION OF AN OFFICER (OR HIS AGENT) OF THE FIRM.		www.bonarplastics.com		1932401M__01		ENG. ID.	
						D007705	
						1 OF 1	