

SHALLOW ESCUTCHEON

920/921 SERIES

TrimTite™

SPECIFICATION

Sioux Chief 920/921 Series TrimTite shallow escutcheon shall be used where necessary on copper or steel stub outs. Escutcheons shall be molded from 100% corrosion proof material, having “shape-memory” to permanently retain its shape and grip on tube. Escutcheon shall be white in color and sized to work with CTS or IPS tubing.

MATERIALS

Polyethylene

DIMENSIONS

	920 Series	3/8"	1/2"	3/4"	1"		
A:	Outer diameter	2-1/2"	2-1/2"	2-1/2"	2-1/2"		
B:	Inner diameter	3/8" CTS	1/2" CTS	3/4" CTS	1" CTS		
C:	Thickness	9/16"	9/16"	9/16"	9/16"		
	921 Series		1/2"	3/4"	1"	1-1/2"	2"
A:	Outer diameter		2-1/2"	2-1/2"	3-1/2"	3-1/2"	3-1/2"
B:	Inner diameter		1/2" IPS	3/4" IPS	1" IPS	1-1/2" IPS	2" IPD
C:	Thickness		9/16"	9/16"	9/16"	9/16"	9/16"

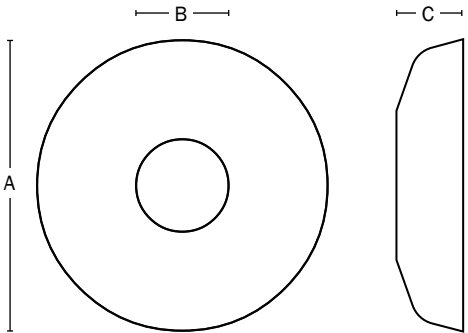

Create Item Number

A-B

e.g. **920-2W**: White polyethylene shallow escutcheon for 1/2" CTS tube

TUBING TYPE A

920 = for CTS tube

921 = for IPS tube

NOMINAL TUBE SIZE B

1W = 3/8" ¹

2W = 1/2"

3W = 3/4"

4W = 1"

6W = 1-1/2" ²

7W = 2" ²

1 Available for 920 Series only | 2 Available for 921 Series only