



# FOOD EQUIPMENT

SERVING THE FOOD INDUSTRY SINCE 1951

## 3-HP FLOOR BAND SAW

Item: 10272 Model: BS-VE-3200-S | Item: 18943 Model: BS-VE-3200-T



**CUT SLABS OF MEAT QUICKLY,  
EASILY, AND PRECISELY**

Fabricated in steel with electrostatic oven paint, complete with an aluminum head. Its stainless steel table has a four-wheel base that slides on rails. Equipped with adjustable legs. Easy to disassemble for quick cleaning and maintenance.

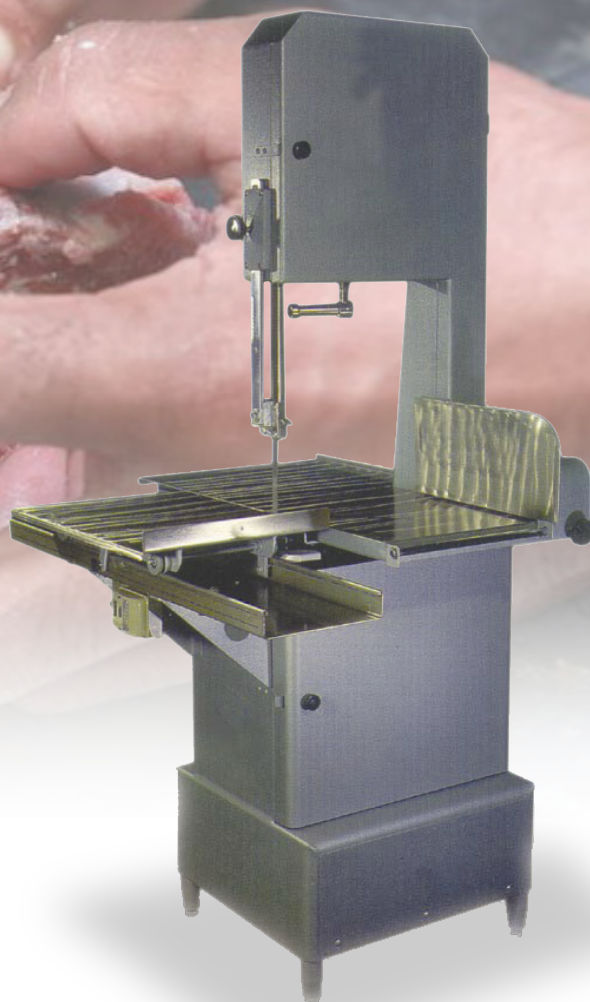

**WARRANTY**  
PARTS AND LABOR



Authorized Dealer

# FOOD EQUIPMENT

3-HP FLOOR BAND SAW BS-VE-3200-S / BS-VE-3200-T

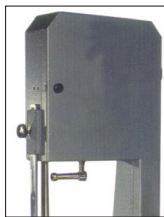

## Features

- Stainless steel finish with electrostatic oven paint
- For heavy and industrial use perfect for slaughterhouses and farms
- Easy accessibility for operation, disassembly, and cleaning

## TECHNICAL SPECIFICATIONS

|                      |                                         |                     |
|----------------------|-----------------------------------------|---------------------|
| ITEM NUMBER          | 10272                                   | 18943               |
| MODEL                | BS-VE-3200-S                            | BS-VE-3200-T        |
| POWER                | 3 HP / 2.24 kW                          |                     |
| BLADE LENGTH         | 126" / 3200 mm                          |                     |
| BLADE SAW DIMENSIONS | 0.78" x 12.60" / 20 x 320 mm            |                     |
| CUTTING CAPACITY     | 15" x 18" / 381 x 457 mm                |                     |
| POWER                | 3 HP / 2.24 kW                          |                     |
| ELECTRICAL           | 220V / 60 Hz / 1 Ph                     | 220V / 60 Hz / 3 Ph |
| AMPS                 | 11A                                     | 9A                  |
| WEIGHT               | 374 lbs. / 170 kg.                      |                     |
| PACKAGING WEIGHT     | 415 lbs. / 188 kg.                      |                     |
| PACKAGING DIMENSIONS | 40" x 54" x 96" / 1016 x 1372 x 2438 mm |                     |

## TECHNICAL DRAWING AND DIMENSIONS

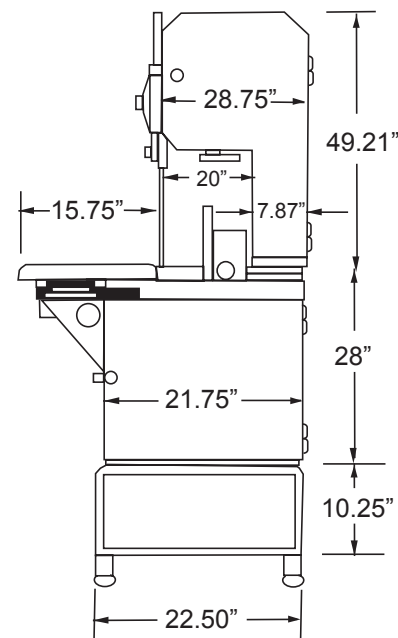
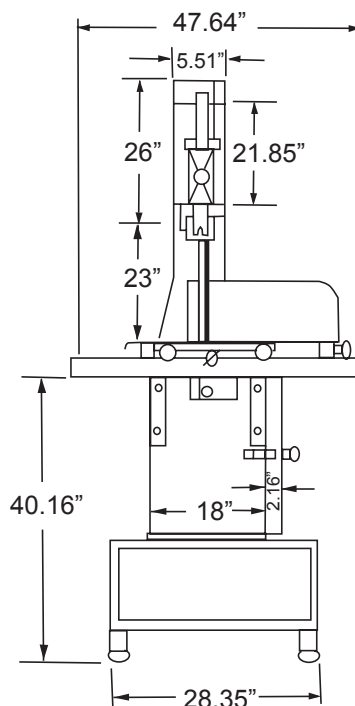

**WARRANTY**  
PARTS AND LABOR



**OMCAN INC.**

Telephone: 1-800-465-0234

Fax: (905) 607-0234

Email: [sales@omcan.com](mailto:sales@omcan.com)

Website: [www.omcan.com](http://www.omcan.com)



Follow us to keep up to date with the latest news and offers



2015.E.O.E