



Profit from the Eagle Advantage®

Specification Sheet

Short Form Specifications

Eagle Hand Sink, model HSAD-10-F. Constructed of type 304 stainless steel, all-welded with deep-drawn positive drain sink bowl, inverted "V" edge to prevent spillage, drain, and deck mounted gooseneck faucet.



#HSAD-10-F

Options / Accessories

- ☐ P-trap
- ☐ Tail piece
- ☐ End splashes
- ☐ Side mount wall bracket
- ☐ Soap & towel dispenser
- ☐ Wrist handles

EAGLE GROUP

100 Industrial Boulevard, Clayton, DE 19938-8903 USA

Phone: 302-653-3000 • Fax: 302-653-2065

www.eaglegrp.com

Foodservice Division: Phone 800-441-8440

MHC/Retail Display Divisions: Phone 800-637-5100

For custom configuration or fabrication needs, contact our **SpecFAB®** Division.

Phone: 302-653-3000 • Fax: 302-653-3091 • e-mail: specfab@eaglegrp.com

Item No.: _____
Project No.: _____
S.I.S. No.: _____

Hand Sink with Deck Mount Faucet

MODELS:

- ☐ **HSAD-10-F**

Design & Construction Features

- Type 304 stainless steel construction.
- One piece, deep-drawn, seamless bowl.
- Inverted "V" edge rim retards spillage.
- All-welded construction.
- Faucet provided features ½" (13mm) NPS male inlets, and comes with mounting hardware.
- Includes 1½" (38mm) stainless steel basket waste, crumb cup, and deck mount faucet with swivel gooseneck spout.
- Stainless steel wall bracket provided for wall-hung installation.
- Positive drain bowl.

Certifications / Approvals



Spec sheets available for viewing, printing or downloading from our online literature library at www.eaglegrp.com

Eagle Foodservice Equipment, Eagle MHC, SpecFAB®, and Retail Display are divisions of Eagle Group. ©2009 by the Eagle Group

Item No.: _____
Project No.: _____
S.I.S. No.: _____

Hand Sink with Deck Mount Faucet

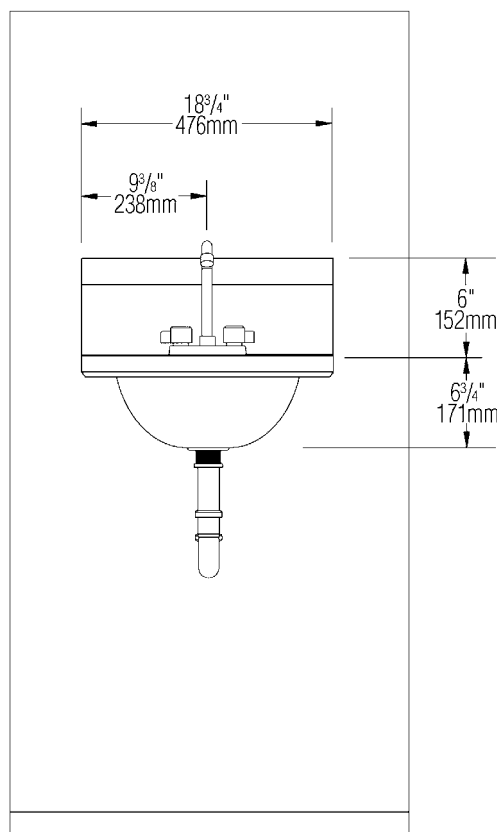

FRONT VIEW

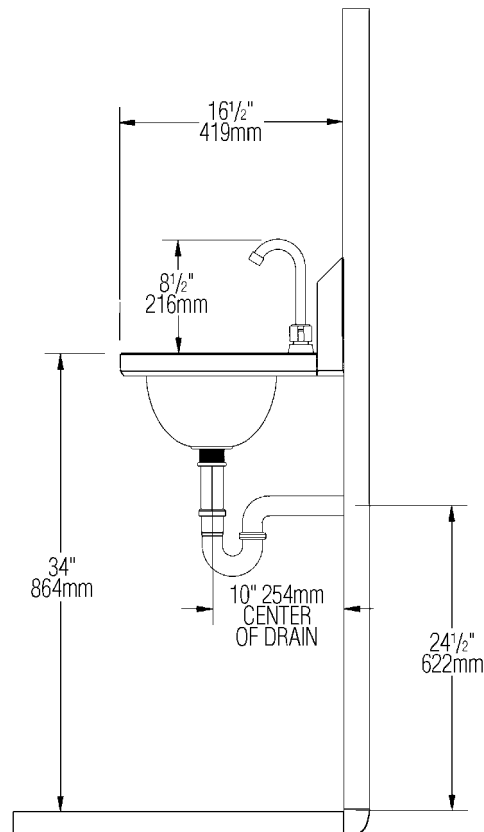

SIDE VIEW

Please note: optional tail piece and P-trap shown

model #	bowl size		overall size		weight lbs. kg
	width in.	length x depth mm	width in.	length x height mm	
HSAD-10-F	9 3/4"	13 1/2" x 6 3/4"	16 1/2"	18 7/8" x 12 3/4"	14 6.4
		248 x 343 x 173		376 x 480 x 324	

EAGLE GROUP
100 Industrial Boulevard, Clayton, DE 19938-8903 USA
Phone: 302-653-3000 • Fax: 302-653-2065
www.eaglegrp.com

Foodservice Division: Phone 800-441-8440
MHC/Retail Display Divisions: Phone 800-637-5100

Printed in U.S.A.
©2009 by Eagle Group
Rev. 06/09

Spec sheets available for viewing, printing or downloading from our online literature library at www.eaglegrp.com

Although every attempt has been made to ensure the accuracy of the information provided, we cannot be held responsible for typographical or printing errors. Information and specifications are subject to change without notice. Please confirm at time of order.