



Profit from the Eagle Advantage®

Specification Sheet

Short Form Specifications

Eagle Full Size Hot Food Merchandising Cart, model HDC48-120NYF. Heavy gauge stainless steel construction with two insulated heating wells, color-coordinated umbrella, one full-size 12" x 20" pan with hinged lid, one ⅜-size inset with hinged lid, and one ⅜-size inset with hinged lid and two 1¼-qt. insets inside. Two 20" ball bearing wheels with rubber tires and one 8" swivel caster. 120-volt 15-amp cord and plug.



Options / Accessories

- ☐ Tongs
- ☐ Ladles

EAGLE GROUP

100 Industrial Boulevard, Clayton, DE 19938-8903 USA

Phone: 302-653-3000 • Fax: 302-653-2065

www.eaglegrp.com

Foodservice Division: Phone 800-441-8440

MHC/Retail Display Divisions: Phone 800-637-5100

For custom configuration or fabrication needs, contact our **SpecFAB®** Division.

Phone: 302-653-3000 • Fax: 302-653-3091 • e-mail: specfab@eaglegrp.com

Item No.: _____
Project No.: _____
S.I.S. No.: _____

Hot Food Merchandising Cart

MODEL:

☐ **HDC48-120NYF**

Design and Construction Features

- Stainless steel construction.
- Two insulated heating wells.
- Solid top work surface.
- 120V operation with cord and 15-amp plug.
- 20" (508mm) ball bearing wheels with rubber tires.
- One 8" (203mm) diameter swivel caster.
- One full-size inset with roll top cover.
- One ⅜-size inset with hinged lid.
- One ⅜-size inset with hinged lid with two 1¼-quart insets inside.
- Color-coordinated umbrella.

Certifications / Approvals



Spec sheets available for viewing, printing or downloading from our online literature library at www.eaglegrp.com

Eagle Foodservice Equipment, Eagle MHC, SpecFAB®, and Retail Display are divisions of Eagle Group. ©2009 by the Eagle Group



Item No.: _____
 Project No.: _____
 S.I.S. No.: _____

Hot Food Merchandising Cart

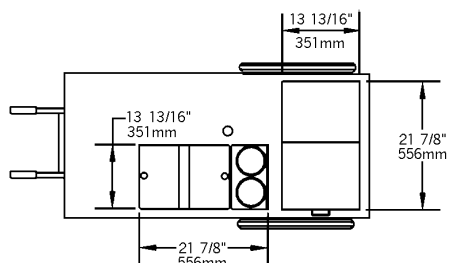

TOP VIEW

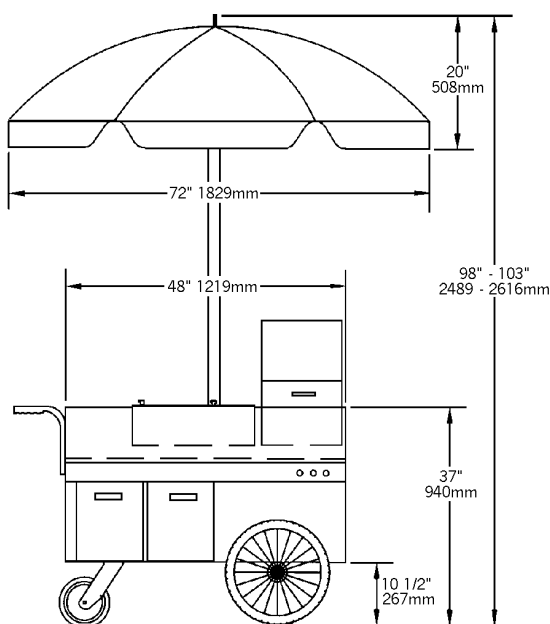

SIDE VIEW

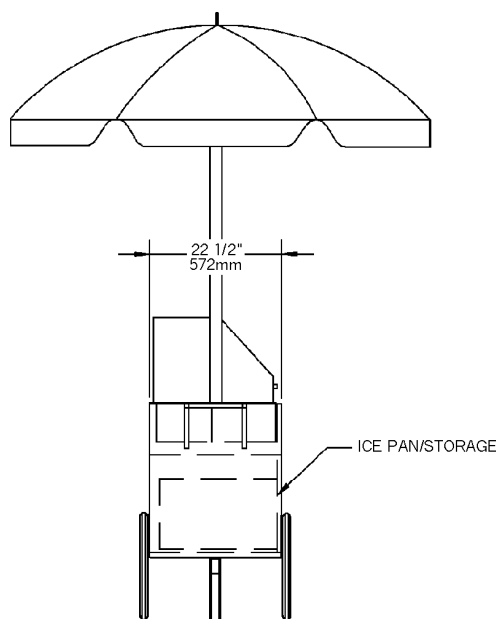

FRONT VIEW

model #	width		length		weight		description
	in.	mm	in.	mm	lbs.	kg	
HDC48-120NYF	22½"	572	48"	1219	467	212	with hinged lids

EAGLE GROUP
 100 Industrial Boulevard, Clayton, DE 19938-8903 USA
 Phone: 302-653-3000 • Fax: 302-653-2065
www.eaglegrp.com

Foodservice Division: Phone 800-441-8440
 MHC/Retail Display Divisions: Phone 800-637-5100

Printed in U.S.A.
 ©2009 by Eagle Group
 Rev. 06/09

Spec sheets available for viewing, printing or downloading from our online literature library at www.eaglegrp.com

Although every attempt has been made to ensure the accuracy of the information provided, we cannot be held responsible for typographical or printing errors. Information and specifications are subject to change without notice. Please confirm at time of order.