



T&S BRASS AND BRONZE WORKS, INC.
 2 Saddleback Cove / P.O. Box 1088
 Travelers Rest, SC 29690

Model No.
EC-3106-VF05

Item No.

Travelers Rest, SC: 800-476-4103 • Simi Valley, CA: 800-423-0150 • Fax: 864-834-3518 • www.tsbrass.com



ADA Compliant
 (Automatic Electronic
 Operation Only)



This Space for Architect/Engineer Approval

Job Name _____ Date _____
 Model Specified _____ Quantity _____
 Customer/Wholesaler _____
 Contractor _____
 Architect/Engineer _____

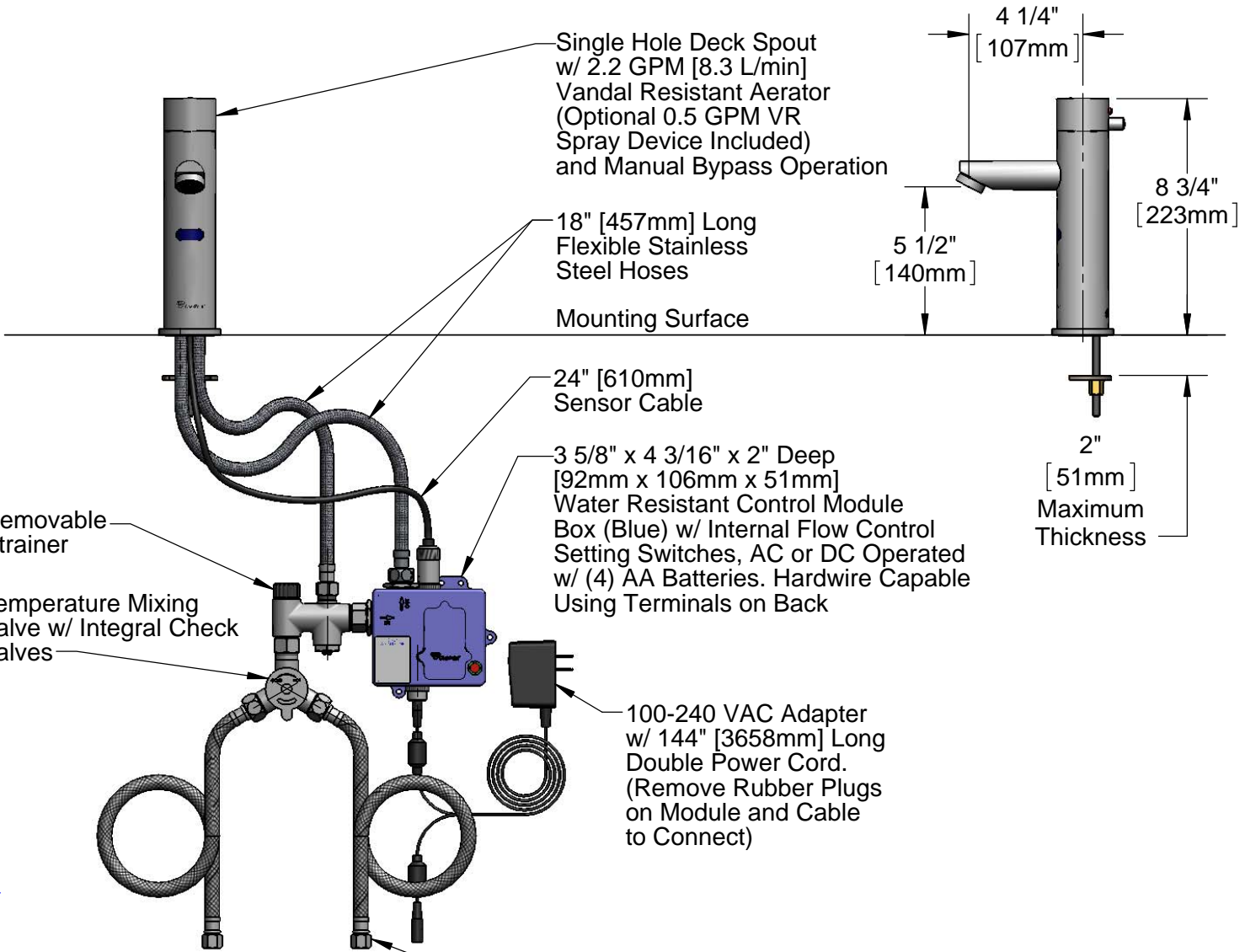
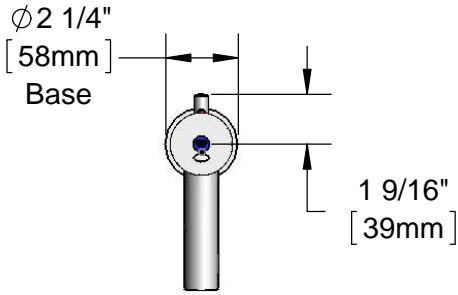

Rough-In Requirement:
 ϕ 1 1/4" [32mm] Mounting Hole

(2) 3/8" Compression x 1/2" NPSM
 18" [457mm] Flexible Stainless Steel
 Supply Hose

Product Specifications:

Chrome Plated Brass Electronic Faucet:
 Single Hole Deck Spout w/ VR 2.2 GPM Aerator, Optional 0.5 GPM
 VR Spray Device, Manual Bypass, AC/DC Control Module w/ Internal
 Flow Control Setting Switches, Temperature Control Mixing Valve,
 18" Long Supply Stop Flexible Connector Hoses

Drawn KJG	Checked DMH	Approved JHB
Scale: 1:6		Date: 09/27/12



T&S BRASS AND BRONZE WORKS, INC.

2 Saddleback Cove / P.O. Box 1088
Travelers Rest, SC 29690

Model No.

EC-3106-VF05

Item No.

Travelers Rest, SC: 800-476-4103 • Simi Valley, CA: 800-423-0150 • Fax: 864-834-3518 • www.tsbrass.com

ITEM NO.	SALES NO.	DESCRIPTION
1	016647-45	ChekPoint Module (Blue)
2	5EF-0002	Double Gang, Plug-in AC Transformer
3	5EF-0006	Mechanical Mixing Valve
4	5EF-0005	Supply Hose, 9/16-24 Female x 1/2" NPSM
5	015425-45	Vandal Resistant Key
6	B-0199-09	VR 2.2 GPM Aerator w/ Key
7	B-0199-09-N05	0.5 GPM VR Spray Device, 15/16-27 Male
8	EC-FILTER	Replacement Filter

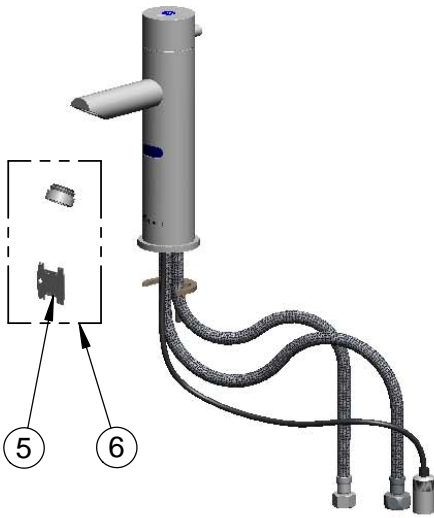

A Maximum of (8) ChekPoint Faucets Can be Hardwire Connected and Powered by ChekPoint Hardwire AC Transformer. EC-HARDWIRE (Sold Separately)

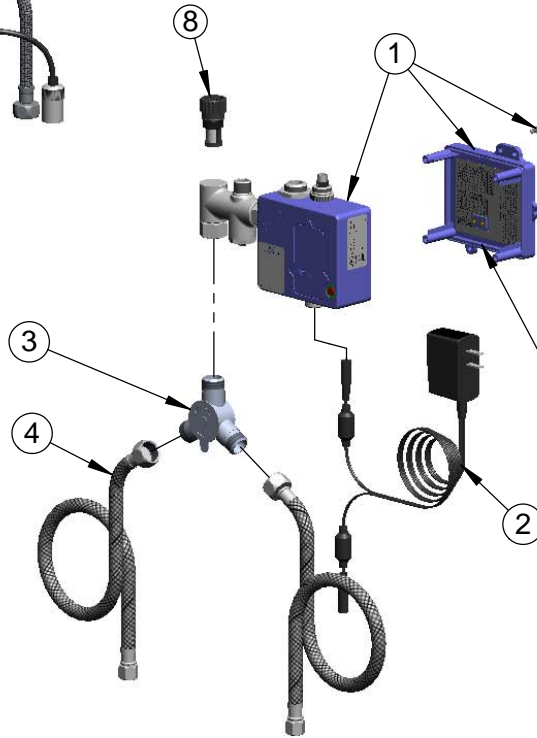
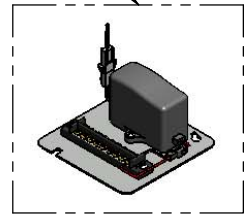

Label for Flow Control Switch Settings is Located on Inside of Back Cover.

Flow Control Switches are Located Inside Module Housing in Black Box Next to Battery Compartment.
*Switches are Set to DEFAULT Position:
Auto Time Out = 10 second
Shut Off Delay = 1 second
Auto Flush = OFF

Remove (4) Screws and Back Cover to Access Switches.

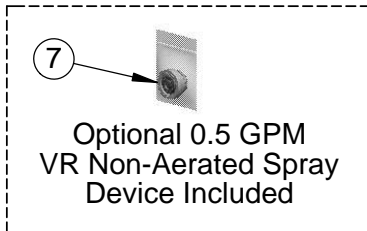

Optional 0.5 GPM VR Non-Aerated Spray Device Included

***Available Water Flow Control Selections:**

(6) Auto Time Out Selections - 10 sec, 25 sec, 45 sec, 60 sec, 3 min, 20 min

(4) Shut Off Delay Selections - 1 sec, 2 sec, 4 sec, 10 sec

Auto Flush for 30 Seconds After Every 12 Inactive Hours - ON or OFF

Product Specifications:

Chrome Plated Brass Electronic Faucet:
Single Hole Deck Spout w/ VR 2.2 GPM Aerator, Optional 0.5 GPM VR Spray Device, Manual Bypass, AC/DC Control Module w/ Internal Flow Control Setting Switches, Temperature Control Mixing Valve, 18" Long Supply Stop Flexible Connector Hoses

Drawn KJG	Checked DMH	Approved JHB
Scale: NTS		Date: 09/27/12