



Item # \_\_\_\_\_

Job \_\_\_\_\_

## WIRE SHELVING ACCESSORIES

### Shelf Dividers for Super Erecta and Super Adjustable Shelves

Keep shelf contents orderly with these 8" (203mm) high, pressure-fit dividers. Unique design allows them to attach to the top or underside of shelves.

Model No. Chrome	Model No. Black	Model No. White	Model No. Smoked Glass	Model No. Metroseal 3 with Microban®	Model No. Stainless	Model No. Designer Colors*	Shelf Width (in.) (mm)	Approx. Pkd. Wt. (lbs.) (kg)
DD14C	DD14BL	DD14W	DD14-DSG	DD14K3	DD14S	DD14-D	14 355	1.8 0.8
DD18C	DD18BL	DD18W	DD18-DSG	DD18K3	DD18S	DD18-D	18 457	2.25 1.0
DD21C	DD21BL	DD21W	DD21-DSG	DD21K3	DD21S	DD21-D	21 530	2.5 1.1
DD24C	DD24BL	DD24W	DD24-DSG	DD24K3	DD24S	DD24-D	24 610	2.75 1.3
DD30C	DD30BL	DD30W	DD30-DSG		DD30S		30 760	3.25 1.5
DD36C	DD36BL	DD36W	DD36-DSG		DD36S		36 914	3.75 1.7

Dividers cannot be stacked.

For OTR applications, additional clamping may be required to keep dividers in place. Consult Metro engineering.

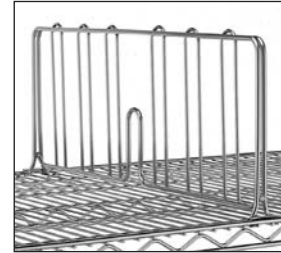

**Shelf Divider for Super Erecta Shelves**

### Shelf Ledges — Side and Back

For stationary or mobile installations, ledges prevent items from protruding or falling from shelves.

#### 1" (25mm) High Ledges

Model No. Chrome	Model No. Black	Model No. White	Model No. Smoked Glass	Model No. Stainless	Model No. Designer Colors*	Length (in.) (mm)	Approx. Pkd. Wt. (lbs.) (kg)
L14N-1C	L14N-1BL	L14N-1W	L14N-1-DSG	L14N-1S	L14N-1-D	14 355	0.58 0.25
L18N-1C	L18N-1BL	L18N-1W	L18N-1-DSG	L18N-1S	L18N-1-D	18 457	0.75 0.33
L21N-1C	L21N-1BL	L21N-1W	L21N-1-DSG	L21N-1S	L21N-1-D	21 530	0.75 0.33
L24N-1C	L24N-1BL	L24N-1W	L24N-1-DSG	L24N-1S	L24N-1-D	24 610	1.0 0.45
L30N-1C	L30N-1BL	L30N-1W	L30N-1-DSG	L30N-1S	L30N-1-D	30 760	2.0 0.9
L36N-1C	L36N-1BL	L36N-1W	L36N-1-DSG	L36N-1S	L36N-1-D	36 914	2.5 1.13
L42N-1C	L42N-1BL	L42N-1W	L42N-1-DSG	L42N-1S	L42N-1-D	42 1066	2.75 1.25
L48N-1C	L48N-1BL	L48N-1W	L48N-1-DSG	L48N-1S	L48N-1-D	48 1219	3.5 1.58
L54N-1C	L54N-1BL	L54N-1W	L54N-1-DSG	L54N-1S	L54N-1-D	54 1370	4.4 1.65
L60N-1C	L60N-1BL	L60N-1W	L60N-1-DSG	L60N-1S	L60N-1-D	60 1524	3.75 1.68
L72N-1C	L72N-1BL	L72N-1W	L72N-1-DSG	L72N-1S	L72N-1-D	72 1828	4.0 1.81

**Note:** Actual length is approximately 1" (25mm) shorter than nominal shelf length/width.

1" (25mm) ledges are not stackable.

Ledges may also be used on the interior of a shelf (lengthwise) by attaching directly above a snake truss. Interior snake trusses are found on shelf widths of 21" (530mm) and larger.

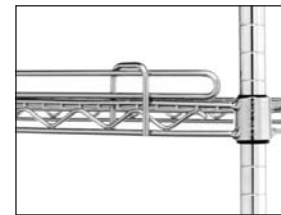

**1" (25mm) Ledge**

#### 4" (100mm) High Stackable Ledges

Ledges may be stacked to form an 8" (203mm) or higher barrier.

Model No. Chrome	Model No. Black	Model No. White	Model No. Smoked Glass	Model No. Metroseal 3 with Microban®	Model No. Stainless	Model No. Designer Colors*	Shelf Width (in.) (mm)	Approx. Pkd. Wt. (lbs.) (kg)
L14N-4C	L14N-4BL	L14N-4W	L14N-4-DSG	L14N-4K3	L14N-4S	L14N-4-D	14 355	0.8 0.3
L18N-4C	L18N-4BL	L18N-4W	L18N-4-DSG	L18N-4K3	L18N-4S	L18N-4-D	18 457	1.5 0.6
L21N-4C	L21N-4BL	L21N-4W	L21N-4-DSG	L21N-4K3	L21N-4S	L21N-4-D	21 530	1.7 0.7
L24N-4C	L24N-4BL	L24N-4W	L24N-4-DSG	L24N-4K3	L24N-4S	L24N-4-D	24 610	2.0 0.9
L30N-4C	L30N-4BL	L30N-4W	L30N-4-DSG	L30N-4K3	L30N-4S	L30N-4-D	30 760	2.2 1.0
L36N-4C	L36N-4BL	L36N-4W	L36N-4-DSG	L36N-4K3	L36N-4S	L36N-4-D	36 914	2.7 1.2
L42N-4C	L42N-4BL	L42N-4W	L42N-4-DSG	L42N-4K3	L42N-4S	L42N-4-D	42 1066	3.2 1.4
L48N-4C	L48N-4BL	L48N-4W	L48N-4-DSG	L48N-4K3	L48N-4S	L48N-4-D	48 1219	3.7 1.6
L54N-4C	L54N-4BL	L54N-4W	L54N-4-DSG	L54N-4K3	L54N-4S	L54N-4-D	54 1370	3.8 1.7
L60N-4C	L60N-4BL	L60N-4W	L60N-4-DSG	L60N-4K3	L60N-4S	L60N-4-D	60 1524	4.0 1.8
L72N-4C	L72N-4BL	L72N-4W	L72N-4-DSG	L72N-4K3	L72N-4S	L72N-4-D	72 1828	5.0 2.2

**Note:** Actual length is approximately 1" (25mm) shorter than nominal shelf length/width.

Ledges may also be used on the interior of a shelf (lengthwise) by attaching directly above a snake truss. Interior snake trusses are found on shelf widths of 21" (530mm) and larger.

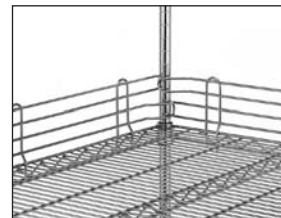

**4" (102mm) Ledge**

### Designer Shelf Colors

\*To order a Designer Color, add the appropriate color suffix to the desired catalog numbers above (example: 18"x36" [457x914mm] Hunter Green Shelf = 1836N-DHG).

**BM** — Black Matte      **SH** — Silver Hammertone      **HG** — Hunter Green  
**F** — Flame              **CH** — Copper Hammertone

\*MICROBAN® and the MICROBAN® symbol are registered trademarks of the Microban Products Company, Huntersville, NC.



**InterMetro Industries Corporation**  
North Washington Street  
Wilkes-Barre, PA 18705  
www.metro.com





# WIRE SHELVING ACCESSORIES

## Snap-On Dividers for Drop Mat Shelves

Organize your shelves with these 8" (203mm) high, easy to snap-in-place dividers.

Model No. Chrome	Model No. Black	Model No. White	Model No. Smoked Glass	Model No. Designer Colors*	Fits Shelf Width (in.) (mm)		Approx. Pkd. Wt. (lbs.) (kg)	
HD18C	HD18B	HD18W	HD18-DSG	HD18-D	18	457	2.5	1.1
HD24C	HD24B	D24W	HD24-DSG	HD24-D	24	614	3.5	1.6

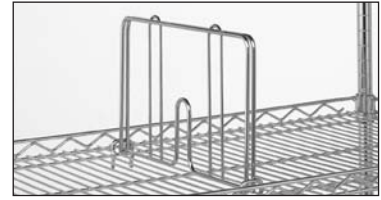

Snap-On Divider

## Super Erecta Slide System (for tote boxes)

Using Super Erecta or Super Adjustable Super Erecta wire units, tote boxes, and these innovative slides, you have the flexibility to create a custom configuration that can be positioned quickly on new or existing units without the use of tools.

Model No.	Outside Slide Dimensions Height/Width/Length (in.) (mm)		For Shelf Width (in.) (mm)	Adaptable Boxes	Approx. Pkd. Wt. (lbs.) (kg)	
SS2NC	10 <sup>1</sup> / <sub>4</sub> x20 <sup>3</sup> / <sub>8</sub> x21 <sup>5</sup> / <sub>8</sub>	256x510x537	24 610	TB/MTB93030W, TB/MTB93060W, TB/MTB93080W	4 <sup>3</sup> / <sub>4</sub>	2.1
SS3NC	10 <sup>1</sup> / <sub>4</sub> x14x17 <sup>1</sup> / <sub>8</sub>	256x355x430	21 530	TB/MTB92035W, TB/MTB92060W, TB/MTB92080W	3 <sup>1</sup> / <sub>2</sub>	1.5
SS4NC	10 <sup>1</sup> / <sub>4</sub> x25 <sup>1</sup> / <sub>8</sub> x17 <sup>1</sup> / <sub>8</sub>	256x630x430	21 530	TB/MTB93030W,* TB/MTB93060W,* TB/MTB93080W*	4	1.8

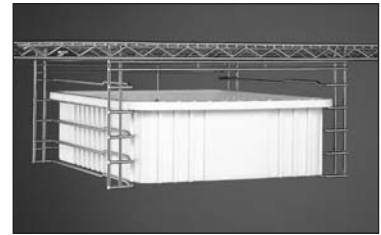

Super Erecta Slide System in place on shelf (Tote box sold separately)

\*Fits SS4NC with box turned sideways.

**Note:**

SS2NC may also be used on 30" (760mm) and 36" (910mm) width shelves.  
Load ratings: 25 lbs. (11.3kg) max per slide level, not to exceed 50 lbs. (22.6 kg) per slide system.  
These slides do NOT work with 12"x20" (305x508mm) steam table pans or 18"x26" (457x660mm) bun pans.

## One-Piece Slides

One-piece solid slide attaches easily to shelf with support brackets.

Model No.	For Shelf Width (in.) (mm)		Approx. Pkd. Wt. (lbs.) (kg)	
BSD2224NB	24	610	5 <sup>1</sup> / <sub>2</sub>	2.47

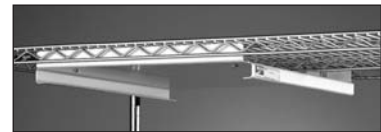

One-Piece Slide

Not adaptable to 24" (610mm) long shelf.  
Can use (2) on a 24"x48" (610x1219mm) shelf.  
Can use (3) on a 24"x60" (610x1524mm) shelf.

## Adjustable Undershelf Slides

These slides can be spaced to fit any width container or tote box.

Model No. (pair)	For Shelf Width (in.) (mm)		Approx. Pkd. Wt. (lbs.) (kg)	
US18NA	18	457	1	0.4
US21NA	21	530	1	0.4
US24NA	24	610	1	0.4



Adjustable Undershelf Slide

\*Not adaptable to 24" (610mm) long shelf.

## Tray Slides

Free up shelves for more efficient use of space. Adaptable slides work with TB93000 and MTB93000 series tote boxes, 12"x20" (305x508mm) steam table pans, or 18"x26" (457x660mm) bun pans. Available in chrome and Metroseal 3 finishes. 22<sup>3</sup>/<sub>4</sub>" H (578mm).

Model No. Chrome	Model No. Metroseal 3 with Microban®	Width (in.) (mm)		Overall Depth (in.) (mm)	Slide Profile (in.) (mm)	On Center Slide Spacing (in.) (mm)	Fits Shelf Width (in.) (mm)	Approx. Weight/Pair (lbs.) (kg)	
15SNC	15SNK3	14 <sup>5</sup> / <sub>8</sub>	371	2 <sup>1</sup> / <sub>4</sub> 56	1 <sup>1</sup> / <sub>2</sub> 37	1 <sup>1</sup> / <sub>2</sub> 37	18 457	9 <sup>1</sup> / <sub>2</sub>	4.3
20SNC	20SNK3	20	508	2 <sup>1</sup> / <sub>4</sub> 56	1 <sup>1</sup> / <sub>2</sub> 37	1 <sup>1</sup> / <sub>2</sub> 37	24 610	11	5.0

Load rating: 25 lbs. (11.3kg) max per slide level, not to exceed 50 lbs. (22.6kg) per slide system.  
20SNC / K3 will fit 30" (760mm) and 36" (910mm) shelves.

Shelf Lengths	Tray Slides per Level
24" (610mm) through 42" (1066mm)	1
48" (1219mm)	1 or 2
60" (1524mm)	2
72" (1829mm)	2 or 3

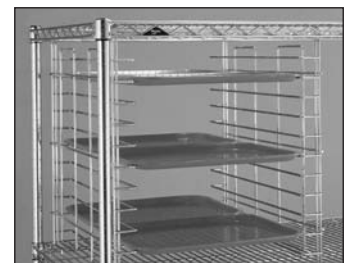

Tray Slides

\*MICROBAN® and the MICROBAN® symbol are registered trademarks of the Microban Products Company, Huntersville, NC.

# WIRE SHELVING ACCESSORIES



## Enclosure Panels

An efficient way to enclose space for stationary or mobile applications.

- Can be used with Super Erecta® and Super Adjustable wire shelving, and Super Erecta solid shelving.
- Appropriate mounting hardware supplied with each panel.



Enclosure Panel

## Enclosure Panels for Super Erecta Wire and Solid, Super Adjustable and MetroMax Q Shelving Units

Model No. Chrome	Model No. Stainless	Width/Height		For Nominal Post Height		Grid Opening		Weight	
		(in.)	(mm)	(in.)	(mm)	(in.)	(mm)	(lbs.)	(kg)
EP35C	EP35S	12 <sup>3</sup> / <sub>8</sub> x 50 <sup>3</sup> / <sub>4</sub>	313 x 1289	54	1370	2 <sup>7</sup> / <sub>8</sub> x 3 <sup>5</sup> / <sub>8</sub>	73 x 92	3	1.4
EP36C	EP36S	12 <sup>3</sup> / <sub>8</sub> x 59 <sup>3</sup> / <sub>4</sub>	313 x 1518	63	1600	2 <sup>7</sup> / <sub>8</sub> x 3 <sup>5</sup> / <sub>8</sub>	73 x 92	4	1.8
EP37C	—	12 <sup>3</sup> / <sub>8</sub> x 70 <sup>1</sup> / <sub>2</sub>	313 x 1791	74	1880	2 <sup>7</sup> / <sub>8</sub> x 3 <sup>5</sup> / <sub>8</sub>	73 x 92	6	2.7
EP55C	EP55S	18 <sup>3</sup> / <sub>8</sub> x 50 <sup>3</sup> / <sub>4</sub>	464 x 1289	54	1370	3 <sup>3</sup> / <sub>8</sub> x 3 <sup>5</sup> / <sub>8</sub>	86 x 92	5	2.3
EP56C	EP56S	18 <sup>3</sup> / <sub>8</sub> x 59 <sup>3</sup> / <sub>4</sub>	464 x 1518	63	1600	3 <sup>3</sup> / <sub>8</sub> x 3 <sup>5</sup> / <sub>8</sub>	86 x 92	6	2.7
EP57C	—	18 <sup>3</sup> / <sub>8</sub> x 70 <sup>1</sup> / <sub>2</sub>	464 x 1791	74	1880	3 <sup>3</sup> / <sub>8</sub> x 3 <sup>5</sup> / <sub>8</sub>	86 x 92	7	3.2

All panels are 7/16" (22mm) thick.

## Panels Required for Super Erecta Wire and Solid and Super Adjustable Shelving Units

**Ends** — Panels required for each end, as follows:

Nominal Post Height (in.)	Nominal Post Height (mm)	18" (457mm)		21" (530mm)		24" (610mm)		30" (760mm)		36" (914mm)	
		Nominal Shelf Width	Nominal Shelf Width	Nominal Shelf Width	Nominal Shelf Width	Nominal Shelf Width	Nominal Shelf Width	Nominal Shelf Width	Nominal Shelf Width		
54	1370	EP35	EP35	EP55	(2) EP35	(1) EP35, (1) EP55	(1) EP35, (1) EP55	(1) EP35, (1) EP55	(1) EP35, (1) EP55	(1) EP35, (1) EP55	
63	1600	EP36	EP36	EP56	(2) EP36	(1) EP36, (1) EP56	(1) EP36, (1) EP56	(1) EP36, (1) EP56	(1) EP36, (1) EP56	(1) EP36, (1) EP56	
74	1880	EP37	EP37	EP57	(2) EP37	(1) EP37, (1) EP57	(1) EP37, (1) EP57	(1) EP37, (1) EP57	(1) EP37, (1) EP57	(1) EP37, (1) EP57	

**Backs** — Require multiple panels as follows:

### WIRE SHELVES

Nominal Post Height (in.)	Nominal Post Height (mm)	30" (760mm)		36" (914mm)		42" (1060mm)		48" (1219mm)		54" (1370mm)		60" (1524mm)		72" (1825mm)	
		Nominal Shelf Length	Nominal Shelf Length	Nominal Shelf Length	Nominal Shelf Length	Nominal Shelf Length	Nominal Shelf Length	Nominal Shelf Length	Nominal Shelf Length	Nominal Shelf Length	Nominal Shelf Length	Nominal Shelf Length	Nominal Shelf Length	Nominal Shelf Length	
54	1370	(2) EP35	(1) EP35, (1) EP55	(2) EP55	(2) EP35, (1) EP55	(1) EP35, (2) EP55	(3) EP55	(1) EP35, (3) EP55	(1) EP35, (3) EP55	(1) EP35, (3) EP55	(1) EP35, (3) EP55	(1) EP35, (3) EP55	(1) EP35, (3) EP55		
63	1600	(2) EP36	(1) EP36, (1) EP56	(2) EP56	(2) EP36, (1) EP56	(1) EP36, (2) EP56	(3) EP56	(1) EP36, (3) EP56	(1) EP36, (3) EP56	(1) EP36, (3) EP56	(1) EP36, (3) EP56	(1) EP36, (3) EP56	(1) EP36, (3) EP56		
74	1880	(2) EP37	(1) EP37, (1) EP57	(2) EP57	(2) EP37, (1) EP57	(1) EP37, (2) EP57	(3) EP57	(1) EP37, (3) EP57	(1) EP37, (3) EP57	(1) EP37, (3) EP57	(1) EP37, (3) EP57	(1) EP37, (3) EP57	(1) EP37, (3) EP57		

### SOLID SHELVES

Nominal Post Height (in.)	Nominal Post Height (mm)	30" (760mm)		36" (914mm)		42" (1060mm)		48" (1219mm)		54" (1370mm)		60" (1524mm)		72" (1825mm)	
		Nominal Shelf Length	Nominal Shelf Length	Nominal Shelf Length	Nominal Shelf Length	Nominal Shelf Length	Nominal Shelf Length	Nominal Shelf Length	Nominal Shelf Length	Nominal Shelf Length	Nominal Shelf Length	Nominal Shelf Length	Nominal Shelf Length	Nominal Shelf Length	
54	1370	(1) EP55	(2) EP35	(1) EP35, (1) EP55	(2) EP55	—	(1) EP35, (2) EP55	—	(1) EP35, (2) EP55	—	(1) EP35, (2) EP55	—	(1) EP35, (2) EP55	—	(1) EP35, (2) EP55
63	1600	(1) EP56	(2) EP36	(1) EP36, (1) EP56	(2) EP56	—	(1) EP36, (2) EP56	—	(1) EP36, (2) EP56	—	(1) EP36, (2) EP56	—	(1) EP36, (2) EP56	—	(1) EP36, (2) EP56
74	1880	(1) EP57	(2) EP37	(2) EP37, (1) EP57	(2) EP57	—	(1) EP37, (2) EP57	—	(1) EP37, (2) EP57	—	(1) EP37, (2) EP57	—	(1) EP37, (2) EP57	—	(1) EP37, (2) EP57

**Note:** Units with a solid shelf in the top position require the use of a three-sided snake frame directly below it.

## Replacement Mounting Kit for Enclosure Panel

Model No. 9970EPZ



Mounting Kit for Enclosure Panel

## Replacement Clamps

Model No. 9970Z

Bag of 8 clamp assemblies.

(Available by the bag only)





## WIRE SHELVING ACCESSORIES

### Rods

Form side and back enclosures for a shelving unit. Can also serve as uniform dividers within unit by passing through shelves from top to bottom. Recommended spacing: every 6" (150mm) to 12" (305mm), depending upon shelf contents.

Model No. Chrome	Model No. Stainless	Min. Post Height (in.)	Rod Length		Approx. Pkd. Wt.	
			(in.)	(mm)	(lbs.)	(kg)
R52C	R52S	54	52	1320	1	0.5
R61C	R61S	63	61	1549	1	0.5
R72C	R72S	74	72	1830	1 <sup>1</sup> / <sub>4</sub>	0.6
R84C	R84S	86	84	2135	1 <sup>1</sup> / <sub>2</sub>	0.7



**Rod with  
Tab in place**

### Tabs

Rods are shipped with 4 tabs per rod.  
Additional Tabs — Bag of 12 Model No. **9084Z**

### Three-Sided Double Snake Frames

Provide additional support or access to floor with these sturdy square snake frames. Chrome finish.

Model No. Chrome	Width/Length (in.) (mm)		Approx. Pkd. Wt.	
	(in.)	(mm)	(lbs.)	(kg)
SF31N3C	18x24	457x610	5	2.3
SF32N3C	18x30	457x760	6	2.7
SF33N3C	18x36	457x914	6 <sup>1</sup> / <sub>2</sub>	2.7
SF34N3C	18x42	457x1066	7	3.2
SF35N3C	18x48	457x1219	7 <sup>3</sup> / <sub>4</sub>	3.5
SF36N3C	18x60	457x1524	8	3.6
SF37N3C	18x72	457x1829	9	4.1
SF41N3C	21x24	530x610	5	2.3
SF42N3C	21x30	530x760	6	2.7
SF43N3C	21x36	530x914	6 <sup>1</sup> / <sub>2</sub>	2.7
SF44N3C	21x42	530x1066	7	3.2
SF45N3C	21x48	530x1219	8	3.6
SF46N3C	21x60	530x1524	8 <sup>1</sup> / <sub>2</sub>	3.8
SF47N3C	21x72	530x1829	10	4.5
SF51N3C	24x24	610x610	6	2.7
SF52N3C	24x30	610x760	7	3.2
SF53N3C	24x36	610x914	7 <sup>1</sup> / <sub>2</sub>	3.4
SF54N3C	24x42	610x1066	8	3.6
SF55N3C	24x48	610x1219	9	4.1
SF56N3C	24x60	610x1524	10	4.5
SF57N3C	24x72	610x1829	11	5.0



**Three-sided Double Snake Frame**

All Metro Catalog Sheets are available on our Web Site: [www.metro.com](http://www.metro.com)



**InterMetro Industries Corporation**  
North Washington Street, Wilkes-Barre, PA 18705  
Phone: 570-825-2741  
Fax: 570-825-2852

L02-007A  
Printed in U.S.A. Rev. 11/09

Information and specifications are subject to change  
without notice. Please confirm at time of order.

Copyright © 2009 InterMetro Industries Corp.

For Product Information: U.S. and Canada: 1.800.433.2232  
Latin America: 1.561.333.3824  
Europe: +31.76.587.7550

Asia/Pacific: +65.6567.8003  
Middle East/Africa: +971.4.811.8286