

F-1001MLJ

MODULAR FLAKER ICE MACHINE LOW-SIDE SERIES

Item # _____

Project: _____

Qty: _____
*AutoCad available on KCL

F-1001MLJ
4/22/16
Item #13345

FLAKER DIMENSIONS W x D x H

F-1001MLJ
22 x 27^{3/8} x 25^{15/16}*

* Requires a rack system for installation

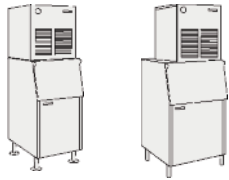

F-1001/B-300

F-1001/B-500



B-700

B-800



B-900

Also available
on Large Bins:
B-1150SS
B-1300SS
B-1500SS
B-1650SS

*FLAKED ICE DIMENSIONS

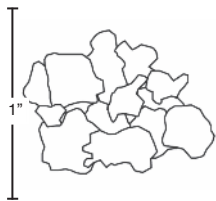

*approximate size, image not to scale



F-1001MLJ*
Air-Cooled
Shown on an optional
B-700

* Requires a rack system
for installation

- Up to 1150 lbs. of ice production per 24 hours
- Durable stainless steel exterior
- Protected by H-GUARD Plus Antimicrobial Agent
- Advanced CleanCycle24™ Design
- Removes sediment
- Clean pure ice
- Longer life and easy maintenance
- R-404A Refrigerant



Warranty

Valid in United States, Canada, Puerto Rico, & U.S. Territories. Contact factory for warranty in other countries.

Three Year - Parts & Labor on entire machine.

Five Year - Parts & Labor on Compressor, air-cooled condenser.



Hoshizaki

F-100IMLJ MODULAR FLAKER ICE MACHINE LOW-SIDE SERIES

DIMENSIONS W x D x H

F-100IMLJ
22 x 27^{3/8} x 25^{15/16}"

• Air-cooled

* Requires a rack system for installation

AIR-COOLED - F-100IMLJ

Water Temp° F.	50°	70°	90°	
Air Temp° F.	70°	1150	1124	1074
80°	1026	980	936	
90°	894	871	816	

UTILITY CONSUMPTION

Model Number	KWH per 100 LBS.		Potable Water Gal. per 100 lbs.	
	90/70	70/50	90/70	70/50
F-100IMLJ	1.9	1.4	12.0	12.0

SPECIFICATIONS

Model Number	Amperage	Min. Circuit Ampacity	Shipping Weight
F-100IMLJ	3.5	20	150 lbs.

STORAGE BINS

Model Number	AHRI-Rated Capacity*
B-300	260 lbs.
B-500	360 lbs.
B-700	550 lbs.
B-800	600 lbs.
B-900	660 lbs.
B-1150	900 lbs.
B-1300	950 lbs.
B-1500	1120 lbs.
B-1650	1210 lbs.

*Rated in accordance with AHRI Standard 820 (I-P)

ELECTRICAL & PLUMBING/F-100IMLJ

- 115V/60/1
- Icemaker Water Supply Line: Minimum 1/4" Nominal ID Copper Water Tubing or Equivalent
- Icemaker Drain Line: Minimum 3/4" Nominal ID Hard Pipe or Equivalent



© HOSHIZAKI AMERICA, INC.

618 Hwy. 74 S., Peachtree City, GA 30269

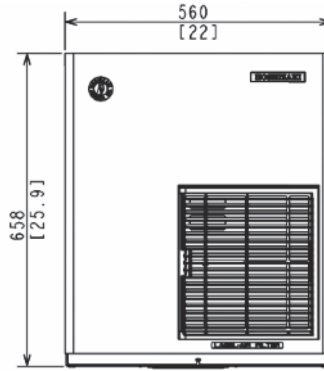

FRONT VIEW
(Remote)

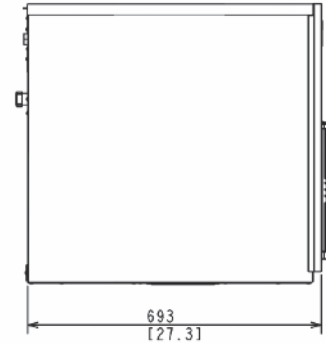

SIDE VIEW

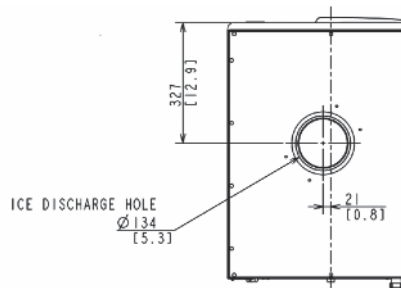

ICE DROP ZONE

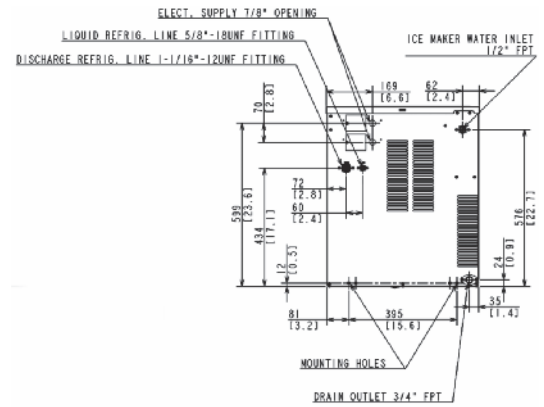

BACK VIEW

OPERATING LIMITS

- Ambient Temp Range 45 - 100°F
- Water Temp Range 45 - 90°F
- Water Pressure 10 - 113psig
- Voltage Range 104 - 127V

OPERATING LIMITS/URC-5F

- Ambient Temp Range -20°F - +122°F
- Voltage Range 104 - 127V

SERVICE

- Panels easily removed and all components accessible for service.
- Removable/cleanable air filter.

TEL 1-800-438-6087

FAX 1-800-345-1325

www.hoshizaki.com

Printed in U.S.A.

