

# FISHER<sup>®</sup>

FISHER MANUFACTURING COMPANY TOLL FREE: 800-421-6162 - FAX: 800-832-8238  
customer@fisherfaucets.com - www.fisherfaucets.com

PRODUCT NAME:

PRERINSE SPG 8BSCDLH INTL

Customer/Wholesaler:

Date:

Job Name:

Model Specified:

Quantity:

Contractor:

Architect/Engineer:

SPEC. PICB-SP-8BSLL

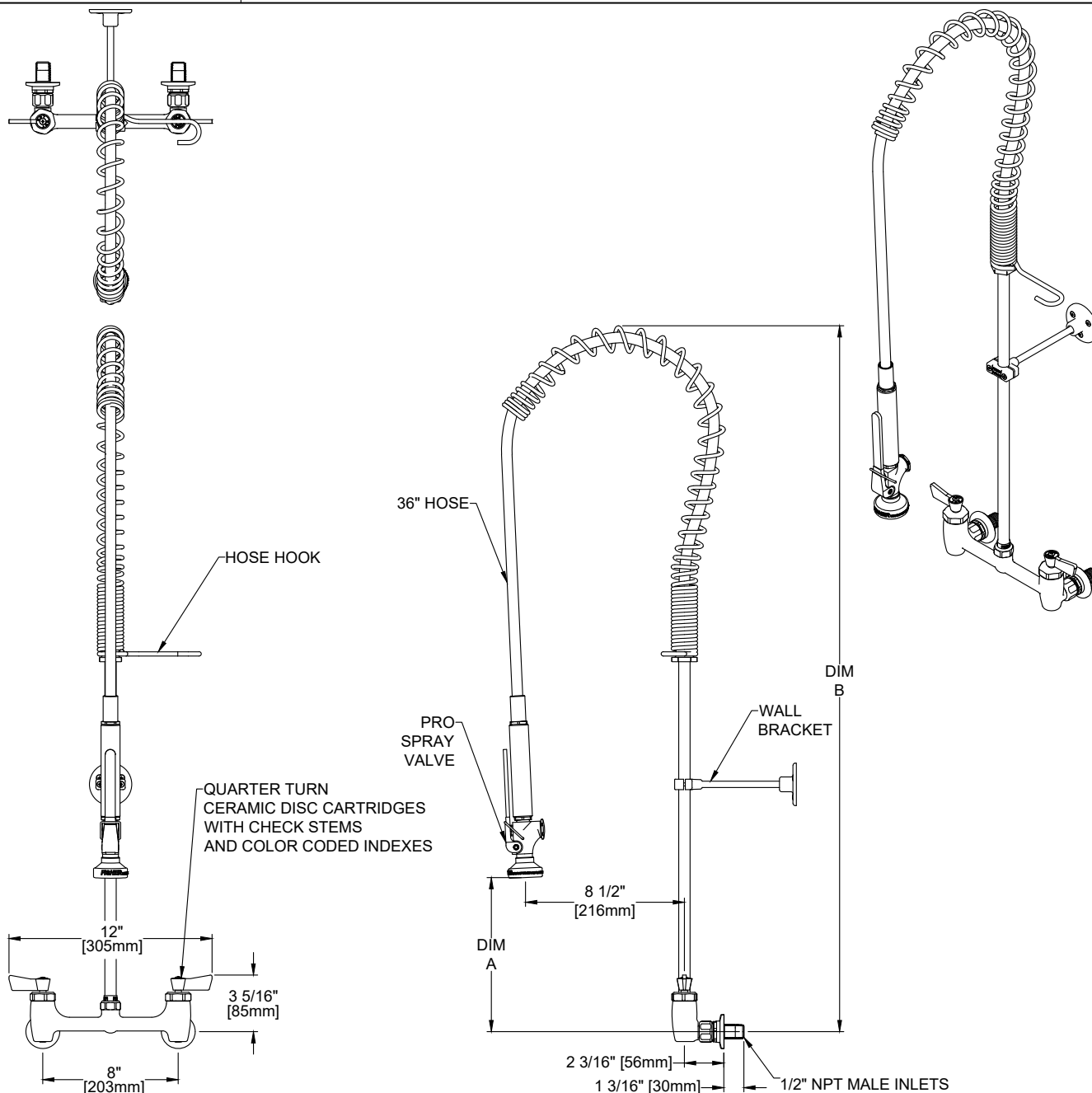

	MODEL	DESCRIPTION	DIM A	DIM B
<input type="checkbox"/>	13380	PRERINSE SPG 8BSCDLH INTERNATIONAL SALES ONLY	8 7/8" [225mm]	36 5/16" [922mm]
<input type="checkbox"/>	73120	PRERINSE SPG 8BSCDLH 16R INTL	3 3/16" [81mm]	30 5/8" [778mm]
<input type="checkbox"/>	75300	PRERINSE SPG 8BSCDLH 21R INTL	8 7/8" [225mm]	36 5/16" [922mm]

**PRODUCT SPECIFICATIONS:**

PRE-RINSE UNIT: 8" BACKSPLASH MOUNT MIXING FAUCET, QUARTER TURN CERAMIC DISC CARTRIDGES W/CHECK STEMS, LEVER HANDLES, 36" FLEXIBLE STAINLESS STEEL HOSE, 2.65 GPM @ 80 PSI SPRAY VALVE, 12" WALL BRACKET, 1/2" NPT MALE INLETS

**PRODUCT COMPLIANCE:**

ASME A112.18.1 / CSA B125.1  
NSF 61 - Section 9  
NSF 372 (Low Lead Content)

Drawn: LC

Checked: EM

Approved: LC

Date: 03/01/24

Sheet: 1 of 2

**FISHER**

FISHER MANUFACTURING COMPANY TOLL FREE: 800-421-6162 - FAX: 800-832-8238  
customer@fisherfaucets.com - www.fisherfaucets.com

PRODUCT NAME:

PRERINSE SPG 8BSCDLH INTL

Customer/Wholesaler:	Date:	Job Name:	Model Specified:	Quantity:
Contractor:	Architect/Engineer:			

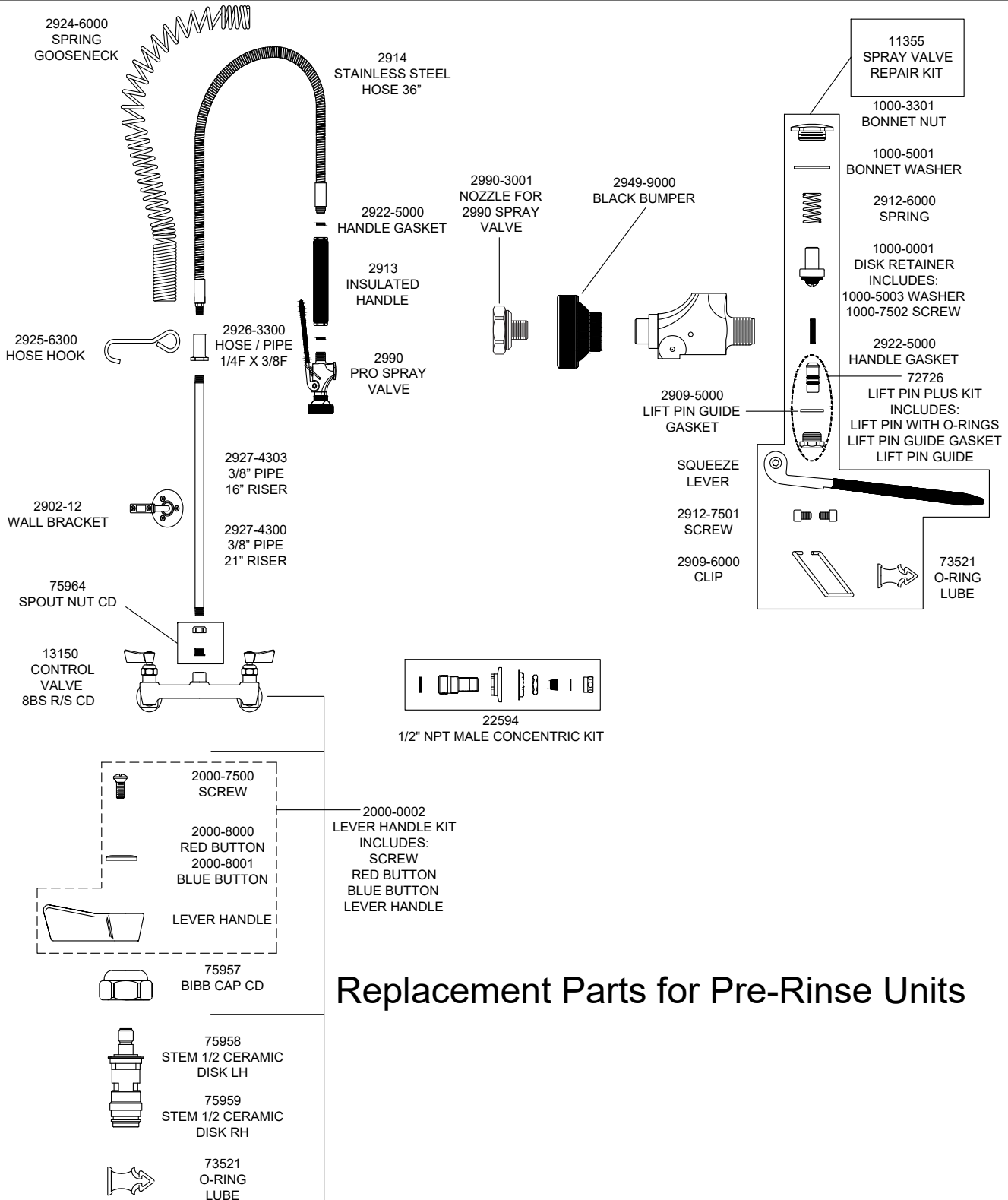

## Replacement Parts for Pre-Rinse Units

### PRODUCT SPECIFICATIONS:

PRE-RINSE UNIT: 8" BACKSPLASH MOUNT MIXING FAUCET, QUARTER TURN CERAMIC DISC CARTRIDGES W/CHECK STEMS, LEVER HANDLES, 36" FLEXIBLE STAINLESS STEEL HOSE, 2.65 GPM @ 80 PSI SPRAY VALVE, 12" WALL BRACKET, 1/2" NPT MALE INLETS

### PRODUCT COMPLIANCE:

ASME A112.18.1 / CSA B125.1  
NSF 61 - Section 9  
NSF 372 (Low Lead Content)

Drawn: LC	Checked: EM	Approved: LC	Date: 03/01/24	Sheet: 2 of 2
-----------	-------------	--------------	----------------	---------------

SPEC. PICB-SP-8BSLL