

FISHER

FISHER MANUFACTURING COMPANY TOLL FREE: 800-421-6162 - FAX: 800-832-8238
customer@fisher-mfg.com - www.fisher-mfg.com

PRODUCT NAME:

DIPPERWELL SINK ASSEMBLY

SPEC. 3043

Customer/Wholesaler:

Date:

Job Name:

Model Specified:

Quantity:

Contractor:

Architect/Engineer:

MODEL:

☐ 3043 DIPPERWELL SINK ASSEMBLY

OPTIONS OR MODIFICATIONS:

☐ OTHER _____

FEATURES:

- * STAINLESS STEEL PAN
- * REMOVABLE INNER SHELL

SYSTEM LIMITS

- * NONE

SHIPPING WEIGHT

- * 2.0 LBS

PRODUCT COMPLIANCE:

- * NONE

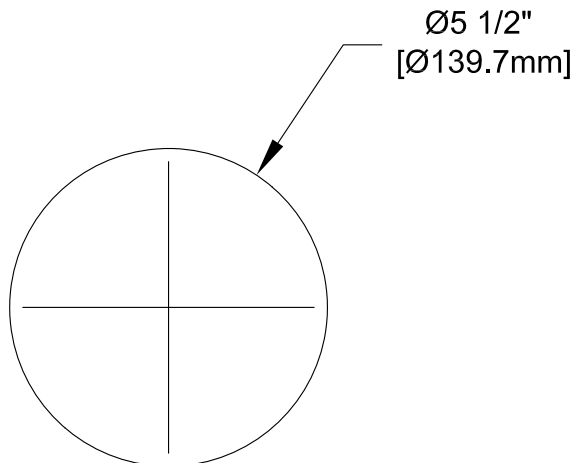
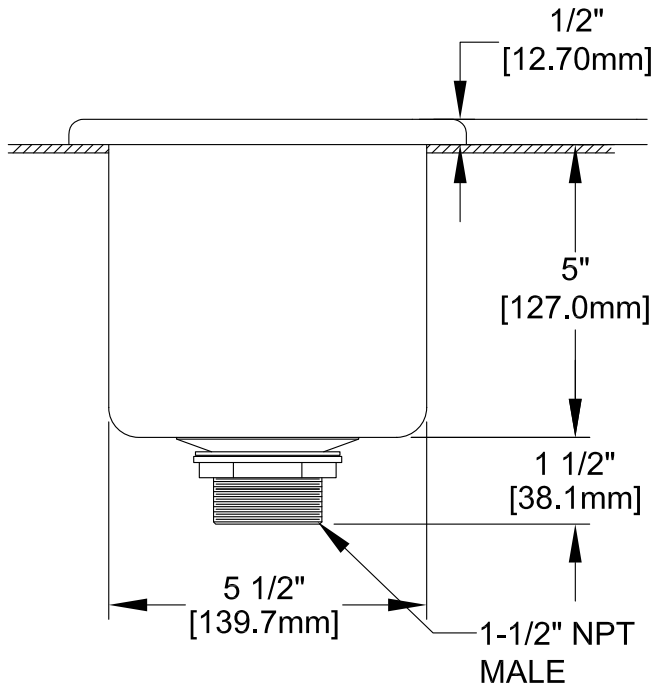

Drawn: DF

Checked: EM

Approved: DF

Date: 12/17/20

Sheet: 1 of 2

REPLACEMENT PARTS

