

3021

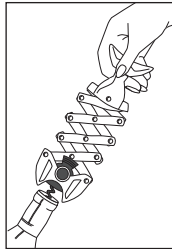

3025

See Page 54
for 3026SET

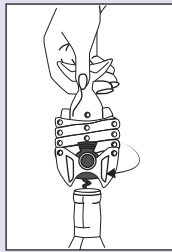

3015

3021 Pisces Multi-Lever Corkscrew

Three-step base automatically fits all bottles. Four-step concertina leverage system draws corks with easy effort. Open spiral Non-Stick worm. Chrome plated. 6" overall. Pkg. Code: BXR.

Imprint area: 5/8" X 5/16" maximum on middle lever. Screen/Pad Print or Metal Laser.

3025 Ratchet Corkscrew

Single-handle, zinc alloy, chrome plated ratchet corkscrew. Hold lever handle in down position tight to the body while turning top handle until spiral has fully penetrated the cork. Pump handle up and down several times until the cork is ratcheted from the bottle. Weighs 12 oz. 6-3/4" high, 3-1/4" wide at base. See page 54 for 3026SET. Pkg. Code: BX.

Imprint area: 5/8" X 1-1/2" on lever handle. Metal Laser. (See pg. 54 for 3026SET.)

3015 Beechwood Bistro Corkscrew - Made in Italy

Reverse helix corkscrew is activated by the lower, larger handle after the upper handle inserts the spiral into the cork. Turning both handles clockwise simultaneously extracts the cork. 7" long. Pkg. Code: BU, PC.

Imprint area: 2-1/4" X 1". Screen/Pad Print or Laser.

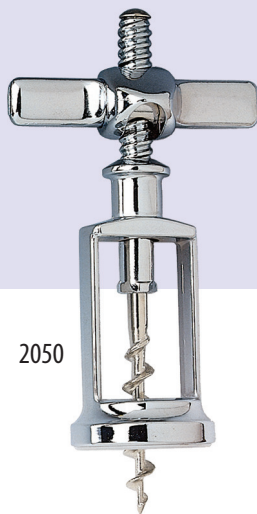

2050



2060

2065



2070

2050 Automatic Corkscrew, Chrome Plated Made in Italy

Spin handle to the top of the spiraled shaft and flip over the ratchet. Continuous clockwise turning inserts into the cork. The ratchet flips over and the cork is extracted. 5-5/8" long. Pkg. Code: BU, BX, C, PC.

2060 Power Corkscrew, Beechwood Handle With Bell - Made in Italy

3-3/8" wide, 5-1/2" long. Pkg. Code: BU, C, PC.

Imprint area: 2" X 3/8". Laser.

2065 "T" Corkscrew, Beechwood Handle - Made in Italy

3-3/8" wide, 4-1/2" long. Pkg. Code: BU, C, PC.

Imprint area: 2" X 1/2". Laser.

2070 Picnic Corkscrew - Made in Italy

Two-piece. Continuous clockwise turning extracts the cork. 5" long. Black only. Pkg. Code: BU.

Imprint area: 3/4" X 3/4". Screen/Pad print.