

REPLACEMENT PARTS LIST

ITEM	PART NO.	DESCRIPTION	QTY.
1	—	PAIL TIPPER CRADLE	1
2	—	LOOKING ARM	1
3	—	THUMB SCREW	1
4	—	11MM HEX BOLT	
5	—	11MM LOCKNUT	

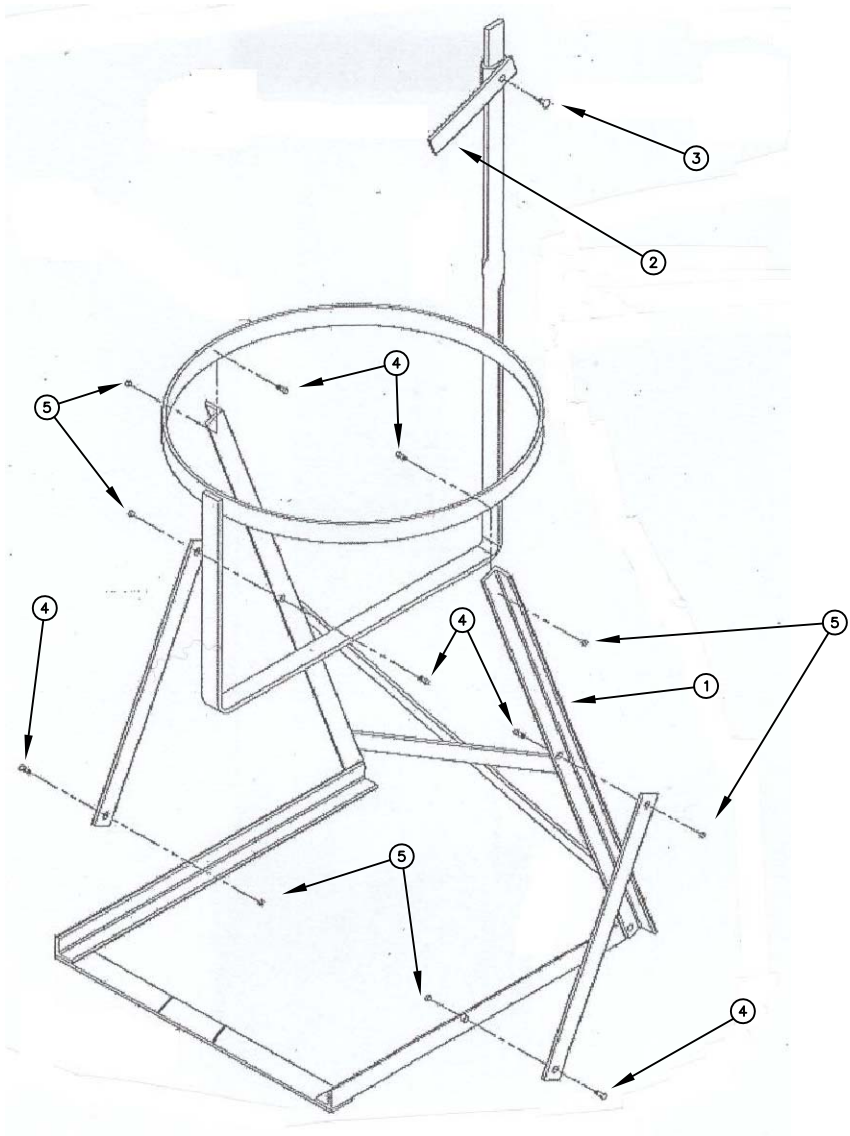

PAIL TIPPER

- Adjustable locking chime stop.
- Ships with Knockdown (KD) for easy assembly.
- Dispensing height 10”.

P/N 273108

Model: PTR  
Capacity: 70 lbs  
Weight: 10 lbs  
Boxed Dimension: 16.5” W x 22” D x 3” H  
Assembled Dimension: 14.5” W x 14.5” D x 30” H

THIS DRAWING IN ALL PARTICULARS IS WESCO INDUSTRIAL PRODUCTS INC. PROPERTY. ALL RIGHTS OF DESIGN, INVENTION OR USE OF ARE RESERVED.

PRINT ISSUED

DEC. 07, 2005

WESCO MANUFACTURING  
ENGINEERING DEPARTMENT

3427	07-24-95	E	C	K	APP
A	ADD 154009, 154040 108304 & REUSE 100101	REV	EDN & DATE	REV	APP
REVISIONS					
WESCO INDUSTRIAL PRODUCTS INC. NORTH WALES PENNA. 19454					
PART NAME Pail Tipper (FINAL ASSEMBLY)					
DRAWN: RLC 12-03-86					
CHECKED:					
APP. ENGR.					
SCALE: 1" = 5"					
C-273108 REV A					

TOLERANCE UNLESS OTHERWISE SPECIFIED	
FRACTION	3 PLACE DECIMAL
± 1/64	± .005
ANGULAR ± 1-1/2°	SHEET 1 OF 1
BREAK ALL SHARP EDGES AND REMOVE ALL BURRS	