

# Data Sheet

## KH II 800 Pro

**BIZERBA**

*Modern PC technology allowing you to be totally flexible is what the K-Class II Pro series stands for. Enjoy more performance due to a large RAM. All models are provided with a powerful Intel® Quad Core processor. Ideally suitable to implement new features or individual requirements. With their attractive design these solutions also ideally integrate in your shop concept from an optical point of view.*



**More information**  
High performance  
with a wide range of  
solutions and options.

Specifications	Facts	Details
<b>Variants</b>	KH II 800 Pro 7" KKH II 800 Pro 12.1" KH II 800 Pro 7" SP KH II 800 Pro 12.1" SP KH II 800 Pro SB	with 7" customer display with 12.1" customer display with 7" customer display and short stand with 12.1" customer display and short stand without customer display, self-service scale
<b>Color</b>	Anthracite gray Signal white	RAL 7016 RAL 9003
<b>Operator display</b>	12.1" touch TFT	Resolution: 800 x 600 Optionally in combination with RIK: 1,024 x 768 LED backlit Resistive 5-wire touch technology Infinitely adjustable viewing angle
<b>Customer display</b>	7" TFT 12.1" TFT	Resolution: 800 x 480 Resolution: 800 x 600 Optionally in combination with RIK: 1,024 x 768 LED backlit Infinitely adjustable viewing angle
<b>Operating system</b>	Windows 10 IoT Enterprise 2016 LTSC BIZLPOS3 OpenSuse® ≥ 42.1 Leap Kernel 4.2	64 bit Windows 64 bit Linux
<b>Scale software</b>	RetailPowerScale RIK (RetailIntegratorsKit)	Bizerba scale software, compatible with Retail-Framework products 3rd-party software
<b>Processor</b>	Intel® Celeron® Processor N3160 Quad Core	Clock rate of up to 2.24 GHz  L2 cache: 2 MB Instruction set: 64 bit Integrated graphics card: Intel® HD Graphics 400
<b>Working memory</b>	DDR3L RAM	4 GB, optionally 8 GB
<b>Mass memory</b>	SSD	SSD 60 GB, optionally 120 GB
<b>Printers</b>	3" receipt / linerless printer 3" label printer  Dual printer 2" receipt + 2" linerless Dual printer 2" receipt + 3" label Two printers: 3" receipt + 3" receipt Two printers: 2" linerless + 3" label	up to 3"/80 mm paper width, 200 dpi print speed up to 150 mm/s, depending on the paper used optional dual printer

<b>External additional printer</b>	Usage of the Bizerba power supply unit RSP 28 allows to use the following printers of the K-Flex series as external additional printer.	KF 3" receipt / linerless printer KF 3" label printer KF 2" L Compact receipt / linerless printer
<b>Interfaces</b>	2 x USB 3.0 2 x USB 2.0 1 x COM LAN Audio output	Super speed High speed DSUB RJ45, GBit LAN 3.5 mm jack
<b>Weighing ranges</b>	15/30 lb	Interval e=0.005/0.01 lb
<b>Temperature range</b>	-10 °C to +40 °C	
<b>Power consumption</b>	In stand-by 3.8 W During operation typically 26 W to 31 W	Energy saving thanks to use of Wake on LAN Depending on the version
<b>Net weight of device</b>	KH II 800 Pro	approx. 19 kg - 20 kg, depending on the version
<b>Options</b>	<b>Facts</b>	<b>Details</b>
<b>Software extensions</b>	RetailApps Software modules: Cash register, scanning, e-cash, inventory, delivery note, proof of origin, time registration, video journal, Retail-Connect	Extra software function per RetailApps Extra software functions per module
<b>Easy Level</b>	Tilt compensation	Automatic correction of incorrect weight values due to angled position of the scale
<b>WLAN modules</b>	BWLC  USB	Bizerba Wireless LAN Client 802.11 a/b/g/n max. 300 MBit/s USB WLAN stick, no continuous operation possible, 802.11 a/b/g/n max. 300 MBit/s 802.11 a/b/g/n max. 300 MBit/s
<b>Cash register drawer connection and 2nd COM</b>	Cash register drawer connection in combination with second COM interface: RS232	RJ12, max. 2 cash register drawers possible with an adapter

#### Info graphics



## Dimensional drawings

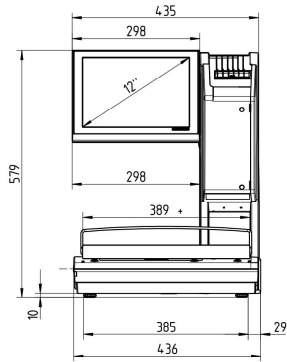

KH II 800 Pro

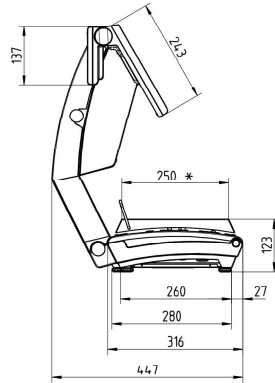

KH II 800 Pro

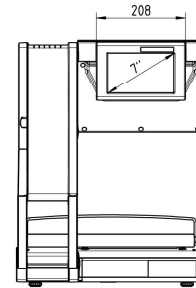

KH II 800 Pro

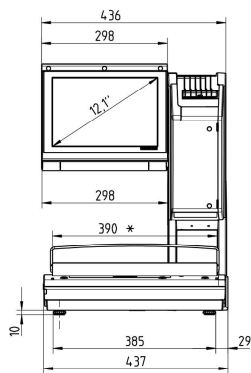

KH II 800 Pro

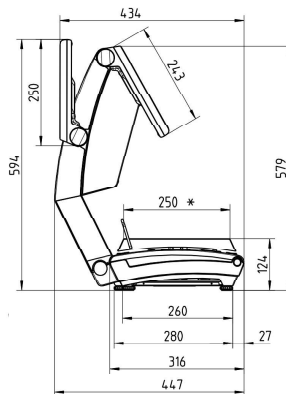

KH II 800 Pro

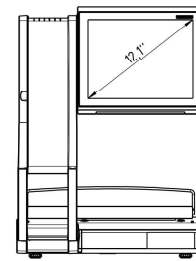

KH II 800 Pro

## Symbols



Java  
Powered



Linux  
64 bit



Windows 10

## Approvals

NTEP - National Type Evaluation Program "legal for trade", passed NTEP program evaluations.

**Bizerba SE & Co. KG**  
Wilhelm-Kraut-Straße 65  
72336 Balingen

T +49 7433 12-0  
fax: +49 7433 12-2696  
marketing@bizerba.com

**www.bizerba.com**

**Bizerba USA Inc.**  
1804 Fashion Court  
Joppa, MD 21085  
USA  
Tel. Office +1 732 565-6000  
Tel. Service +1 732 565-6001  
Fax +1 732 819-0429  
us.info@bizerba.com  
**www.bizerba.com**