

WAVE15-APS, PF

17.4" x 17.9" x 9.7"
(44.2cm x 45.5cm x 24.6cm)



- BrewMETER® allows automatic programming of pulse routine
- Adjustable legs to accommodate up to 3.0L lever action and 2.5L push button BUNN airpots and thermal servers
- Brew into 1.9L thermal carafe using the slide-out booster tray
- Four-digit LED read-out for simple programming
- Utilize the same LED read-out for brewer status (Ready, Heating, Brewing)
- SmartWAVE technology increases turbulence in the brew funnel
- Standard Version
- Energy-saver mode reduces tank temperature during idle periods
- Ensures coffee brew quality with cold brew lock out capability
- SplashGard® funnel deflects hot liquids away from the hand

Agency:



Specifications

Product #: 39900.0005

Water Access: Plumbed

Finish: Stainless

Funnel: Black Plastic

Faucet: Lower

Additional Features

BrewMETER

Electrical & Capacity

Volts	Amps	Watts	Cord Attached	Plug Type	8oz cups/hr 236ml cups/hr	Input H ₂ O Temp.	Phase	# Wires plus Ground	Hertz
120	11.3	1350	Yes	NEMA 5-15P	62	60°F (15.5°C)	1	2	60

Plumbing Requirements

PSI	kPa	Fitting Supplied	Water Flow Required (GPM)
20-90	138-621	1/4" Male Flare Fitting	-

CAD Drawings

2D	Revit	KLC
●		



BUNN® reserves the right to change specifications and product design without notice. Such revisions do not entitle the buyer to corresponding changes, improvements, additions or replacements for previously purchased equipment. For most current specifications and other info visit bunn.com.

Created on:
01/04/2019

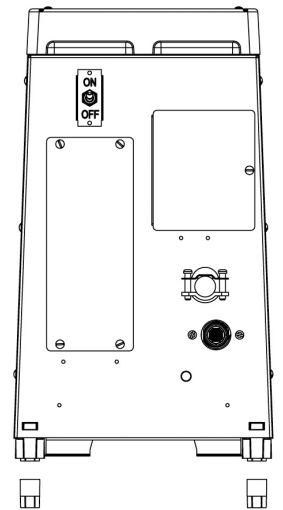
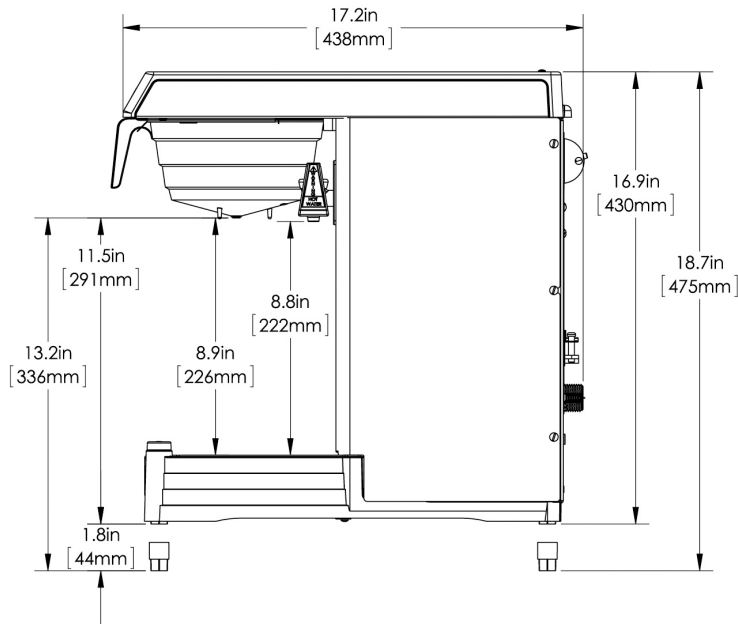
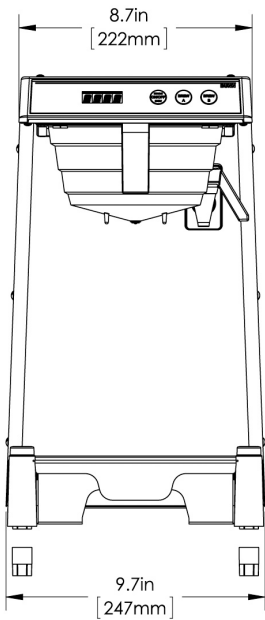
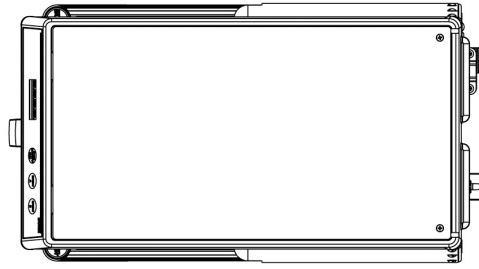

Unit				Shipping				
	Width	Height	Depth	Width	Height	Depth	Weight	Volume
English	9.7 in.	17.4 in.	17.9 in.	12.3 in.	19.5 in.	19.5 in.	24.350 lbs	2.505 ft ³
Metric	24.6 cm	44.2 cm	45.5 cm	31.2 cm	49.5 cm	49.5 cm	11.045 kgs	0.071 m ³



BUNN® reserves the right to change specifications and product design without notice. Such revisions do not entitle the buyer to corresponding changes, improvements, additions or replacements for previously purchased equipment. For most current specifications and other info visit bunn.com.

Created on:
01/04/2019

Related Products & Accessories:WAVE15-APS, PF(39900.0005)



FILTERS,REGULAR1M
500/2 50/CL

Product #: 20115.0000



FUNNEL W/DECALS,
BLACK PLASTIC

Product #: 20583.0003



WATER FILTER
SYSTEM,EQ-17-TL

Product #: 30200.1000



WATER FILTER,IN LINE
ED-17-TL

Product #: 30201.1001



Serving & Holding Options: WAVE15-APS, PF(39900.0005)

 <p>AIRPOT, 2.5L GL PB SINGLE PK</p> <p>Product #:13041.0001</p>	 <p>AIRPOT, 2.5L GL PB 6/ CASE</p> <p>Product #:13041.0101</p>	 <p>TSR-1,THERMAL SRVR RACK-1 POSN</p> <p>Product #:18008.6001</p>	 <p>AIRPOT, 2.2L GL PB SINGLE PK</p> <p>Product #:28696.0002</p>	 <p>NO IMAGE AVAILABLE</p> <p>AIRPOT, 2.2L GL PB 6/ CASE</p> <p>Product #:28696.0006</p>
 <p>AIRPOT, 2.5L SST LA SINGLE PK</p> <p>Product #:32125.0000</p>	 <p>AIRPOT, 2.5L SST LA 6/ CASE</p> <p>Product #:32125.0100</p>	 <p>AIRPOT, 3.0L SST LA SINGLE PK</p> <p>Product #:32130.0000</p>	 <p>AIRPOT, 3.0L SST LA 6/ CASE</p> <p>Product #:32130.0100</p>	 <p>THERMAL CARAFE, BLK 1.9L 1PK</p> <p>Product #:36029.0001</p>
 <p>THERMAL CARAFE,ORN 1.9L 12PK</p> <p>Product #:36252.0000</p>	 <p>THERMAL CARAFE,ORN 1.9L 1PK</p> <p>Product #:36252.0001</p>	 <p>PITCHER,SST 1.9L TALL- SNGL PK</p> <p>Product #:39430.0000</p>	 <p>PITCHER,SST 1.9L TALL-6/CASE</p> <p>Product #:39430.0100</p>	 <p>CARAFE,SST 1.9L SHRT BLK 1/</p> <p>Product #:40163.0000</p>
 <p>CARAFE,SST 1.9L SHRT ORN 1/</p> <p>Product #:40163.0001</p>	 <p>CARAFE,SST 1.9L SHRT BLK 12/</p> <p>Product #:40163.0100</p>	 <p>CARAFE,SST 1.9L SHRT ORN 12/</p> <p>Product #:40163.0101</p>	 <p>NO IMAGE AVAILABLE</p> <p>THERMAL SRVR, 2.5L 6/ CS NO BASE GL LINR</p> <p>Product #:45882.0001</p>	 <p>THERMAL SRVR, 2.5L NO BASE GL LINER</p> <p>Product #:45882.0003</p>

