

# Inverter Air Conditioner **Indoor/Outdoor Units Disassembly Manual**

**Models:**

**WYT009GLSI25RH**

**WYT012GLSI25RH**

**WYT018GLSI25RH**

**WYT024GLSI25RH**

## IDU Disassembly

Indoor Unit Model Numbers: WT009GLSI25HLH | WT012GLSI25HLH | WT018GLSI25HLH | WT024GLSI25HLH

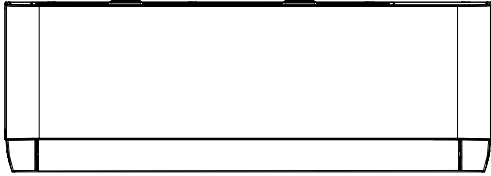
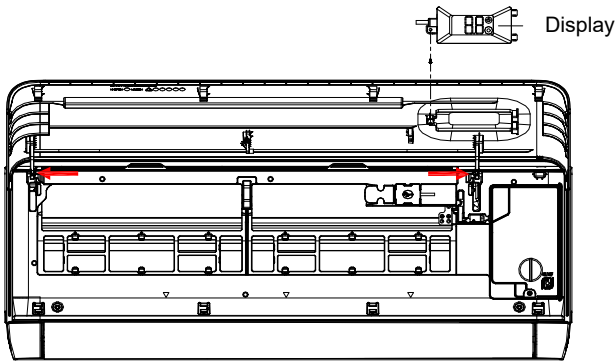
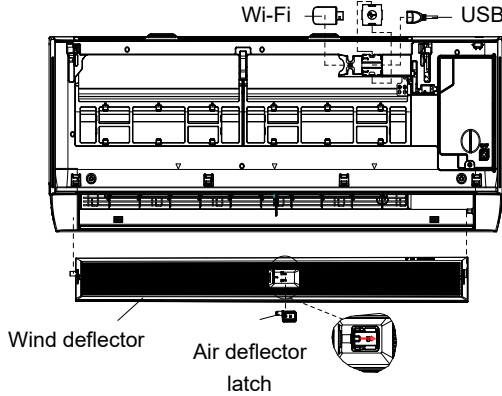
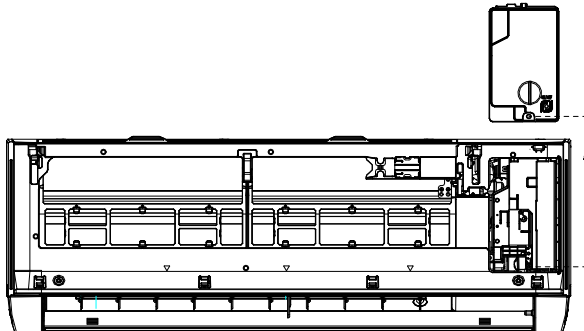
Steps	Reference Photo
Before disassembly	
1. Disassemble the front panel, display board, and Wi-Fi module.	
<p><b>A.</b> Open the front panel.</p> <p><b>B.</b> Remove 1 screw, then take the display box out from the panel.</p> <p><b>C.</b> Release the panel axis, which shown in red arrows, out from middle frame and take the panel out.</p>	 <p>Display</p>
2. Remove the louver and take the Wi-Fi module out from the middle frame.	
<p><b>A.</b> Remove the air guide by sliding the air guide pin to the right. The pin stays on the air guide after removing the air guide.</p> <p><b>B.</b> Slide the Wi-Fi module to the left to remove it.</p> <p><b>C.</b> Remove the Wi-Fi retaining cover from the retaining clips and remove the USB cable.</p>	 <p>Wi-Fi</p> <p>USB</p> <p>Wind deflector</p> <p>Air deflector latch</p>
3. Remove the louver	
Unfix 1 screw on the cover of the electric box, and remove the cover.	

**4. Remove the front cover plate.**

**A.** Press the red arrow to loosen the 6 fixed clips between the front cover and center frame.

**B.** Rotate the front cover plate outward to disengage the fixing pins of the front cover plate and center frame. Then, remove the front cover plate.

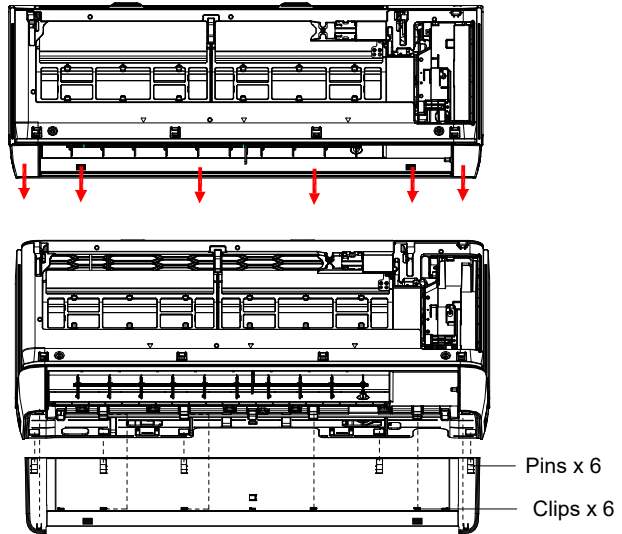
**5. Remove the sweep blade assembly.**

**A.** Remove the sweep blade assembly by loosening the 5 clips from the base upwards.

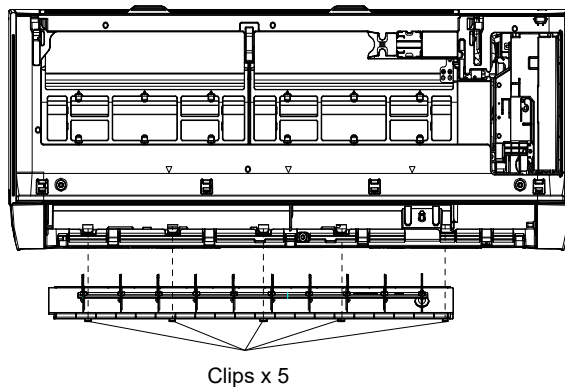
**6. Remove the filter.**

**A.** Pinch the top of the strainer at the grommet position and slightly press upward to remove the strainer.

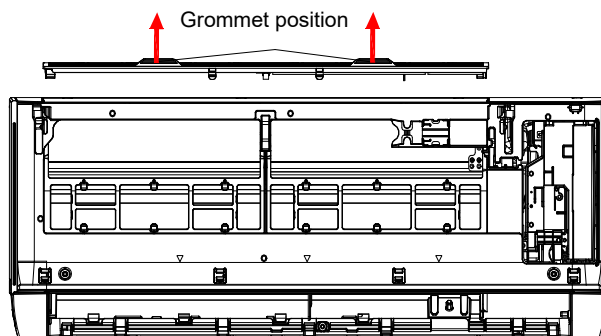

**7. Disassembly the middle frame.**

- A. Remove 2 fixing screws between the center frame and the base.
- B. Loosen the 4 fixing clips between the upper part of the center frame and the base.
- C. According to the position indicated by the arrow of the center frame, press downward to loosen the 3 fixed clips between the center frame and the upper edge of the air vent of the base.
- D. Follow the arrow in the center frame to indicate the position, press outward to loosen the 3 fixed clips between the center frame and the lower edge of the air vent of the base.
- E. Remove the center frame upwards

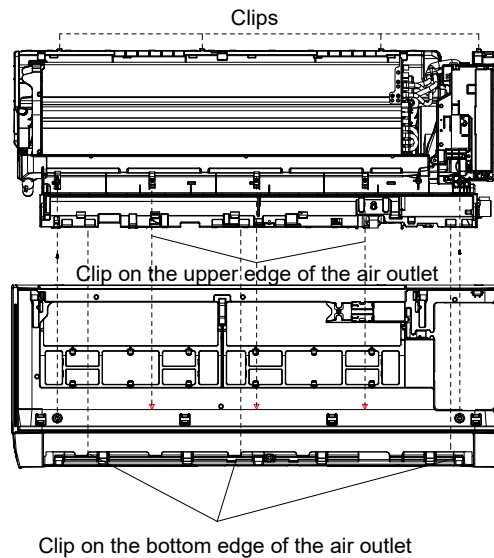
**8. Disassembly the electric control box.**

- A. Remove the electric control box and base fixing screws.
- B. Remove the control box

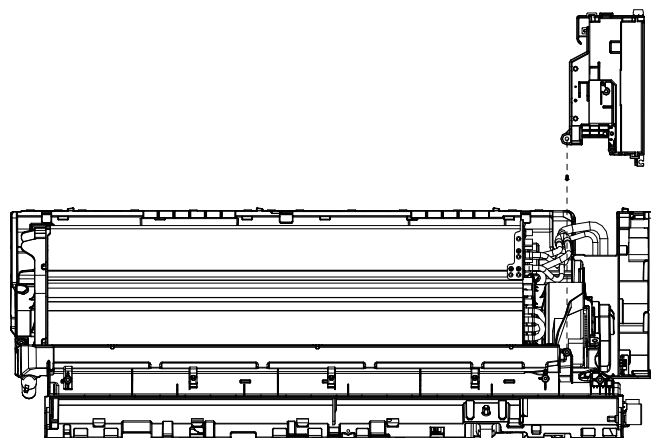
**9. Removal of wall panels and pipe pressure plates**

- A. Loosen the fixing screws of wall plate and base.
- B. According to the direction of the arrow, on-line press the base wall plate fixing clips, you can loosen the wall plate and base fixing clips, take out the wall plate.
- C. Hold the pipe pressure plate gripper position upward force, you can loosen the pipe pressure plate and the base of the fixed clips, remove the pipe pressure plate

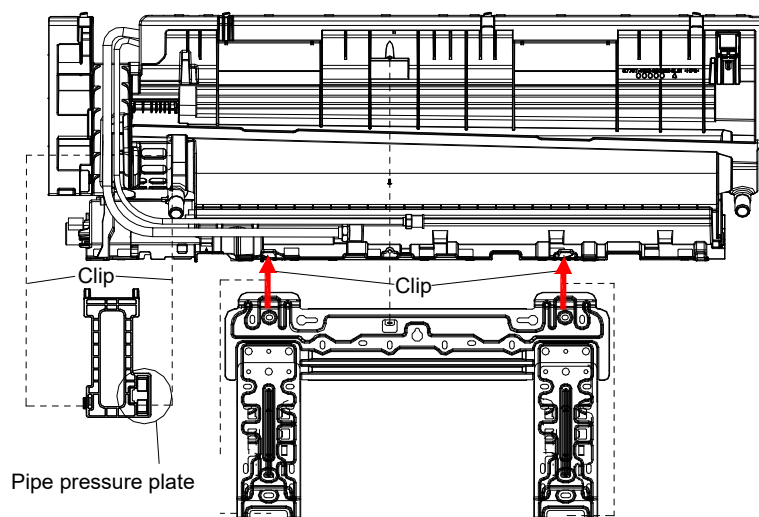

**10. Disassembly the evaporator**

- A. Remove the evaporator and base fixing screws
- B. Loosen the left side of the evaporator and the base fixing buckle, lift the left side of the evaporator upward.
- C. After the left side of the evaporator is lifted, the right side of the evaporator will be loosened, and the evaporator can be taken out upwards.

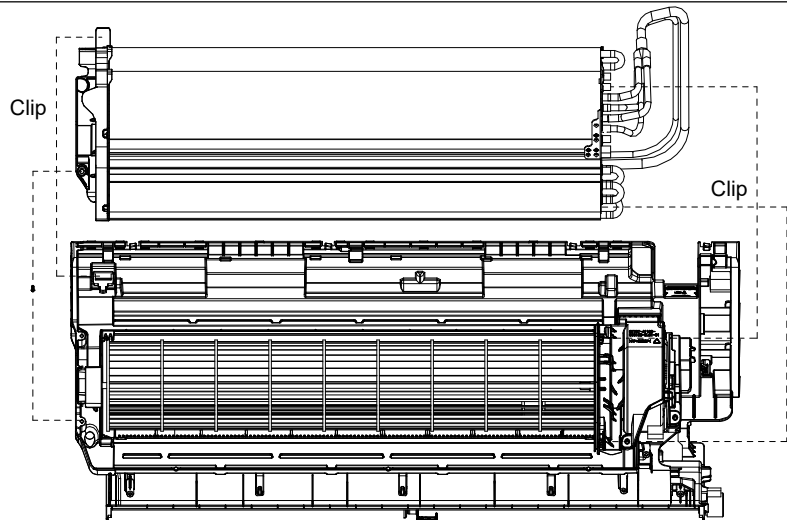
**11. Remove motor cover**

- A. Remove the motor cover and the 2 fixing screws on the base to take out the motor cover upwards.

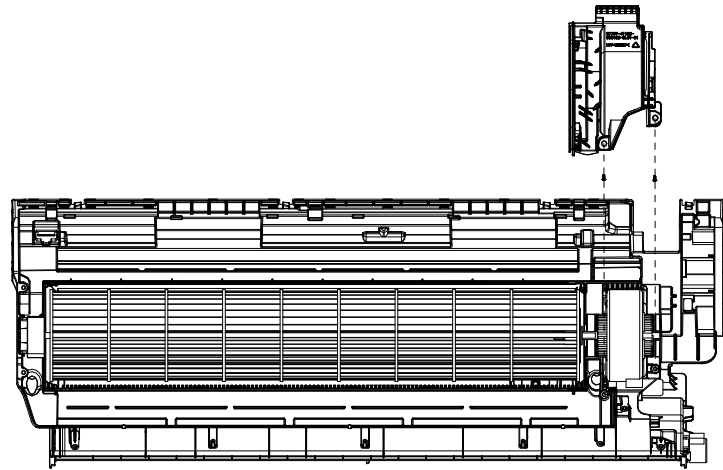
**12. Remove the crossflow fan and motor**

- A. Remove the crossflow fan and crossflow fan motor upwards.

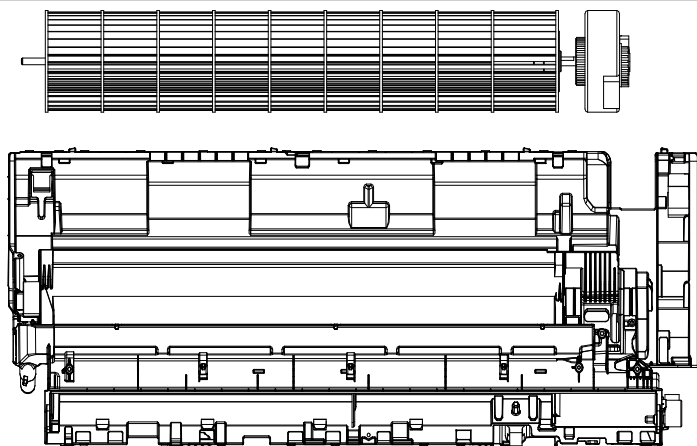
**13. Removal of cross-flow fan motor**

- A. Remove the crossflow fan motor by removing the crossflow fan and crossflow fan motor mounting screws.

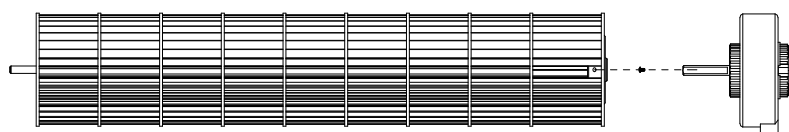

## ※Refrigerant Leakage Detector Installation

9K 230V  
12K 230V

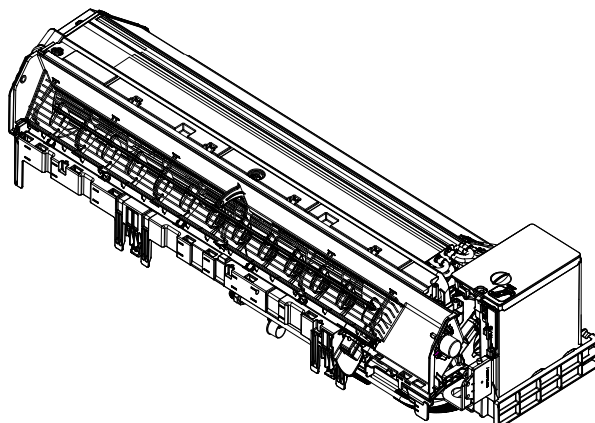

18K 230V  
24K 230V

※Power cord mounting plate  
installation

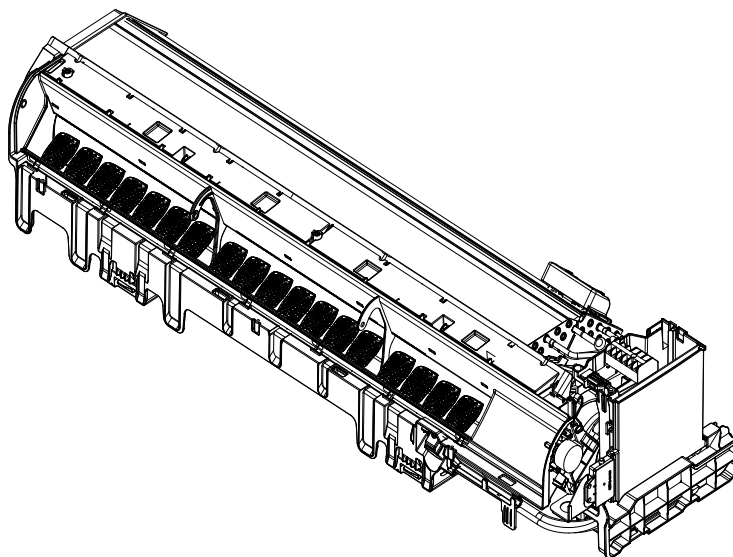

9K 230V 12K 230V

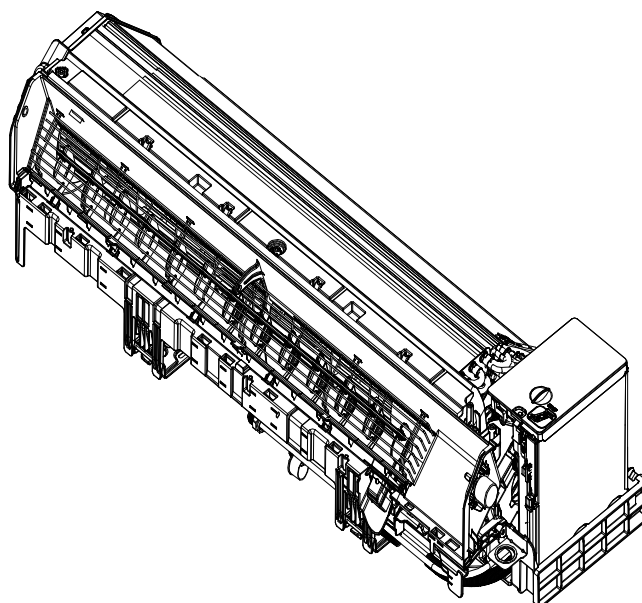

18K 230V  
24K 230V4.

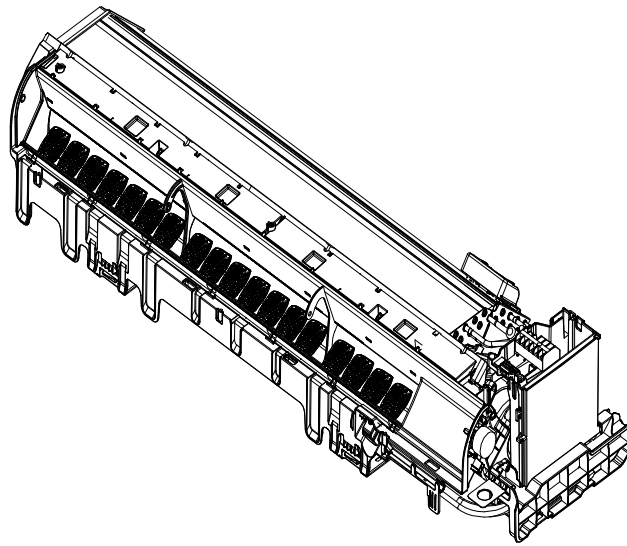
**ODU Disassembly**

Outdoor Unit Model Numbers: YN009GLSI25RPH | YN012GLSI25RPH | YN018GLSI25RPH | YN024GLSI25RPH

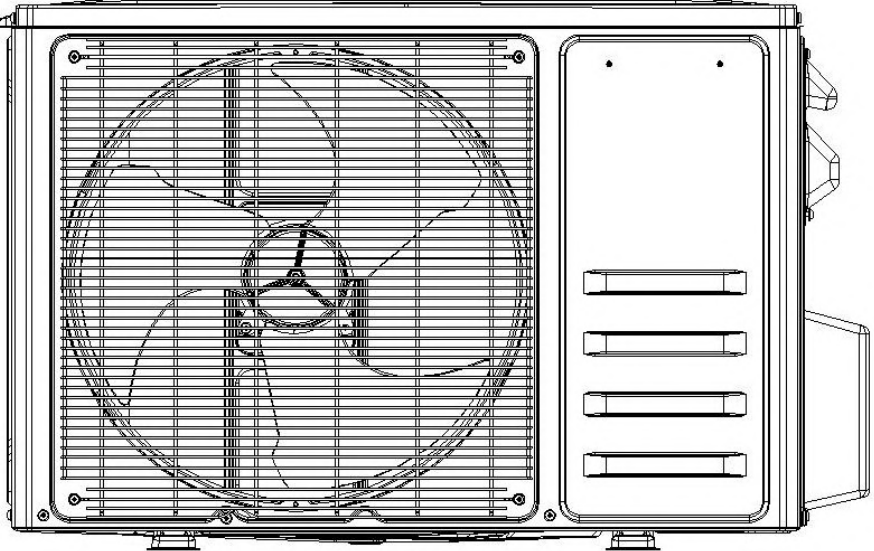
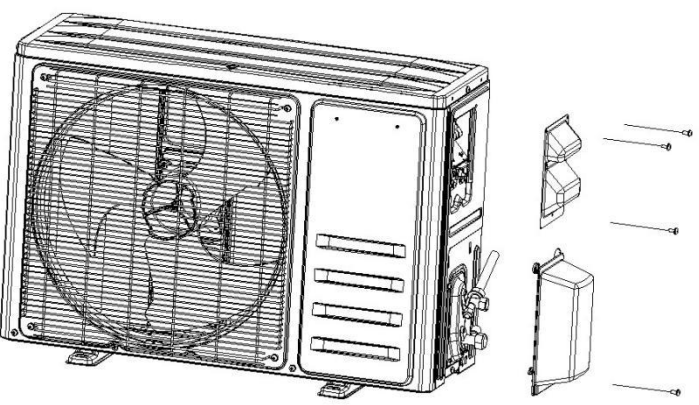
Step	Reference photo
Before disassembly	
1. Remove the PCB Cover , valve Cover and top cover	
A  1). Unfix one screw on the PCB cover, you can take the cover out from unit.  2). Unfix one screw on the valve cover, you can take it out easily.	

B

Unfix screws btw the top cover with front panel, left and right plate, then you can take the top cover out.

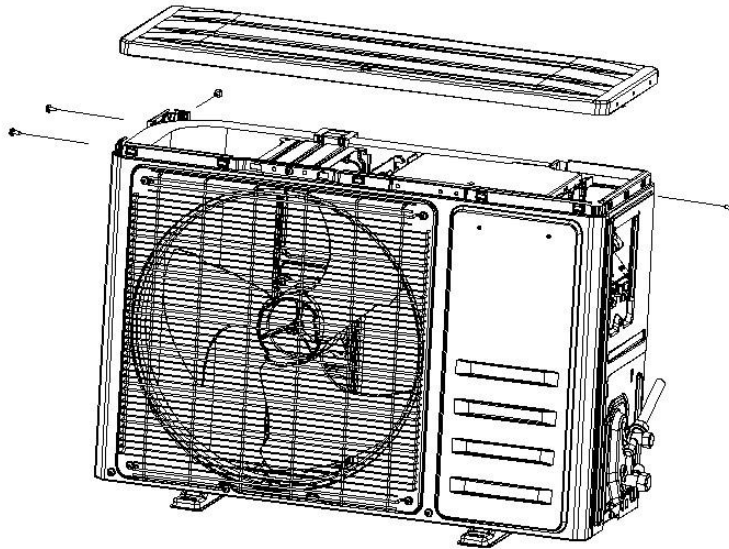

## 2: Disassemble the Fan Guard and Front Panel

A

Remove the screws assembling the grille to the front panel and remove the grille.

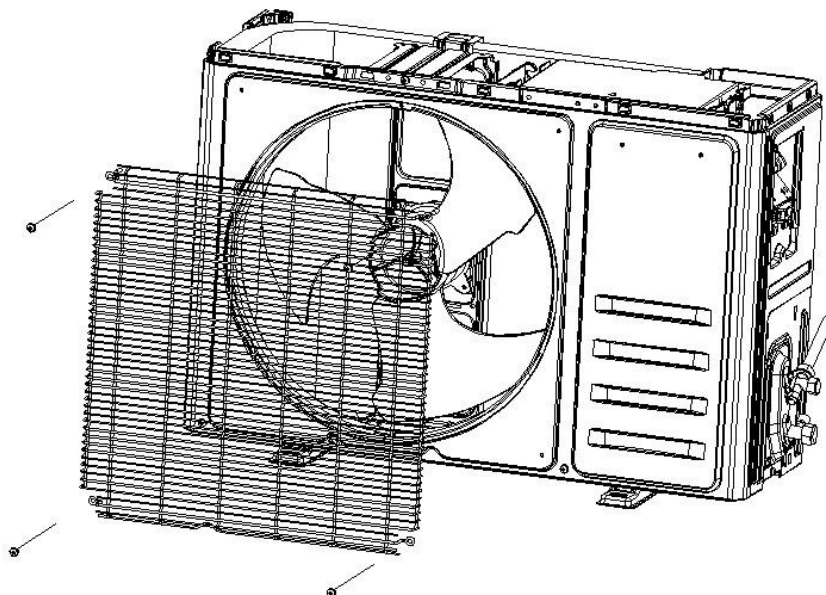

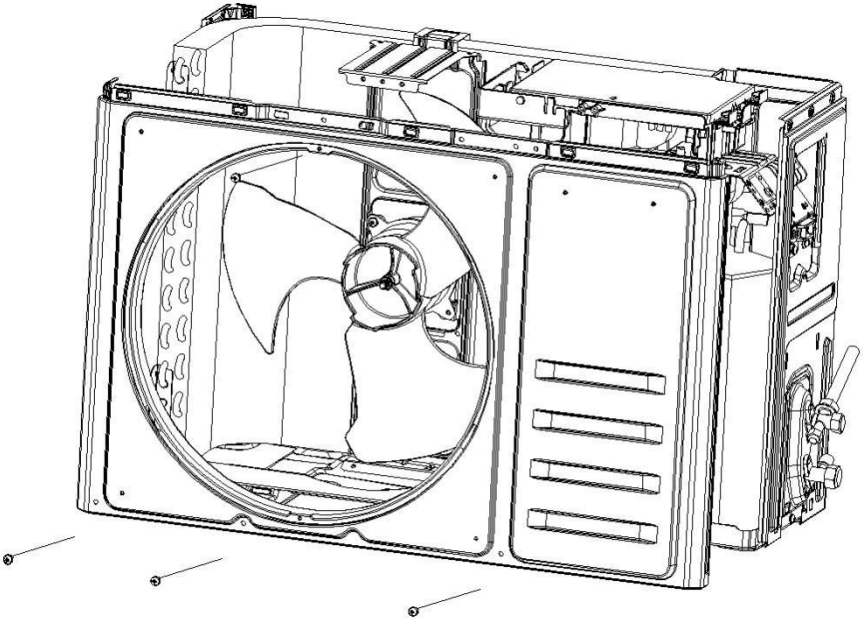
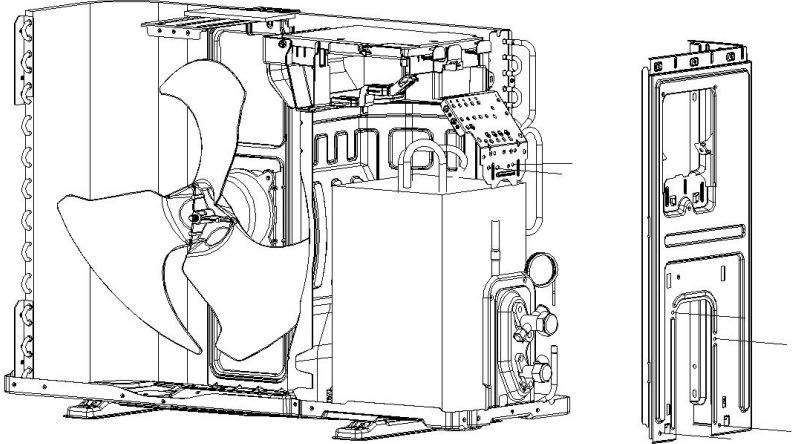
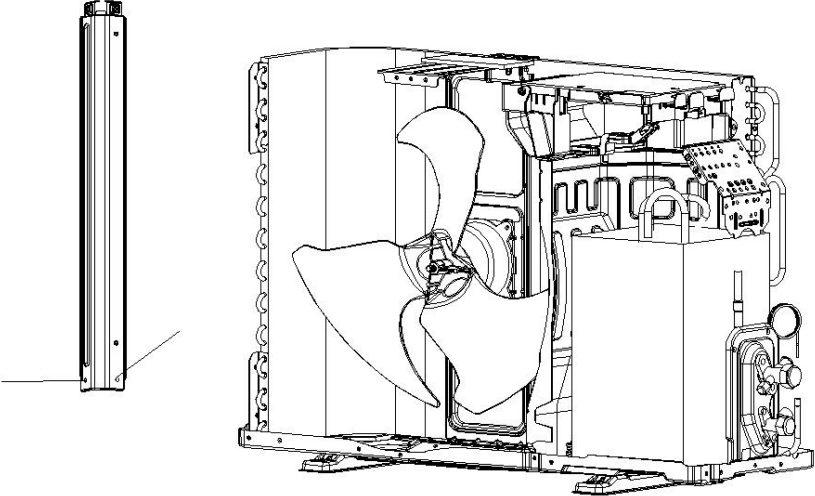

B	<p>Unfix screws on front panel with fan guard, ODU middle separate plate and base plate, uplift front panel you can take it out from unit</p>	
<b>3: Disassemble the Left and Right plate.</b>		
A	<p>Unfix screws btw Right Plate and the Electric Box assembly, Valve Plate, Base Plate, then you can take the Right plate out.</p>	 → X
B	<p>Unfix screws btw Left Plate, Base plate and Condenser plate, you can take the left plate out.</p>	

**4: Disassemble the Axis Fan Blade**

A

Unscrew the fan blade nut, and take the blade out.

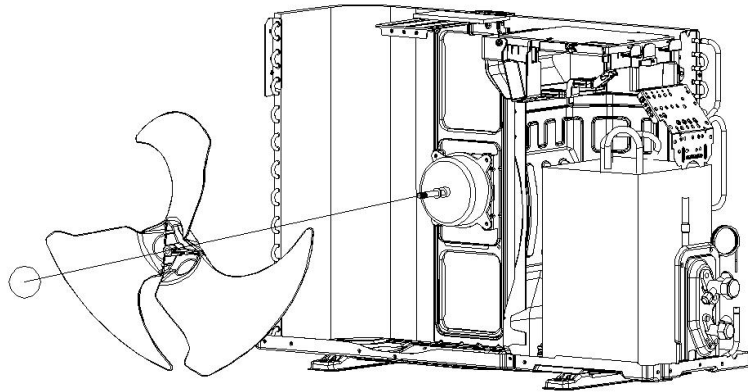
**5: Disassemble the electric box**

Unfix screw btw Electric Box and motor supporter etc. loosen the wiring clamp, then you can take the control box out.

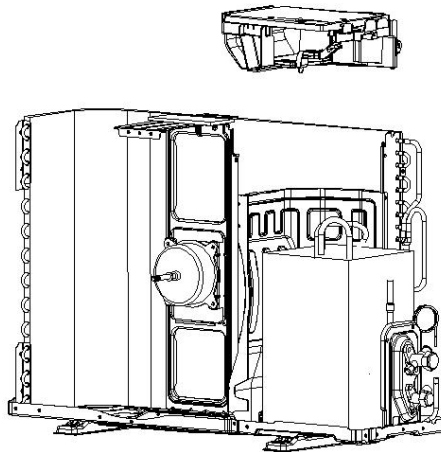
**6: take out the noise cotton**

A

Shown as picture to take the cotton out

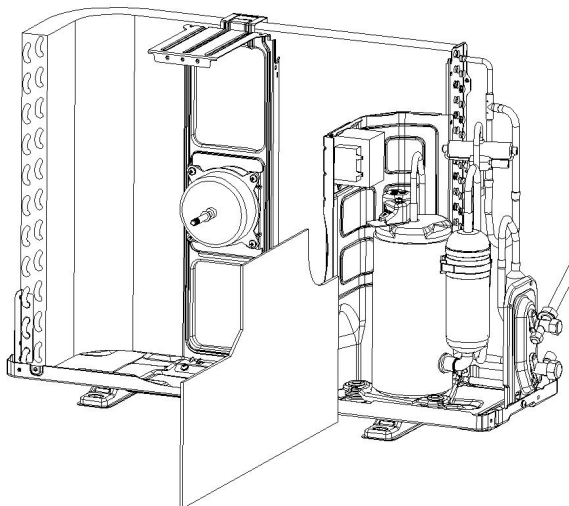

**7: Disassemble the separate plate**

Unfix the screw btw  
separate plate and  
unit, and take it out

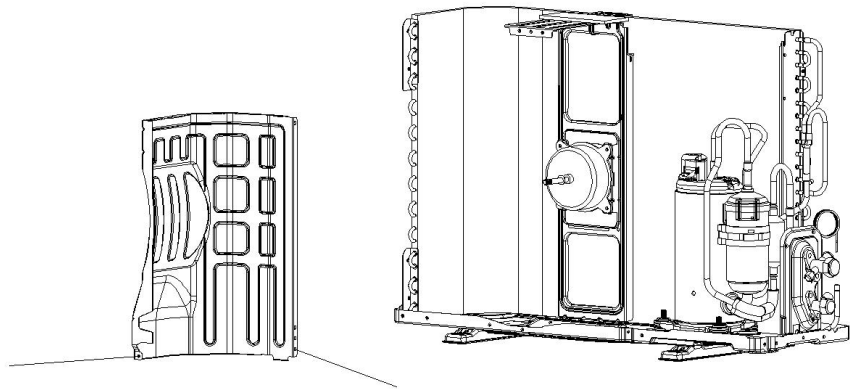
**8: Disassemble the 2 and 3-way valve**

Unfix screw btw  
Valve plate and  
base, you can take  
the 2-way and 3-way  
valve out by welding.

Note:  
1). The welding can  
only place while no  
gas in the unit.  
2). Pay attention to  
the fire to prevent  
any injury.

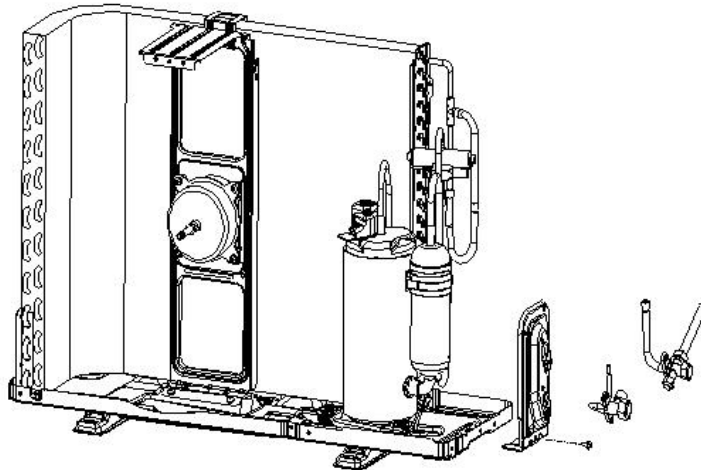
**9: Disassemble the 4-way valve assembly**

Take the 4-way  
valve out from  
system by welding.  
Make sure no hurt to  
the compressor and  
nameplate, etc.

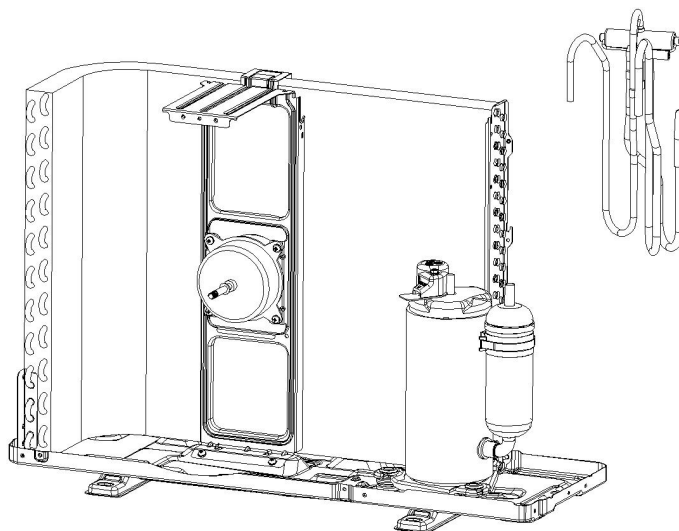

**10: Disassemble the compressor**

Unscrew the nuts  
and take the  
compressor out.

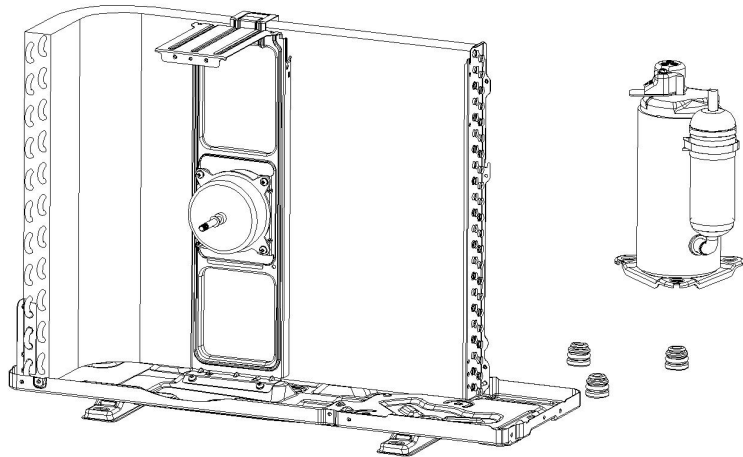
**11: Remove the fan motor and fan supporter.**

Unfix screws btw fan  
motor with  
supporter, and  
supporter with base  
plate.

Note:  
Pay attention to the  
motor wiring, it can't  
be taken out by  
force.

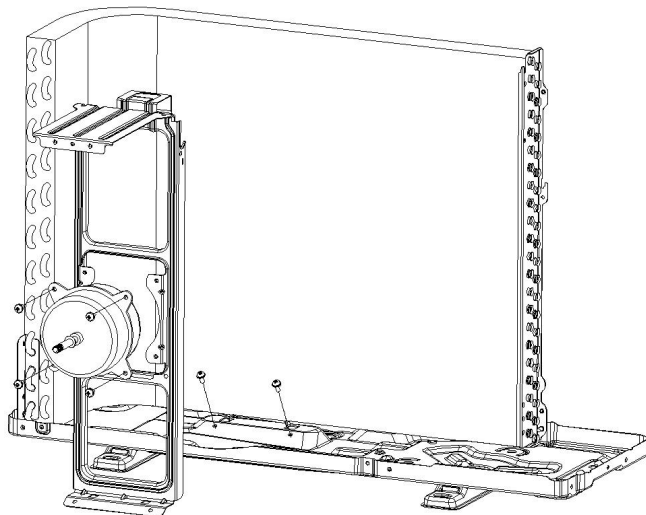

The design and specifications of this product are subject to change without prior notice as development continues. Consult with the sales agency or manufacturer for details. Refer to the equipment nameplate for all other applicable specifications.



is a registered trademark of Parker Davis HVAC International, LLC.

Parker Davis HVAC International  
7290 NW 77 Court, Miami, FL 33166 - USA  
Tel : (305) 513-4488  
Fax : (305) 513-4499  
E-mail : [info@pdhvac.com](mailto:info@pdhvac.com)  
Website: [www.pdhvac.com](http://www.pdhvac.com)

Pioneer product line, parts, and supplies are  
available online for convenient ordering at:  
[www.highseer.com](http://www.highseer.com)  
[www.pioneerminisplit.com](http://www.pioneerminisplit.com)

Scan the below code to visit our support page  
where you can find more installation materials:



Copyright © Parker Davis HVAC International, LLC. All rights reserved.

---