

# Stainless Steel Wire Shelving Kit

## Assembly Instructions

### PARTS:

- (A) Shelves
- (B) Posts
- (C) Split Sleeves
- (D) Casters (if included)

### TOOLS SUGGESTED

- Rubber Mallet
- Cut-Resistant Gloves

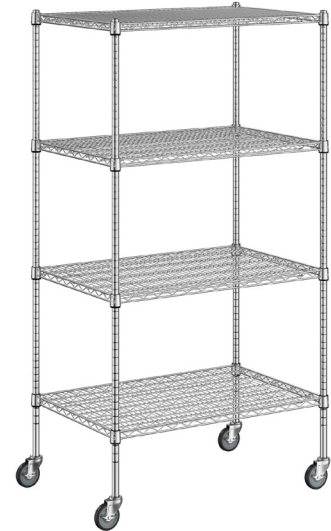
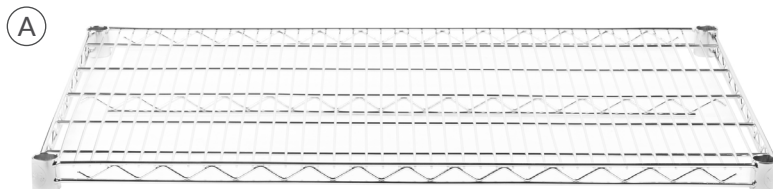

(B)



(C)



(D)



### NEED HELP?

Scan here to follow along with the full assembly video:



## Assembly Instructions

**WARNING:** Stainless steel edges may be sharp and cause cuts. Wear gloves and handle with care during installation and use.

**NOTE:** Every eighth groove is doubled for easy assembly. Posts are notched in 1 inch increments.

1. Please inspect that all items are present and none are damaged before assembling.
2. If assembling a mobile unit, insert the casters into the posts by simply pushing them in. If not, attach the foot levelers to the posts by twisting them in a clockwise direction.

**NOTE:** Pushing in the casters may take a bit of force, but the ring on the stem will hold them in place inside the post.



## Assembly Instructions Cont.

3. Snap (4) split sleeves onto each post for the bottom shelf. Ensure that the split sleeves have the arrow facing up.

**NOTE:** NSF requires that bottom shelves be at least 6 inches off the ground.

4. Hold the bottom shelf on its side and slide each post through the collars in the shelf until the sleeves fit firmly inside the shelf collars.
5. Stand the unit upright and ensure that the shelf is secured. Use a mallet and towel to secure the shelf well without damaging it.
6. Add additional split sleeves at desired shelf height and continue to place the remaining shelves on top of the posts, sliding them through the shelf slots until the sleeves fit firmly.
7. Screw the foot levelers in or out to level the entire unit.

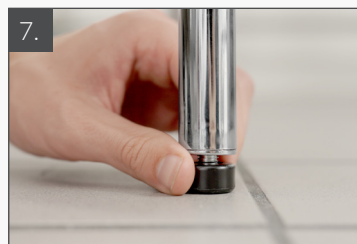
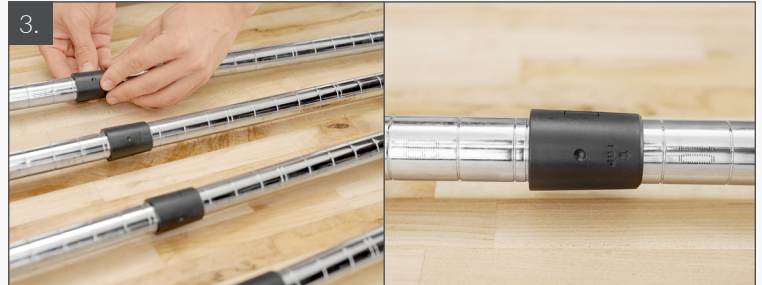

## CARE AND MAINTENANCE

- Please check the weight capacity of the shelf AND unit and stay within the weight recommendations by evenly distributing items on the shelf.
- Dust the shelf or wipe down with a damp cloth or paper towel to clean off any dirt or food.
- For more information, please reference the Stainless Steel Care and Maintenance Guide.

## IMPORTANT

Manufacturer is not responsible for damage and/or injury caused by improper assembly, misuse, extended use past the life span, or unbalanced loading of the product. It is the user's responsibility to understand the product's use in each application.