

Parts Manual



**ULTRA
SERIES**

Gas Countertop Chrome Plated Griddles with Thermostatic Controls



351GTUCPG24(L/N), 351GTUCPG36(L/N), 351GTUCPG48(L/N), 351GTUCPG60(L/N),
351GTUCPG72(L/N),



REVISED 02/2022

Safety Precautions

CAUTION:

- Failure to comply with the following operation instructions could lead to potential hazards and/or unsafe practice and could result in injury and damage to product and property.

NOTICE:

- Local codes regarding installation vary greatly from one area to another. The National Fire Protection Association, Inc., states in its NFPA96 latest edition that Local codes are “Authority Having Jurisdiction” when it comes to requirement for installation of equipment. Therefore, installation should comply with all Local codes.
- This product is intended for commercial use only. Not for residential use. Use in residential applications will void warranty.

WARNING:

- Do not store or use gasoline or other flammable vapors and liquids in the vicinity of this or any other equipment.
- Improper installation, adjustment, alteration, service or maintenance could lead to property damage, injury or death. Read the installation, operating and maintenance instructions thoroughly before installing or servicing CPG equipment. This manual must be retained for future reference.
- A factory authorized agent must handle all maintenance and repair.

Gas Pressure

- The appliance and its individual shutoff valve (to be supplied by user) must be disconnected from the gas supply piping system during any pressure testing of that system at test pressures in excess of ½ PSI (3.45 kPa).
- The appliance must be isolated from the gas supply piping system by closing its individual manual shut-off valve during any pressure testing of the gas supply piping system at test pressures equal to or less than ½ PSI (3.45 kPa).

Parts Manual

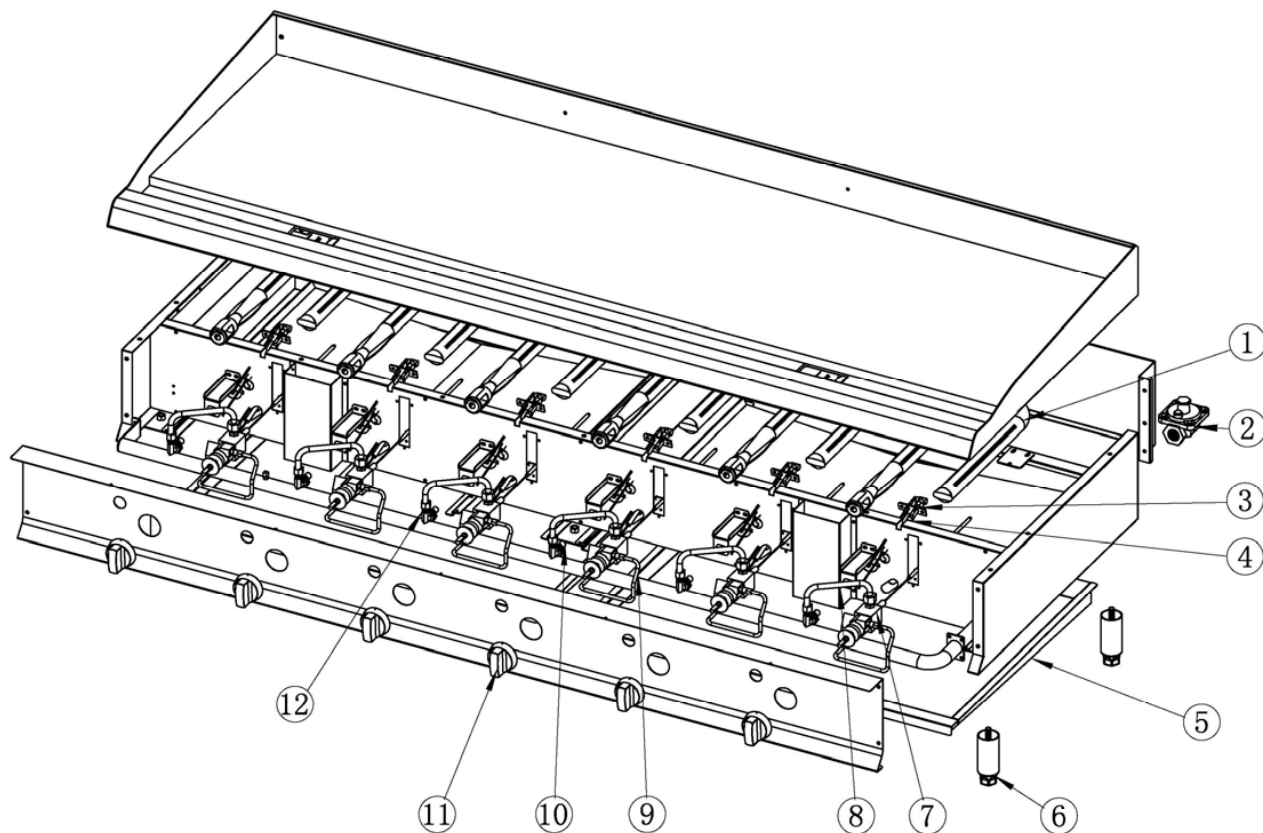

KEY	DESCRIPTION	MODEL	QTY
1	BURNER	351GTUCPG24 /L /N	2
		351GTUCPG36 /L /N	3
		351GTUCPG48 /L /N	4
		351GTUCPG60 /L /N	5
		351GTUCPG72 /L /N	6
2	REGULATOR	ALL MODELS	1
3	FLAME DEVICE SYSTEM (NO INCLUDE INJECTOR)	351GTUCPG24 /L /N	2
		351GTUCPG36 /L /N	3
		351GTUCPG48 /L /N	4
		351GTUCPG60 /L /N	5
		351GTUCPG72 /L /N	6
4	ODS INJECTOR - 0.45	351GTUCPG24N	2
		351GTUCPG36N	3
		351GTUCPG48N	4
		351GTUCPG60N	5
		351GTUCPG72N	6
	ODS INJECTOR - 0.25	351GTUCPG24L	2
		351GTUCPG36	3
		351GTUCPG48L	4
		351GTUCPG60L	5
		351GTUCPG72L	6

Parts Manual



**ULTRA
SERIES**

KEY	DESCRIPTION	MODEL	CODE	QTY
5	GREASE TRAY	351GTUCPG24 /L /N	01.05.1029318	1
		351GTUCPG36 /L /N	01.05.1029318	1
		351GTUCPG48 /L /N	01.05.1029318	1
		351GTUCPG60 /L /N	01.05.1030891	2
		351GTUCPG72 /L /N	01.05.1030870	2
6	FOOT	351GTUCPG24 /L /N	01.02.1005373	4
		351GTUCPG36 /L /N		4
		351GTUCPG48 /L /N		4
		351GTUCPG60 /L /N		6
		351GTUCPG72 /L /N		6
7	THERMOSTAT VALVE	351GTUCPG24 /L /N	01.20.1068510	2
		351GTUCPG36 /L /N		3
		351GTUCPG48 /L /N		4
		351GTUCPG60 /L /N		5
		351GTUCPG72 /L /N		6
8	MAIN PIPE ASSEMBLY	351GTUCPG24 /L /N	06.05.1472204	2
		351GTUCPG36 /L /N		3
		351GTUCPG48 /L /N		4
		351GTUCPG60 /L /N		5
		351GTUCPG72 /L /N		6
9	PILOT PIPE ASSEMBLY	351GTUCPG24 /L /N	06.05.1472205	2
		351GTUCPG36 /L /N		3
		351GTUCPG48 /L /N		4
		351GTUCPG60 /L /N		5
		351GTUCPG72 /L /N		6
10	ORIFICE	351GTUCPG24N	01.20.1068641	2
		351GTUCPG36N		3
		351GTUCPG48N		4
		351GTUCPG60N		5
		351GTUCPG72N		6
		351GTUCPG24L	01.20.1068651	2
		351GTUCPG36		3
		351GTUCPG48L		4
		351GTUCPG60L		5
		351GTUCPG72L		6
11	DIAL	351GTUCPG24 /L /N	06.05.1473191	2
		351GTUCPG36 /L /N		3
		351GTUCPG48 /L /N		4
		351GTUCPG60 /L /N		5
		351GTUCPG72 /L /N		6
12	ORIFICE CONNECTION	351GTUCPG24 /L /N	01.18.1067404	2
		351GTUCPG36 /L /N		3
		351GTUCPG48 /L /N		4
		351GTUCPG60 /L /N		5
		351GTUCPG72 /L /N		6