

## TRM Installation Packet



**STOP! All work detailed in these instructions must be done by a qualified technician.**



**Subject:** TRM Installation Packet

**Date:** November 22, 2024

**Models / Parts Affected:** TRM

**Voltages:** All Voltages

### Contents

#### Overview

Required Tools .....	2
Installation Tips.....	2
Side Identification.....	3
Screw Identification .....	4
Parts Identification.....	4

#### Installation

Uncrate & Move the Appliance.....	9
Leveling .....	12
Seismic Anchors .....	13
Install Refrigeration Deck(s) .....	14
Install the Main Electrical Box .....	16
Mount the Temperature Control Assembly .....	17
Install the Shroud Supports.....	18
Facility Management Systems .....	18
Install the Air Dividers.....	19
Verify Operation .....	19
Install the Shrouds & Shroud Junctions .....	20
Install the Door Junctions.....	21
Install the Side & Front Kickplates .....	22
Misc. Wrap Up .....	25
Make Door Adjustments .....	27

#### Door Reversal

Required Tools .....	28
Procedure .....	28

### Questions or Concerns

For more information, please contact our Technical Support team.

#### North America – USA, Canada & Caribbean

**Warranty Phone:** +1 855 878 9277

**Warranty Fax:** +1 636 980 8510

**Warranty Email:** WarrantyInquiries@TrueMfg.com

**Technical Phone:** +1 855 372 1368

**Technical Email:** Service@TrueMfg.com

7:00am-6:00pm CST Monday-Friday;

8:00am-12:00pm Saturday

#### European Union & Commonwealth of Independent States

**Phone:** +41 61 563 0705

Service-EMEA@TrueMfg.com

8:00am-5:00pm M-F

#### UK, Ireland, Middle East, Africa & India

**Phone:** +44 (0) 800 783 2049

Service-EMEA@TrueMfg.com

8:30am-5:00pm M-F

#### Latin America

**Phone:** +52 555 804 6343/44

ServiceLatAm@TrueMfg.com

9:00am-5:30pm M-F

#### Mexico

**Phone:** +52 555 804 6343/44

Service-MexicoCity@TrueMfg.com

9:00am-5:30pm M-F

#### Australia

**Phone:** +61 2 9618 9999

Service-Aus@TrueMfg.com

8:30am-5:00pm M-F

### Overview

This document details the installation procedure for TRM models.



**WARNING!** Tip over hazard. Appliance may pose a tipping hazard when uncrating, installing, or moving the appliance. Take appropriate safety precautions. Use of tip over restraints may only reduce (not eliminate) the tipping hazard. Never allow children to climb or hang on drawers, doors, or shelves.



**WARNING!** Electrical shock or burn hazard. Powering off an electronic control does not remove power from all components. Unplug the unit or disconnect power before proceeding.



**WARNING!** Sharp edges. Take care when installing, cleaning, servicing, and maintaining the equipment.



**WARNING!** The appliance owner is responsible for performing a Personal Protective Equipment (PPE) Hazard Assessment and to ensure adequate protection during maintenance and cleaning procedures. Use appropriate tools, safety equipment, and PPE during installation and servicing.





## TRM Installation Packet

### Required Tools\*

Required tools include (but may not be limited to) the following:

- Gloves
- Eye Protection
- Ladder(s) [6' (1.8 m) minimum]
- T-25 Bit
- Phillips Screwdriver or Bit Driver
- Magnetic 1/4" Hex Head Driver
- 12" (304.8 mm) Magnetic Drill Extension
- Cutting Tool
- Level (2-3' for 2-door; 2-4' for 3- and 4-door)
- Padding (possible)
- 3/8" Socket
- 9/16" Socket
- Drill
- Impact Drill (18V)\*\*

\*Depending on the number of installers and the scope of the installation, multiple sets of the required tools list will increase the efficiency of the installation process.

\*\*For lowering the leveling legs. See "Leveling."



### Installation Tips

- Unit height without skid is 80-1/2" (2044.7 mm).
- Unit height with skid is 88" (2235.2 mm).
- Unit height with skid and boxes is 100" (2540 mm).
- Always start installing a line of units at an end (N-side). See next page.

**EXCEPTION: For L-shaped lines, start with the corner appliances.**

- For ease of installation, position the unit farthest from the building entry point first.
- Level units to each other.
- Italicized steps indicate installing junction pieces, or the pieces connecting two adjoining units.
- Connecting sides have a Y in the full model name; non-connecting sides have an N in the full model name. See next page.
- **Boxed components are specific to the appliance they ship with.**
- Install the units as described in the installation procedure.



## TRM Installation Packet

### Side Identification

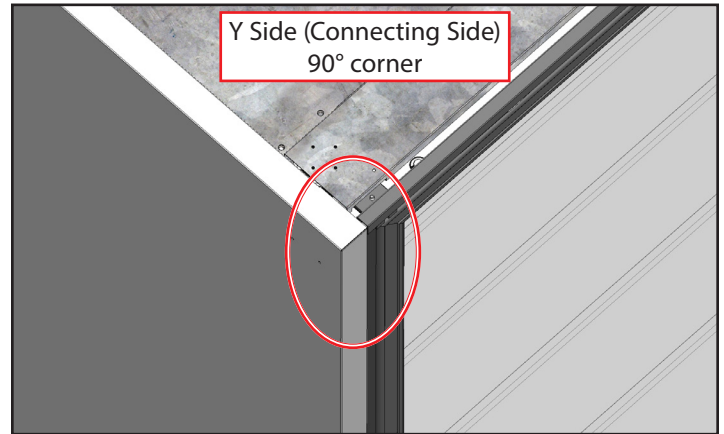
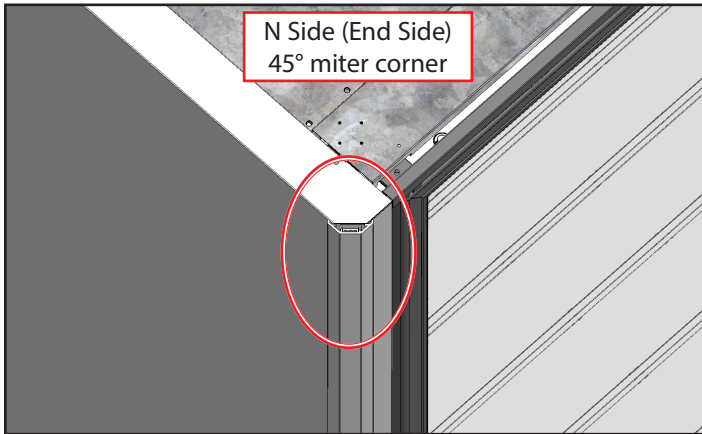
There are two side styles: N sides (end sides) and Y sides (connecting sides). You can identify the type of side a TRM has by the model nomenclature and the front corners.

- Model Nomenclature

TRM2MS-**NN**-BLK-WHT-1BLKLL-4

Code	Definition
NN	No adjacent units (end sides)
YY	Adjacent unit on the left and right (connecting sides)
NY	Adjacent unit on the right (connecting side); no adjacent unit on the left (end side)
YN	Adjacent unit on the left (connecting side); no adjacent unit on the right (end side)

- Front Corners





## TRM Installation Packet

### Screw Identification

Locate screws A-E in individual labeled bags inside the packaging.

**A** 8-18 x 1/2" 1/4" Hex Head



**B** 8-32 x 3/8" Phillips Hex Head



**C** 8-18 x 1/2" Phillips Head, Thin



**D** 8-18 x 1/2" 1/4" Hex Head



**E** 8-32 x 5/8" Phillips Truss Head



### Parts Identification

Installation components come packaged in multiple boxes. The possible contents of each box are shown in this section.

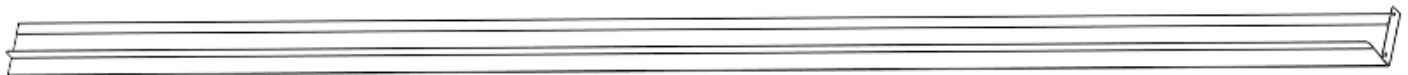
**Please note:**

- **Your installation may not have all the components shown.** Required components vary by application.
- **Your components may not exactly match the components shown.**
- Bolts, nuts, and washers contained in the boxes are **not represented** in this section.
- **Components are not to scale.**
- Boxed components are **specific to the appliance they ship with.**
- Numbers are for identification purposes within this installation instruction. Items are not physically labeled as such.

### Door Junction (wrapped)

(rear view; shown horizontally; installed vertically)

**1**



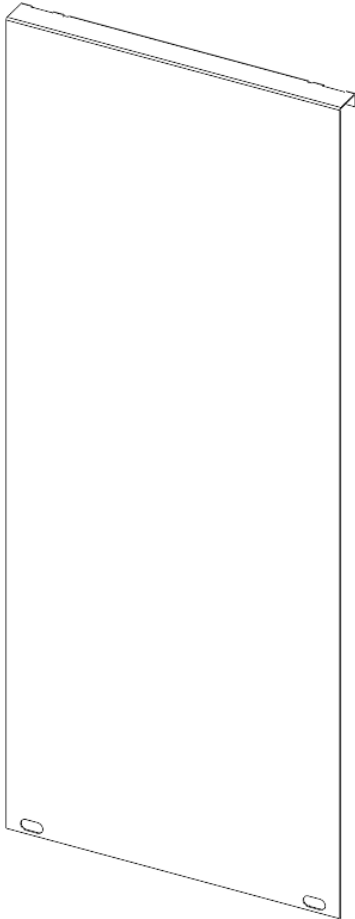


## TRM Installation Packet

### Junction Box Components

Shroud Junction

2



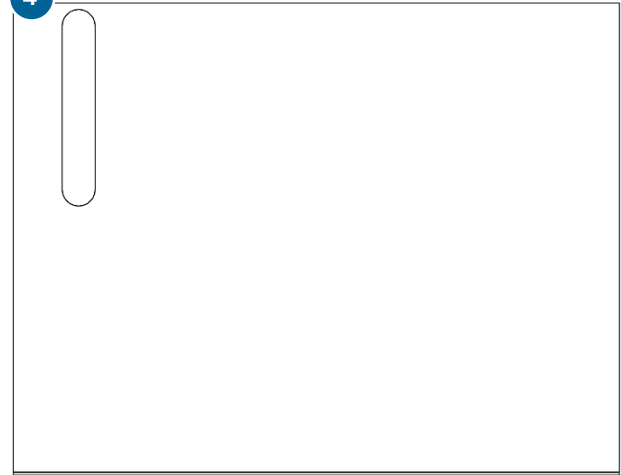
Rear Kickplate Junction

3



Front Kickplate Junction

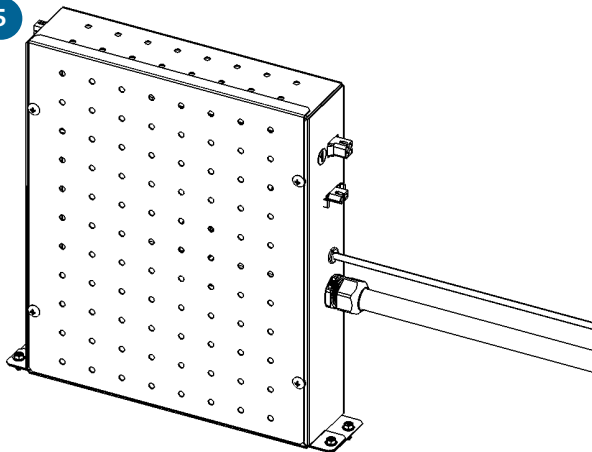
4



### Electrical Box Components

Main Electrical Box

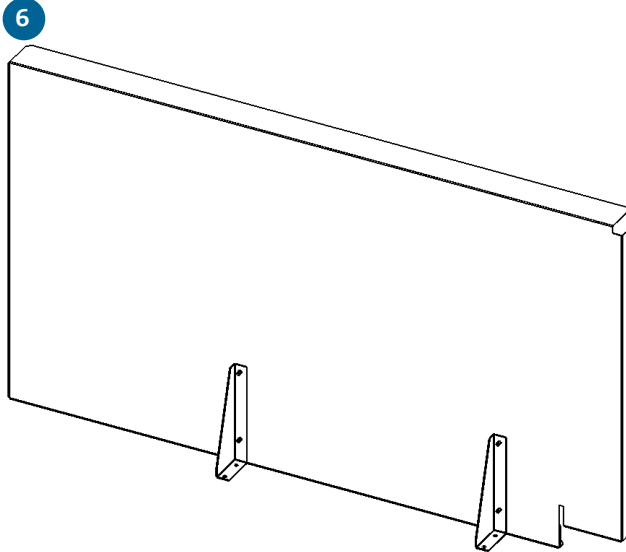
5



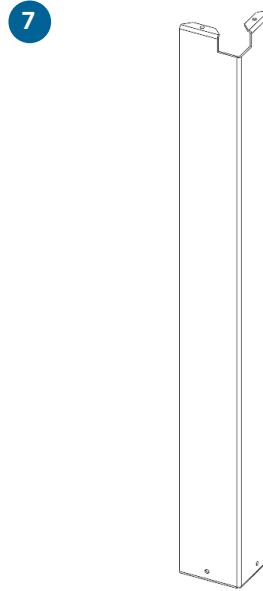
## TRM Installation Packet

### Air Divider Box Components

Air Divider

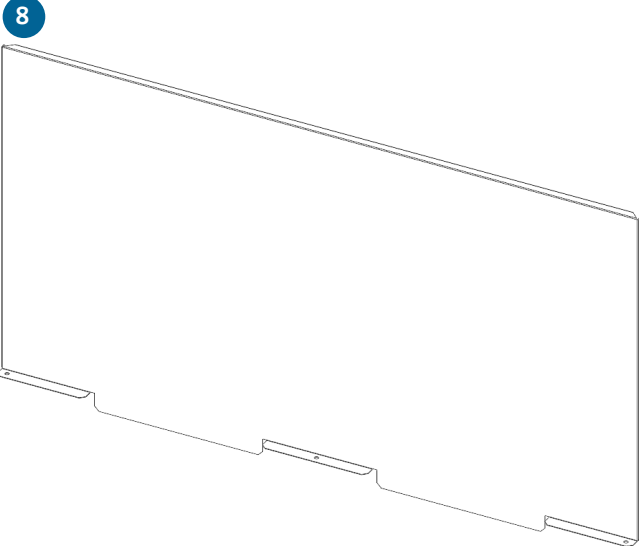


Shroud Support

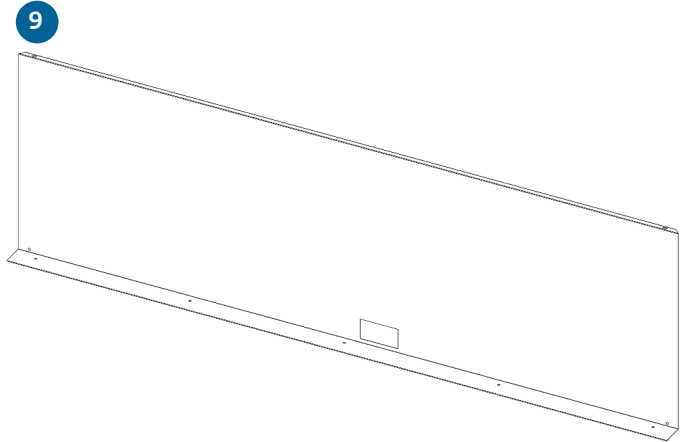


### Shroud Box Components

Side Shroud



Front Shroud

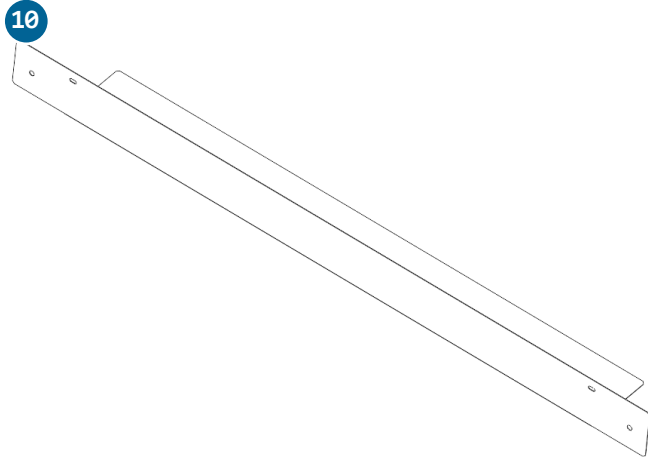




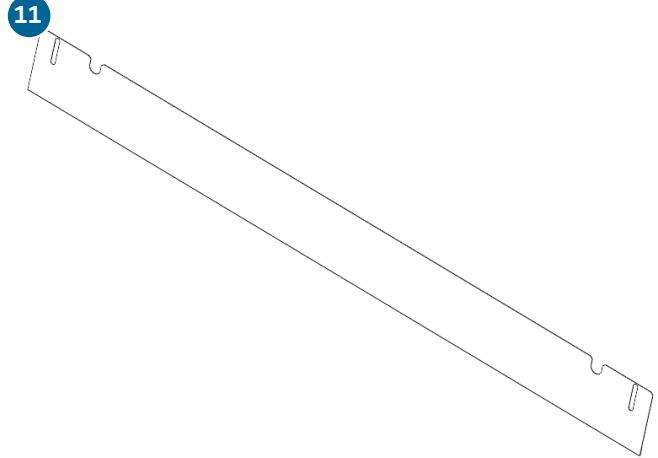
## TRM Installation Packet

### Kickplate Box Components

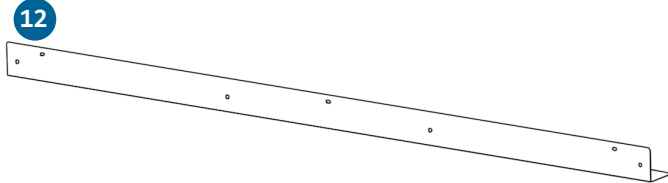
Side Kickplate Support



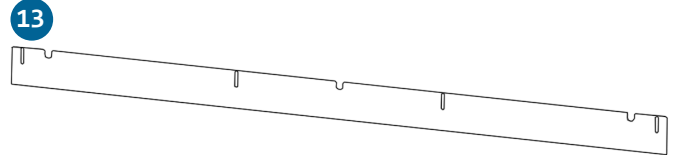
Side Kickplate



Front Kickplate Support

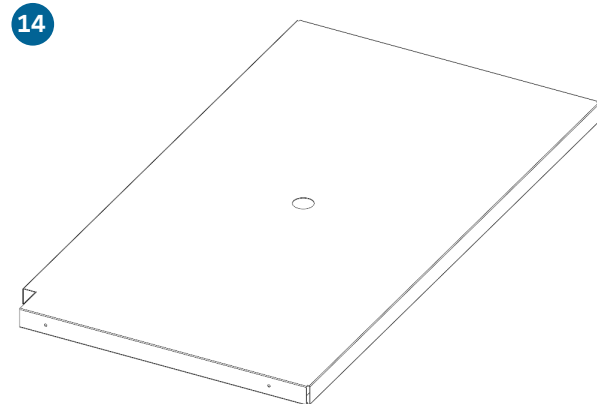


Front Kickplate

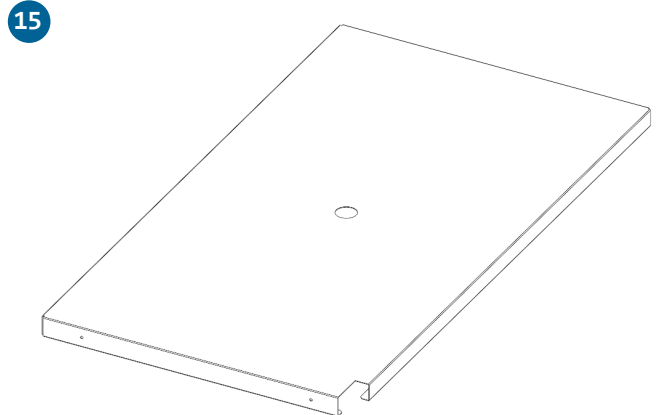


### Floor Shelf Box Components

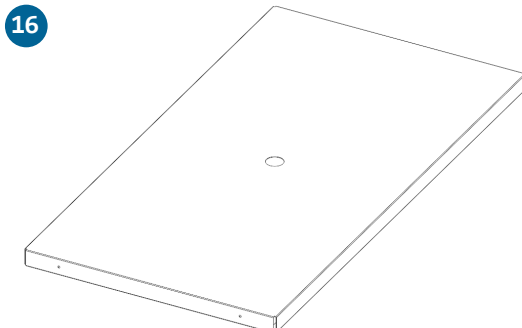
Left Floor Shelf



Right Floor Shelf



Middle Floor Shelf





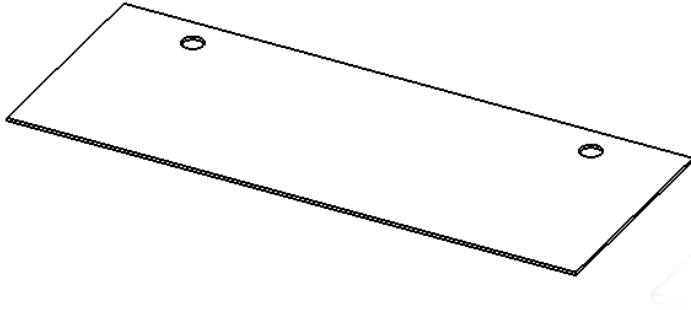
## TRM Installation Packet

### Leveling Leg Tools Bag\*

\*Not all components shown

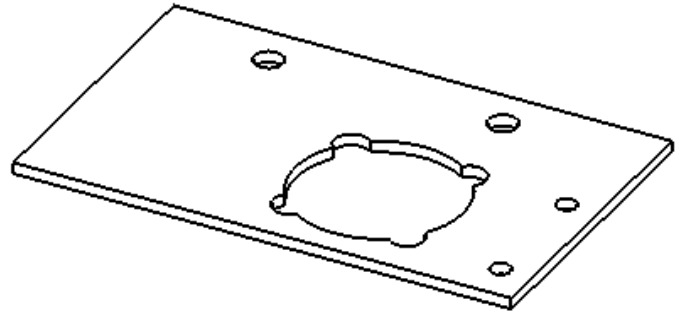
Replacement cover plate

17



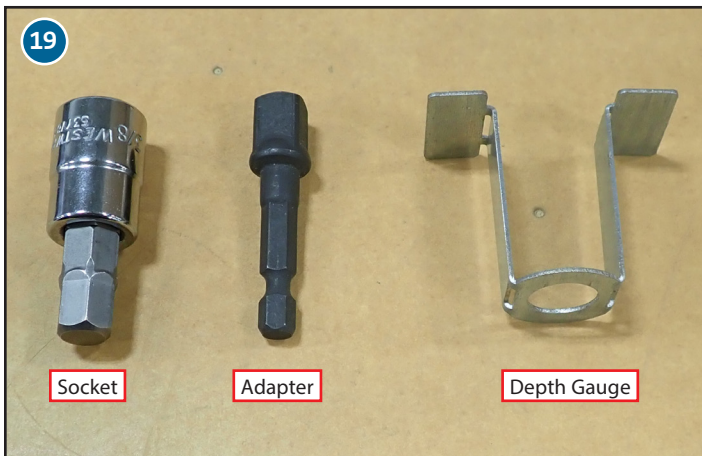
Replacement torque master plate

18



Leveling Tools

19



Socket

Adapter

Depth Gauge



## TRM Installation Packet

### Installation

This document describes the installation procedure after the appliances have been unloaded and are on the ground.

**NOTE: Italicized steps indicate installing junction pieces, or the pieces connecting two adjoining units.**

### Uncrate & Move the Appliance

1. Move the unit as close as possible to the final installation location. See figs. 1 and 3.

**NOTE: This step may require removing exterior packaging. See steps 2 and 3.**

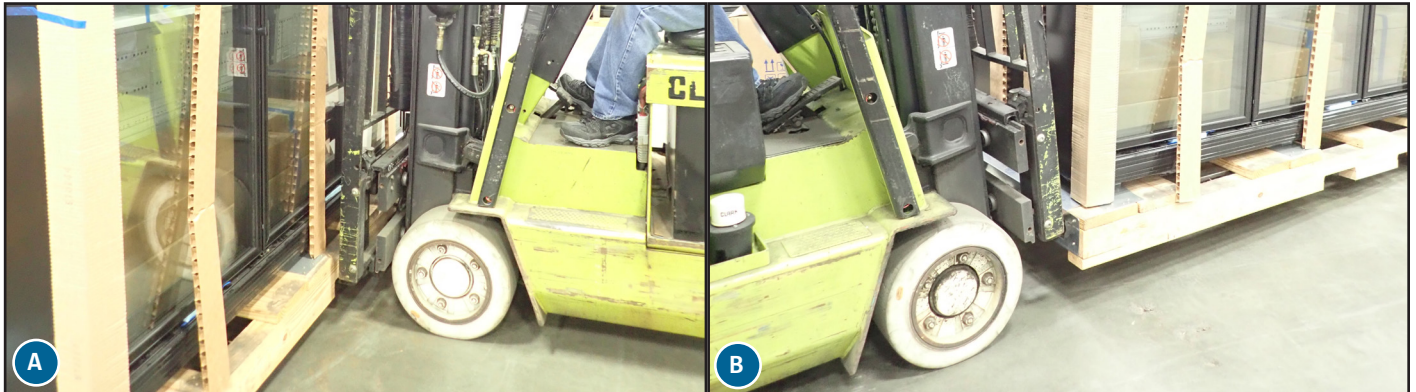


Fig. 1. There are two ways to move the appliance with a forklift.

A: Forklift from the front, uses 48" (1219.2 mm) forks.

B: Forklift from the side with pallet antitip bracket, uses 72" (1828.8 mm) forks.

**NOTE: To use a pallet jack, remove the lower screws from the pallet antitip bracket; then fold the bracket up. See fig. 2.**

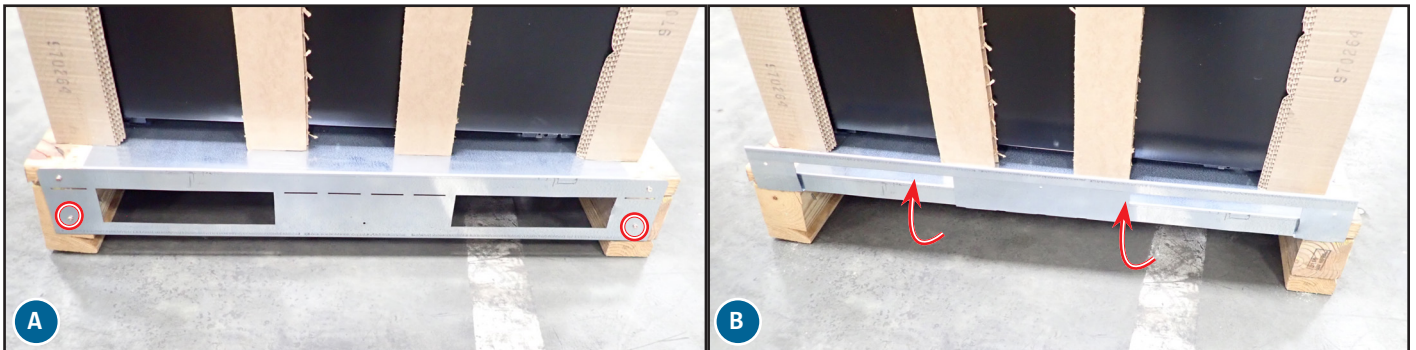


Fig. 2. Lower skid antitip bracket screws (A). Then, fold the skid antitip bracket up (B).

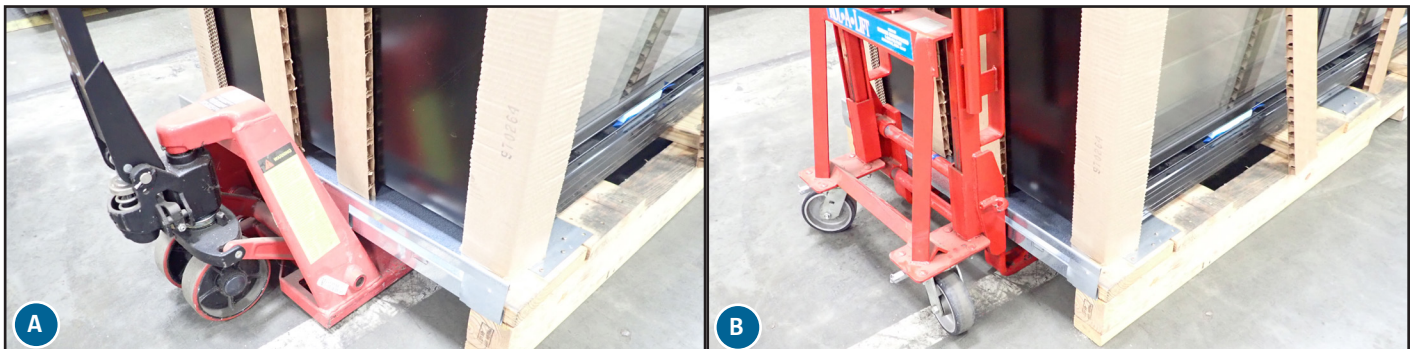


Fig. 3. More methods for moving crated appliances.

A: Pallet jack (with folded pallet antitip bracket).

B: Rol-A-Lifts (qty 2).



## TRM Installation Packet

2. Remove the exterior packaging.

**NOTE: Leave the doors taped shut.**



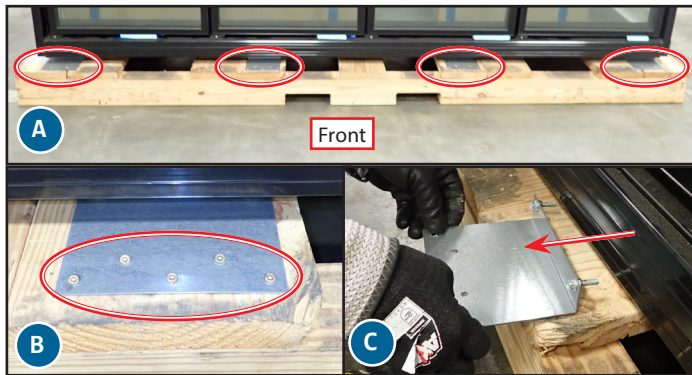
**NOTE: Removing exterior packaging may include removing boxed components from the appliance's top. Boxed components are specific to the appliance they ship with. Keep boxed contents grouped with the appliance they go with.**

3. Remove the skid.

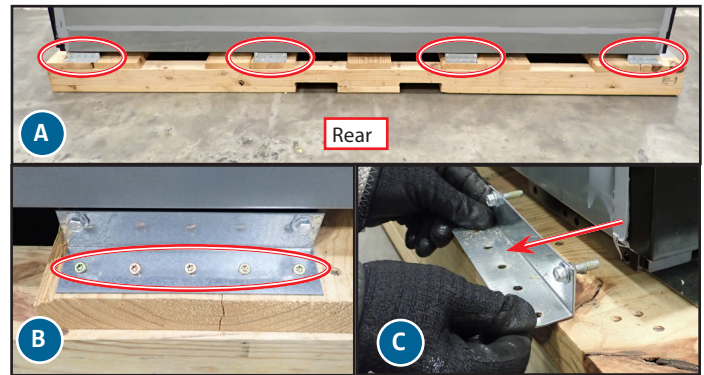
- a. Remove the front and rear skid brackets. See figs. 4 and 5.
- b. With a lift, carefully lift the unit from the skid. See fig. 6 and 7.

**NOTE: Be sure Rol-A-Lifts hook into the leveling support plate. See fig. 8.**

- c. Pull the skid from underneath the unit.



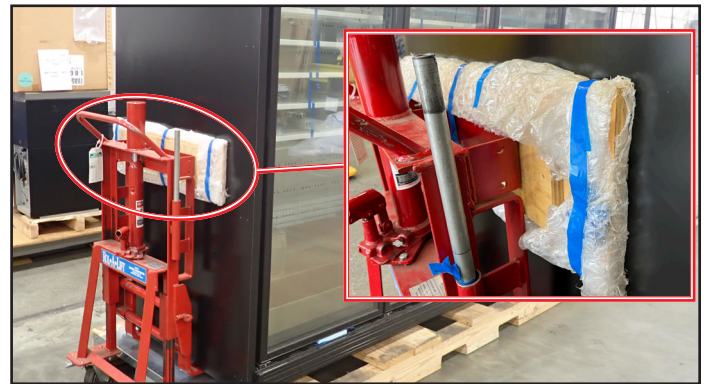
**Fig. 4.** Front skid bracket locations (A). Remove the screws (B) and pull the bracket towards you (C).



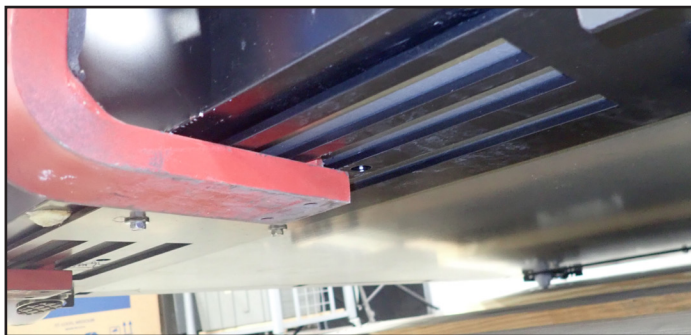
**Fig. 5.** Rear skid bracket locations (A). Loosen the screws (B) and pull the bracket towards you (C).



**Fig. 6.** Lift the unit with a forklift.



**Fig. 7.** Lift the unit with a pair of Rol-A-Lifts. Be sure to use padding between the Rol-A-Lifts and the appliance.



**Fig. 8.** Rol-A-Lift arms hooked into the leveling support plate.



## TRM Installation Packet

4. Move the unit into the installation location. See fig. 8.

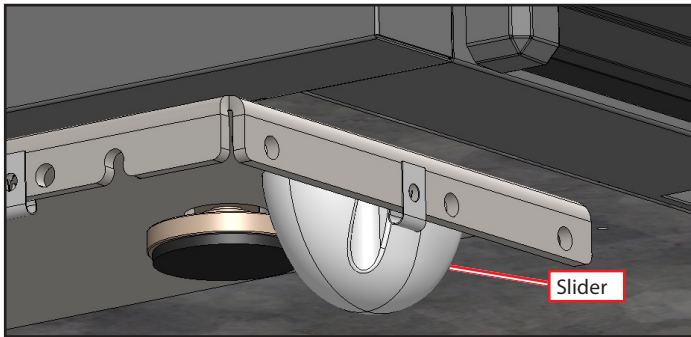
**NOTE: Do not move by doors or door handles.**

**NOTE: On L-shaped lines, start by positioning the corner appliances with the corners touching. See fig. 9.**

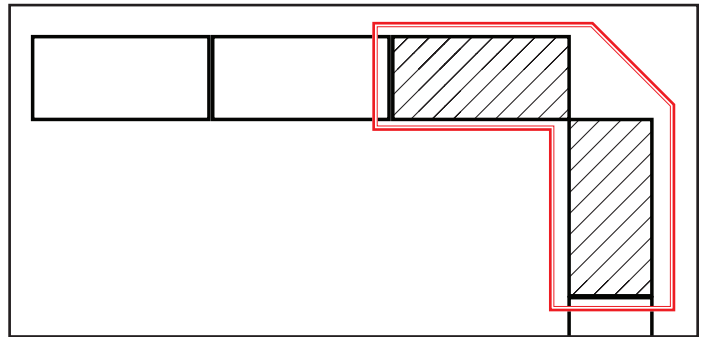
**NOTE: For multiple units, level the first unit before positioning the adjoining unit. See "Leveling."**

**NOTE: The bottom spacer must touch the adjoining unit and the units' fronts must be flush. See figs. 10 and 11.**

**NOTE: Verify the units make a straight line and make any minor adjustments to the unit location before lowering any leveling legs.**



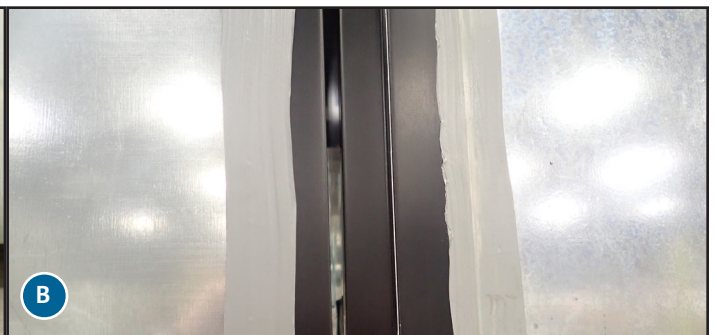
**Fig. 8.** Sliders provide limited mobility on a smooth surface after the skid has been removed. Bottom view.



**Fig. 9.** Start positioning L-shaped lines with the corner appliances.



**Fig. 10.** Front bottom spacer touching the adjoining unit (A). Front middle spacers may not touch (B); this resolves during the leveling process.



**Fig. 11.** Bottom of rear spacer touching the adjoining unit (A). The rest of the rear spacer may not touch (B); this resolves during the leveling process.



## TRM Installation Packet

### Leveling

1. Remove tape from the doors.
2. Remove the packages from inside the unit.



**Boxed components are specific to the appliance they ship with. Keep boxed contents grouped with the appliance they go with.**

3. Remove the interior backguards. See figs. 1 and 2.



**Fig. 1.** Lift the interior backguard and pull it forward.



**Fig. 2.** Interior backguard removed to access rear leveling leg (circled).

4. Level the unit with the TRUE LEVEL™ leg system.

**NOTE: Level units to each other. True recommends waiting to plug and cap the leveling leg holes until the entire line of units is ready. See "Misc. Wrap Up."**

**NOTE: For multiple units, level the first unit before positioning the adjoining unit.**

- a. Make any final adjustments to the unit's positioning.
- b. With the provided leveling tools (#19; see fig. 3), lower the corner leveling legs until the tops of the legs are flush with the interior floor.
- c. With the provided leveling tools, lower the corner leveling legs until the depth gauge is flush with the interior floor. See fig. 4.

**NOTE: Lowering the leveling legs in stages reduces tension on the other leveling legs.**

**NOTE: Keep in mind how the unit will tilt/move from its position as you lower the leveling legs.**

**NOTE: Once lowered, the leveling leg has  $\pm 1/2"$  (12.7 mm) of adjustability.**

- d. From the appliance floor, verify the appliance is level side-to-side. See fig. 5. Adjust leveling legs accordingly.

**NOTE: Bubble must be centered between the lines. See fig. 7.**

- e. From the appliance front, verify the appliance is level front-to-back. See fig. 6. Adjust leveling legs accordingly.

**NOTE: Bubble must be centered between the lines. See fig. 7.**

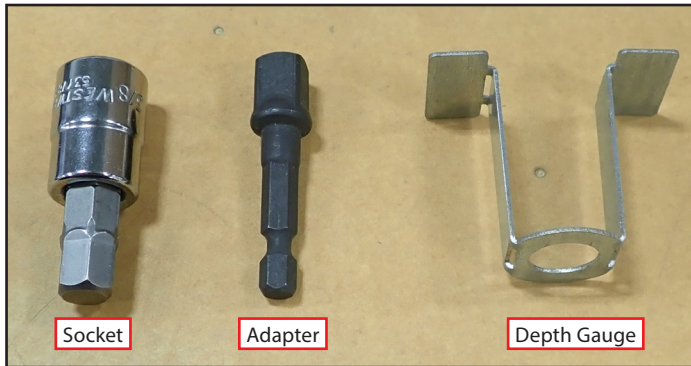
- f. Lower the center leveling legs (if so equipped) until the you feel resistance.

**NOTE: Take care to not lower the center leveling legs too much.**

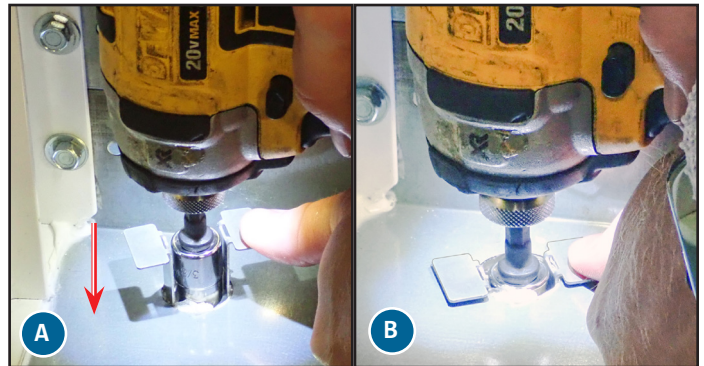
**NOTE: Center leveling legs (3- and 4-door units) and one front/one back leveling leg (2-door units) have rubber on the bottom. The appliance cannot be moved after lowering these legs.**



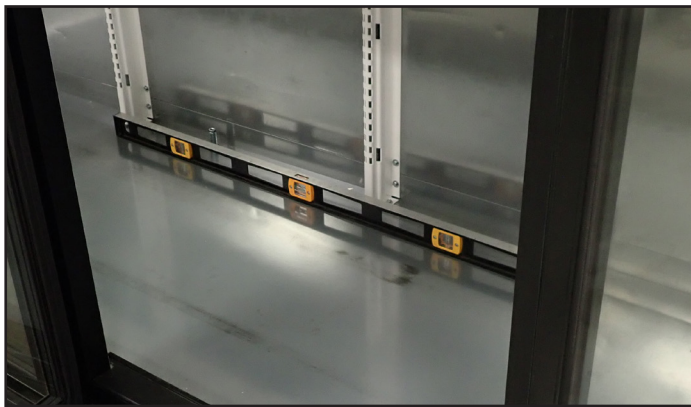
## TRM Installation Packet



**Fig. 3.** Provided leveling tools.



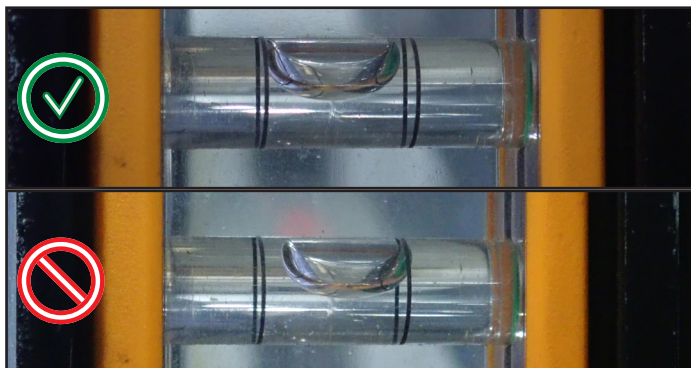
**Fig. 4.** Push the leveling assistant down as you lower the leveling leg.



**Fig. 5.** Place the level on the interior floor. Level side-to-side.



**Fig. 6.** Place the level on the door's hinged side. Level front-to-back.



**Fig. 7.** Leveling bubble must be centered between the lines.

### Seismic Anchors

1. If your appliance is being installed in a region requiring seismic anchors, install seismic kits per the seismic installation instructions at this time. See QR code.





## TRM Installation Packet

### Install Refrigeration Deck(s)

1. Install the refrigeration deck onto the unit's top. Repeat step as needed.

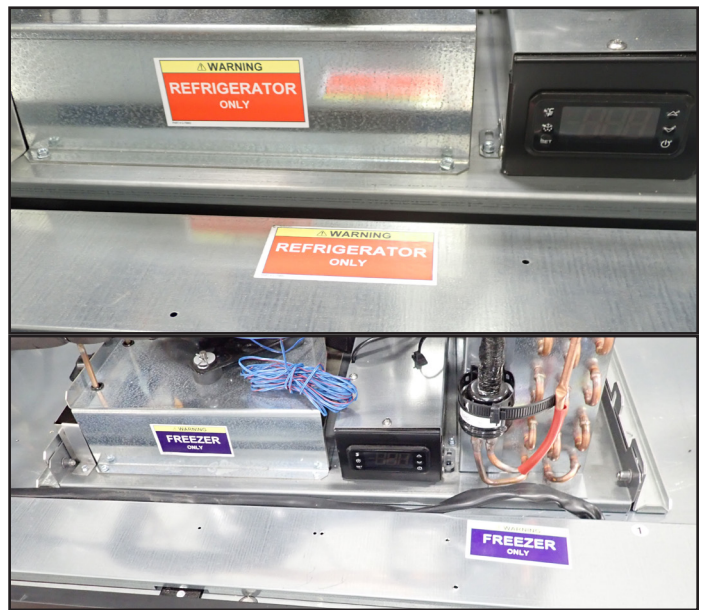
**NOTE: Be sure to match the correct refrigeration deck to the correct appliance. See nomenclature on the exterior packaging (fig. 1) and refrigerator/freezer labels on the refrigeration decks and the unit's top (fig. 2).**

- Remove the exterior packaging.
- Locate the refrigeration deck bolts. See fig. 3.
- Remove the refrigeration deck from its skid. See fig. 4.
- With the control facing forward, carefully position the refrigeration deck on top of the unit. See fig. 5 and 6.
- Hand-thread the two front vertical refrigeration deck bolts on both sides to hold the refrigeration deck in position. See fig. 7.
- Loosen the horizontal refrigeration deck bolts on both sides (see fig. 8) to lower the refrigeration deck to the unit's top.
- Hand-thread the two rear vertical refrigeration deck bolts on both sides. See fig. 9.
- Tighten all 16 vertical and horizontal refrigeration deck bolts until snug.

**NOTE: DO NOT overtighten. In the event of a stripped vertical rivnut, install a self-tapping vertical bolt in the nearest alternate hole. See fig. 10.**



**Fig. 1.** The letter in the nomenclature identifies the type of refrigeration deck.



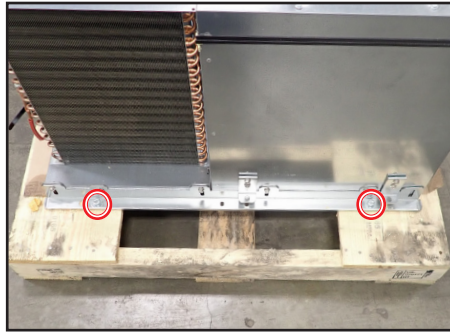
**Fig. 2.** Refrigeration deck label stickers on the refrigeration deck and the unit's top.



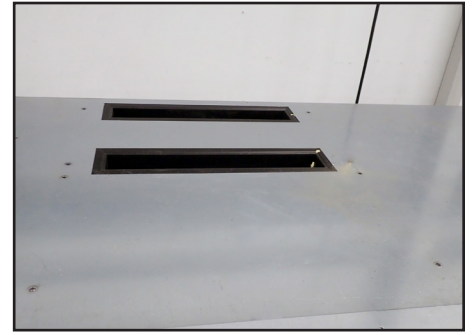
## TRM Installation Packet



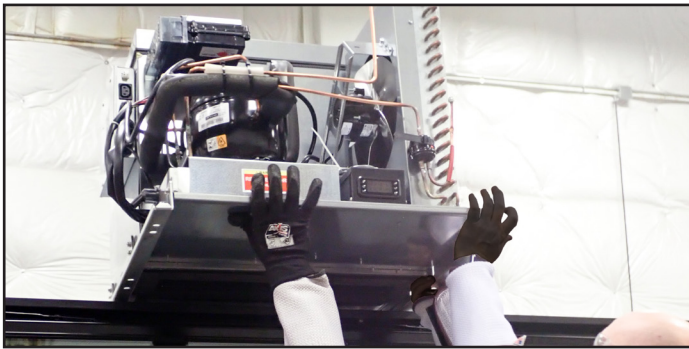
**Fig. 3.** Refrigeration deck vertical bolts.



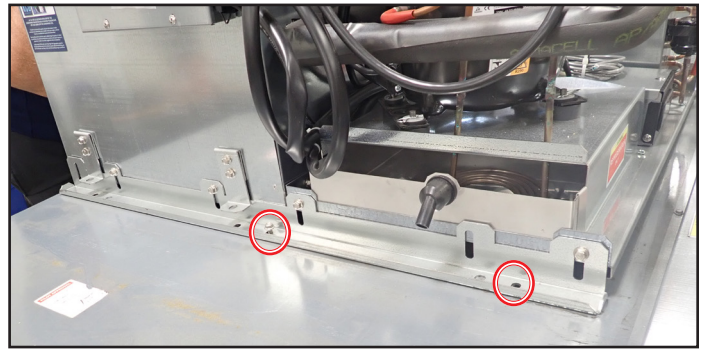
**Fig. 4.** Refrigeration deck shipping bolt locations. Other side not shown.



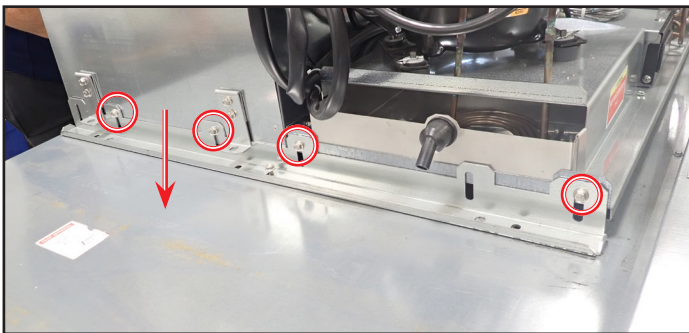
**Fig. 5.** Ducts and predrilled holes for the refrigeration deck.



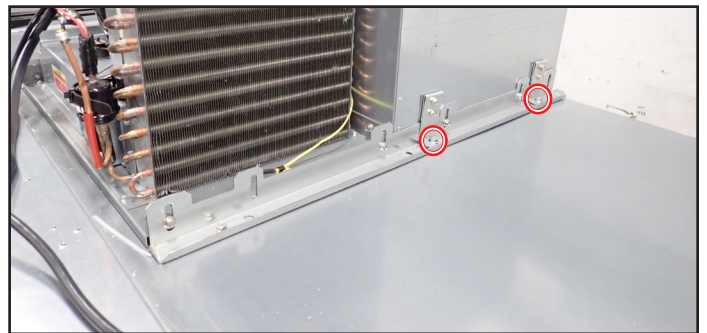
**Fig. 6.** Lift the refrigeration deck onto the unit.



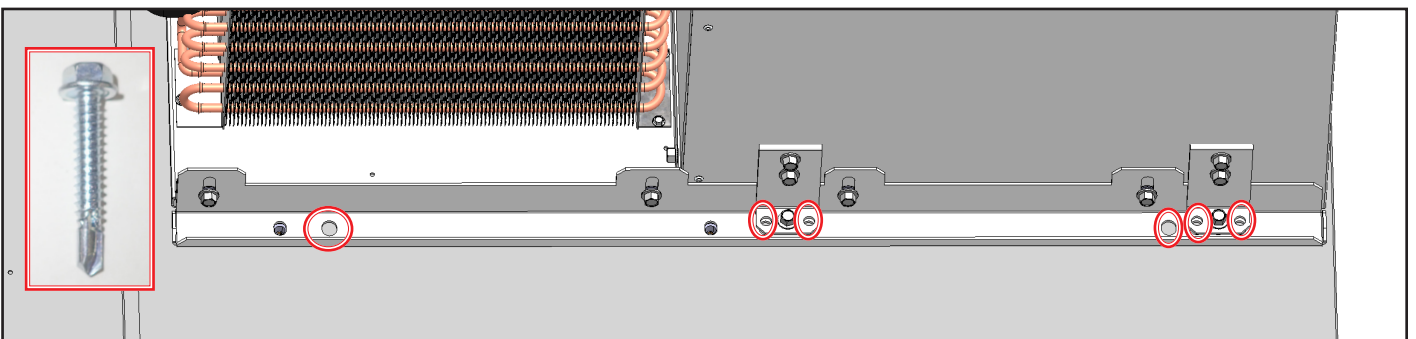
**Fig. 7.** Thread the front vertical bolts. Other side not shown.



**Fig. 8.** Horizontal refrigeration deck bolt locations. **Loosen; do not remove.** Other side not shown.



**Fig. 9.** Thread the rear vertical bolts. Other side not shown.



**Fig. 10.** Alternate holes in the refrigeration deck side bracket. Other side not shown.

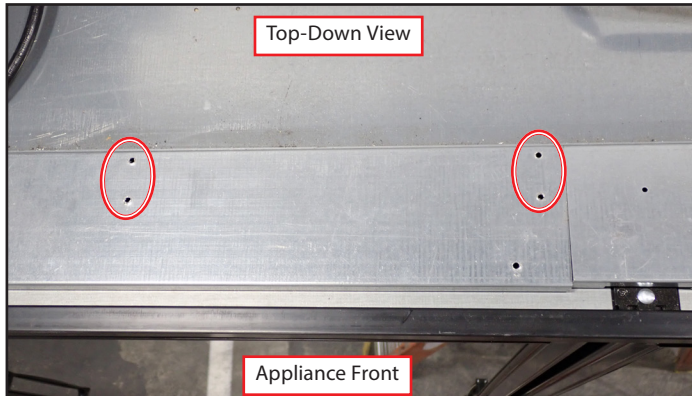


## TRM Installation Packet

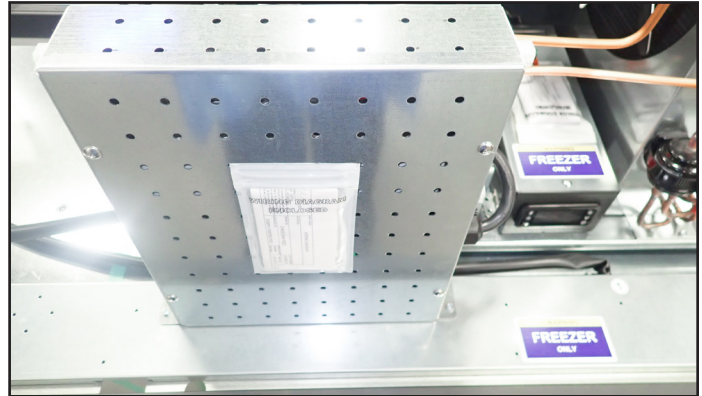
### Install the Main Electrical Box

1. With screws **B**, install the main electrical box (#5) with the hole side facing forward. See figs. 1 and 2.

**NOTE: Main electrical boxes are specific to the unit they ship with. Make sure the label on the main electrical box (rear side) matches the labels on the refrigeration deck(s) and the unit.**



**Fig. 1.** Predrilled holes in the appliance top for the main electrical box.

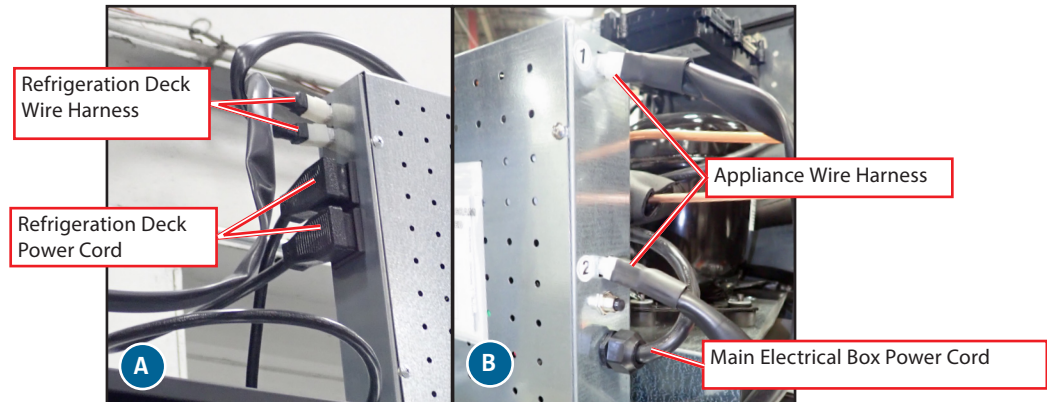


**Fig. 2.** Installed main electrical box.

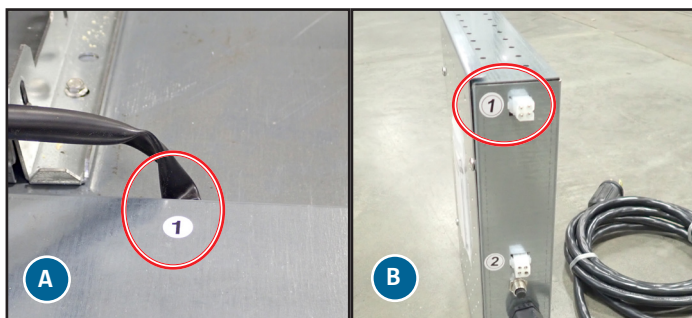
2. Connect the following to the main electrical box (see fig. 3):

- Refrigeration deck wire harness(es)
- Refrigeration deck power cord(s)
- Appliance wire harness(es)

**NOTE: Be sure to match the number on the appliance wire harness to the number on the main electrical box. See fig. 4.**



**Fig. 3.** Main electrical box connections. Left (A) and right (B) sides. Freezer unit shown.



**Fig. 4.** Label for appliance wire harness (A) and main electrical box (B).



## TRM Installation Packet

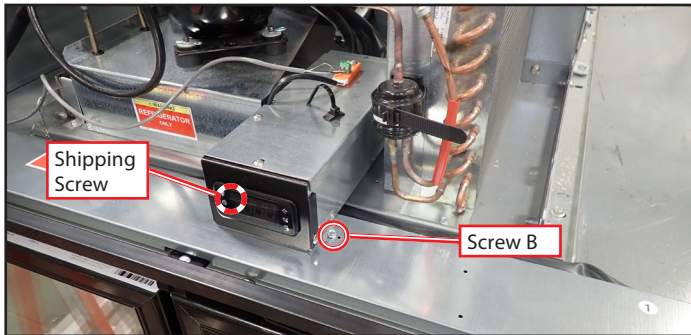
### Mount the Temperature Control Assembly

1. Remove the temperature control assembly shipping screw and shift the temperature control assembly forward. See fig. 1.



**Fig. 1.** Temperature control assembly shipping screw screw location.

2. With screw **B** and the shipping screw, install the temperature control assembly in the forward position. See fig. 2.



**Fig. 2.** Temperature control shifted forward. Install with two (2) screws total.

3. Repeat steps 1 and 2 for each temperature control assembly.

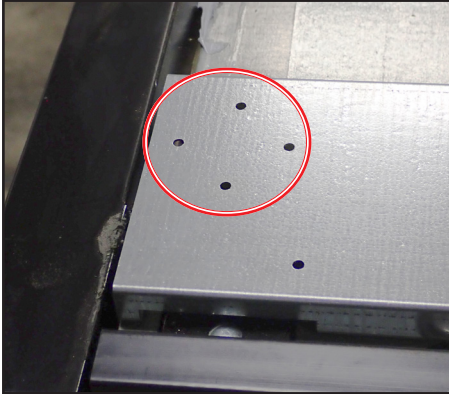


## TRM Installation Packet

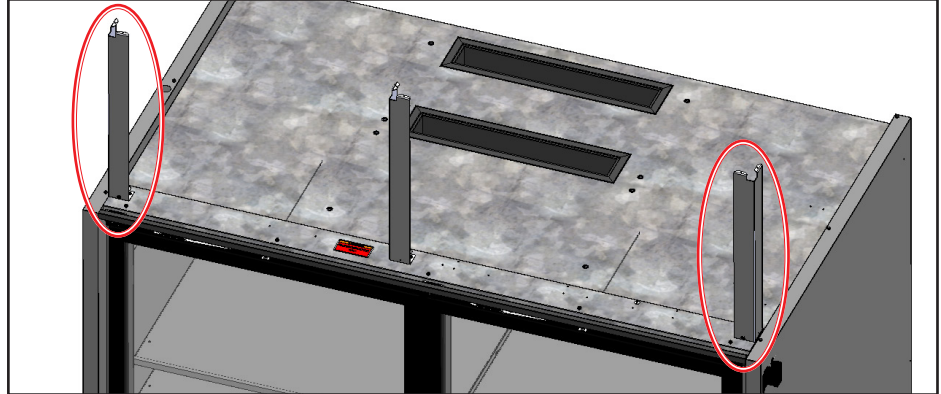
### Install the Shroud Supports

1. With screws **B**, install the shroud supports (#8). See fig. 1.

**NOTE: Be sure the shroud support corners are aligned with the closest front corner of the appliance. See fig. 2.**

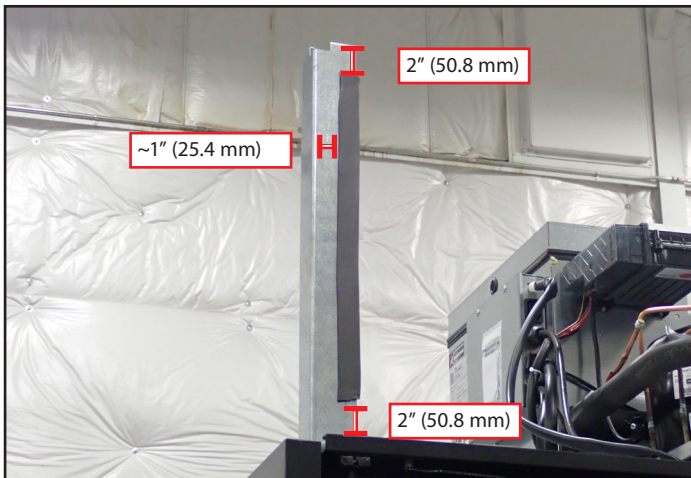


**Fig. 1.** Predrilled holes for shroud supports. Top-down view.



**Fig. 2.** Install the shroud supports with the supports' corners aligned with the closest front corner of the unit.

2. Apply the provided tape to the front faces of the shroud supports. See fig. 3.



**Fig. 3.** Apply the tape to the front of the shroud supports about 1" from the side and 2" from the top/bottom.



### Facility Management Systems

1. If applicable, connect the TRM temperature controls to a facility management system at this time (ex. RS-485 RTU).



## TRM Installation Packet

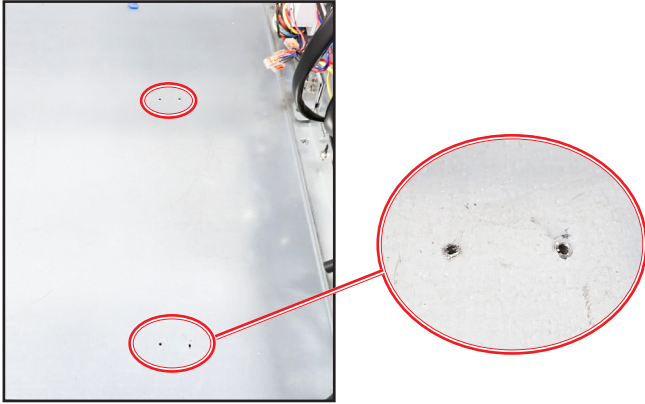
### Install the Air Dividers

1. With screws **A**, starting between the refrigeration decks (if so equipped), install an air divider (#7) to the right of each refrigeration deck. See figs. 1 and 2.

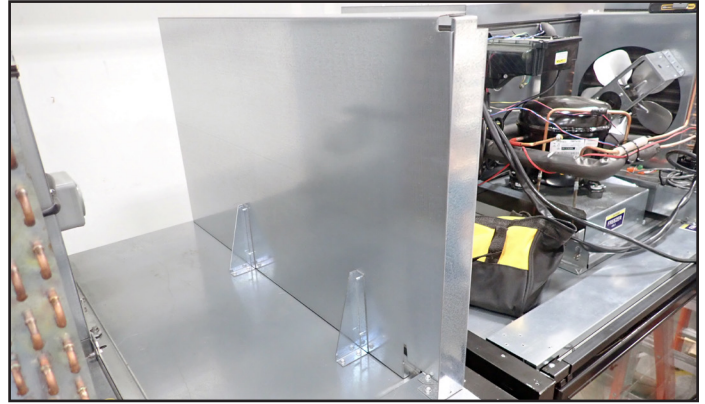


**EXCEPTION: DO NOT install air dividers on the far right of YN units.**

**NOTE: Be sure to tuck the cords into the notch.**



**Fig. 1.** Predrilled holes for air dividers. Top-down view; example shown is between refrigeration decks.



**Fig. 2.** Install air dividers to the right of refrigeration decks. Far right divider shown.



**Fig. 3.** Wires tucked into the air divider notch.

### Verify Operation

1. Plug in the main electrical box power cord and verify operation.



## TRM Installation Packet

### Install the Shrouds & Shroud Junctions

1. With screws **B**, install the front shroud(s) (#9). See fig. 1.

**NOTE: Install shroud junctions (#2) on connecting sides (Y sides). See next step.**

**NOTE: Be sure the display is positioned in the shroud display hole. See fig. 2.**

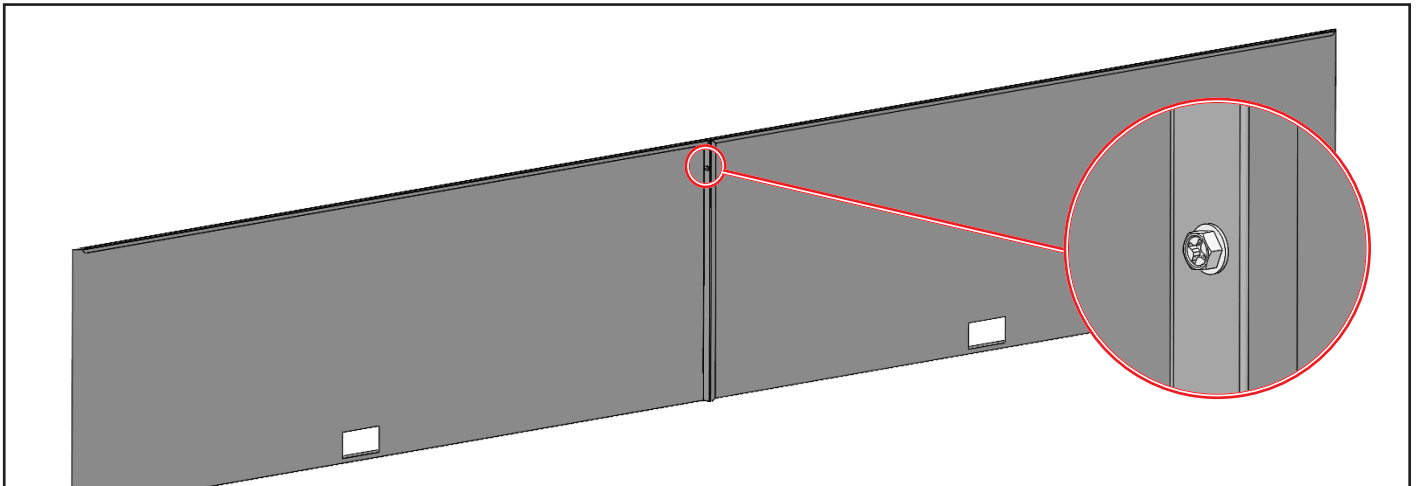


**Fig. 1.** Example of front shroud screw locations.



**Fig. 2.** Display showing through the shroud display hole.

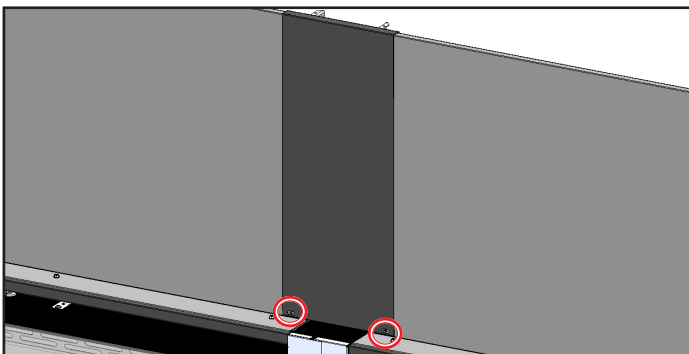
**Four/Five-Section Units Only: With screws **A**, connect the front shrouds before installing the front shrouds on the unit. See fig. 3.**



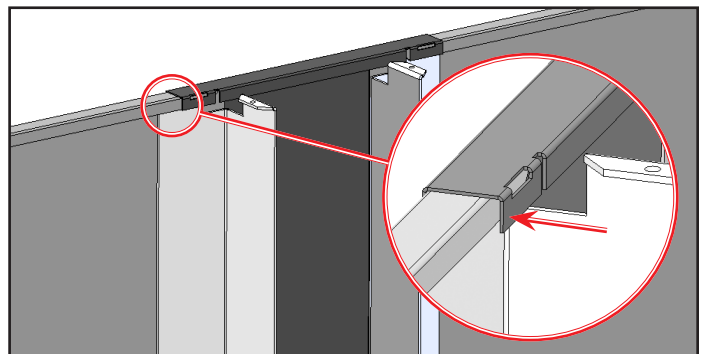
**Fig. 3.** Connected front shrouds.

2. With screws **C**, install the shroud junction (#2) over the front shrouds. See fig. 4.

**NOTE: Be sure to press in the shroud junction rear tabs. See fig. 5.**



**Fig. 4.** Shroud junction screw locations.



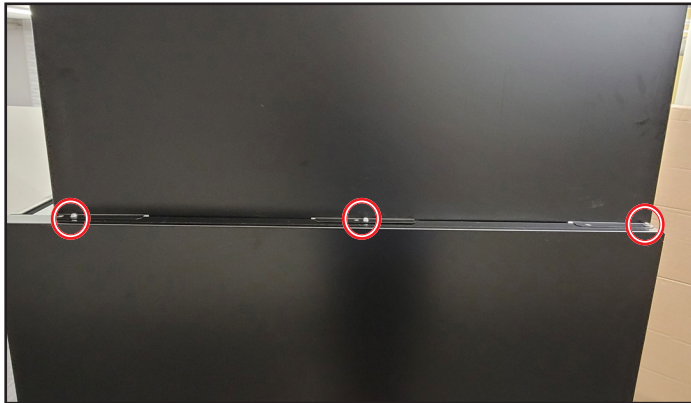
**Fig. 5.** Press the both shroud junction rear tabs in.



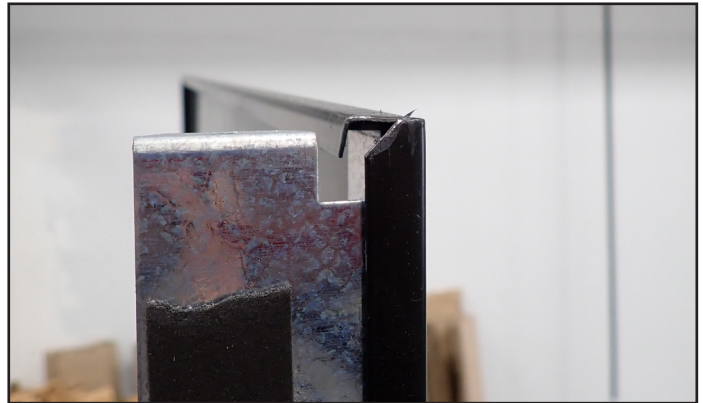
## TRM Installation Packet

3. With screws **D**, install the side shroud (#8). See figs. 36 and 37.

**NOTE: Shrouds hook onto the shroud supports. See fig. 37. Connecting sides (Y sides) will not have side shrouds.**



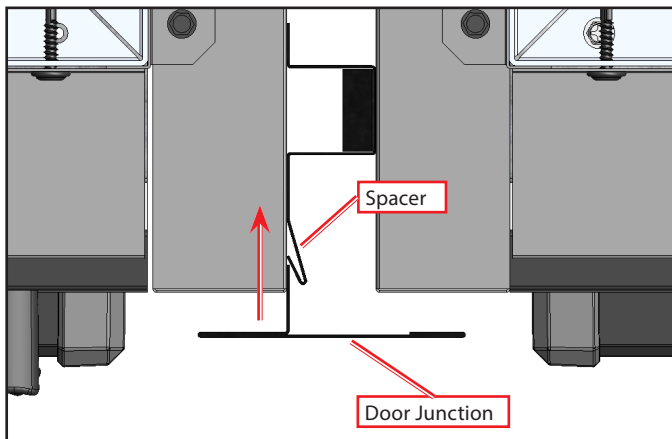
**Fig. 36.** Side shroud screw locations.



**Fig. 37.** Side shroud hooked onto shroud support.

### Install the Door Junctions

1. Remove the adhesive backing from the door junction piece (#1). Then, with screws **A**, install the door junction pieces. See figs. 1 and 2.



**Fig. 1.** Insert the door junction between the left unit's side and the spacer. Top-down view.



**Fig. 2.** Door junction screw locations.

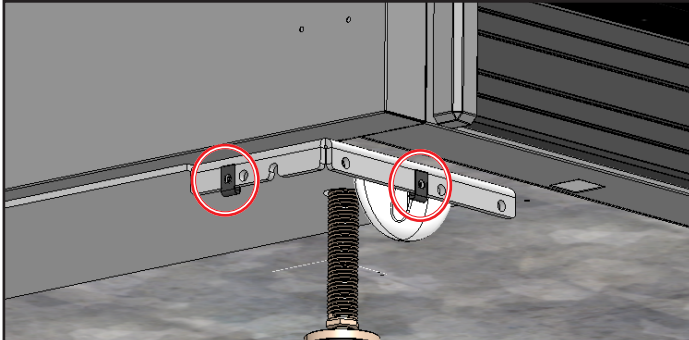


## TRM Installation Packet

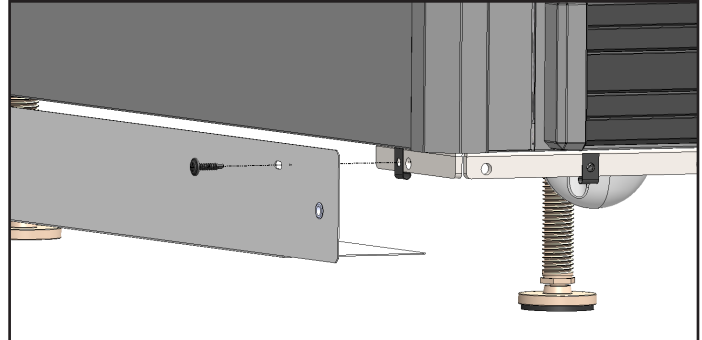
### Install the Side & Front Kickplates

1. With screws **C**, install the side kickplate support (#10) on the side kickplate bracket. See figs. 1 and 2.

**NOTE: Connecting sides (Y sides) will not have side kickplate supports or side kickplates.**



**Fig. 1.** Side and front kickplate brackets. Extra clip on nuts (circled) provided.



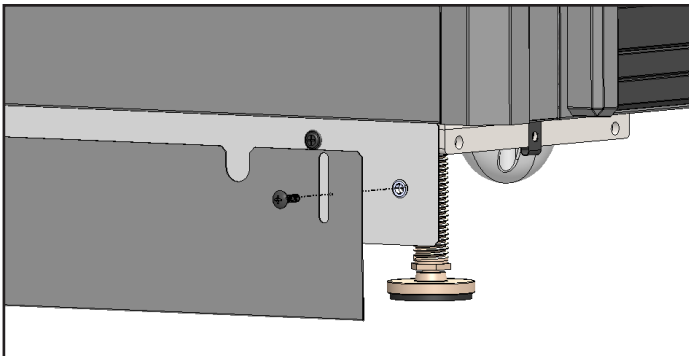
**Fig. 2.** Align the side kickplate support with the kickplate brackets.

2. With screws **E**, install the side kickplate (#11). See figs. 3 and 4.

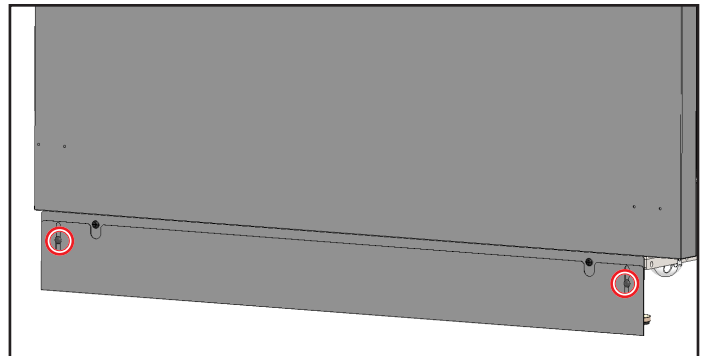
**NOTE: Hand-thread and then tighten. Do not overtighten.**

**NOTE: Kickplates are slotted to adjust to the floor as needed.**

**NOTE: In the event of a stripped rivnut, install the side kickplate with screws **C** positioned above or below the stripped rivnut.**



**Fig. 3.** Align the side kickplate with the rivnuts in the kickplate support.



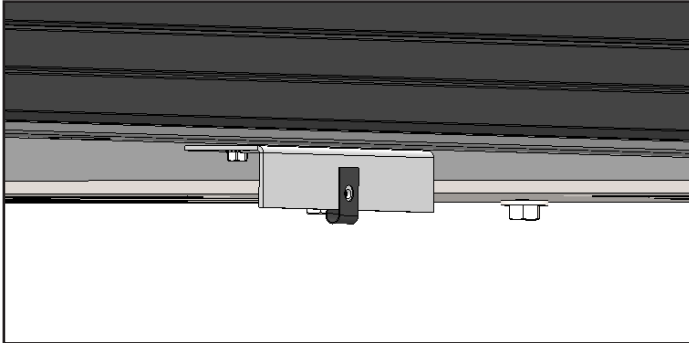
**Fig. 4.** Installed side kickplate.

3. Install any remaining side kickplates.

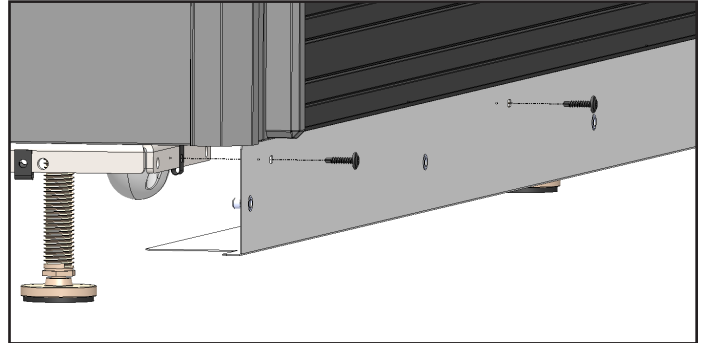


## TRM Installation Packet

4. With screws **C**, install the front kickplate support(s) (#12) on the front kickplate brackets. See figs. 5 and 6.

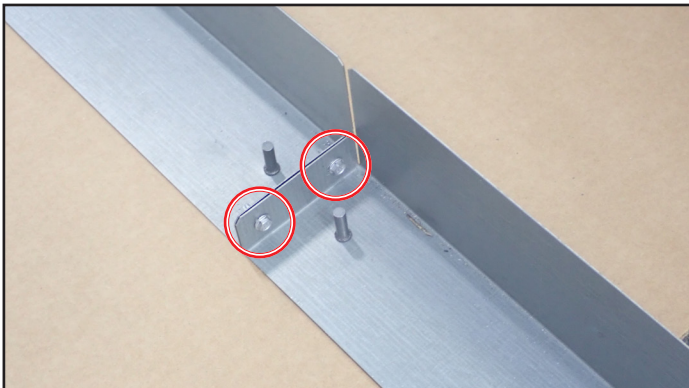


**Fig. 5.** Center front kickplate bracket.



**Fig. 6.** Align the front kickplate support with the front kickplate brackets.

**Four/Five-Section Units Only: With screws **A**, connect the front kickplate supports before installing the kickplate supports on the unit. See fig. 7.**



**Fig. 7.** Connected front kickplate supports.



## TRM Installation Packet

5. Install the kickplate junction pieces (#3 & #4). See fig. 8-10.

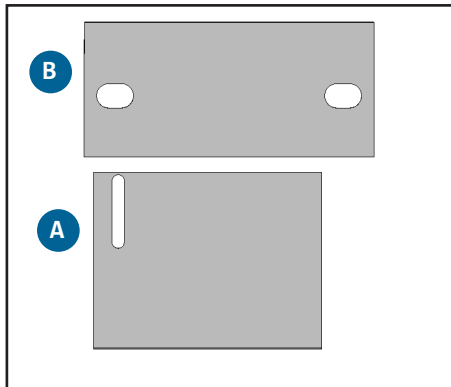
**NOTE: Kickplate junction pieces install BETWEEN the front kickplate supports and the front kickplates of each unit. See fig. 9 and 10.**

- Remove the adhesive backing from the rear kickplate junction piece.
- Position the rear kickplate junction piece.
- With a screw **E**, install the front kickplate junction piece and the left front kickplate.

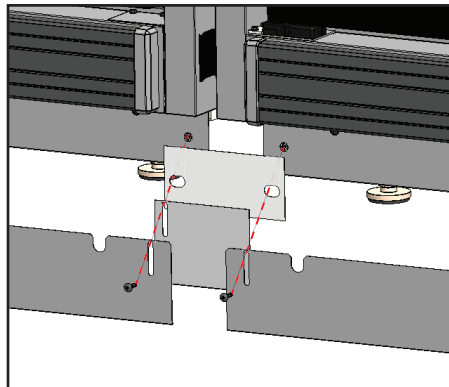
**NOTE: Hand-thread and then tighten. Do not overtighten.**

- With a screw **E**, install the right front kickplate.

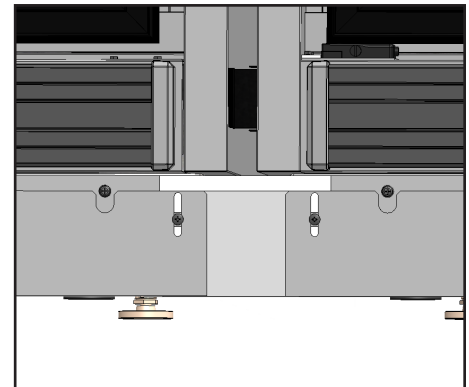
**NOTE: Hand-thread and then tighten. Do not overtighten.**



**Fig. 8.** Front (A) and rear (B) kickplate junction pieces.



**Fig. 9.** Exploded view of installing kickplate junction pieces (held in place by kickplate screws **E**) between the front kickplate support and the front kickplate.

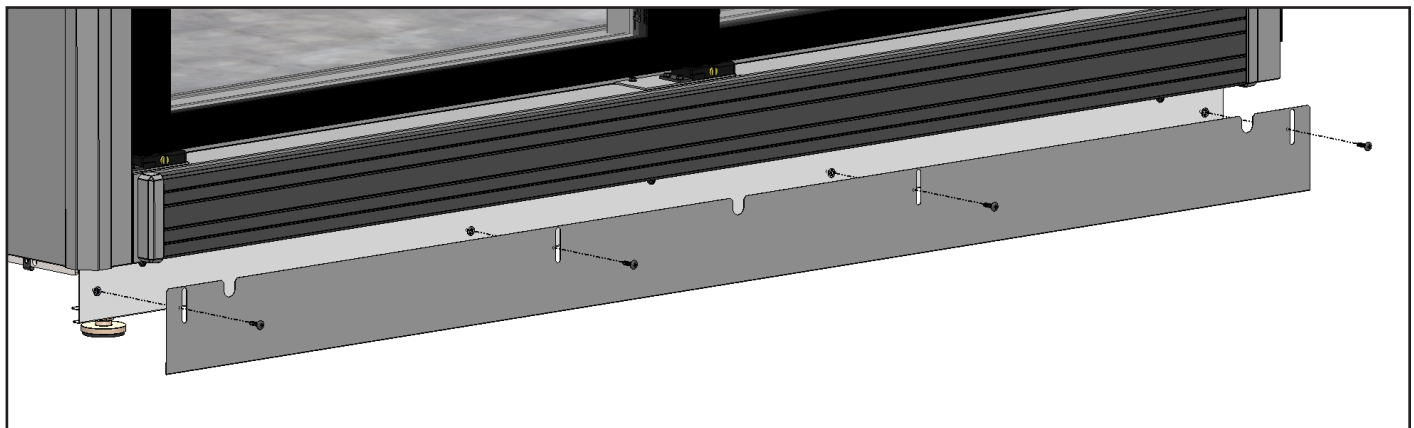


**Fig. 10.** Installed front kickplate supports, kickplate junction pieces, and front kickplate.

6. With screws **E**, install the front kickplate(s) (#13).

**NOTE: Hand-thread and then tighten. Do not overtighten.**

**NOTE: In the event of a stripped rivnut, install the side kickplate with screws **C** positioned above or below the stripped rivnut.**



**Fig. 11.** Align the front kickplate with the rivnuts in the kickplate support.



## TRM Installation Packet

### Miscellaneous Wrap Up

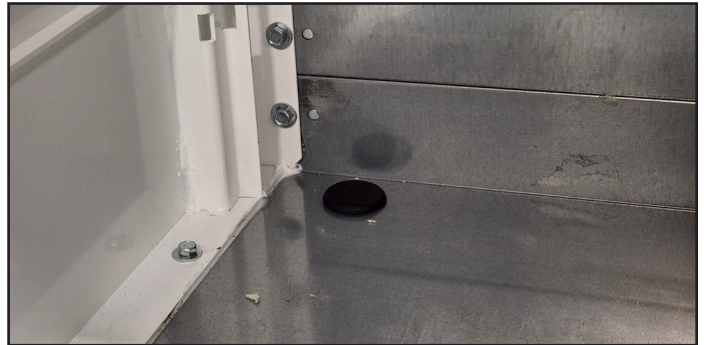
1. Plug and cap the leveling leg holes.

**NOTE: True recommends waiting to plug and cap the holes until the entire line of units is ready.**

- a. Locate the foam cylinders and caps.
- b. Insert a foam cylinder into a leveling leg hole. See fig. 1.
- c. Cap the plugged leveling leg hole. See fig. 2.
- d. Repeat steps b and c for each leveling leg hole.



**Fig. 1.** Plug the leveling leg holes with foam.



**Fig. 2.** Cap the leveling leg hole.

2. Reinstall the interior backguards. See fig. 3.



**Fig. 3.** Installed interior backguard.



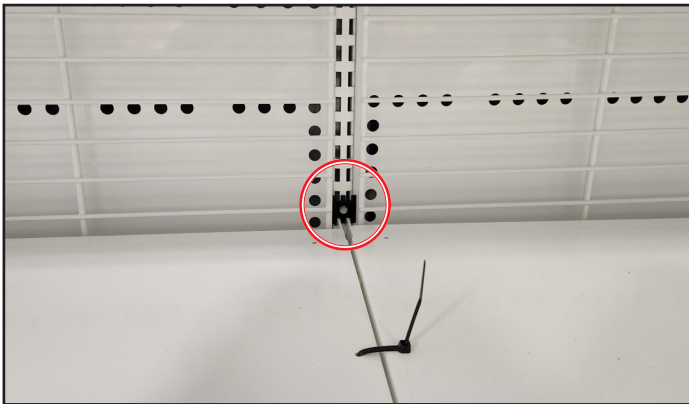
## TRM Installation Packet

3. Position the floor shelves (#14-16). See fig. 4.



**Fig. 4.** Installed left floor shelf.

4. Remove shelf shipping brackets, shelf cable ties, and any tape on the shelves and sidewalls. See figs. 5 and 6.



**Fig. 54.** Shelf shipping bracket.



**Fig. 55.** Shelf cable ties and shelf tape. Not all cable ties or tape shown.



## TRM Installation Packet

### Make Door Adjustments

1. Verify door alignment. Adjust doors as needed. See figs. 1 and 2.

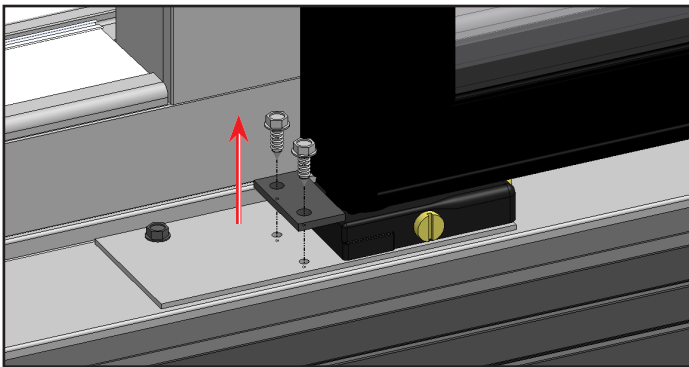
**NOTE: Before adjusting door down, be sure to remove the door shipping plate. Reinstall the door shipping plate screws. See figs. 3 and 4.**



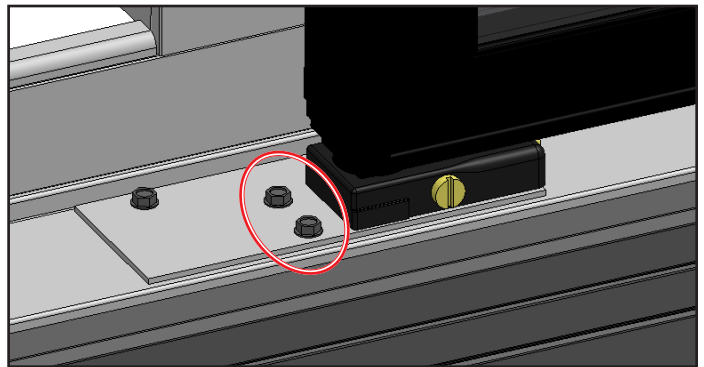
**Fig. 1.** Verify door corners are aligned.



**Fig. 2.** Door alignment adjustment screw location.  
Clockwise turn: Adjust door handle-side down  
Counterclockwise turn: Adjust door handle-side up



**Fig. 3.** Remove the door shipping plate.



**Fig. 4.** Reinstall the door shipping plate screws.

2. Verify door operation. Adjust door tension as needed. See figs. 5 and 6.



**Fig. 5.** Verify doors are self-closing when opened 2-3" (50.8-76.2 mm).



**Fig. 6.** Door tension adjustment screw location.  
Clockwise turn: Decrease door tension  
Counterclockwise turn: Increase door tension

3. If applicable, reverse the door. See "Door Reversal."



## TRM Installation Packet

### Door Reversal

**NOTE:** Only the rightmost doors on N sides can be reversed. See your full model name on the serial label.

### Required Tools

Required tools include (but may not be limited to) the following:

- Phillips Screwdriver or Bit Driver
- 1/4" Hex Head Driver
- Needle Nose Pliers
- 7/16" Socket
- Flat Blade Screwdriver
- Rubber Mallet
- Drill



### Procedure



**WARNING!** Assistance recommended. Door weight exceeds 50 lb (22.7 kg). Do not lift or support the door by the handle.



**WARNING!** Crush or cut hazard! Doors are heavy. Be prepared to support the door's weight during removal. Do not lift or support the door by the handle.

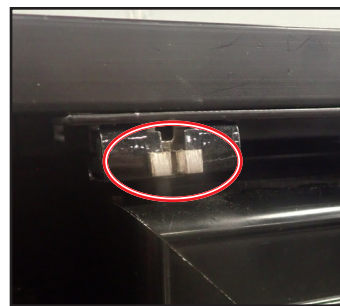


**WARNING!** Electrical shock or burn hazard. Powering off an electronic control does not remove power from all components. Unplug the unit or disconnect power before proceeding.

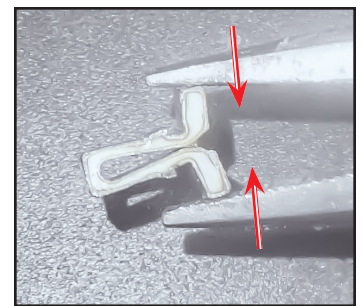


**Fig. 1.** Hold-open bracket screw location at the top of the door.

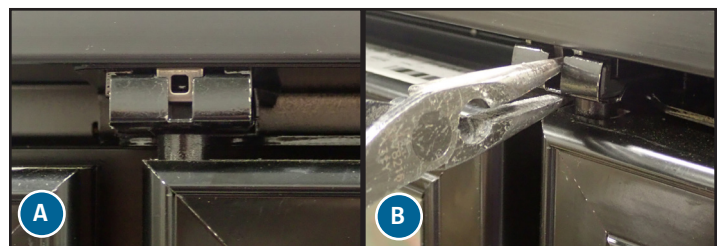
1. Remove the door tension. Turn the door tension adjustment screw clockwise until the door stays open on its own.
2. Disconnect the hold-open bracket from the appliance. See fig. 1.
3. If present, remove the hinge retention clip from the top hinge. Compress the clip and pull from the appliance. See figs. 2 and 3.
4. With assistance, disconnect the top of the door from the appliance.
  - a. Open the door approximately 70°.
  - b. With needle nose pliers, compress the hinge pin. See fig. 4.
  - c. While compressing the hinge pin, carefully pull the top of the door away from the appliance.



**Fig. 2.** Hinge retention clip installed in top hinge.



**Fig. 3.** Squeeze the hinge retention clip.



**Fig. 4.** Hinge pin at the top of the door (A). Squeeze the hinge pin (B).

Continue to next page





## TRM Installation Packet

5. Lift the door (by the frame) from the bottom hinge.

**NOTE: Do not lift the door by the handle.**

**NOTE: The torsion rod may remain in the torque master hole when lifting the door. If so, have an assistant lift the torsion rod out of the hole. See fig. 5.**

6. Carefully lay the removed door handle-side down.

7. Reverse the door.

**NOTE: Only freezer doors contain wires.**

- Remove the wire cover from the door's side. See fig. 6.
- If applicable, disconnect the hinge pin wires. See figs. 7–9.
- Remove the hinge pin.
- Carefully remove the torsion rod.

**NOTE: Removing the torsion rod may require slightly rotating the rod to get the torsion rod cap to clear the door. See fig. 10.**

- Install the torsion rod in the opposite side.
- Install the hinge pin in the opposite side. If applicable, connect the hinge pin wires to the door as described.

**NOTE: Wiring will vary by age of appliance.**

Style #1 (fig. 8)

- Hinge pin white to door white
- Hinge pin red to door black
- Ground to door

Style #2 (fig. 9)

- Hinge pin white to door white with yellow heat shrink
- Hinge pin red to door white with red heat shrink
- Ground to ground

- Reinstall the wire cover.
- Remove the hold open bracket.
- Remove the plastic cap. See fig. 11.
- Swap the hold-open bracket and plastic cap locations.

**NOTE: Hold-open bracket installs with the convex side facing the door.**

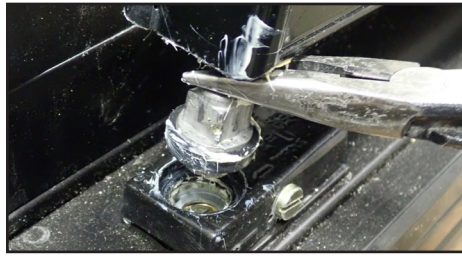


Fig. 5. Lifting the torsion rod from the torque master hole.



Fig. 6. Wire cover located in the hinge-side of the door in the center.

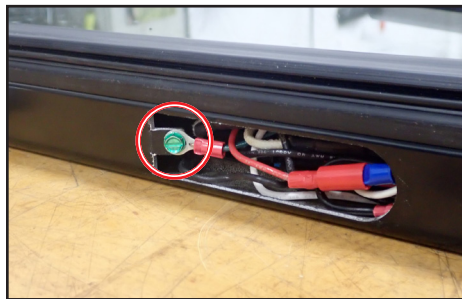


Fig. 7. Hinge pin ground screw location. Style #1.

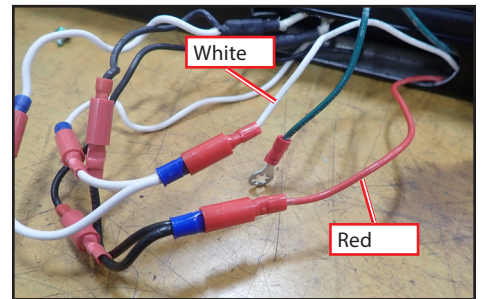


Fig. 8. Hinge pin wire connectors. Style #1.

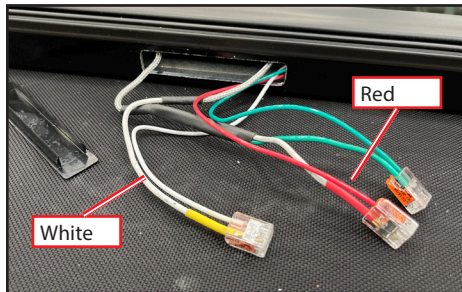


Fig. 9. Hinge pin wire connectors. Style #2.

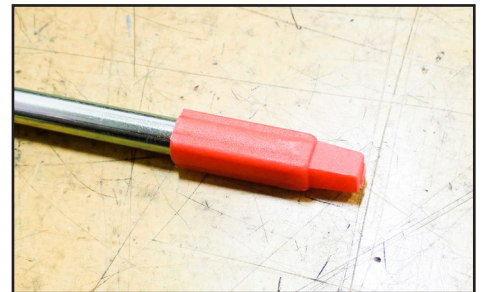


Fig. 10. Torsion rod cap.



Fig. 11. Plastic cap in the door's bottom.

Continue to next page





## TRM Installation Packet

- k. Move the magnet assembly to the opposite side.

**NOTE: Install the magnet assembly 15" (381 mm) from the door's handle side. Be sure the installed magnet is flush with the gasket. Magnet assembly hole may be predrilled.**

8. If applicable, move the hinge pin plug to the opposite side. See fig. 12.

9. If applicable, move the hinge pin cover to the opposite side. See fig. 13.

10. Locate the replacement cover plate (#17) and torque master plate (#18) in the interior packaging with the leveling tools. See fig. 14.

11. Remove the torque master assembly and the existing cover. See fig. 15.

12. Move the torque master to the replacement torque master plate. See fig. 16.

13. Install the replacement cover and the replacement torque master assembly on the opposite sides.

**NOTE: Be sure to install the replacement torque master assembly with the alignment adjustment screw facing out. See fig. 17.**

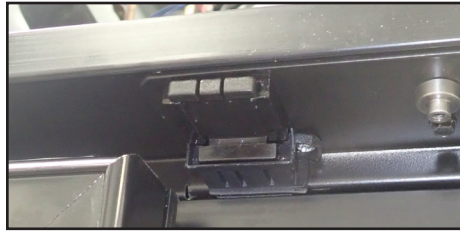
14. Lift the door (by the frame) and set it in the torque master hole. Be sure the door is fully seated.

**NOTE: Do not lift the door by the handle.**

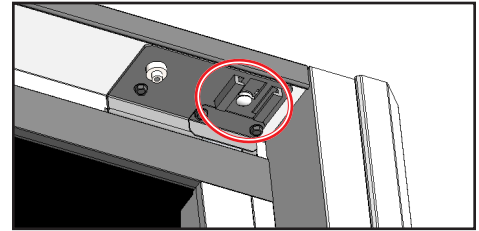
15. Hold the door perpendicular to the appliance.

16. Align the hinge pin (see fig. 18). Then, push the door's top towards the appliance until the hinge pin clicks into place.

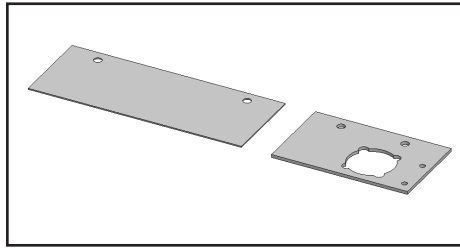
**NOTE: Getting the hinge pin fully seated may require a rubber mallet.**



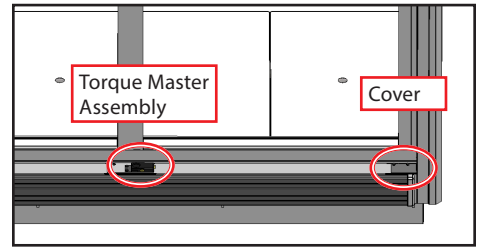
**Fig. 12.** Hinge pin plug installed on the opposite side.



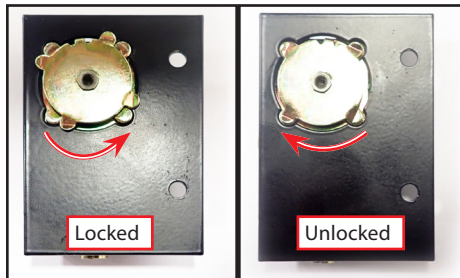
**Fig. 13.** Hinge pin cover located on appliance upper right.



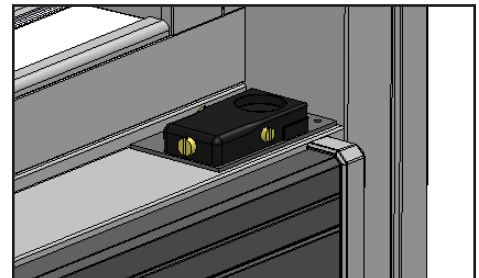
**Fig. 14.** Replacement cover plate and torque master plate. Located in the interior packaging with the leveling tools.



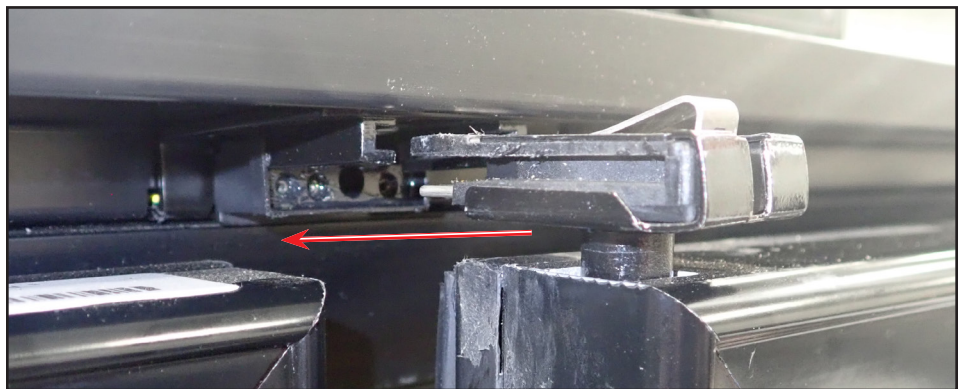
**Fig. 15.** Original torque master assembly and cover locations.



**Fig. 16.** Move the torque master to the replacement plate. Rotate counterclockwise to lock; clockwise to unlock.



**Fig. 17.** Correctly installed replacement torque master assembly.



**Fig. 18.** Align the hinge pin.

Continue to next page





## TRM Installation Packet

17. Reinstall the hinge retention clip.
    - a. Compress the hinge retention clip. See fig. 19.
    - b. Insert the compressed hinge retention clip below the hinge clip in the hinge pin. See figs. 20 and 21.

**NOTE: If the hinge retention clip does not stay inserted, pry the hinge clip up with 1/8" drift punch or torsion tool. See fig. 22.**

  - c. With a flat blade screwdriver and a rubber mallet, open the hinge retention clip. See fig. 23.
18. Verify the hinge pin securely holds the door. Pull down on the door.
  19. Install the hold-open bracket onto the appliance.
  20. Turn the door tension adjustment screw counterclockwise until the door gently self-closes from 2-3" (50.8-76.2 mm). See fig. 24.
  21. Verify door alignment. Adjust alignment as needed. See fig. 25.

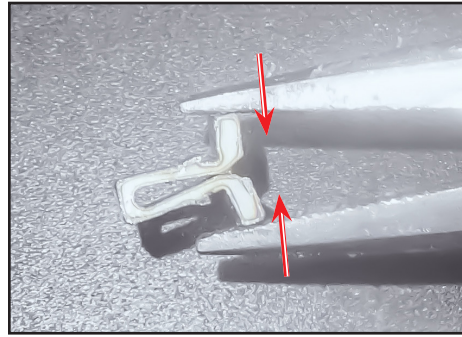


Fig. 19. Squeeze the hinge retention clip.

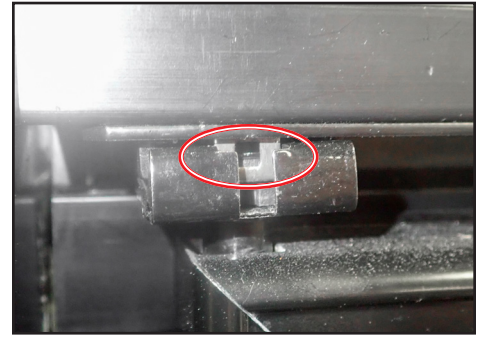


Fig. 20. Hinge clip in the top door hinge.



Fig. 21. Insert the hinge retention clip.

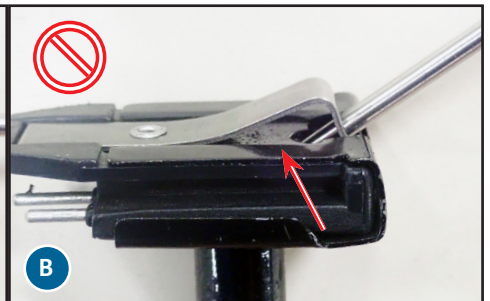
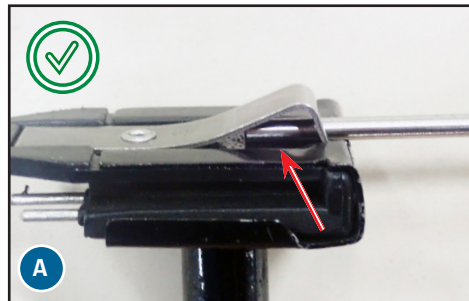


Fig. 22. Insert the torsion tool/drift punch into the hinge clip horizontally (A) or from below, not from above (B).

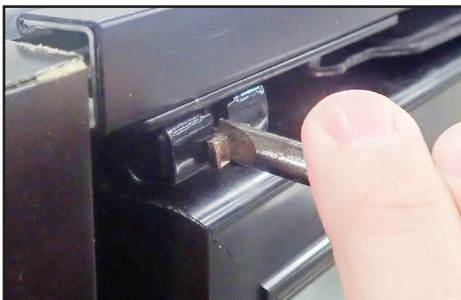


Fig. 23. Open the hinge retention clip.



Fig. 24. Door tension adjustment screw location.  
Clockwise turn: Decrease door tension  
Counterclockwise turn: Increase door tension



Fig. 25. Door alignment adjustment screw location.  
Clockwise turn: Adjust door handle-side down  
Counterclockwise turn: Adjust door handle-side up